

**RURAL
CEMETERIES
OF
McDONOUGH COUNTY, ILLINOIS**

**VOLUME VII
NEW SALEM- ELDORADO**

**BY DUANE LESTER
GOOD HOPE, ILLINOIS**

**PRINTED BY
SCHUYLER – BROWN
HISTORICAL AND GENEALOGICAL SOCIETY
AND
THE SCHUYLER JAIL MUSEUM**

“A monument is erected
not because a person died,
but because a person lived.”

Volume VII

Table of Contents

Preface	i – ii
Maps and plats	iii – iv....ix-xiv
McDonough County, Illinois	iii
Areas Covered in Volumes I - XVII	iv
Section 19: New Salem Township, T5N R1W, 1871	v
Section 6: Eldorado Township, T4N R1W, 1871	vi
Section 23: Eldorado Township, T4N R1W, 1871	vii
Pennington Point Cemetery	1 - 41
Dailey Cemetery	42
Miles Cemetery	43 - 44

Preface

Within the boundaries of McDonough County, Illinois are more than a hundred cemeteries and gravesites ranging in size from a single burial site to the expansive Oakwood Cemetery at Macomb. Within these cemeteries are the remains of an estimated 40,000 individuals who have died since the first settler arrived here over 150 years ago. Graves of countless others are scattered over the countryside of McDonough County; but, exact sites of many of these resting places are no longer known for various reasons. During the early days of this county, there were obviously no central burial grounds; thus, a pioneer family having the misfortune of losing one of its members placed the deceased in a grave on a family homestead and erected a makeshift marker. A number of these family burial grounds later became public cemeteries, however, many of the grave sites soon became "lost". Crude wooden markers or hand engraved stone soon succumbed to the elements and were never replaced; scores of families moved further west after staying in this area only a short time and the gravesites of their loved ones shortly became insignificant mounds of earth; a number of families passing through this vicinity suffered individual losses. A prime example of the latter is contained in a history of Bethel Township. In 1830, four children of an emigrant family died while en route through McDonough County. They were buried near their places of death which occurred about two miles southwest of Fandon. All traces of those graves have long been gone. During the summer of 1834, a widow lady died at her home in northern Tennessee Township. Her coffin of dressed walnut lumber was built by a local cabinet maker and she was buried in the timber near her home. Within a few years, no evidence remained to indicate the presence of her final resting place. A family who created an excellent farm from the prairies a few miles north of Macomb, maintained a fenced family burial site for several years. This cemetery contained the graves of about 12 former family members. During the early 1900's, the farm changed ownership. Shortly thereafter, the new owner removed all the stones, took down the fence and this graveyard became part of a cornfield. These are only three of the countless incidents involving the total disappearance of burial sites. At this time, it is impossible to determine the locations of hundreds of individual's graves in this county.

Vandalism is responsible for the destruction of many grave stones. Countless markers have been partially or totally destroyed. Inscriptions have been obliterated by gunshot blasts, stones have been broken into dozens of pieces, and some markers have been entirely removed from their original locations.

While weather-wear and vandalism accounts for most of the destruction of individual tombstones, neglect is directly responsible for the eventual deterioration of graveyards. Several local cemeteries have had no protective fencing for a number of years and the grounds have become grazing land for livestock. Groundhogs and other burrowing animals have undermined large portions of various cemeteries. Some areas are nearly invisible because of massive growth of weeds and brush. Stones have fallen, broken, and become completely covered with soil and debris.

The overall condition of our county cemeteries is a pathetic case. While some grounds are well maintained, or at least partially kept-up by various families, many have been totally forgotten. This situation is appalling and should never have come about. Apparently, lack of time, expense, and most of all regard has brought about the present-day poor conditions of many of our rural cemeteries.

Genealogical notes accompanying the various cemetery listings were prepared from a wide variety of sources including: Local area history books and atlases; newspaper files; county, state, and federal archives; family histories. These notes were collected at random from readily available sources and little, or no attempts were made to search for material for more complete genealogies. These notes are presented only for the purposes of identification and/or clarification.

Every attempt has been made to present complete and accurate information. Readers will find errors and omissions. Others will not agree with portions of my findings; however, no information contained herein is based solely on assumption or guesswork. It must be remembered that this information has been prepared for use only as a tool for further research and that nothing must be taken as final and absolute.

The larger cemeteries contained in these volumes are accompanied by grave location charts. These charts in no way are intended to represent any professionally prepared plat or survey that may exist. Their preparation and presentation are solely for general location purposes.

When copying inscriptions from grave markers, it is sometimes impossible to read some portions of the engraving. Names, dates, ages, etc. that were found to be unclear or totally missing are indicated by the use of question marks or dashes, i.e., SPICER, James T., infant son of ?J.B. & S.J.?.; d. ____; age _____. The letters or numbers enclosed in parenthesis following the inscription, indicated general location as indicated on the accompanying chart.

Abbreviations used are as follows:

b. born	m. months
Cav. Cavalry	md. married
Co. County/Company	sec. section
d. died/days	twp. township
dau. daughter	y. years
Inf. Infantry	

Time and space prohibits proper recognition for all those individuals who gave assistance in preparing and publishing these volumes. Deep and sincere appreciation is extended to all concerned, especially to the following: My parents, Mr. and Mrs. Lloyd Lester, and my wife, Rose; and to Mrs. Lavina Walton and other members of the Schuyler County Historical and Genealogical Society for printing and binding the finished product. Thank you.

Duane Lester

ADDENDUM

Mr. Lester's Magnum Opus is nothing short of monumental. It is not easy to gain access to many of these historic family burial sites. By the time of Mr. Lester's survey (1970's) numerous plots were long left abandoned, overgrown with trees and weeds and monuments under attack by weather, livestock, vandals, and property owners who did not care about the burial sites of McDonough County's brave pioneers. Thankfully, we now (2012) have laws to protect our county's historical legacy and these final resting gardens.

I am in awe of Mr. Lester for his transcriptions of hard-to-read tombstones and his laborious typing of his 18 Volumes of the Rural Cemeteries of McDonough County. He did not have access to a computer. In addition to transcribing information from tombstones, he had to painstakingly access county records (e.g. 1840 county tax list), federal census records, and local newspapers requiring a great deal of time and effort. As a genealogist in 2012, I have access to the internet with fast access to US Census records, Family Search (records kept by the Church of Jesus Christ of Latter-Day Saints) and numerous other legal documents, books, and family journals. Mr. Lester used an old-fashioned key-strike, ribbon tape typewriter where mistakes were hard to correct and appear as overstrikes. There are very few attesting to his skill as a typist. What an US Census record will not contain are the names and dates of infants who died between census surveys. Mr. Lester's tombstone records give names and dates of children, whose lives were brief, but would otherwise be lost to history without his efforts. Frequently, he provides names of brothers and sisters, fathers and mothers that allows for completion of family group sheets.

Another work of love for those who dared to settle the prairie lands of western Illinois and raise their families is being performed by Dr. A. Gil Belles. He has been able to install signs for each of these rural cemeteries and provide GPS (Global Positioning System) information making it easier for anyone wishing to visit a rural cemetery to help them actually find it. Gil also works closely with Boy Scouts and other civic groups to help cleanup, clear brush and dead trees, locate buried tombstones, and restore stones. My revision of Mr. Lester's document will provide information on all cemetery restoration projects.

Any changes made to Mr. Lester's original work was done in blue color font. His maps were scanned and copied into the text and remain like his original work and are not subject to editing. His text was transcribed using MS Word, enabling me to control font size and color. Retyping text also leaves room for typo errors. Mr. Lester's rare typo errors are corrected but not displayed in blue. This MS Word document allows on-the-fly editing of any "Notes, Corrections, Additions, and Changes" found at the end of every cemetery. This was Mr. Lester's intent to produce a working document and improve accuracy about the information on those buried. I have retyped state abbreviations as they are now used (e.g. IL, instead of Ill.). On 1840 county tax lists I omitted cents (e.g. \$140, instead of \$140.00). The current MS Word font uses less space, thus, placing more text per line. This shrinks his documents and reduces pages. This, then, changes page numbering in each Table of Contents. Cemetery locations are also found on the internet. See: **McDonough County Illinois Cemeteries** <http://graveyards.com/graveyards/IL/McDonough>

Areas covered by volumes I - XVII
 "Cemeteries of McDonough County, Illinois"

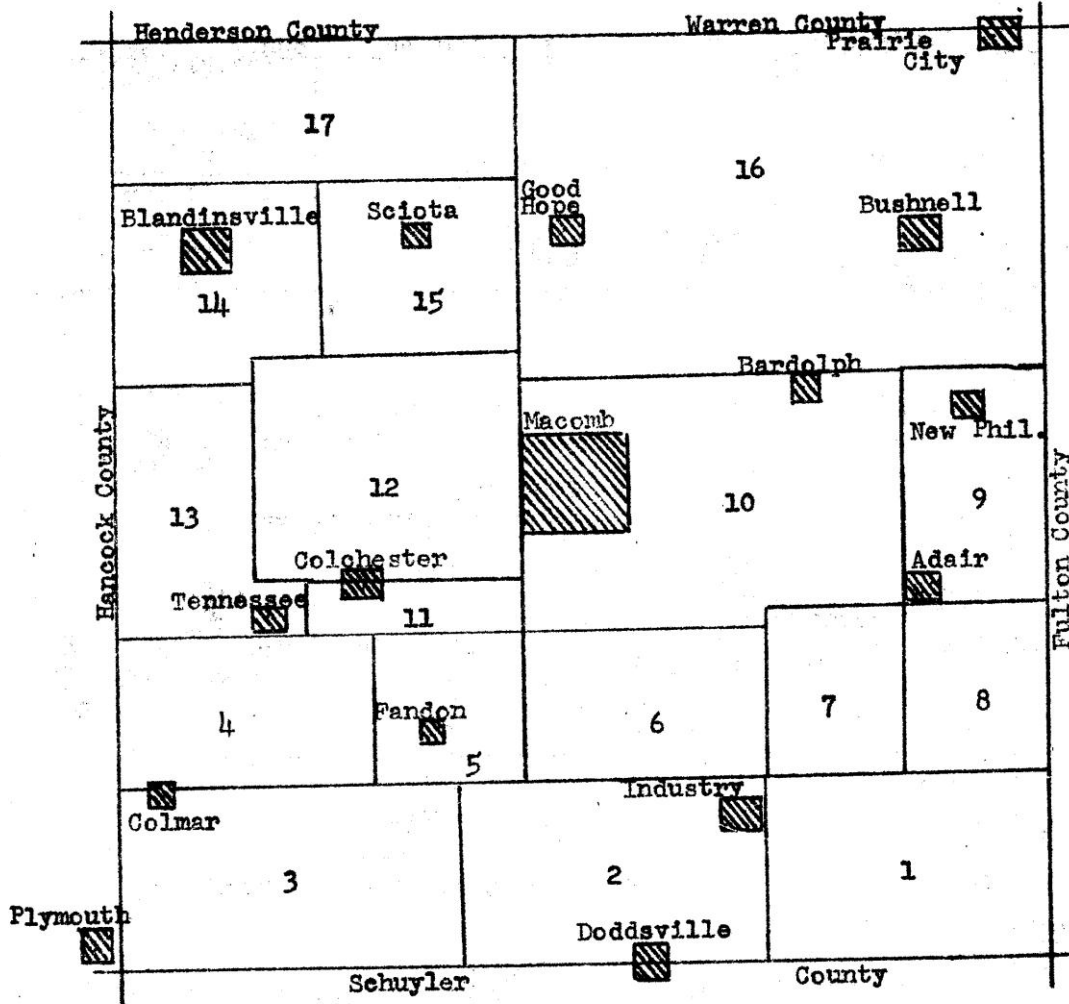

Section 19

New Salem Township, T5N R1W; 1871

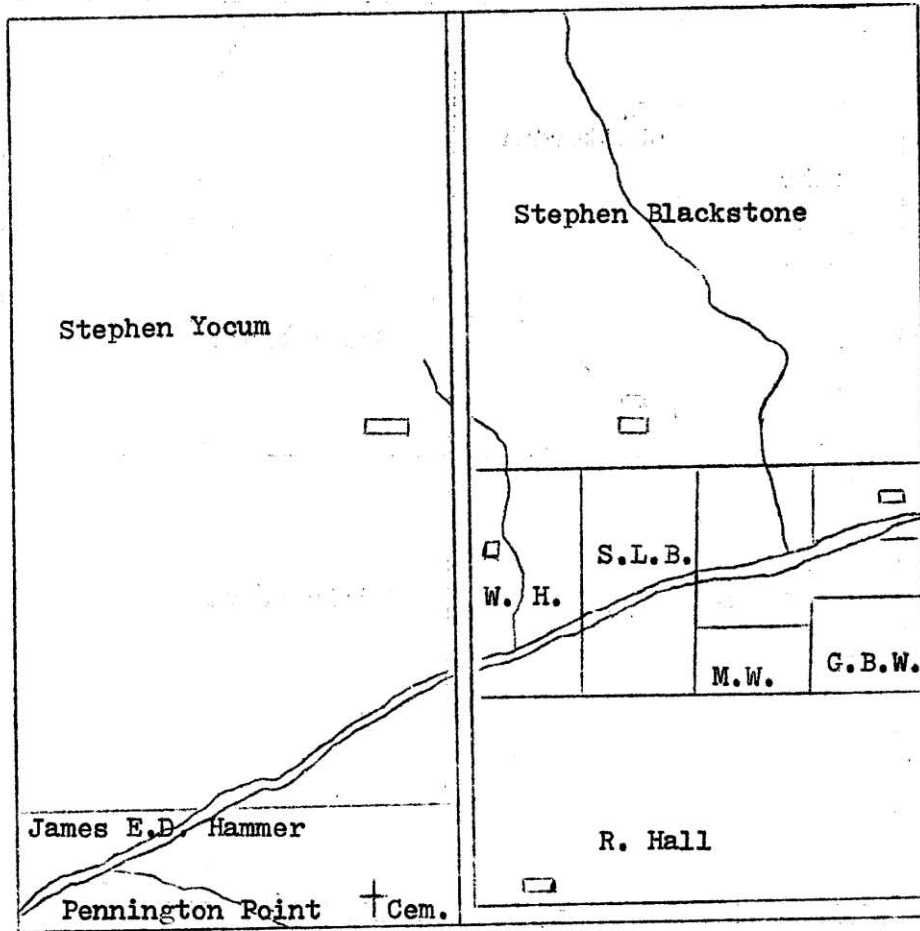

Section 6

Eldorado Township, T4N R1W; 1871

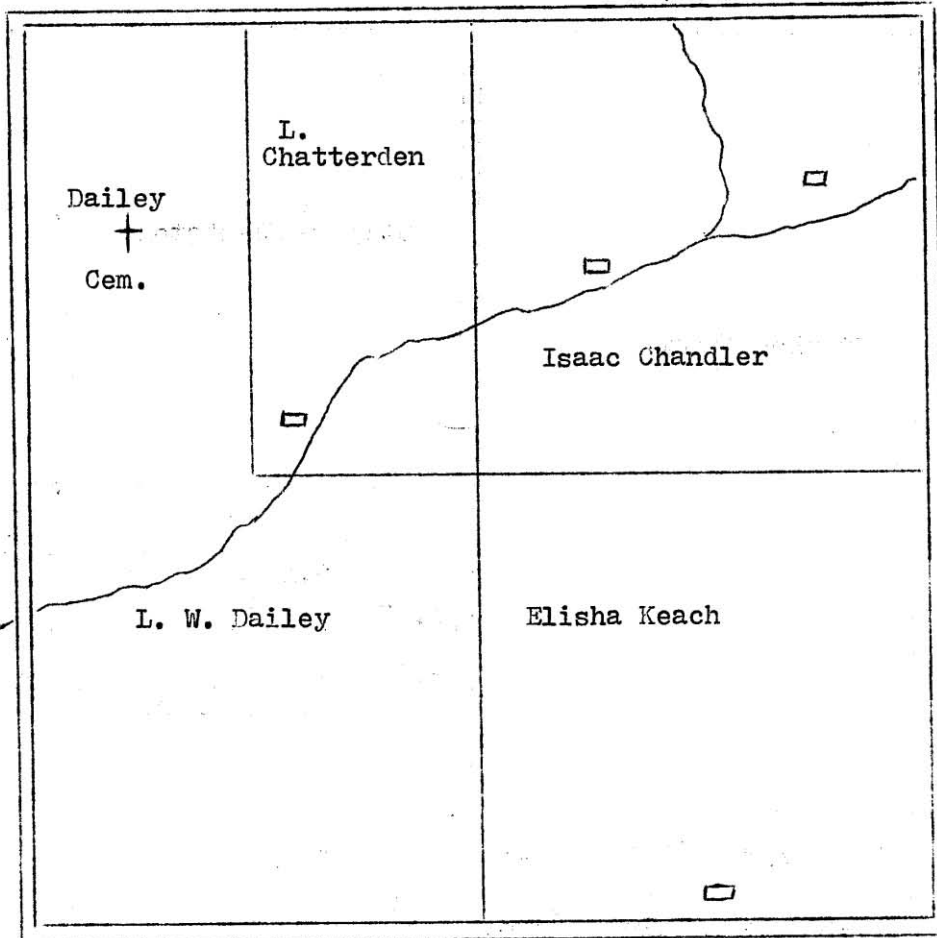

Section 23

Eldorado Township, T4N R1W; 1871

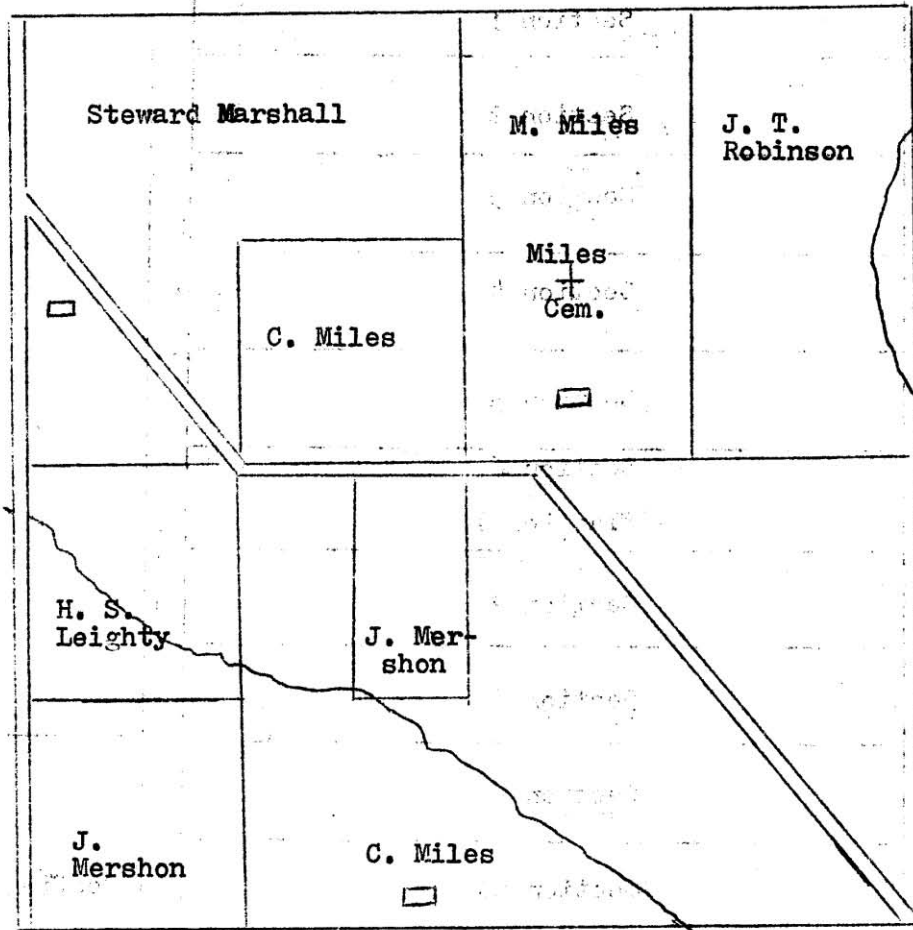

Pennington Point Cemetery
New Salem Township
SW $\frac{1}{4}$, Section 19

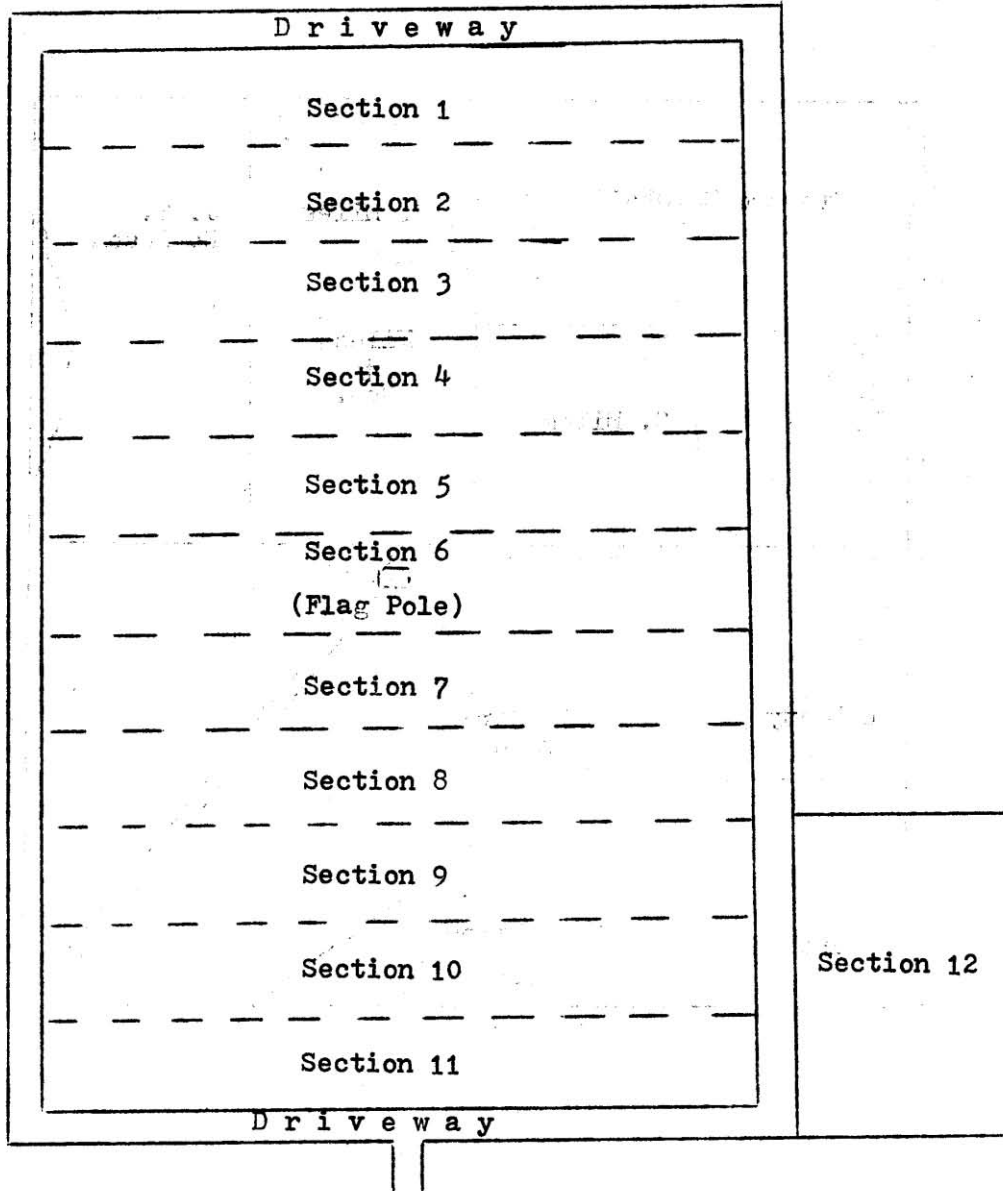
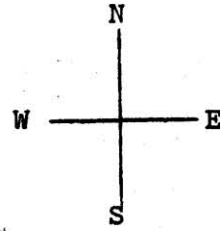

PENNINGTON POINT CEMETERY

Location: New Salem Township, SW¼, section 19; three miles southwest of Adair. [\[One quarter mile west of E1840 St on N775 Rd\]: 40° 23' 47.1" N: 90° 33' 19.5" W](#)

Remarks: Established in the early 1830's with the first known burial here being that of 27 year-old Agnes Ausbury, wife of Thomas Ausbury, who died in Sep 1836. Mr. J.E.D. Hammer owned the land on which this 2-acre cemetery is located; he later deeded the property to McDonough County; and shortly thereafter was again deeded to trustees of the cemetery. In the early 1880's, Pennington Point Cemetery was surveyed and laid off in blocks and lots. The grounds are regularly maintained and the area is completely fenced; most stones are in excellent condition, however, many of the older markers are badly weather-worn and nearly unreadable. Pennington Point M.E. Church, which stood immediately south of this cemetery was recently torn down. It was originally built in 1856 at this site; in 1876, a new church building was erected and it was badly damaged in a tornado in 1881; a few years ago, services here were discontinued.

ACKMAN:

Anna M.; 1888 – 1963. (12)

ALTON:

Phebe E., wife of Marcus; b. Jun 22, 1826; d. Apr 24, 1877. (2)

ARNOLD:

M.S.; d. Feb 2, 1895; age 46y 1m 9d. (3)

Sarah Jane; 1852 – 1927. (3)

Sylvia R.; dau of M.S. & S.J.; d. Dec 25, 1892; age 4m. (3)

ATEN:

Belle; 1868 – 1963. (2)

Irven; 1871 – 1944. (2)

Pearl, dau of Irven & Belle; b. Jul 2, 1895; d. Oct 25, 1896. (2)

ATHERTON:

William E.; Apr 12, 1856 – Jun 7, 1886. (3)

Mary J.; May 1, 1830 – Nov 23, 1893. (3)

Eliza, dau of G. & S.A.; d. Nov 19, 1872; age 5d. (3)

William B.; 1842 -1916. (3)

Amelia C., wife of W.B.; 1853 – 1902. (3)

Emma, dau of W.B. & A.C.; d. Jan 28, 1890; age 6y 1m 1d. (3)

Abbie, dau of W.B. & A.C.; d. Oct 19, 1878; age 3y 8m 3d. (3)

Infant dau of W.B. & A.C.; 1877 – 1877. (3)

Infant son of W.B. & A.C.; 1881 – 1881. (3)

AULT:

Nell E. Thomas; d. Oct 12, 1860. (8)

AUSBURY:

Luella Foster, wife of Edward; b. Dec 5, 1870; d. Mar 25, 1909. (1)

Otis F., son of E.T. & Luella; b. Dec 16, 1893; d. Aug 7, 1895. (1)

Agnes, wife of Thos.; d. Sep 9, 1836; age 27y 7m 22d. (6)

William J., son of T. & L.; d. Jun 14, 1860; age 22y 5m 8d. (6)

Lucy A., wife of T.W.; b. Jan 30, 1847; d. Sep 8, 1888. (7)

Thomas; b. Mar 8, 1809; d. Jan 15, 1887. (7)

Lucinda, wife of Thos.; b. Apr 26, 1811; d. Oct 22, 1902. (7)

Golda; b. May 18, 1888; d. Nov 20, 1966. (7) 2

BAER:

Rebecca, wife of A.; d. Jun 9, 1865; age 40y 1m 4d. (7)

BAKER:

Lillie F., wife of T.M. & dau of J. & M.A. Reedy; d. Apr 21, 1889; age 23y 10m 15d. (4)

Thomas M.; Jun 26, 1863 – Apr 16, 1899. (4)

Queenye, dau of Thos. & Francis; Nov 20, 1887 – Jan 13, 1906. (4)

BALDNER:

Clarence E., son of P.F. & L.H.; d. Sep 8, 1905; age 2y 9m 8d. (1)

Grover Kline, son of G.T. & D.M.; b. Mar 1, 1922; d. Aug 16, 1923. (1)

Marjorie, dau of G.T. & D.M.; b. 1914; d. 1921. (1)

Grover T.; 1884 – 1961. (11)

D. Maude; 1888 – 19---. (11)

BARNHART:

Oscar T., son of John W. & Sarah A.; d. Oct 9, 1886; age 1y 3m 1d. (3)

Sarah A.; 1857 – 1924. (3)

BATTIN:

William; b. Jul 20, 1867; d. Dec 10, 1925. (1)

Hettie; b. Jan 10, 1867; d. Jul 13, 1941. (1)

Blanche; b. 1891; d. 1901. (1)

Newton; b. 1892; d. 1921. (1)

BERRY:

Isabella; Jul 12, 1815 – Mar 3, 1870; age 54y 7m 21d. (9)

BLACKSTONE:

Mahala E.; 1843 – 1916. (6)

Stephen; 1838 – 1921. (6)

Elizabeth; 1868 – 1945. (6)

Olive E.; 1879 – 1963. (6)

George R.; 1875 – 1964. (6)

Howard, son of George & Olive; 1901 – 1916. (6)

Elizabeth Blisset, wife of B.; d. Aug 16, 1887; age 70y 16d. (7)

Beverly; d. Jan 3, 1861; age 57y 5m 1d. (7)

Mary V.; dau of B. & E.; d. Aug 16, 1841; age 11m 6d. (7)

BLANSFIELD:

Infant son, Robert Van; d. Jan 3, 1842. (4)

BLOOMER:

Rev. Henry M.; May 11, 1874 – Mar 18, 1956. (2)

Mertie H.; Aug 1, 1875 – Aug 20, 1958. (2)

BREADEN:

James T., son of Wm. & S.C.; Jul 5, 1860 – Aug 16, 1861. (9)

Sarah C., wife of Wm.; d. Aug 10, 1861; age 23y 9m 20d. (9)

BROTHERS:

John; 1812 – 1898. (7)

Nancy, wife of John; 1812 – 1886. (7)

BRUNDIGE:

Mary Wilkins, wife of James W.; Feb 11, 1864 – Jan 2, 1892. (4)

George E.; 1863 – 1963. (11)

Rosa B.; 1868 – 1953. (11)

BURNHAM:

Garnet Bible; d. May 10, 1975; age 74y 10m 23d. (11)
Bailey Frederick; d. Oct 26, 1973; age 66y 11m 17d. (11)
Ami; 1873 – 1955. (11)
Alice G.; 1906 – 1906. (9)
B. Lawson; 1900 – 1921. (9)
Binnie L.; d. Feb 7, 1921; IL Pvt. S.A.T.C. Knox College. (9)
Sarah Lela; 1878 – 1948. (9)
Albert C.; 1874 – 1944. (9)

BURNHART:

Nelle; 1893 – 19---. (10)
Roxselany; 1889 – 1970. (10)
Rosa; dau of J.A. & E.C.; Jun 17 – Jun 19, 1895. (10)
Jacob A.; 1854 – 1926. (10)
Esther C.; 1859 – 1947. (10)
Charles B.; 1881 – 1963. (11)

CASPALL:

Bessie; 1885 – 1965. (1)
Frederick A.; 1880 – 1935. (1)
Charlie D.; 1916 – 1916. (1)
A. Elmo; 1905 – 1906. (1)
Sarah E., dau of J. & E.; Aug 28, 1876 – Oct 15, 1904. (4)
J.E.M.; d. Nov 20, 1881; age 28y 4m 20d. (4)
Shirley Joan; Oct 19, 1935 – Apr 1, 1961. (12)

CHADDERDON:

Arthur E.; b. Oct 23, 1874; d. Sep 27, 1905. (1)
Achsa, wife of A.E.; b. Oct 31, 1879; d. Feb 28, 1900. (1)
George W.; b. Dec 11, 1835; d. Aug 28, 1917; Co B 84th Regt IL Vol Inf (1)
Nancy P. Willis, wife of George; b. Oct 31, 1837; d. Sep 11, 1905. (1)
Lewis; 1828 – 1884. (5)
Mary J.; 1837 – 1930. (5)
U.B. Way; 1813 – 1867. (5)
Lydia A.; 1871 – 1938. (5)
Alfred S.; 1865 – 1928. (5)
Glenn; 1893 – 1893. (5)
Czerna J.; 1898 – 1937. (10)
Wayne; 1894 - 1950. (10)
Sarah J.; 1863 – 1956. (10)
Alvin S.; 1865 – 1928. (10)
George Lewis; 1900 – 1953. (11)

CHANDLER:

Franklin; b. Dec 11, 1851; d. ----- (6)
Lusettie F., wife of F.; Mar 13, 1854 – Feb 28, 1899. (6)
Blanch, infant dau of F. & L.F.; Apr 10 – 28, 1883. (6)
Isaac; Aug 23, 1823 – May 30, 1899. (6)
Martha L. Stockton, wife of Isaac; Oct 7, 1838 – Feb 22, 1922. (6)
William; Feb 8, 1861 – Jul 3, 1919. (9)
Lillian; Jun 27, 1874 – May 25, 1927. (9)

CHISM:

James T.; d. Mar 2, 1858; age 25y 5m 17d. (9)

COATS:

Lena E.; 1886 – 1940. (4)
Fred R.; 1884 – 1974. (4)
Diane, dau of Arnold & Mary; b. & d. Mar 1, 1935. (11)

COLEMAN:

Henrietta, wife of Mathias; b. May 23, 1827; d. Nov 12, 1900. (1)
Charles C.; b. 1854; d. 1934. (1)

COPE:

Henry W.; 1901 – 1926. (8)
Elva Williams; 1866 – 1909. (8)

COYNER:

Roy B.; 1880 – 1955. (3)
Alta M.; 1880 – 1956. (3)
Henry J.; 1866 – 1932. (11)
Clara B.; 1867 – 1957. (11)

CRAIG:

Ina J. dau of M.H. & M.J.; d. Feb 1, 18----; age -----. (4)
Charlie, son of W.J. & S.B.; d. Oct 28, 1863; age -----. (9)

CURRENS:

Fannie M., dau of D.M. & L.A.; Apr 13, 1879 – Jan 29, 1882. (3)
Mahala, wife of W.A.; 1855 – 1922. (3)
William A.; d. Nov 20, 1881; age 32y 5m 5d. (3)
Bryce E. 1879 – 1949. (9)
Laura A., 1879 – 1974. (9)
Jessie J.; Jun 20, 1885 – Mar 21, 1912. (10)

CURTIS:

Alta M.; 1882 – 1968. (11)
Fred E.; 1884 – 1963. (11)

DAUGHERTY:

Aubrey, son of U.G. & A.D.; b. Feb 8, 1897; d. at age 20d. (2)

DAVIS:

Ada G.; 1915. (2)
Charles G.; 1883 – 1962. (10)
Ada Grim, wife of Chas.; 1892 - -----; md. 1915. (10)

DEAN:

Earl Ro; 1887 – 1969. (11)

DEWITT:

Francis, son of D. & A.; d. Jul 15, 1874, age 3m 5d. (9)

DICKEY:

Stanton, son of J. & L.; d. Apr 14, 1870; age 1m 3d. (7)
William; Jun 1, 1813 – Jul 14, 1898. (8)
Melinda, wife of Wm.; Jul 13, 1819 – Aug 4, 1876. (8)
Hiram A., son of W. & M.; d. Dec 5, 1872; age 10y 1m 19d. (9)
Sarah A., dau of W. & M.; d. Nov 13, 1862; age 17y 1m 25d. (9)
Harriet, dau of W. & M.; d. Jun 2, 1862; age 6y 1m. (9)

DORRIS:

Thomas; (no dates); Kenney's Co IL Mtd. Rangers; Black Hawk War. (5)

DOWEN:

Mary E. Stockton, wife of Jacob; b. Oct 7, 1833; d. Nov 27, 1891. (6)

DUNBLAZER:

Locy E. (Lucy?); 1886 – 1945. (3)

Bernice E., 1889 – 1974. (3)

EASTON:

Freddie W., son of -----; d. Dec 20, 1869; age -----. (7)

EDWARDS:

Emily; Feb 9, 1817 – Apr 22, 1894. (9)

Joseph L.; Feb 11, 1852 – May 12, 1891. (9)

ELWELL:

Thomas D.; 1835 – 1916. (9)

Ellen E.; 1839 – 1922. (9)

Fannie M., dau of T. & E.; d. Mar 22, 1888; age 22y 8m 27d. (9)

EMMERSON:

Ella, dau of A. & P.; d. Sep 15, 1862; age 1y 6m. (9)

ENDRES:

Glade, son of G.W. & Elvie; b. Jan 17, 1897; d. Jun 6, 1905. (1)

Mary E., wife of George W.; 1870 – 1929. (1)

Martha E., dau of G. & W.; d. Jul 15, 1871; age 1y 11m 16d. (7)

ENGLISH:

John, consort of Hannah M.; d. Aug 26, 1852; age 41y 3m 15d. (5)

Mary J., dau of J. & H.M.; d. Dec 11, 1852; age 8m 23d. (5)

EVANS:

Nancy, wife of J.G.; d. Dec 13, 1863; age 37y 9m 28d. (5)

FAUCETT:

William H.; Jan 1, 1860 – Jul 16, 1924. (1)

Lydia A. Grim, wife of Wm.; Oct 7, 1861 – Mar 20, 1943. (1)

Adam F.; Dec 8, 1854 – Jul 2, 1902. (1)

FISH:

Maretta C. Pile; b. Mar 4, 1855; md. E. Fish; Jun 5, 1879; d. Sep 18, 1895. (4)

FORRISTER:

Inf child of J.H. & A.; (no dates). (3)

FOWLER:

Jesse Jones; 1878 – 1902. (5)

Ola Salisbury; 1877 – 1913. (5)

Thomas; d. Mar 6, 1893; age 43y 6m 17d. (5)

Jesse B.; 1878 – 1906. (5)

Melissa; 1854 – 1926. (5)

FRIDAY:

Silva M.; Jan 26, 1975 – Feb 7, 1975. (12)

GARDNER:

Gertrude; 1887 – 1967. (2)

Jesse O.; 1883 – 1949. (2)

GATES:

Flora; d. Jun 23, 1880; age 77y 2m 6d. (7)

Nathan; d. Oct 9, 1846; age 71y. (7)

GINGERICH:

Jacob H.; 1854 – 1918. (1)

Clara C., wife of Jacob; 1856 – 1913. (1)

GRAVES:

Infant child of W.T. & S.J. (9)
William T.; Oct 26, 1828 – Mar 25, 1906. (9)
Susan J.; Aug 25, 1842 – Apr 29, 1879. (9)

GRAY:

Lyle A.; 1909 – 1954. (11)
Catherine; Jun 6, 1917 – Apr 2, 1925. (11)
Blanche; 1888 – 1960. (11)
George A.; 1886 – 1947. (11)

GREEN:

James W., son of L. & M.E.; d. Apr 30, 1857; age 13m. (7)

GREENUP:

Simon W.; d. Jun 28, 1901; age 74y 4m 16d. (1)
Ollie E., wife of James W.; 1871 – 1928. (1)
James W.; 1868 -1958. (1)
John; d. Jan 13, 1874; age ----- (7)
Elizabeth H., wife of J.; d. Nov 17, 1844; age 44y 2m 11d. (7)
James F.; b. Nov 6, 1824; d. Oct 20, 1894. (7)
Elizabeth J. Vawter, wife of J.F.; b. Jun 6, 1833; d. Jan 18, 1906. (7)
Allen; b. May 4, 1861; d. Sep 9, 1862. (7)
Cornelia; b. Sep 25, 1862; d. Sep 30, 1864. (7)
Lygurgus; b. Feb 27, 1858; d. Jun 10, 1934. (7)
Maria A., wife of L.; b. Mar 30, 1861; d. Dec 23, 1890. (7)
Frank W., son of L. & M.; b. Jan 8, 1886; d. Feb 27, 1887. (7)
Lydia A., wife of Chas.; d. Oct 9, 1880; age 51y. (8)
Dora, dau of C. & L.; d. Nov 17, 1878, age 20y. (8)
William B.; Mar 3, 1827 – Feb 20, 1896; Corp. Co I 124th Il Inf. (9)
Emily J. Johnston, wife of Wm.; Feb 25, 1840 – Sep 16, 1923. (9)
James F.; d. Sep 10, 1862; age 23y 6m 11d; Corp. Co B 10th MO Inf. (9)
Ross; Jun 1, 1891 – Jan 5, 1949. (10)
Eleanor; 1862 – 1950. (10)
Albert; 1859 – 1934. (10)

GRESSER:

Mabel A.; Jun 30, 1879 – Jan 18, 1973. (3)

GRIGSBY:

Mary A., dau of S.B. & C.; d. Nov 4, 1862; age 2y 11m 17d. (5)
Cynthia, wife of S.B.; d. Nov 9, 1863; age 23y 9m 1d. (5)

GRILLS:

Etta Thomas; 1872 – 1948. (8)

GRIM:

Everett; 1890 – 1891. (2)
Michael W.; 1859 – 1917. (3)
Lucinda; 1869 – 1957. (3)
Jacob; 1826 – 1914; age 87y 9m 3d. (3)
Sarah Reedy, wife of J.; d. Feb 9, 1902; age 73y 2m 27d. (3)
Anna J., wife of John; d. Oct 28, 1847; age 33y 11m 27d. (3)

HAIST:

Verla L.; 1888 – 1970. (11)
Lillie M.; 1891 - (11)

HALL:

- Randolph; 1823 – 1898. (2)
- Almeda L.; 1829 – 1921. (2)
- Platt, son of R. & L.; d. Oct 11, 1868; age 20y 11m. (2)
- William; Sep 1, 1841 – Oct 10, 1879. (4)
- Ralph H.; Aug 12, 1887 – Oct 21, 1909; Enl. in the Navy, Feb 6, 1907. (5)
- Mary Wright; (no dates). (5)
- L. Grow; 1855 – 1924. (5)
- Eva V. Hammer, wife of Grow; d. Feb 12, 1888; age 32y 3m. (5)
- Beryl, dau of Grow & Eva; d. May 26, 1886; age 5d. (5)
- Bertie, son of F. & C.E.; d. Dec 31, 1879; age 2m 25d. (5)
- Douglas, son of S.M. & M.; d. Feb 2, 1857; age 2y 6m 11d. (6)
- Charley, son of S.M. & M.; d. Feb 6, 1861; age 2y 6m 13d. (6)
- Mary, consort of Joel; d. Aug 26, 1844; age 48y 8m 19d. (6)
- Millard Dewitt; b. Jan 5, 1851; d. Jul 2, 1930. (7)
- Clara Dilworth, wife of M.; b. Apr 11, 1852; d. Apr 9, 1926. (7)

HAMMER:

- Josiah Y.; Nov 14, 1843 – Apr 25, 1897; Corp. Co C 84th Regt. IL Vol Inf. (4)
- Mary C. Hall, wife of J.Y.; May 16, 1849 – Nov 19, 1919. (4)
- David Taylor; d. Nov 29, 1876; age 27y 8m 6d. (4)
- Clarence Aubrey, son of D.T. & C.G.; d. Nov 19, 1878; age 7y 21d. (4)
- R.M.; Nov 4, 1834 – Jan 7, 1895. (5)
- S.M. Bowles, wife of R.M.; Jan 10, 1841 – (no date). (5)
- Nancy, wife of J.E.D.; d. Oct 2, 1887; age 75y 7m 14d. (5)
- J.E.D.; d. Oct 5, 1889; age 80 5m 7d. (5)
- S.F.; d. Aug 15, 1888; age 57y 5m 12d. (5)
- James; d. Sep 18, 1866; age 25y 5m 16d. (5)
- Cornelius E.; d. Nov 15, 1879; age 24y 6m 11d. (5)
- James Hervey; Jun 21, 1840 – May 23, 1859; (erected to father & brother by Mary Ramp, Salem, OR) (6)
- George Washington; b. Oct 10, 1807, Washington Co. TN; d. Jan 6, 1841. (6)
- Millard F., son of R.N. & C.; d. Sep 5, 1854; age 1y 5m 1d. (7)
- Sarah F., dau of R.N. & C.; d. Aug 29, 1851; age 3y 13d. (7)
- Austin M.; infant; d. Nov 18, 1857. (7)
- Nelson D.; d. Aug 16, 1862; age 2m 7d. (7)
- Alonzo; d. Feb 10, 1861; age 2y 2m 6d. (7)
- Richard N.; d. Sep 12, 1858; age 40y 2m 11d. (8)
- Caroline C., wife of R.; d. Aug 21, 1866; age 39y 10m. (8)
- Frances M., dau of W.C. & M.M.; d. Sep 8, 1859; age ----. (9)
- Virginia T., dau of W.C. & M.M.; d. Aug 17, 1875; age 16y 13d. (9)
- Mary M., wife of W.C.; d. Sep 3, 1875; age 41y 7m 15d. (9)
- *Elizabeth; 1857 – 1950. (5)

HAMMOND:

- John B.; d. Jun 24, 1920; age 80y 9m 23d. (3)
- Iambia C., wife of James G.; Apr 2, 1854 – May 18, 1923. (3)
- James G.; d. Feb 2, 1931; age 81y 2m 25d. (3)
- Arethusa G., wife of James G.; Sep 7, 1854 – Jan 6, 1883. (3)
- Elizabeth, wife of Mickey; d. Mar 3, 1887; age 77y 6m 12d. (3)
- Mickey T.; d. Jan 29, 1880; age 85y 4m 1d; b. Jul 28, 1794; Pvt Capt. W. King's Co, E TN Militia; War of 1812. (3)
- Willard R., son of S.D. & C.M.; 1881 -1882. (4)
- Wade B., son of S.D. & C.M.; 1878 – 1893. (4)

HAMMOND (Cont'd):

Carcena Mariah, wife of S.D.; 1853 – 1919. (4)
Samuel Duff; 1842 – 1924. (4)
O. Roy; 1884 – 1958. (9)
M. Mae; 1887 – 1949. (9)
Ralph O.; 1892 – 1973. (9)
Marie Lance; 1894 – 1973. (9)
James Oren; 1881 -1962. (10)
Nina Chapman; 1883 – 1964. (10)
John Urban; 1879 – 1956. (10)
Nellie A.; 1888 – 1968. (10)
Duff; 1887 – 1953. (10)
Leslie A.; 1875 – 1935. (11)
Myrtle M.; 1877 – 1948. (11)
Keith W.; 1908 – 1969. (11)

HARLAN:

William M.; Feb 17, 1834 – May 22, 1888. (2)
C. Hester, wife of Wm.; Apr 1, 1836 – Mar 9, 1915. (2)
Frank E.; 1864 – 1927. (4)
Della A.; 1869 – 1924. (4)
Aubrey J.; 1907 – 1925. (4)
Mary, wife of Wesley; Jun 7, 1827 – Nov 2, 1895. (5)
Wesley; Feb 3, 1805 – Jan 17, 1874. (5)
Nancy, wife of Wesley; Apr 5, 1803 – Mar 24, 1864. (5)
James W., son of W. & N.; d. at Benton Barracks, MO, Jun 30, 1863; age 20y 7m 22d; Co B 10th MO Inf. (5)
Marcus L. "Mark"; 1839 – 1879; Co C 84th IL Inf. (5)
Catherine L., wife of M.L.; 1845 – 1902. (5)
Clifford, son of M.L. & C.L.; 1877 – 1878. (5)
Fred; 1867 – 1961. (5)
Sarah; d. Mar 8, 1846; age 65y 2m 21d. (7)
Jacob; d. Aug 19, 1839; age 66y 4m 24d. (7)
Mary A., wife of S.J.; 1869 – 1895. (7)
George T.; Dec 29, 1827 – Dec 18, 1908. (8)
Alitha C. Yokum, wife of Geo.; Oct 17, 1832 – Sep 12, 1925. (8)
Alma; Jul 18, 1870 – Jul 20 1906. (8)
Horace A.; 1858 – 1860. (8)
Leroy P.; d. Dec 28, 1886; age 27y 3m 19d. (8)
Infant dau of G. & A.; d. Jul 5, 1872. (8)
Infant son of G. & A.; d. Apr 6, 1864. (8)
Virginia W., dau of W.H. & D. O.; Oct 18 – 22, 1913. (10)
William H.; 1891 – 1973. (10)
Daisy O.; 1891 – 1971. (10)
Inez; Dec 12, 1892 – Nov 29, 1909. (10)
Nellie Atherton, wife of A.S.; 1871 – 1956. (10)
Ambrose Stephen; 1865 – 1955. (10)

HARSHMAN:

Samuel; May 18, 1822 – May 3, 1897; age 74y 11m 15d. (2)

HEATON:

William A.; 1869 – 1939. (11)
Dora B.; 1878 – 1947. (11)
Edward E.; 1901 – 19----. (11)

HENSLEY:

William J., son of John & Margaret; d. at Bowling Green, KY Dec 18, 1862; age 21y 2m 24d; belonged to U.S.Army, 2nd Corp of Co C 84th Reg IL Vol. (9)
Martha A., dau of J. & M.; d. May 3, 1857; age 3m 10d. (9)
Lincoln N., son of J. & M.; d. Feb 14, 1862; age 1y 7m 7d. (9)

HERLOCKER:

Josiah; 1807 – 1890. (3)
Margaret; b. 1815; d. Dec 28, 1887; age 72y 24d. (3)

HERNDON:

Granville C., son of M.W. & M.J.; d. Jun 11, 1864; age 7y 8m 11d. (4)
Atis A., son of M.W. & M.J.; d. Jul 10, 1867; age 4m 21d. (4)
Manson W.; Oct 18, 1820 – Dec 11, 1899. (4)
Margaret J., wife of M.W.; Jul 30, 1829 – Nov 28, 1899. (4)
Lizzie, wife of Marcellus; Sep 28, 1860 – Feb 17, 1900. (4)
E. C.; 1850 – 1918. (4)
E.L., wife of E.C.; 1853 – 1924. (4)
Maggie; 1879 – 1879. (4)
Grace; 1880 – 1880. (4)
Edith; 1881 – 1900. (4)
Iva; 1884 - 1900. (4)
Frank; 1889 – 1894. (4)
Belle Moyers, wife of B.D.; d. Oct 12, 1890; age 25y 8m 2d. (5)
C.D.; 1885 – 1956. (5)
Mary, wife of Howard; Feb 18, 1876 – Oct 1, 1900. (5)
Howard, husband of Mary McFarland; Nov 9, 1876 – Jan 29, 1953. (5)
(to this union 2 children were born; Mildred – 1898 & Carl – 1899)
Allen A.; Sep 9, 1831 – Feb 20, 1862; Co C 84th IL Inf. (9)
Frances M. Cave, wife of A.A.; Nov 8, 1830 – Jul 14, 1893. (9)
Theodore Albert; Nov 16, 1853 – Sep 7, 1938. (9)
Paulina Frances, wife of T.A.; May 8, 1855 – Dec 10, 1923. (9)
Bulah Anna; Mar 3, 1885 – Oct 14, 1887. (9)
Sterl Arthur; Mar 19, 1888 – 1965. (9)
Nolah Fern; Mar 19, 1888 – Sep 17, 1914. (9)
William H.; 1857 – 1914. (9)
Nettie F.; wife of M.O.; Oct 21, 1865 – Aug 28, 1917. (10)
Manson O.; Jun 15, 1861 – Jan 11, 1913. (10)
Dale B.; 1903 – 1962. (10)
Orville O.; 1889 – 1968. (10)
Clara G.; 1893 – 1972. (10)
Manson O., son of O.O. & C.G.; 1914 – 1915. (10)
Ruth L.; 1892 – 1970. (10)
Harvey M.; 1891 – 1968. (10)
Nellie M.; 1894 - (10)
H. Lee; 1893 – 1961. (10)
Helen E.; 1894- 1955. (10)

HERNDON (Cont'd):

Fred E.; 1887 – 1971. (10)

Wilbur A.; 1873 – 1940. (10)

Herbert J.; Aug 21, 1892 – Jan 9, 1965; IL Wagoner, 54th Ammo Train CAC WWI. (10)

HOLLIDAY:

Alexander C.; Feb 19, 1825 – Apr 6, 1884. (4)

Anne Elizabeth, wife of Alex.; May 15, 1832 – Dec 3, 1900. (4)

Frankie, son of O.L. & R.A.; d. Aug 4, 1892; age 6m. (4)

Oscar L.; Jan 21, 1866 – Apr 10, 1903. (4)

Rosa A.; Feb 25, 1861 – Apr 17, 1926. (4)

HOLLY:

Lorinda, wife of Isaac; d. Apr 24, 1889; age 42y 7m 6d. (2)

Infant son of Isaac & Lorinda; d. Nov 30, 1871. (2)

Infant dau of I. & L.; d. Jan 25, 1875. (2)

Infant son of I. & L.; d. Nov 15, 1877. (2)

Isaac; d. Jul 5, 1900; age 61y 3m 6d. (2)

HORN:

Mary; d. Aug 27, 1892; age 56y 6, 17d. (5)

HUNTER:

John E., son of Sam'l & Catharine; d. Jun 12, 1867; age 33y 4m 11d. (5)

ISAACS:

Minerva, dau of I. & M.; d. Feb 4, 1865; age 13y 10m 16d. (5)

JANES:

Linda, wife of Henry E.; d. Mar 19, 1894; age 26y 6m 27d. (5)

Henry E.; 1865 – 1943. (5)

JEFFERY:

Mary, wife of R.H.; Dec 23, 1813 – Apr 15, 1885. (7)

Sarah Leona, dau of R.H. & M.S.; d. Sep 14, 1868; age 9y 9m 10d. (7)

JENNINGS:

Earle L.; Sep 13, 1885 – Sep 19, 1891. (5)

Ellen Belle; Apr 11, 1857 – Apr 23, 1889. (5)

Martin Luther; Feb 17, 1857 – Feb 4, 1923. (5)

James M.; Jan 5, 1818 – May 21, 1891. (8)

Lewis T.; d. Jan 22, 1866; age 12y 2m 19d. (8)

Infant dau; d. May 15, 1856; age 29d. (8)

(Latter 2 were children of J.M. & G.)

William H.; d. May 9, 1877; age 28y 1m 25d. (8)

JOHNSON:

Flora M.; 1894 --- (10)

Ernest J.; 1892 – 1958. (10)

JOHNSTON:

Absalom; d. Jun 24, 1890; age 88y 1m 22d. (8)

Susan A. Jerome, wife of A.; d. May 3, 1885; age 73y 18d. (8)

Mary M., dau of A. & S.A.; d. -----; age -----. (8)

Alice, dau of N.H. & M.A.; d. Sep 13, 1881; age 10m 11d. (8)

Esther Jane, dau of A. & S.; d. Jun 1, 1869; age 17y 19d. (8)

N[athan].H.; May 21, 1848 – Apr 4, 1930. (9)

Mary Alice, wife of N. H; Apr 4, 1841 – May 28, 1909. (9)

JONES:

Mary J. Standard, wife of J.B.; Nov 24, 1849 – Nov 28, 1886. (5)
Samuel B., son of J.B. & M.J.; d. Sep 26, 1870 – Feb 5, 1871. (5)
Perry C.; d. May 13, 1901; age 58y 11m 1d; Co B 16th IL Inf. (5)
Julia A. Cox, wife of P.C.; d. Oct 24, 1884; age 39y 9d. (5)
Amanda J., wife of J.W.; Sep 8, 1851 – Jul 6, 1898. (5)
Vertie V., dau of J.W. & A.J.; Jan 28, 1870 – Nov 9, 1896. (5)
Ira B., son of J.W. & A.J.; Feb 8, 1869 – Feb 27, 1869. (5)
Frank A.N., son of J.W. & A.J.; Oct 16 – 23, 1887. (5)
Doric, son of S.R. & H.; d. Dec 17, 1853; age 5y 2m. (6)
Infant son of S.R. & H.; d. Feb 23, 1853. (6)
Infant dau of S.R. & H.; d. Mar 18, 1851. (6)
Infant son of S.R. & H.; d. Apr 1, 1855. (6)
Elizabeth, wife of J.; d. Jul 3, 1883; age 83y 10m 2d. (6)
Jonathan; d. Aug 12, 1847; age 46y 11m 1d. (6)
Isaac N.; (no dates); Corp. Co B 16th IL Inf. (6)
Newton, son of T. & C.J.; d. Sep 27, 1852; age 1y 6m 5d. (7)
Thomas H.; d. Dec 22, 1855; age ----- (7)
N.B.; d. Jul 18, 1866; age 35y 10m. (7)
James H.; d. Mar 11, 1857; age 60y. (7)

KELLY:

John W.; Aug 7, 1842 – Oct 25, 1915. (1)
Elizabeth; Mar 17, 1845 – Jan 8, 1921. (1)
Elsie Lee; Jun 12, 1889 – Oct 1, 1889. (1)
Maurice; 1900 -1938. (11)

KERR:

Lena L. Thomas, wife of Edward G.; b. Sep 7, 1870; d. Aug 26, 1891. (2)
Edward G.; 1868 – 1936. (2)
Kate Carlin; 1875 – 1951. (2)
Claybourn T.; Nov 5, 1825 – Mar 14, 1895; Sgt. Co F 84th IL Inf. (3)
Mary E., wife of C.; Jun 24, 1832 – Jan 19, 1912. (3)

KILLINGSWORTH:

Mary E., dau S. Walker; 1881 – 1960. (6)

KIMBLE:

Emma Skien; 1905 – 1972. (4)
W. Wayne; 1903 – 1954. (4)

KYLE:

James H., son of J.A. & M.A.; d. Aug 22, 1866; age 1y 9m 21d. (7)
Nancy C., dau of W.H. & Z.A.; d. Jun 22, 1858; age 12y 3m 19d. (7)
Mary E., dau of W.H. & Z.A.; d. Jul 27, 1842; age 1y 5m 17d. (7)
Sarah A.B.M., wife of L.K.; d. Jul 22, 1856; age 25y 11m 22d. (8)

LANCE:

Olive; 1863 – 1876. (3)

LAUGHLIN:

George G.; Dec 18, 1850 – Oct 10, 1888. (1)
Amelia C., wife of Geo.; Nov 4, 1851 – Jun 28, 1921. (1)
Forrest V.; b. & d. Jul 4, 1882. (7)

LEFTRIDGE:

- Philip M.; 1844 – 1926. (1)
- Sarah J.; 1851 – 1927. (1)
- Joseph H.; 1888 – 1889. (1)

LEIGHTY:

- Samuel; d. Nov 24, 1908; age 57y 8m 12d. (2)
- Florence E., wife of Sam'l; Oct 8, 1855 – Feb 7, 1936. (2)
- Bessie Blanche, dau of S. & F.; Sep 19, 1881 – Dec 2, 1910. (2)
- Grace R.; 1884 – 1965. (2)
- George; May 17, 1855 – Mar 15, 1932. (3)
- Martha F. Wetzell, wife of Geo.; May 2, 1865 – Feb 8, 1951. (3)
- Claude W., son of G. & M.; Oct 22, 1883 – Jan 29, 1901. (3)
- Cora M., dau of G. & M.; Oct 15, 1887 – Aug 31, 1921. (3)
- Joseph M.; Feb 18, 1824 – Sep 18, 1901. (3)
- Rebecca, wife of J.M.; Feb 26, 1824 – Sep 3, 1906. (3)
- Leroy; 1852 – 1926. (3)
- Jane E., wife of L.; 1857 – 1928. (3)
- Edgar H.; 1891 – 1891. (3)
- Jesse O.; 1879 – 1952. (9)
- Coral; 1885 – 1956. (9)
- Vera I.; Dec 21 – 25, 1918. (9)

LOWNES:

- E. Roy; 1887 – 1927. (1)
- Olive; 1886 – 1953. (1)
- Seleucus S.; Nov 3, 1850 – Jan 30, 1931. (1)
- Adaliza; 1858 – 1934. (1)
- Rowena B., dau of C.R. & C.B.; d. Aug 21, 1893; age 1y 9m 13d. (1)
- Clementine; 1845 – 1923. (2)
- Julia Ann; d. Apr 27, 1900; age 57y 9m 17d. (2)
- Emmor B.; Jun 19, 1822 – Jul 25, 1911. (2)
- Rebecca, dau of E.B. & J.A.; d. Nov 8, 1885; age 22y 6m 15d. (2)
- Mary Ida, dau of E.B. & J.A.; d. Feb 24, 1895; age 34y 20d. (2)

LOY:

- Hiram; Nov 2, 1812 – Jan 10, 1900. (2)

MACLEAN:

- Mary J. Chandler, wife of Dr. J.M.; Mar 5, 1854 – Jun 22, 1887; buried at Suttgart, Arkansas (6)
- J.M.; May 5, 1843 – Nov 27, 1879; Dallas City, IL (6)

MARRS:

- Abijah T.; b. Tompkinsville, KY, Feb 12, 1831; d. Pennington Pt., IL, Jan 29, 1900. (8)
- Elizabeth B.; b. Pennington Pt., IL, Jan 15, 1835; d. Sciota, IL Oct 25, 1913. (8)
- Orie A., dau of A.T. & E.B.; d. Jan 25, 1879; age 14y 4m 2d. (8)
- Alfred T., son of A.T. & E.B.; d. Apr 29, 1860; age 2y 4m 11d. (8)

MARSHALL:

- R. Philip; Oct 2, 1901 – Dec 20, 1972. (11)

MARTIN:

- Samuel A., son of S. & E.J.; Mar 6, 1862 – Mar 5, 1863. (9)

MERRILL:

- Alice Lucille, dau of J.L. & M.; Feb 3, 1895 – Aug 14, 1895. (1)
- Eona Grace, dau of J.L. & L.; d. Jun 23, 1898; age 1y 1m 8d. (1)

MILLER:

John; 1840 – (no date). (3)
Jacueline, wife of J.; 1844 – 1908. (3)
A.A.; d. May 5, 1902; age 78y 2m 5d. (3)
Francis, wife of A.A.; d. Dec 21, 1887; age 82y. (3)

MINER:

Herbert H., son of A.J. & N.L.; Jan 23, 1874 – Dec 29, 1878. (4)
Hattie Williams; 1854 – 1931. (8)

MITCHELL:

Emma E., wife of S.; d. Mar 30, 1878; age 40y 5m 7d. (7)
Willie, son of S. & E.; d. Aug 15, 1863; age 15d. (7)
Gaylan, son of Wm. G. & Achsa B.; 1934 – 1942. (11)
Hilda E.; 1888 – 1955. (11)
Ira; 1887 – 1954. (11)

MONTGOMERY:

Infant son of J.L. & M.J.; d. Jul 27, 1878; age 10m 7d. (1)
Martha, wife of J.L.; d. Aug 8, 1887; age 42y 8m 29d. (1)
James; 1858 – 1923. (2)
Robert T.; Oct 16, 1859 – (no date). (3)
Aretta, wife of Robt.; Jun 4, 1860 – Apr 28, 1900. (3)
A.J.; Aug 17, 1829 – Jul 13, 1913. (3)
Martha J., wife of A.J.; Jan 14, 1827 – Aug 29, 1900. (3)
L.A.; Apr 12, 1862 – Jan 8, 1917. (4)
Susie Reedy, wife of L.A.; Nov 7, 1861 – Sep 5, 1927. (4)
Infant son of L.A. & S.; Dec 3, 1882. (4)
Dora May; Feb 9, 1893 – Apr 7, 1893. (4)
Lena McFadden; 1886 – 1919. (4)
Minnie A.; Oct 18, 1885 – Aug 15, 1970. (10)
Roy H.; Sep 8, 1886 – Jan 11, 1963. (10)

MOORE:

Edwin; 1862 -1923. (3)
Elosia; 1859 – 1944. (3)
Thomas J.; 1834 – 1920. (3)
Sarah A., wife of Thos.; 1838 – 1931. (3)
James W., son of J.D. & E.B.; d. Dec 14, 1863; age 2y 8m 5d. (8)
Elizabeth M., dau of W. & E.; d. Dec 19, 1859; age 19y 5m 4d. (8)
Mary W., dau of W. & E.; d. Dec 11, 1847; age 20y 10m 11d. (8)
Katharine M., dau of W. & E.; d. Jul 2, 1840; age 7y 4m 22d. (8)
Elizabeth, wife of Wm.; d. Jan 21, 1875; age 73 8m 15d. (8)
William T., son of J.W. & M.; d. Jul 19, 1866; age 29y 15d; Corp. Co B MO Inf. (8)

MORAN:

Willie, infant son of T.G. & M.E.; d. Feb 23, 1885; age 8d. (2)

MORROW:

Olive V., dau of T.A. & S.A.; d. Feb 6, 1906; age 6m 18d. (1)
Esther A., wife of Andrew; d. Jun 4, 1868; age 65y 9m 19d. (8)
David E., son of B.C. & R.; d. ----, 1868; age ----. (8)
Benjamin F., son of B.C. & R.; d. Jan 13, 1865; age 3m 9d. (8)
Benjamin C.; Feb 4, 1830 – Sep 20, 1910. (8)
Roxselany France, wife of B.C.; Mar 11, 1837 – Nov 6, 1925. (8)

MULLEN:

- Ethel; 1891 – 19---. (10)
- Henry; 1891 – 1962. (10)
- Mary Maxine, dau of Henry & Ethel; Oct 7, 1916 – Jul 17, 1919. (10)

MC CARTNEY:

- Perry J.; 1885 – 1966. (2)

MC DONALD:

- Infant dau of W.H. & C.M.; Jul 5, 1886. (2)

MC FADDEN:

- John W.; Oct 15, 1849 – Feb 20, 1912. (4)
- Nancy Hills, wife of J.W.; Sep 23, 1848 – Mar 1, 1913. (4)
- Samuel D.; Nov 2, 1822 – Jun 9, 1884; Erected by his beloved wife, Rosey. (5)
- Rosey; Sep 29, 1828 – May 26, 1898. (5)
- Cora; d. Mar 2, 1885; age 2m 7d. (5)
- Nora; d. Feb 24, 1885; age 1m 20d. (5)
- (Above were twin daughters of J.W. & Nancy).

MC GAUGHEY:

- Thomas Walker, M.D.; 1869 – 1904. "Greater Love Hath No Man Than This, That A Man Lay Down His Life For His Friends". (8)
- Elizabeth Harlan; 1873 – 1940. (8)
- Nellie; Jun 2, 1896 – Jun 9, 1896. (8)

MC KINZEY:

- Randall L., son of Lawrence H. & Kathryn L.; 1938 – 1967. (11)

MC MULLIN:

- Tillie E., dau of J. & L.; d. Mar 27, 1894; age 22y 3m 4d. (5)

NEFF:

- Henry S.; Mar 18, 1829 – Jun 8, 1874. (5)
- Rebecca, wife of H.S.; Feb 10, 1828 – Dec 11, 1881. (5)
- Nora Bell; 1877. (5)

NOONER:

- Mary Goldie; 1908 – 1955. (2)
- Tommie; 1934. NOTE: Name & year indicated by way of marbles embedded in concrete. (2)
- Mrs. Roland; d. Saturday, Apr 21, 1974; age 69y 2m 2d. (2)
- Daisy; 1880 – 1952. (3)
- Sherman B.; May 24, 1902 – Jan 3, 1959. (3)

OAKS:

- Elbridge G.; b. Jul 1830; d. Nov 1878. (9)
- Priscilla A. Miller; b. Feb 1836; d. Nov 1878. (9)

OLDFIELD:

- Mary Viola; Sep 6, 1867 – Mar 28, 1899. (4)
- Hilas A.; Mar 22, 1862 – Jan 20, 1930. (4)
- Guy Allen; Dec 22, 1891 – Jun 25, 1949; Cpl. 163rd Inf, 41st Div WWI. (4)
- Frances May; d. Aug 8, 1964. (4)

OLDKNOW:

- Nellie V., wife of P.W.; Jan 13, 1874 – May 4, 1900. (1)

ORR:

- Son of D.C. & J.S.; d. Jun 1847. (7)

PATTERSON:

- W.J.; 1843 – 1919. (4)

PENNINGTON:

S.; b. Jun 10, 1784; d. Sep 20, 1859; age 85y. (6) Stewart
Richard W.; d. Dec 31, 1862; age 18y 9m 23d. He enlisted Aug 5, 1862 in Co C 84th Regt. IL Vol Inf & fell
While gallantly defending his post in the Battle of Stone River, Dec 31, 1862. (7)
Albert Stewart; son of R. & D.; d. Aug 11, 1852; age 10y 4m 27d. (7)
Elnora Frances; dau of R. & D.; d. Oct 3, 1852; age 8m 29d. (7)
Leander, son of S. & J.; d. Feb 19, 1854; age 8m 29d. (7)
Joshua J.; son of S. & J.; d. Sep 8, 1838; in the 11th year of his age. (7)
Jemima, wife of S.; b. Feb 24, 1788; d. Sep 22, 1852. (7)
James E., son of W. & J.; d. Sep 30, 1853; age 1y 6m 4d. (7)
Nicolas W., son of W. & J.; d. Oct 12, 1853; age 3y 8m 6d. (7)
Richard; d. Oct 26, 1891; age 77y 9m 2d. (8)
Delilah Shannon, wife of Richard; d. Dec 4, 1892; age 82y 2m 7d. (8)
Charles W.; d. May 5, 1875; age 38y 8m 8d; Corp. Co 3 84th IL Inf. (9)
Richard W.; Jul 21, 1930 – Jul 26, 1970; IL Lt Col 8th TAC Ftr Wg AF Korea Vietnam AFCM.

PERDUE:

Hazel Woods, wife of Loren; 1904 – 1935. (11)

PILE:

Hannah B., wife of W.B.; d. Sep 29, 1885; age 65y 1m 6d. (4)
George R.; d. Dec 12, 1884; age 28y 7m 12d. (4)
James M., son of W.B. & Hannah; d. May 14, 1884; age 24y 14d. (4)
Nancy J., dau of W.B. & H.B.; d. Mar 25, 1877; age 31y 1m 21d. (4)
John A.; b. Jul 29, 1848; md. Maretta C. Lambert, Oct 20, 1872; d. May 2, 1875. (See FISH, Maretta C. Pile) (4)
Flora I., dau of W.B. & H.B.; d. Aug 26, 1871; age 19y 4d. (4)
Stephen A.O., son of W.B. & H.B.; d. Oct 15, 1853; age 2y 11m 22d. (7)
Infant son of W.B. & H.B.; b. & d. Jan 3, 1845. (7)
Rhoda Abbott, dau of W.B. & H.B. Pile; d. Aug 24, 1881; age 19y 2m 27d. (4)

PLEDGE:

James; Oct 21, 1818 – Apr 7, 1900. (4)
Sarah, wife of Jas. Oct 13, 1819 – Feb 12, 1891. (4)

PLOWMAN:

Katie, dau of A.B. & P.A.; 1879 – 1881. (2)
Andrew, son of C. & L.; d. Nov 1, 1861; age 1y. (2)

POINTER:

Jennie M., wife of George; Mar 22, 1847 – Jan 25, 1899. (7)
William; Nov 30, 1812 – Jun 30, 1903. (7)
Elizabeth, wife of Wm.; d. Jul 11, 1892; age 76y 2m 1d. (7)
Ella L., dau of R. & F.; d. May 16, 1868; age 1d. (7)
Etta E., d. Feb 6, 1873, age 3y 1m 27d. (7)
Mary E., d. Jan 28, 1869; age 1y 8m 13d. (7)
(All were children of Robert & Flora)
William C.; 1879 – 1949. (7)
Ollie M.; 1888 – 1932. (7)
Robert C.; 1838 – 1932. (7)
Flora Gates, wife of Robt.; 1845 – 1926. (7)

PONTIOUS:

- Simon; Jun 22, 1825 – May 30, 1899. (3)
 - Elizabeth, wife of Simon; Jul 22, 1825 – Feb 6, 1905. (3)
 - Ann M.; Mar 8, 1850 – Jan 21, 1919. (3)
 - Brucie, son of L.J.; d. Feb 17, 187--; age 11m 12d. (3)
 - Arah, dau of B. & A.; d. Mar 24, 1875; age 1y 2m 16d. (3)
 - Byron (no dates). (3)
 - Ambrosia (no dates). (3)
 - Ralph (no dates). (3)
- (Inscribed on a single stone: "Ashes of Byron, Ambrosia, & Ralph").

PONTIUS:

- Brower B.; 1878 – 1960. (9)
- Eve Anna; 1877 – 1950. (9)
- Austin; 1853 – 1937. (9)
- Clara J.; 1859 – 1940. (9)
- Clifford A., son of L.F. & F.; Sep 26, 1876 – Aug 11, 1858. (9)
- Florence; Jan 7, 1849 – May 13, 1940. (9)
- Lyman F.; Oct 23, 1848 – Mar 14, 1936. (9)

PORTER:

- Albert E., son of C.E. & M.E.; Jan 1, 1874 – Nov 17, 1891. (2)
- Joseph E.; Jul 9, 1821 – Aug 9, 1886. (2)
- Susan M.; Feb 26, 1822 – Oct 4, 1913. (2)
- Royal A.; 1877 -1966. (3)
- Fleanore L.; 1883 – 1966. (3)
- Mary E., wife of George E.; Nov 27, 1852 – Apr 20, 1883. (3)
- Infant of G.E. & M.E.; Mar 24, 1879. (3)
- John Dexter; d. Jun 6, 1867; age 31y 9m 6d. (5)
- George B., son of L. & C.; d. May 27, 1856; age 9y 7m 25d. (6)
- Laura B., dau of L. & C.A.; d. Feb 1, 1866; age 7y 6d. (6)
- Lester W., son of J.E. & S.M.; killed at Memphis; Co I 137th IL Inf. Aug 21, 1864; age 19y 6m. (6)
- Arabella, dau of J.E. & S.M.; d. Aug 21, 1859; age 3y 1m 28d. (6)

POTTER:

- Alice Chandler, wife of A.D.; Oct 25, 1863 – Jan 25, 1896. (6)

PRICE:

- Joe H.; 1889 – 1967. (11)
- Lyda Maria; 1898 – 1932. (11)

PROVINE:

- Margaret I. Hammer; Aug 28, 1879 – (no dates). (5)
- George E.; Nov 9, 1880 – Aug 20, 1957. (5)

PUGH:

- Henry G.; 1897 – 1966. (12)
- Cleo A.; 1900 - . (12)

PUTT:

- Maggie L.; 1875 – 1921. (9)
- Josephine, wife of J.F.; Oct 29, 1869 – Jan 17, 1897. (9)

QUIGHLEY:

- Merle D.; 1905 – 1969. (11)
- Mary Stella; 1884 – 1944. (11)
- Fay; 1885 – 1965. (11)

RABY:

- S. Wheeler; 1877 -1926. (3)
- Simon; May 6, 1832 – Jul 24, 1908. (3)
- Sarah E. Brookman, wife of Simon; Jun 3, 1838 – May 31, 1903. (3)

REED:

- Rev. Fred; 1883 – 1960. (11)
- Sarah E.; 1881 – 1956. (11)

REEDY:

- Dale D., son of H.R. & M.E.; d. Sep 2, 1897; age 1y 1m 22d. (4)
- Glade M., son of H.R. & M.E.; d. -----, 1894; age -----. (4)
- Fred L., son of H.R. & M.E.; d. -----; age -----. (4)
- Michael G.; Aug 1, 1830 – Jan 29, 1906. (4)
- Mary N., wife of M.G.; Nov 16, 1836 – Nov 16, 1915. (4)
- Elizabeth; 1805 – 1885. (4)
- Jacob S.; 1806 – 1880. (4)
- Infant son of M.G. & M.; d. May 20, 1877; age 3d. (4)
- Sallie H., dau of J.H. & M.J.; Jan 8, 1870 – Apr 22, 1901. (4)
- Mary E., dau of J.H. & M.J.; Nov 4, 1876; age 3y 2m 5d. (4)
- Alfred E., son of J. & M.A.; Jul 20, 1871 – May 16, 1874. (4)
- Maggie V. Rinehart, wife of Jacob; 1846 – 1931. (4)
- Infant of J. & M; 1878 – 1878. (4)
- Infant of J. & M.; 1880 – 1880. (4)
- Jacob; 1834 – 1921. (4)
- Mary A.; 1835 – 1880. (4)

REXROAT:

- Minnie, 1859 – 1930. (3)
- Winfield; 1854 – 1926. (3)
- Edith; 1880 – 1908. (3)
- Medelena; 1877 – 1877. (3)
- Mintie Alice; 1856 – 1925. (3)
- Lawson T.; 1851 – 1917. (3)
- Harvey; Mar 21, 1880 – May 18, 1880. (3)
- James M.; Jan 22, 1828 – Oct 6, 1914. (4)
- Jane, wife of J.M.; Nov 29, 1831 – Jul 25, 1892. (4)
- Ulyssis G., son of J.M. & J.; Aug 21, 1864 – Sep 25, 1865. (4)
- Granville J., son of J.M. & J.; Mar 26, 1867 – Mar 1, 1868. (4)
- Dovie I.; 1881 – 1945. (4)
- James W.; 1880 – 1936. (4)
- Ralph Claire; Nov 19, 1900 – Jan 6, 1901. (4)
- George C., son of S.R. & P.A.; d. Oct 12, 1867; age -----. (4)
- Mournin, wife of Peter; d. Sep 14, 1879; age 66y 8m 2d. (6)
- Peter; d. Mar 22, 1877; age 74y 10m 20d. (6)
- Tellus C.; 1864 – 1926. (10)
- Linnie Chandler, wife of T.C.; 1869 – 1925. (10)
- Florence May, dau of T.C. & L.; 1888 – 1917. (10)

RICHARDSON:

- Grace Hammer, wife of P.W.; Jul 15, 1867 – May 8, 1890. (3)

RILE:

- Frankie, son of W.H. & E.; d. 1861; age-----. (2)

RINEHART:

- Charles W.; 1850 – 1901. (5)
- Jane A.; 1852 – 1939. (5)
- Eliza, wife of Abner; d. Sep 2, 1873; age 59y 11m. (5)
- Ezra B.; Oct 3, 1844 – Nov 4, 1916. (10)
- Celia Frost, wife of E.B.; May 1, 1844 – Jan 17, 1931. (10)
- Charles H.; Oct 27, 1871 – (no date). (10)
- Grace Swango, wife of Chas.; Nov 8, 1873 – Dec 20, 1936. (10)

RITTER:

- Warren A.; 1857 – 1922. (1)
- Nellie, wife of Warren; 1861 – 1940. (1)
- Solomon; d. Mar 17, 1900; age 72y 8m 7d. (2)
- Nancy, wife of S.; d. Apr 17, 1899; age 68y 1m 9d. (2)
- William L.; 1849 – 1934. (3)
- Jane, wife of Wm.; 1850 – 1924. (3)
- Frank L.; 1884 – 1907. (3)
- Elmer B.; 1878 – 1886. (3)
- Nellie E., wife of Harry; Feb 24, 1890 – Feb 23, 1920. (10)

ROBINSON:

- Robert B., son of H. & M.J.; d. May 8, 1861; age 11m 8d. (7)
- Infant son of H. & M.J.; d. Oct 28, 1855. (7)
- John F., son of R. & M.; d. Sep 28, 1860; age 3y 9m 13d. (7)
- Martha, wife of R.; d. Apr 26, 1874; age 69y 4m 7d. (7)
- Robert, Sr., d. Aug 21, 1867; age 68y 5m 4d. (7)

RUSH:

- Thomas J., son of A. & N.; d. Nov 17, 1854; age 11m 11d. (7)

RUTH:

- Glen A.; 1890 – 1934. (11)
- Carrie M.; 1892 – 1963. (11)

RUTHE:

- Alex; 1853 – 1926. (4)
- Sarah; 1856 – 1911. (4)

SAUERS:

- Goldie B.; Sep 5, 1889 – Feb 4, 1952. (4)
- Ruth E., dau of Rudolph & Goldie; 1929 – 1929. (4)
- Rudolph M.; 1883 – 1949. (4)
- Mary Flossie Brundige, wife of R.M.; 1891 – 1918. (4)

SAYERS:

- John W.; 1879 – 1964. (11)
- Effie J., wife of J.W.; 1870 – 1956; md. 1899. (11)

SCHACK:

- Sadie, dau of N.H. & M.A. Johnston; 1871 – 1925. (9)

SCOTT:

- Mary D., dau of Wm. R. & G.; d. Oct 17, 1872; age 8y 1m 6d. (4)

SEABURN:

Thomas; Aug 24, 1830 – Dec 22, 1903. (3)
Anna E. Johnston, wife of Thos.; Sep 29, 1840 – Aug 31, 1919. (3)
Edwin J.; 1875 – 1942. (3)
Frank T.; 1867 – 1949. (10)
Ona Mae; 1867 – 1952. (10)
Ralph; 1890. (10)
Anna Mae; 1900. (10)
Evangeline E.; 1897 – 1960. (10)
Glenn T.; 1895 – 1964. (10)

SEYMOUR:

Emanuel; Mar 3, 1894 – Aug 29, 1972; IL PFC US Army WWI. (11)
Dovie Mae; Jul 9, 1895 – May 29, 1973. (11)

SHANNON:

Charles; d. Jun 8, 1852; age 70y 9m 20d. (7)
Rachel, wife of C.; d. Nov 17, 1848; age 60y 9m 19d. (7)

SHARON:

Clarence O.; 1880 – 1957. (11)
Alta Jane; 1882 – 1967. (11)
Louise W.; 1910 – 1972. (12)

SHOOP:

Rev. Wm. B.; b. Abingdon, IL, Jul 31, 1858; d. Apr 2, 1957. (8)
Luella B. Marrs, wife of Wm.; b. Pennington Point, IL, Dec 1, 1859; d. Spfld, IL, Apr 3, 1943. (8)

SIERER:

J. B.; d.. Dec 20, 1900; age 44y 6m 24d. (3)

SIMERAL:

Sylvia Gay, dau of A. & M.B.; d. Jun 20, 1901; age 5m 16d. (4)
Minnie; 1877 – 1969. (11)
Allen; 1873 – 1971. (11)

SKIEN:

Jack, son of Edgar & Ermie; 1908 – 1931. (9)
Mary E.; 1882 – 1964. (9)
Edgar J.; 1876 – 1956. (9)
Helen Lorraine, dau of Howard & Velma; 1935 – 1940. (10)

SMITH:

Harry W.; 1879 – 1941. (5)
Sarah C., wife of W.H.; d. Jul 30, 1892; age 37y 10m 24d.

SNYDER:

Louis E.; 1886 – 1969. (1)
Elsie Alice, dau of J. & H.; d. Aug 4, 1890; age 1y 1m 25d. (4)
Jacob; 1842 – 1924; Co M 1st OH Cav. (4)
Harriet, wife of J.; 1844 – 1943. (4)
Mariam M.; 1906 – 1947. (10)
Maude W.; d. Nov 17, 1973; age 89y 8m 12d. (10)
H. May; 1882 – 1971. (10)
Robert J.; May 11, 1917 – May 31, 1973; IL Tec 5 US Army WWII. (11)
Merle Dean; Oct 4, 1930 – Jul 9, 1937. (11)
George E.; 1872 – 1968. (11)
Elsie McIlhenny, wife of Geo. E.; 1875 – 1934. (11)
Alvin E.; 1875 – 1951. (11)
Helen G.; 1894 – 1964. (11)

SPENCER:

Delbert Wayne, son of E. & F.; Feb 10, 1918 – Jun 14, 1920. (10)
Leonard D.; 1930 – 1963. (10)

STALEY:

Robert; d. Aug 13, 1867; age 76y 8m 27d. (8)
Edith, wife of Robt.; d. Jan 8, 1868; age ----- (8)
Infant dau of E. & L.; d. ----- (8)
William; Dec 15, 1832 – Oct 31, 1892. (8)
Nancy A.; Nov 27, 1835 – Jan 21, 1927. (8)

STEPHENS:

Infant son of J.W. & C.V.; d. May 15, 1872; age 5d. (5)
Clarissa V., wife of James & dau of S. & M. Yocum; d. in the 30th year of her age; (no dates). (5)
Infant children of J. & C.V.; (no names nor dates). (5)
Catharine, wife of James; Apr 16, 1779 – Aug 24, 1864. (9)

STEVENS:

Albert B.; 1873 – 1915. (10)
Roxse L. Morrow, wife of A.B.; 1871 – 1967. (10)
Floyd B.; 1900 – 1974. (11)

STOCKMAN:

Clair Dean, son of W.W. & V.L.; Oct 9, 1932. (9)

STUCK:

John M.; 1891 – 1929; Iowa PVT 351st Inf 88th Div Co A AEF {WWI?} (9)
Wyllie Wootten, wife of John; 1885 – 1974. (9)

SULLIVAN:

Ray; 1879 – 1965. (11)
Lulu Rexroat, wife of Ray; 1883 – 1936. (11)

SWANGO:

Porter A., son of L.E. & J.E.; d. Oct 28, 1892; age 7y 25d. (3)
Orville R.; 1915. (3)
Loren E.; 1858 – 1933. (3)
Josephine E.; 1860 – 1955. (3)
Nellie May, dau of J.M. & S.A.; d. Oct 17, ?1877?; age ----- (3)
James M.; Jan 16, 1852 – Jan 15, 1931. (3)
Sarah Ann, wife of J.M.; Feb 10, 1854 – Jan 10, 1931. (3)
William Barnett; Sep 13, 1830 – Oct 5, 1894. (8)
Mary A., wife of Wm.; Jun 26, 1833 – Oct 16, 1904. (8)
Infant son of W.B. & M.A.; Apr 9, 1861 – Apr 30, 1861. (8)

SWEDELL:

Amira Carrison; 1856 – 1940. (11)
Frank L.; 1852 -1935. (11)
Stella Herndon; 1888 – 1949. (11)
William Ira; 1880 – 1930. (11)
Burdette H.; 1912 – 1967. (12)

SYLVESTER:

Albert J.; d. Oct 6, 1879; age 52y 8m. (4)
Charles M.; 1858 – 1908. (9)

THOMAS:

Catherine; Feb 3, 1810 – Feb 20, 1901. (1)
C.W.; May 25, 1834 – Jul 8, 1898; Corp. Co A IL Inf. (1)
Truman; Dec 22, 1873 – Jan 22, 1874. (1)
Howard; Dec 22, 1873 – Nov 5, 1894. (1)
(Latter 2 were twin sons of G.W. & N.E.)
Nelson A.; 1877 – 1950; CEF WWI Siberia, 1918-1919. (8)
John; Mar 18, 1842 – Feb 21, 1910; Co F 84th IL Vol. (8)
Margaret Jones, wife of John; Dec 15, 1853 – Jan 9, 1880. (8)
Mary E., dau of -----; d. Mar 23, 18----; age 7m 16d. (8)
Solomon; (no dates); Co I 58th OH Inf. (9)

THOMPSON:

Eliza A.; 1853 – 1938. (2)
Oliver; 1847 – 1919. (2)
Leroy, so of O. & E.; d. Jan 7, 1887; age 4m 9d. (2)

THROCKMORTON:

Jacob; d. Oct 1, 1880; age 50y 11m 29d. (2)
Mary A.; Mar 9, 1832 – Apr 6, 1921. (2)

TROTTER:

Wayne D.; 1902 – 1949. (11)
Harlan B.; 1930 – 1951. (11)
Hazel E.; 1902 – 1945. (11)
Simeon; 1863 – 1929. (11)
Rosetta; 1871 – 1951. (11)

TURNER:

Nellie Grim; 1877 – 1934. (2)
Charles W.; 1875 – 1954. (2)

TYSON:

Grove B.; 1874 – 1956. (11)
Olive D.; 1877 – 1967. (11)
Glenn M.; 1901 – 1948. (11)

VAIL:

John B., son of J.M. & E.J.; d. Feb 20, 1870; age ----. (6)
James M.; d. Dec 18, 1869; age -----. (6)
William D., son of J.M. & E.J.; d. Feb 10, 1845; age 2m 1d. (7)
Oral, son of H.W. & A.M.; d. Jan 1, 1882; age 5y 8m 13d. (7)
Birta, dau of H.W. & A.M.; d. Nov 30, 1878; age 6m 10d. (7)

VAN WEY:

Lettie A.; 1840 – 1926. (6)

VAWTER:

George A.; 1836 – 1933. (10)
Cora E.; 1881 – 1967. (10)

WAGNER:

Mary A.; 1904 – 1931. (11)
Riley L.; 1897 – 19----. (11)
Vergene Eloise; 1931 – 1931. (11)

WALKER:

Ellen E., wife of B.A.; Jun 6, 1859 – Feb 16, 1921. (4)
Burton A.; Oct 24, 1861 – Nov 16, 1928. (4)
Infant dau of S. & E.; d. Jun 21, 1863; age 2d. (6)
Solomon; Dec 28, 1826 – Dec 15, 1895. (6)
Elizabeth, wife of S.; May 22, 1831 – Jan 9, 1874. (6)
Anna, wife of S.W.; Nov 3, 1844 – Oct 26, 1924. (6)
Clara Harlan, dau of A.S. & N. Harlan; 1889 – 1973. (10 & 12)
Rickey Allen; 1878 – 1963. (12)

WARD:

Daniel D.; Apr 24, 1804 – Jul 18, 1880. (3)
Harriet N. Cooke, wife of D.D.; 1820 – 1861. (3)
Edgar Young, son of D.D. & H.H.; Sep 1860 – Apr 1863. (3)

WATERS:

Mariah M., wife of G.B.; d. Feb 26, 1876; age 47y 2m 1d. (3)
Gideon B.; d. Sep 15, 1885; age 66y 22m 4d. (3)
Augustus; Sep 15, 1833 – Apr 16, 1901. (5)
Celestia Butler, wife of A.; Jan 5, 1841 – 1923. (5)
George H.; 1861 – 1922. (5)

WATSON:

Archibald; 1830 – 1879. (3)
Ettie May; d. 1879. (3)
Infant dau of T. & M.; Sep 24, 1875. (3)
Cathiren J., dau of A. & L.; d. Sep 2, 1861; age 1y 7m. (5)
Hugh; d. May 19, 1863; age 34y 9m 5d. (5)
Jane McMillan, wife of Hugh; 1796 – 1870. (5)
Thomas D., son of Alexander & Isabella; Apr 22, 1857 – Dec 23, 1881; age 24y 8m 1d. (6)
Albert T.; 1872 – 1959. (10)
Maggie Cameron, wife of A.T.; 1880 – 1927. (10)

WEAVER:

Margaret R.; 1895 – 1949. (8)

WELCH:

William J.; 1856 – 1931. (3)
Clara A.; 1856 – 1916. (3)
Guy F.; 1878 – 1934. (3)
Ethel; 1884 – 1960. (3)
Oral C., son of Wm. & Clara; May 30, 1879 – Aug 17, 1895. (3)

WEST:

Matthew; d. Nov 1, 1856; age 79y 9m 16d. (7)

WETSEL:

Minnie Alma, dau of J.B. & S.A.; d. Sep 14, 1870; age 1m 3d. (5)

WILCOX:

John B., son of T.H. & P.A.; d. Oct 20, 1881; age 24y 10m 5d. (5)
William, son of T.H. & P.A.; d. Jul ----; age ----. (5)
Delia, dau of J.M. & M.Z.; d. Mar 20, 18---; age -----. (5)
Lee, son of J.M. & M.Z.; d. Jan -----; age -----. (5)
John M.; Mar 19, 1826 – Jul 12, 1895. (6)
Mary Z.V., wife of J.M.; Jul 12, 1834 – Mar 23, 1882. (6)
George T.; d. Feb 21, 1894; age 38y 1m 12d. (6)

WILKINS:

William C.; 1838 – 1917. (4)
Susannah R.; 1836 – 1919. (4)

WILLIAMS:

Washington; d. Jul 30, 1890; age 67y; stone erected 1891. (2)
Jane, wife of W.; Oct 23, 1831 – May 5, 1917. (2)
Infant son of Wm. & Lucy; d. ----- (2)
Isadore Adcock, wife of L.M.; Oct 14, 1856 – May 26, 1889. (2)
Walter, son of L.M. & D.; Jan 24 – 25; 1878. (2)
Orbra, son of L.M. & D; Mar 14 – Jun 18, 1889. (2)
W.H.; Oct 18, 1828 – Jul 10, 1897. (8)
Sarah A., wife of W.H.; May 10, 1832 – Jul 24, 1919. (8)
Melissa, dau of W. & S.; Jun 8, 1852 – Jul 28, 1879. (8)
James H.; (no dates); Co K 107th IL Inf. (9)

WILLITS:

William L.; 1881 – 1949. (11)
Kathryne B.; 1891 – 1963. (11)

WILSON:

George P.; d. Feb 20, 1875; age 1y 3m 9d. (5)
Alice J.; d. Feb 19, 1875; age 5m 19d. (5)
Dora J.; d. Mar 20, 1872; age 8m 22d. (5)
Warren W.; d. Dec 20, 1875; age 1y 25d. (5)
(Above were 4 children of W.H. & E.M.)
James M.; d. Mar 18, 1868; age 22y 9m 15d. (8)
Hannah L., wife of James; d. Jan 19, 1871; age 29y 3m 16d. (8)
Baby of J.M. & H.L.; (no dates). (8)
Frank A.; 1871 -1948. (11)
Emma W.; 1869 – 1954. (11)
Keith E.; 1910 – 1973. (12)
Harley J.; 1897 – 1969. (12)
Goldie May; 1900 – 1968. (12)

WINDSOR:

Mary E., dau of Rev. J.A. & A.M.; d. Aug 23, 1866; age 4m. (3)

WOLFORD:

Lloyd; 1896 – 1962. (11)
Florence; 1899 – 1965. (11)

WOODS:

Harvey; Nov 14, 1815 – Jul 12, 1899. (1)
Sarah M., wife of H.; Aug 19, 1823 – Dec 7, 1888. (1)
Edgar H., son of D.D. & J.H.; Jun 11, 1858 – Nov 11, 1876. (2)
D.D.; Apr 1, 1827 – Mar 2, 1902. (2)
Jemima H. Hammer, wife of D.D.; Oct 12, 1832 – Apr 3, 1894. (2)
James Bird; 1856 – 1913. (2)
Louella, wife of B.; 1862 – 1928. (2)
Cornelia, wife of Salem; d. Aug 23, 1893; age 89y 7m. (6)
Salem; d. Sep 27, 1879; age 80y 3m 22d. (6)
Jonas, son of S. & C.; d. Jun 20, 1844; age 4y 10m 27d. (6)
Willard; d. Aug 20, 1867; age 5y 6m 11d. (7)
Daniel Lamoine, son of G. & M.; d. Oct 19, 1851; age 1y 8d. (7)
Guy R.; 1882 – 1967. (11)
Fern H.; 1884 – 1968. (11)

WOOLEY:

- Lewis B.; Sep 26, 1807 – Aug 10, 1866. (7)
- Charlotte, wife of L.B.; Jul 11, 1812 – Oct 27, 1845. (7)
- Nancy W., wife of L.B.; Jan 4, 1823 – Aug 15, 1890. (7)
- Infant son of L.B. & N.W.; d. Jan 31, 1850. (7)
- Charlotte F., dau of L.B. & N.W.; Apr 15, 1851 – Nov 4, 1853. (7)

WOOTEN:

- Zachariah J.; Oct 14, 1829 – Mar 11, 1903. (8)
- Sara J., wife of Z.J.; Mar 17, 1845 – 1920. (8)
- Margaret M., wife of Z.J.; d. Oct 1, 1875; age 42y 3m 9d. (8)
- Cornelia A.; Aug 20, 1862 – Jul 9, 1890. (8)
- Lloyd A.; 1887 – 1956. (9)
- Owen O.; 1883 – 1961. (9)

WORTMAN:

- Joseph B.; d. Dec 21, 1880; age 47y 1m 15d. Corp Co A 84th IL Inf. (8)
- Infant son of J.B. & M.G.; d. Jun 4, 1868. (9)

WRIGHT:

- Theodore; Apr 6, 1850 – Feb 10, 1890. (3)
- Aubrey, son of Theo. & Ida; Jan 12, 1879 – Apr 2, 1882. (3)

WRIGLEY:

- Hugh L., son of T. & V.; d. Nov 3, 1869; age 3y 7m 9d. (7)

YANKEY:

- Leslie O.; 1886 – 1975. (11)
- Eva M.; 1885 – 1974. (11)

YETTER:

- Guy; Dec 31, 1894 – Aug 14, 1895. (2)
- Pearl; Mar 6, 1896 – Aug 8, 1896. (2)

YOCUM:

- Steven; d. Oct 23, 1874; age 74y 9m 27d; 1LT Dobbin's Co I Brig IL MTD Inf Black Hawk War. (6)
- Mary, wife of Steven; d. May 25, 1879; age 69y 10m 24d. (6)
- Julia L., dau of S. & M.; d. Jan 10, 1855; age 18y 2m 21d. (7)
- Milton, son of S. & M.; d. Jan 10, 1844; age 1y 11m 25d. (7)
- George F., son of S. & M.; killed at Stone River, Dec 31, 1862; age 24y 11m 9d; IL Vol Inf 84th Co C. (7)

YOUNG:

- Walter Scott; 1897 – 1947. (5)
- Catherine; 1866 – 1939. (5)

UNKNOWN:

- _____, David; d. Feb 10, 1861; age ----- (8)
- , Joseph; d. Feb 13, 1864; age ----- (8)
- , Sarah A., wife of -----; d. Jan 17, 1861; age 43y 11m 26d. (9)
- , Rose Inda; d. Feb 26, 1873; age 4y 4m. (9)
- , Purley Hestell; d. May 2, 1867, age ----- (9)

Genealogical Notes – Pennington Point Cemetery

ALTON: Marcus md. Phoebe Evaline Griffith in this county on Nov 30, 1847.

ANDERSON: Harold Rex; d. Mar 2, 1922; age 26d; son of Verne & Iva R. (Graham) Anderson.

ARNOLD: M.S. (1848-1895) taught school at the District #3 school in Eldorado Twp. in the late 1870's

ATHERSON: William B. (1842- 1916); parents were Joseph and Eliza (Simonson) Atherton; was born in Hancock Co. IL Mar 14, 1842; the Atherton family moved to Stark Co. IL from OH in 1845 [??]; Wm. was raised in that county; enlisted in the army in Feb 1864; served with Co C 14th IL Inf; discharged in Jun 1865; married Mar 3, 1869 in Toulon, IL to Amelia C. Atherton; had several children included Nellie (Mrs. Ambrose Harlan), Mary Abigail, Emma, and Joseph A.; farmed on section 36, Scotland Twp.

Amelia C. (1853-1902) (Obit, in part, from the Bardolph News, Feb 5, 1902): "Mrs. Amelia Atherton died at her home near Pennington Point on last Sunday evening, aged nearly 49 years..... Deceased was born in Cape Girardeau, MO, Apr 15, 1853. She was married to W.B. Atherton in 1868, two children being the result of the union – Joseph of Pennington Point and Mrs. Nellie Harlan of Scotland Township.... "

William E. (Death notice, in part, from The Macomb Journal, Jun 10, 1886): "Edward Atherton, formerly of McDonough Co., but now of Ray, IL, died in a coal bank at Ray on Jun 7th. He was buried Jun 8th at Walnut Grove....?"

AUSBURY: Thomas (1809-1887); md. Agnes Shannon in this county on Nov 1, 1835, after the death of his 1st wife in 1836, Mr. Ausbury then md. Mrs. Lucinda (??) Vawter in this county on Apr 16, 1837. Thomas appears on the 1840 county tax list as #461; he owned no real estate; had \$55 worth of horses, \$41 cattle, and \$135 in other property; taxes were \$1.16.

Thomas (Death notice from The Macomb Journal, Jan 20, 1887): "Thos. Ausbury of Industry Twp. died at his home last Saturday and was buried Sunday at the Pennington's Point burial grounds. He was aged about 80 years and had lived in the county for over 50 years."

BAER: Rebecca (1825-1965), wife of Anthony; daughter of Stephen and Mary (Dorris) Yocum; Mrs. Baer was first married to Thomas Jones; he died in 1855.

BALDNER: Grover Kline; d Aug 16, 1923; age 1y 16d; son of Mr. and Mrs. Grover Baldner; father native of OH; mother maiden name Greenhagen, a native of IL.

Marjorie (1914-1921) (Obit, in part, from The Macomb Daily Journal, May 11, 1921): "Marjorie Margaret Baldner, daughter of Grover and Maude Baldner, was born in Eldorado Township, McDonough Co., IL, and departed this life May 7, 1921, at the age of 6 years, 9 months, and 9 days, after 6 years of suffering with rickets. She leaves to mourn her departure the father and mother, one brother and two sisters, Ray C., Dorothy R., and Ethel M. Baldner."

BERRY: Isabella (1815-1870); wife of Nathaniel Berry; maiden name was Keys.

BLACKSTONE: Stephen (1838-1921); born in Lafayette Co. WI, Jan 17, 1838; son of Beverly and Elizabeth (Blisset) Blackstone. The family moved to this county in 1840 and began farming in New Salem Twp.; Stephen married on Mar 2, 1865, to Mahala Smith; had 5 children; Beverly, Lizzie, George, Nettie, and Clara. Stephen sustained an injury in 1896, that resulted in the amputation of his right arm; the was mangled in a cob crusher.

BLACKSTONE (Cont'd): Beverly (1803-1861); born and raised in New York; moved to Wisconsin in the mid-1830's; married to Elizabeth Blisset; had a son and 3 daughters; Stephen, the only son, born in 1842. [???] [Stephen above, son of Beverly and Elizabeth b. in 1838]

Elizabeth (1817-1887); wife of Beverly; born in England; came to America about 1818. (Death notice, in part, from The Macomb Journal, Aug 18, 1887): "Mrs. Blackstone, the mother of Stephen Blackstone, died this week about 70 years."

Mahala E. (1843-1916), wife of Stephen; daughter of Reuben and Mary (Tinsley) Smith, natives of KY; the Smith's came to this county about 1848 and farmed near Bardolph.

BROTHERS: Nancy (1812-1886) (Death notice, in part, from The Macomb Journal, Jun 10, 1886): "Mrs. John Brothers died at her home in Eldorado Twp. on the 6th. Burial was Monday in the Pennington's Point Cemetery."

BURNHAM: Sarah Lela (1878-1948), wife of Albert C., daughter of Lawson T. and Alice Rexroat.

Alice G. (d. 1906) (Death notice, in part, from The Macomb Daily By-Stander; Apr 10, 1906): "Alice Geniveve, the little 5-week old child of Mr. and Mrs. Albert Burnham of Bethel Township, died Thursday morning"

CASPALL: J.E.M.; d. Nov 20, 1881; age 28y 4m 20d; farmer; married; b. England; resident of IL 8 yrs; d. New Salem Twp. (Death notice, in part, from The Macomb Journal, Nov 24, 1881): "James Caspall died last Sunday in Scotland Twp., aged 28 years; survived by a wife and 3 children....."

CHADDERDON: Achsa (1879-1900) (Death notice, from The Bardolph News, Mar 14, 1900): "Mrs. Arthur Chadderdon died at her home near Newtonia, MO, on Feb 29. Mr. and Mrs. Chadderdon were former residents of New Salem Twp., the latter being a daughter of George Battin. The couple had been married about two years. A two-week old babe survives the mother. The remains were brought to Pennington's Point for interment."

CHANDLER: Isaac (1823-1899); served as a school director for the District #3 school in Eldorado Twp.; he was also a trustee with the West Prairie Cumberland Presbyterian Church, located in section 9, Eldorado Twp.

Lusettie F. (1854-1899), wife of Franklin, maiden name was Ausbury.

CURRENS: Jessie J. (1885-1912) (Obit, in part, from The Macomb Daily Journal, Mar 23, 1912): "Mrs. Price Currens of Adair died last night in St. Louis, MO; at the home of a relative, Mrs. Rippe, of tuberculosis, after an illness extending over about eight months. Her age was about 27 years. She has been in poor health for the past several years and for the past three weeks has been taking treatment in St. Louis.... The body was shipped from St. Louis and arrived in Adair this afternoon. Deceased was born near Adair, her mother dying when she was a child, and she was reared by her grandmother, Mrs. Seaburn. Besides her husband, she leaves on 7-year-old son. She leaves the following uncles and aunts: Mrs. Bird Woods, Mrs. Walter Sperling, Jay and Frank Seaburn, all of Adair.... her husband employed with the Martin-Price hardware firm in Macomb."

William A.; d. Nov 20, 1881; age 32y 5m 5d; farmer; married; b. PA; d. New Salem Twp. of typhoid fever.

Fannie M.; d. Jan 29, 1882; age 2y 2m 14d; b. PA; d. New Salem Twp. of typhoid fever.

DICKEY: William (1813-1898) (Death notice, in part, from The Macomb By-Stander, Jul 20, 1898): "The remains of William Dickey of Kansas were interred at the Pennington Point Cemetery last Friday He lived in New Salem township previous to Kansas."

DORRIS: Thomas appears on the 1840 county tax list as #550; he owned no real estate; had \$120 worth of horses, \$46 cattle, and \$70 in other property; tax were \$1.18.

DOWNEN: Mary E. Stockton md. "Job" Downen in this county on Apr 5, 1849.

ELWELL: Thomas (1835-1916) born in Knox Co. OH Nov 21, 1835; moved to this county with his mother; learned the trade of blacksmithing in Vermont, IL; returned to this county; worked in Schuyler Co. IL about 3 years as a blacksmith; married there to Ellen E. Edwards; had 6 children: Mary E. (Mrs. C.W. Sylvester); Henry M.; Fannie M.; James H.; Lewis G.; and Angeline C. Mr. Elwell was a blacksmith in Adair for a number of years. Thomas is credited as the first person to build a dwelling in the village of Reedyville (later Adair); he built his home there in 1870; the total cost of that home was \$500.

Ellen E. (1839-1922), wife of Thomas; born in Pittsfield, IL Aug 16, 1839.

ENDRES: Glade (1897-1905) (Obit, in part, from The Macomb Weekly Sentinel, Jun 8, 1905): "Glade, the eight year old son of Mr. and Mrs. George Endres, died at their residence Tuesday morning of erysipelas. The family lives at Adair..... He is survived by his parents and one brother....."

EVANS: Nancy (1826-1863); her husband, J.G. Evans lived to age 84 yrs; d. 1905; buried at Camp Creek Cemetery.

FORRISTER: John Howard and Anna Amelia (Arnold) Forrister were the parents of the infant child buried in this cemetery; John was born in Framingham, MA in 1847; he and Amelia Arnold were married near Vermont, IL on Mar 16, 1876; Mrs. Forrister was born in Uniontown, PA in 1854. John H. and Amelia had 3 daughter: Laura Etta; Ada Emiline; and Clara Helen.

FOWLER: Jesse B. (1878-1906) (Obit, in part, from The Macomb Daily By-Stander, Aug 3, 1906): "Jesse Fowler of New Salem Twp., the young man who met with the awful accident Thursday while threshing at the William Miles farm in Eldorado Twp., died about 5 o'clock Thursday afternoon. Death was due to the shock from the accident and from the loss of blood before the physicians arrived. The physicians arrived as soon as possible after notified of the accident but when they arrived the young man was in a state of collapse. The only hope of saving his life was in amputation of the leg which had been crushed in the cylinder of the thresher. The operation was started but the patient died before it was concluded. The body was removed to his home, which is only about two miles from where the accident occurred..... Jesse Fowler was born in the neighborhood where he died, about 28 or 30 years ago and had lived there the greater part of his life"

GATES: Flora (1803-1880) d. Jun 23, 1880; age 77y 2m 6d; widow; in IL 44 years; born in Lexington, KY; maiden name was McCormick; married first to Benjamin Wilcox in KY; had 6 children; Mr. Wilcox died in 1836, in KY; the widow and her children then moved to this county and, in the early 1840's, Flora remarried to Mr. Gates; she later lived in Bardolph, where she died in 1880.

GREENUP: John (1797-1874); native of Monroe County, KY; married Elizabeth Harland in 1820; moved to this county from KY in 1835; lived near Pennington Point; had several children, his sons included: S.F. (b. Monroe Co. KY, 1835); Charles W. (1829, KY); William (1827); James F. (1824). John's sister, Nancy, married Wesley Harlan in KY and later moved to this county. John and his sister, Nancy, were children of Thomas Greenup of Monroe Co. KY. John appears on the 1840 tax list as \$413; he owned no real estate; had \$85 worth of horses, \$50 cattle, \$45 wagons, and \$75 in other property; taxes were \$1.28.

Lydia, wife of Chas; Lydia A. Mills and Chas. W. Greenup were married in this county on Jan 1, 1851.

GRIM: Jacob (1826-1914), along with John Reedy, laid out the town of Reedyville (later Adair) in August 1870. Jacob farmed on section 21, New Salem Twp.; he was born in OH and moved here in 1853 from Pickaway Co. OH.

HALL: Randolph farmed on section 19, New Salem Twp.; he was born in KY and moved to this county from that state in 1837. Randolph and Almeda Woods married in this county on Aug 6, 1846.

Ameda L. (1829-1921), wife of Randolph; daughter of Salem and Cornelia (Grow) Woods; lived in Table Grove.

Eva V. (1855-1888), wife of L. Grow Hall; daughter of James E.D. and Nancy (Pennington) Hammer; lived in Table Grove, IL. (Death notice, in part, from The Macomb Journal, Feb 16, 1888): "Mrs. Grow Hall died at the home of her husband's father, Ran Hall, in Table Grove, Fulton Co. on Feb 12th. She was a former resident of Pennington's Point and was the daughter of Richard (??) Hammer."

William; d. Oct 10, 1879; age 38y 1m; farmer; married; b. Ross Co. OH; resident of IL 15 yrs; d. New Salem Twp.

Bertie; d. Jan 1880; age 2m 20d.

HAMMER: James E.D. (1808-1889) born in Washington Co. TN Apr 28, 1809; son of Richard and Anna (Fisher) Hammer; moved to Monroe Co. KY about 1819; Richard died there in 1844; Anna died in that county in 1854; James moved to this county in 1834; settled on section 24, Scotland Twp.; later moved to Pennington Point; married in Monroe Co. KY on Apr 15, 1821(1830??), to Nancy Pennington; had 9 children: U.J.; Stewart F.; Jemima H. (Mrs. D.D. Woods); Richard McKenzie; William Jefferson; James; Josiah Yancey; Amanda Jane (Mrs. Wm. Jones); David Taylor; Eva Virginia (Mrs. Grow Hall). James E.D. Hammer appears on the 1840 county tax list as #415; he owned no real estate; had \$175 worth of horses, \$50 cattle, \$10 clocks and watches, \$75 wagons, \$25 cash loaned out, and \$302 in other property; taxes were \$3.19.

Nancy (1812-1887), wife of James E.D.; daughter of Stewart and Jemima (Houser) Pennington, (Obit, in part, from The Macomb Journal, Oct 6, 1887): "Nancy, wife of J.E.D. Hammer, died Saturday.... She was the third child of Stewart and Jemima (Houser) Pennington of Pennington's Point. She was born Feb 18, 1812, near Thompkinsville, Monroe Co. KY and was married on Apr 15, 1830. She came with her husband to Pennington's Point in 1834 and they have resided there ever since. She was the mother of 10 children, 7 of whom survive – 4 sons and 3 daughters, along with the husband...."

David Taylor (1849-1876), son of James and Nancy Hammer; married to Clarissa Woods.

S.F. (1831-1888); Stewart Franklin Hammer was a son of James E.D. and Nancy (Pennington) Hammer; married to Margaret Harlan, a daughter of Wesley & Nancy (Greenup) Harlan.

R.M. (1834-1895); Richard McKenzie, son of James & Nancy (Pennington) Hammer, was born in this county; in 1874 he moved to Crawford Co. KA and farmed there about 3 years; returned here and built a hotel in Adair; that hotel, a 2-story frame building, was erected by Mr. Hammer in 1878. Richard married S.M. Bowles, a native of KY; had 4 children.

Josiah Yancy (1843-1897), born in Scotland Twp.; son of James E.D. & Nancy (Pennington) Hammer; enlisted in the army in 1862; discharged on Jun 22, 1865; married Oct 23, 1866 to Mary C. Hall; had a daughter, Della A.

Mary C. (1849-1919), wife of J.Y.; daughter of Randolph and Ameda L. Hall.

George W. (1807-1841) appears on the 1840 county tax list as #423; owned no real estate; had \$75 worth of horses, \$30 cattle, \$50 wagons, and \$100 in other property; taxes were \$1.28.

HAMMOND: M. Mae (1887-1949), wife of Roy; maiden name was Carlin.

HARLAN: Wesley (1805-1874); born in Barren Co. KY, son of Jacob and Sarah (Combs) Harlan; moved from that state to Schuyler Co. IL in 1834; lived there about 2 years; moved to Industry Twp., this county; ran a horse-powered grist mill at his home for several years; married on Nov 2, 1826, to Nancy Greenup, in Monroe Co. KY; had 10 children; George T.; William N.; Marcus L.; Lorenzo D.; Margaret (Mrs. S.F. Hammer); Rebecca (Mrs. Elihu Stockton); Hulda (Mrs. Daniel Wooley); Eliza (Mrs. Sam'l Kyle); Chloe (Mrs. Frank Hall); and James W. After the death of Nancy, his first wife, Wesley remarried on Dec 4, 1867 to Mary Osborne. Wesley appears on the 1840 county tax list a #427; he owned no real estate; had \$165 worth of horses, \$40 cattle, \$10 clocks and watches, \$50 wagons, and \$180 in other property; taxes were \$2.23.

Nancy (1803-1864), wife of Wesley Harlan; daughter of Thomas and Catherine (McIntosh) Greenup, natives of VA. Nancy was a sister to John Greenup, who came to this county with his family in 1835.

George Taylor (1827-1908) born in Monroe Co. KY; son of Wesley and Nancy (Greenup) Harlan; moved to this county in 1834; married to Talitha C. Yocum on Dec 25, 1856; had 11 children, including: Emma (Mrs. Jesse A. Pierce); Inez (Mrs. Patrick H. McElhone); Ambrose; Julia (Mrs. Jacob Raby); Winifred (Mrs. Thomas Bean); Horace A.; Leroy P.; James F.; Alma; and 3 children that died in infancy. George T, his physical description as "about five feet ten inches in height, slimly built" is contained in an early history of this county. George T. farmed on section 31, New Salem Twp.

Talitha C. (1832-1925), wife of George T.; daughter of Stephen and Mary (Dorris) Yocum; the Yocum family arrived in this area in 1833.

Leroy P. (1859-1886), son of George T. and Talitha (Yocum) Harlan; killed on the Wesley Harlan farm when a tree limb fell on him. (Obit, in part from The Macomb Journal, Dec 30, 1886): "Leroy Harlan, a farmer of New Salem Twp., died at Pennington's Point last Tuesday. His brother lived about a quarter mile from where he died. He is survived by his wife and an only child, a daughter age 3 years..... He was aged 30 years. His wife was the daughter of Lewis Chadderdon. They had been married about 4 years."

C. Hester (1836-1915), wife of William M.; daughter of Stephen and Mary (Dorris) Yocum.

Nellie (1871-1956), wife of Ambrose S.; daughter of William B. and Amelia Atherton.

Marcus (1839-1879); died Dec 14, 1879; age 40 years; farmer; married; b. KY; in IL since a child.

HENSLEY: William J. (1841-1862); enlisted in the army at Macomb on Aug 7, 1862; promoted to Corporal; died at Bowling Green, KY.

HERLOCKER: Josiah and Margaret were among the original members of the New Salem Christian Church which was organized on Apr 8, 1849; a church was later built on section 32, New Salem Twp.

Margaret (Obit, in part, from The Macomb Journal, Jan 5, 1888): "Margaret Herlocker died at her home on E. Jackson St. in Macomb on Dec 28th aged 72 years 24 days. She was born in Milton, Northumberland Co. PA on Dec 4, 1815 and was married to Josiah Herlocker on Jan 2, 1834. They came to IL on 1849 and to McDonough Co. in 1850. She is survived by her husband, a daughter – Mrs. Griffin, of this county, and 4 sons, one of whom is Gus Herlocker in the Circuit Clerk's Office in this city...."

HERDON: Manson (1820-1899), born near Richmond, VA; married Margaret Rexroat; they had 5 children.

Elijah C. (1850-1918), born in Cass Co. IL Nov 28, 1850; son of Manson and Margaret J. Herndon; the family moved to this county in 1856; Elijah married Lucinda Clarke on Mar 20, 1873; had several children, including: Wilber A.; William Howard; Iva; Grade; Edith; and Frank.

Iva (1884-1900) (Obit, in part, from The Bardolph News, Nov 21, 1900): "Ivy Herndon died at the home of her parents, Mr. and Mrs. Elijah Herndon, in Scotland Twp. on last Sunday night of typhoid pneumonia, aged 16 years... This is the sixth death among the Herndon families in that vicinity in less than one year...."

Howard (1876-1953); William Howard Herndon was a son of Elijah and Lucinda (Clark) Herndon; the family moved to this county in 1856; farmed in Scotland Twp.; Howard married Mary McFarland on Feb 24, 1897; they had 2 children; Mildred and Carl. Mary, wife of Howard, died in 1900; he then married Mamie Farr on Feb 7, 1906.

Lizzie (1860-1900), wife of Marcellus; daughter of Hasting and Patsy (Riggins) Rexroat; married Mr. Herndon on Oct 31, 1878; children included Archie and Willie; farmed in New Salem Twp.

Edith (1881-1900) (Obit, in part, from The Bardolph News, Nov 7, 1900): "Edith Herndon died at the home of her parents, Mr. and Mrs. Elijah Herndon, in Scotland Township, Wednesday, last, of typhoid fever, aged 19 years, 2 months and 17 days..... The funeral was held early on account of three other members of the family being now sick with the same disease, and the physician in attendance deemed it best to inter the remains as soon as possible. She leaves besides her parents, two brothers and one sister."

Belle (1865-1890), wife of Baxter D.; Mr. Herndon was a son of Manson and Margaret (Rexroat) Herndon; Baxter and Belle Moyers were married on Sep 1, 1884; they had 2 children; Charles and Bessie.

Allen (1831-1862) son of Ezekiel Herndon; born in Rockingham Co. VA; married Frances Cave, also of VA, a daughter, Sarah, married Andrew Binnie. Mr. Herndon died in a hospital at Nashville, TN while in the army during the Civil War; cause of death was exposure. He enlisted in the army at Macomb on Aug 9, 1861; died Feb 20, 1862.

Pauline Francis; d. Dec 10, 1923; age 68y 7m 2d; b. May 8, 1855, at Knox Co. IL; daughter of Beverly and Harriet Jane (Lastley) Vawter, both natives of NC; Pauline was married to Theodore Herndon.

HOLLEY: Isaac (1839-1900) son of William and Elizabeth (Stockwell) Holley, natives of VA; Isaac was born in Fayette Co. PA, Mar 29, 1839; left home at age 18 years; moved to IL in 1864; farmed in LaSalle Co. for a year; then moved to New Salem Twp., this county; married on Jan 14, 1869, to Lorinda Brundage; had 8 children: Ellsworth E. (1869); Infant son (1871); Nicholas T. (1872); Infant dau (1875); Mary F. (1876); Infant son (1877); Olive M. (1878); Edward E. (1883). (Isaac's wife, Lorinda, see *)

HOLLIDAY: Alexander C. (1825-1884) lived on section 32, New Salem Twp.; he was a plasterer by trade; born in OH and moved here in 1857 from Cincinnati. (Death notice, in part, from The Macomb Journal, Apr 10, 1884): "Mr. A.C. Holliday died at his residence in New Salem Twp. on the 6th, aged 59 years on February last. He was born in Harrison Co. OH and came to this state in 1857. He was married and had children"

Lorinda (1846-1886), wife of Isaac; daughter of John and Lucy A. (McClure) Brundage; born Nov 30, 1846.

JONES: Jerome B., husband of Mary J. (1849-1886); son of Sam'l R. Jones; farmed in Scotland Twp.; married on Nov 16, 1871; had the following children: Sam'l B.; Annie B.; Joab; Mabel; Jennie; and Matha.

Mary J. (1849-1886) (Death notice, in part, from The Macomb Journal, Dec 2, 1886); "Mrs. Jerome Jones died last Saturday at her home in Scotland Twp. aged about 35 years. She is survived by her husband and a family of children. She was the daughter of J.B. Standard of Industry...." Her mother was Jane (Allison) Standard. The Standard's came to this county in 1836 from Kentucky.

Perry C. (1842-1901), son of Sam'l R. and H. Jones; born in Scotland Twp. Jun 12, 1842; enlisted in the army at Macomb on May 24, 1861; wounded in the leg in the battle of Buzzard's Roost in 1863; hospitalized in TN and in IN; mustered out on Jul 25, 1864 and returned to this county; married Dec 28, 1865, to Julia A. Cox; had 7 children: Iverson E.; Samuel L.; Minnie M.; Nina B.; Bessie F.; Jessie A.; and Alta M.

Julia A. (1845-1884), wife of Perry C.; daughter of Thomas Cox.

Amanda J. (1851-1898), wife of J.W.; daughter of James E.D. and Nancy (Pennington) Hammer. (Obit, in part, from The Macomb By-Stander, Jul 13, 1898): "Mrs. J.W. Jones of Nettleton, MO, a former resident of Pennington Point, died the 7th of July and the remains were brought to Macomb Friday morning accompanied by Mr. Jones and family..... Amanda J. Hammer was born in Monroe County, KY, in the month of September, 1851. She was married to J.W. Jones, July 3rd, 1868. Five children were born to them, two of them, Clayton and William, with their father and a little granddaughter, are left to mourn her loss...."

Thomas H. (d. 1855); married to Rebecca J. Yocum, a daughter of Stephen and Mary (Dorris) Yocum; after Mr. Jones' death, his widow then married Anthony Baer.

Newton (1851-1852), son of Thos. and Jane (Yocum) Jones who were married in this county on Sep 11, 1845.

Isaac N. enlisted in the army at Macomb on May 24, 1861; re-enlisted after first term; mustered out on Jul 8, 1865.

KERR: Claybourn T. (1825-1895); farmed on section 26, New Salem Twp.; was born in VA; moved to this county in 1852/53 from Fulton Co. IL. Enlisted in the army at New Salem Twp. on Aug 7, 1862; promoted to Sergeant; wounded while in service; mustered out on Jun 8, 1865.

KYLE: Nancy and Mary were daughters of Wm. H. and Zillah Ann (Vandike) Kyle, who were married in this county on Sep 5, 1836.

Sarah Danley married Logan K. Kyle in this county on Mar 15, 1849.

LEFRIDGE: Philip M. (1844- 1926), son of Henry and Rachel (Swink) Leftridge; born in Indiana; moved to IL in 1857; lived in Eldorado Twp. several years; lived in MO for a few years; then farmed in Schuyler Co. IL about 9 years; later returned to Eldorado Twp.; married Oct 8, 1868, to Sarah Jane Bruner; children included: Rhoda; Maria; Fannie; and Joseph H.

Sarah J. (1851-1927), wife of Philip M.; daughter of David and Rhoda (Hills) Bruner, who came to this county about 1843, from KY; the Bruner family lived for several years in Eldorado Twp.

LEIGHTY: Samuel (1851-1908) born in Layette Co. PA, Mar 12, 1851; married Eva Seaburn in 1875; children included: Fred (1876); Olive (1879); Bessie B. (1881); Sam'l farmed till about 1881, then moved to Adair and operated an implement business.

Florence Eva (1855-1936), wife of Samuel; daughter of George and Sarah (Kerr) Seaburn; George, a native of OH, born in 1828; Sarah, born in VA in 1833; Florence was a sister to Mary J. (Mrs. Peter Dougherty); Lizzie K.; Bessie B.; George A.; John H.; Johnston.

Martha F. (1856-1951), wife of George, daughter of Christopher and Mary E. (Elwell) Wetsel/Wetzel; Mr. Wetsel was born in Augusta Co. VA in 1831; married on Oct 20, 1853; Martha (Wetzel) Leighty was a sister to Hettie F.; Eliza J.; Mary E.; and Nora E.

Joseph M. (1824-1901) born in Fayette Co. PA; married there in 1846, to Rebecca Harshman; had 10 children: Daniel; William; Samuel; Leroy; George; Mary; Isaac; Lyman; and twins that died in infancy. The family moved to this county in 1856; lived in Eldorado Twp.

LOWNES: Rebecca (Death notice, in part, from The Macomb Journal, Nov 12, 1885): "Miss Rebecca Lownes, daughter of Elmer Lownes of New Salem Twp., died Sunday Nov 8th, aged 22 years. She was a teacher in Bushnell..."

Rowena B. (d. 1893) was a daughter of Charles R. and Clementine B. Lownes.

Clementine (1845-1923), wife of Charles R.; Chas. enlisted in the army at Bushnell on May 11, 1864; served as a private with Co I 137th IL Inf.; mustered out on Sep 24, 1864.

LOY: Hiram (1812-1900); farmed on section 5, New Salem Twp.; he was born in VA; moved to this county in 1853, from Hamilton Co. IN. According to cemetery records, Mr. Loy's wife, Nancy B. is also buried here; no stone was located; she was born Jul 28, 1817; died Jul 19, 1895.

MARRS: Abijah T. (1831-1900); moved to this county about 1856; farmed near Pennington Point; a son, Richard F., later became a physician and lived in Sciota, IL.

Elizabeth B. (1835-1913); wife of A.T.; daughter of Richard and Delilah (Shannon) Pennington.

MERRILL: Eona Grace (1897-1898) (Death notice, in part, from The Macomb By-Stander, Jun 29, 1898): "The little daughter of Mrs. Jacob Merrill died at their home in Table Grove Thursday and was buried Friday. The family had passed through a siege of the measles, when the baby took whooping cough and lung fever. The mother has the sympathy of all who know her in her loneliness and sorrow, as Mr. Merrill has gone to the Klondike and will not return for years, if ever, the loss of her child is doubly hard to bear."

MONTGOMERY: Martha (Obit, in part, from The Macomb Journal, Aug 11, 1887): "Mrs. Martha, wife of J.L. Montgomery, aged 42 years 9 months, died Monday. She came from Virginia to this state about 6 years ago with her husband and children. They had lived in Scotland Twp. for 2 years. She was the mother of 14 children, 11 of whom are living"

James (1858-1923) (Obit, in part, from The Macomb Daily Journal, Feb 6, 1923): "Walter James Montgomery, aged 65 years, 2 months, and 9 days, died at his home near Adair last night of pneumonia after an illness of four days Deceased was born in Virginia, Nov 24, 1857, but came to Fulton county and a year later to near Adair when he was a small boy. He has since resided in that vicinity. He was unmarried. Surviving is one brother, Robert Montgomery, of Adair. One brother, Alexander, is deceased."

MOORE: William, husband of Elizabeth (1801-1975); born in Monroe Co. KY; appears on the 1840 county tax list as #419; he owned no real estate; had \$150 worth of horses, \$50 cattle, \$25 wagons, and \$60 in other property; taxes were \$1.43.

Elizabeth (1801-1875), wife of William; came to this county from KY in 1835; maiden name was Greenup; lived at Pennington Point; Wm. and Elizabeth had 10 children.

Thomas J. (1834-1920) farmed on section 31, New Salem Twp.; he was born in KY and moved here in 1835 from Byron Co. KY.

MC FADDEN: Samuel D. (1822-1884) born in PA; son of Thomas and Mary (Dunlap) McFadden; moved to this county in 1848; farmed in Eldorado Twp., married Rosann Miles; they had 4 children including Thomas Martin McFadden, born in this county in 1853, and John W. (Death notice, in part, from The Macomb Journal, Jun 12, 1884): "Sam'l McFadden died at his home in Eldorado Twp. this week and was buried in the Pennington's Point cemetery on Tuesday. There are two men of this same name in the same township; the man who died is known as "Big Sam."

Rosey (1828-1898); wife of Sam'l; born in OH, daughter of Martin and Elizabeth (Smith) Miles. (Death notice, in part, from The Macomb By-Stander, Jun 1, 1898): "Mrs. Rosey McFadden died at her late residence on South Randolph street in Macomb last Thursday morning, aged 70 years, 8 months, and 25 days. Death was caused by a complication of rheumatism and other troubles, from which she had suffered for several months.... Deceased leaves two sons, and two daughters – John W. and Mrs. Jennie Lawyer of Eldorado township, Thomas, of Macomb, and Mrs. Mary Johnson of Rock Island."

John W. (1849-1912) (Obit, in part, from The Macomb Daily Journal, Feb 20, 1912): "....John W. McFadden.... died in Table Grove... Deceased was born in Eldorado township, where he lived all his life until a few years ago, when he moved to Table Grove. He was united in marriage about forty years ago to Nancy Hill, who survives. He leaves three sons, and one daughter, all married: Martin, Wallace and Samuel, living in the vicinity of Table Grove, and Lena, residing in the south part of the State. He is survived by one brother and one sister, Thomas M. McFadden of Macomb, and Mrs. Jennie Lawyer, of Table Grove."

PENNINGTON: Stewart (1784-1859) was a son of Richard and Hannah (Boone) Pennington; Richard was born in PA in 1748; he died near Sparta, TN in 1813; Hannah was a sister of Dan'l Boone and the widow of John Stewart, who was killed in KY; Mr. and Mrs. Stewart had 4 children – all girls. After Richard and Hannah were married they moved to White Co. KY and raised 3 sons and a daughter; Joshua (d. in TN); Daniel (d. in KY); Abigail (Mrs. W. Gest; lived in Monroe Co. KY); and Stewart. Stewart, born in NC; married Jemima Houser; they had 13 children: Nicholas N.; Thomas J.; Nancy; Richard; Abigail; Warner; Hannah B.; Elizabeth Z.; Stewart M.; Mary M.; Leander W.; Joshua J.; and William T. The family moved from Kentucky to this county about 1830.

Richard (1814-1891), son of Stewart and Jemima Pennington; born in Monroe Co. KY Jan 24, 1814; married Jan 30, 1834, to Delilah Shannon, in this county. Richard moved to this county with his parents in 1830; farmed in New Salem Twp.; had 12 children: Elizabeth (Mrs. A.T. Marrs); Charles W.; Jane C. (Mrs. C.A. Jones); Mary C. (Mrs. Elias W. Beghtol); Albert S.; Richard Warren; Sarilda Agnes (Mrs. A..B. Wetzel); Elnora Frances; John Alfred; Ella Margaret; and Edward E. Richard appears on the 1840 county tax list as #424; he owned no real estate; had \$80 worth of horses, \$80 cattle, \$10 clocks and watches, \$30 wagons, and \$150 in other property; taxes were \$1.75.

Delilah (1810-1892), wife of Richard; daughter of Charles and Rachel Shannon.

James E. and Nicholas W. were sons of Warner & Juliett (Shannon) Pennington, who were married in this county on Sep 20, 1843.

PILE: Hannah Boone (1829-1885), wife of William B. Pile; daughter of Stewart and Jemima Pennington; born in KY; moved to this county with parents in 1830; William Pile moved to this county in 1833; lived in New Salem Twp. for a few years, then moved to Macomb. (Death notice, in part, from The Macomb Journal, Oct 1, 1885): "Mrs. Bird Pile, recently of Sedan, Kansas, died a few days ago. Her maiden name was Pennington. She lived in Industry up to 5-6 years ago and then moved to southern Kansas. Shortly after Mr. and Mrs. Pile moved to Kansas, a daughter, aged 18 years died and since then, 4 more in the family have died."

George R. (Death notice, in part, from The Macomb Journal, Dec 18, 1884): "George Pile was buried in the Point Cemetery on Dec 14th. He leaves a wife and 1 child. Mr. Pile was from Sedan, Kansas and died at the residence of his father-in-law, L. Williams of Adair....."

James M. (Death notice, in part, from The Macomb Journal, May 22, 1884): "Monroe Pile of Kansas, formerly of Industry Twp., died at Sedan, Kansas. He was a son of Bird Pile....."

Rhoda Abbott (Death notice, in part, from The Macomb Journal, Aug 25, 1881): "Abbie Pile died at the residence of her parents in Industry Twp. on Aug 24, age 18 years. She was a daughter of W.B. Pile and was born and raised in Industry....."

POINTER: William (1812-1903); born in Cumberland Co. KY; son of Cornelius and Rebecca (Snow) Pointer; Cornelius, born in 1788, in Pulaski Co. KY; Rebecca born in 1789, in MD; the family moved to Morgan Co. IL in 1829; Cornelius died in 1833; Rebecca in 1835; William married on May 31, 1835, to Elizabeth Morrison; in 1855, they moved to Hancock Co. IL; then, in 1858, moved to this county; he farmed and raised imported horses; had four children; Sarah R.; Robert C.; George D.; and William. William, Sr. served during the Black Hawk War of 1831 and 1832. Mr. Pointer became a Methodist preacher in 1871. William served as a wagon master during the Civil War; he was discharged about 1863 because of a disability.

Robert C. (1838-1932), son of William and Elizabeth (Morrison) Pointer; born at Meridosia, IL Dec 17, 1838; married in this county on May 5, 1864 to Flora Gates; had 7 children: Anna E. (Mrs. J.D. Hayes); Jennie (Mrs. L.L. Gardner); Ida M. (Mrs. G.A. Lewis); Lula (Mrs. B.D. Hernden); William C.; Nellie (Mrs. James O. Gift); and Grace G. Mr. Pointer lived at Bardolph and was a part owner of a clay works and tile factory at that place.

Flora (1845- 1926), wife of Robert; daughter of Nathan and Flora Gates.

PONTIOUS/PONTIUS: Byron was born in Ross Co. OH May 25, 1851; moved with parents to Fulton Co. IL in 1853; there two years, then moved to New Salem Twp., this county; Byron attended Lombard College at Galesburg; then owned and operated a drug store in Adair for a few years; began study law and was admitted to the bar in 1880; married Ambrosia Woods on Apr 2, 1873; children included Arah and Ralph.

Ambrosia, wife of Byron, was a daughter of Morillo and Martha (Hall) Woods; Mr. and Mrs. Woods later moved to Clay Co. NE.

Ralph Woods Pontious was a son of Byron and Ambrosia (Woods) Pontious; married on Sep 4, 1900 to Adah B. Runkle, a native of Doddsville, IL; they had a son, William Byron, born in 1905.

Simon (1825-1899); father of Byron; lived in PA and OH before coming to this county; a local history (McDonough) account of the family described Mr. Pontious as "Having been six feet four inches in height and of herculean strength."

PONTIOUS/PONTIUS (Cont'd):

Lyman F. (1848-1936), born in Ross Co. OH; moved to this county in 1853; operated a general store in Adair for a few years; later operated a poultry house in Adair; married on Dec 16, 1875 to Florence Zoll, a native of Fulton Co. IL; had one son, Clifford A.

Clara (1859-1940), wife of Austin; daughter of Daniel and Jemima H. (Hammer) Woods.

PORTER: Lester W. (1845-1864), son of Joseph E. and Susan Porter; enlisted in the army at Bushnell on May 11, 1864; he was killed at Memphis, TN 4 months later.

Laura B. and George B. were children of Lyman Porter. Lyman was a brother to Joseph E. Porter.

Joseph E. (1821-1886), son of Noah and Nabby (Comings) Porter and brother to Lyman, Reuben, and Warren. Lyman and Reuben moved to this county prior to 1850. Noah was born in Franklin Co. MA in 1792; Nabby and he were married in 1815; had 11 children including Joseph E.; he was born in Wendell, MA Jul 9, 1821; married Sep 14, 1842, to Susan M. Cogswell; Joseph and his father, Noah, came on a visit to IL in 1855; while here, Noah died in this county; his body was returned to MA for burial; his mother, Nabby, died in MA on Jan 4, 1868. About a year later, Joseph moved his family to this county (about 1856) and began farming in New Salem Twp. An early history of this county describes Joseph E. Porter as follows: "about five feet ten inches in height, and a stout, well built man..." (Death notice, in part, from The Macomb Journal, Aug 12, 1886): "Joseph E. Porter, an old citizen of McDonough co., died at his home in New Salem Twp. on Monday, aged 65 years. He was born in Franklin Co., MA on Jul 9, 1821. He resided with his parents until he was 21 years old, teaching at school in the winter and farming. At the age of 22 years, he married Miss Susan Cogswell of New Salem, MA. Two years later they moved to Farmington, MA. They returned to New Salem in 1848 and lived there until 1856 when they came to New Salem Twp., McDonough Co. where they have since resided. He is survived by his wife and a number of children. One son was killed in the Civil War...."

Susan M. (1822-1913), wife of Joseph E., daughter of Jonathan and Lydia (Boynton) Cogswell; the family lived in New Salem, MA. Jonathan was born in 1792; Lydia, in 1791; they were married on Oct 19, 1816.

Mary Elizabeth; d. Apr 20, 1883; age 30y 4m 20d; married; b. in Fulton Co. IL; d. New Salem Twp. this county.

PUTT: Josephine (1869-1897) (Death notice, in part, from the Macomb Eagle, Jan 21, 1897): "Josephine, wife of Frank Putt, died Sunday at 8:15 p.m. Both Frank and his wife were in town Saturday evening at the doctor's office and got some medicine. They had called in the doctor Sunday afternoon; he left there about 6 o'clock and did not anticipate any immediate danger. Frank raised her up and gave her the medicine and she expired as soon as she laid down. Perhaps heart failure was the cause of the sudden death...."

RABY: Simon (1832-1908) farmed on section 30, New Salem Twp.; he was born in PA and moved to this county in 1858 from Ashland Co. OH; operated a general store, blacksmith shop, and was the postmaster at Pennington Point for a number of years.

REEDY: Mary A. (1832-1880) (Death notice, in part, from The Macomb Eagle, Aug 7, 1880): "Mrs. Mary Ann, wife of Jacob Reedy, a prominent citizen of Adair, New Salem Twp., died on the 31st, age about 42 years." Mary Ann; b. OH; resident of IL 23 years; d. at Adair, Jul 24(?), 1880; age 42y 3m; married.

Jacob S. (1806-1880); an older stone, now removed from this cemetery, read: "Born Union Co. PA, Nov 26, 1806; emigrated to Ohio in 1832 and to Illinois in 1856. Died Apr 14, 1880."

REEDY (Cont'd): Dale D. (1896-1897) (Death notice, in part, from The Macomb Eagle, Sep 9, 1897): "Died, Thursday night about 8 o'clock, baby son of Hiram Reedy, aged 1 year; was only sick a few hours; congestion of the brain was the cause of death... Mr. and Mrs. Reedy have the sympathy of their many friends; this was their only child they had living, having buried two before this one; the first only a month or so old, the second about 11 months old...."

REXROAT: James M. (1828-1914), born in Russell Co. KY Jan 22, 1828; son of Peter and Mourning (Hopper) Rexroat; the family moved to this county about 1853; settled in Scotland Twp.; married Sep 8, 1850 to Jane Moyers, a native of Green Co. IL; had 10 children: Lawson T.; Eliza; Winfield; Sarah; William H.; Jourdan H.; Teelus C.; Roberth H.; Edgar L., and Frederick D. After the death of his wife in 1892, James M. then married Dora Manlove, a native of Rushville, IL in Nov 1895.

Jane (1831-1892), first wife of James M.; born in IL; daughter of Jacob Moyers, a native of PA.

Lawson T. (1851-1917), born in Des Moines Co. IA Jul 5, 1851; a son of James and Jane Rexroat; married on Sep 2, 1875 to Alice Rexroat of Morgan Co. IL; children included: Sarah Lela (Mrs. Albert Burnham); Alta J.; and Carrie.

Peter (1802-1877), born in Philadelphia, PA May 2, 1802; moved with parents about 1810 to Russel Co. KY; married there to Mourning Hopper, a native of PA; they had 6 children including; James M. and Granville R. The family left KY in 1846 and moved to Morgan Co. IL; they moved to Des Moines Co. IA; then, to this county in 1853.

Dovie Irene (1881-1945), wife of James W.; daughter of James B. and Luella (Seaburn) Woods.

RIPPE: Mahala J.; d. May 20, 1922; age 67y 10m 16d; widow; b. Jul 4, 1954 in this co.; daughter of Manson and Margaret (Rexroat) Herndon; Manson, b. in VA; Margaret, b. in KY. Mrs. Rippe was living with a son, Bryce E. Currens, at the time of her death.

SEABURN: Thomas (1830-1903), son of Jacob and Mary (Megrady) Seaburn; Jacob, born in Berkley Co. VA in 1791; veteran of the War of 1812; married in 1823, in Ross Co. OH to Mary Megrady, a native of PA; the family moved to Table Grove, IL about 1843; Jacob died there on Jan 29, 1878. Jacob and Mary had 7 children, including: Thomas and George. Thomas was born in Ross Co. OH; lived with his parents till about 1853, when he bought a farm in New Salem Twp., this county; contracted typhoid fever in 1854 and was bedridden for a year; married on Feb 21, 1860, to Annie E. Johnston; had 5 children: Mary Luella (Mrs. J. Bird Woods); Johnston S.; Frank T.; Jessie May and Edwin J. (twins).

Annie E. (1840-1919), wife of Thomas; daughter of David and Sarah (Day) Johnston, who lived in Pike Co. IL; David was born in 1798, in Wythe Co. VA; he died in 1879; Sarah was born in 1801, and died in Pike Co. IL in 1865. David was a Pike Co. surveyor for several years.

SHANNON: Charles (1781-1852); born in Greenbrair Co. VA; moved to Knox Co. TN; in 1819, moved to Gallatin Co. IL, then in 1830, to Industry Twp., this county. Charles appears on the 1840 county tax list as #422; he owned no real estate and \$75 worth of horses, \$22 loaned out, and \$120 in other property; taxes were \$1.09.

STALEY: William (1832-1892); born in Staffordshire, England; son of Robert and Edith (Blower) Staley; married to Nancy A. Marr on Feb 19, 1873.

Robert (1790-1867); married Edith Blower in England on Feb 13, 1830; Robt. Was a dairyman and came to America in 1856; they came to Fulton Co. IL; farmed there a number of years.

STEPHENS: Clarissa V. (d. at age 30); wife of James; daughter of Stephen and Mary (Dorris) Yocum.

SYLVESTER: Charles M. (1858-1908), lived at Pennington Point; married to Mary E. Elwell, daughter of Thomas and Ellen E. (Edwards) Elwell; Chas. and Mary moved from this county to Fairfield, Clay Co., NE.

THOMAS: George W. (1834-1898); born in Pickaway Co. OH; his father was from MD and died in OH in 1858; George and Nancy E. Mitchell were married on Sep 15, 1868; they had 6 children: Otis; Lena L.; Howard and Truman, twins; George W.; and Cera. George W. moved to IL in 1857; lived in Fulton Co. for a while; he returned to OH in 1858 and brought back to this state, his mother and some brothers and sisters. Catherine, mother of George, died in this county in 1901 at age 91. In June, 1861, George enlisted in the army and served for over 4 years. (Obit, in part, from The Macomb By-Stander, Jul 13, 1898): "George W. Thomas died at his late home near Washington, IA Friday of last week, while at work in the hay field. Death was caused from heart trouble ... funeral services held at Pennington Point. Deceased was born in Pickaway Co. OH May 25, 1834, and remained with his parents till age of 21. He came to Illinois in 1857, and the following year went back and brought his mother and her family to this State. In 1861, Mr. Thomas enlisted in the war, and served as a member of Company H, Twenty-eighth Illinois Infantry. He participated in all the engagements of his regiment, and escaped any serious wounds. In 1868, Mr. Thomas was united in marriage with Nancy E. Mitchell at Pennington Point. She and three children, George, Otis, and Cora, survive him. He also leaves his aged mother, Mrs. Catherine Thomas of Industry, and five brothers – Samuel of Industry, John Solomon, Robert, and William of Macomb...."

George W. (1834-1898); enlisted at Blandinsville on Aug 14, 1862; served as a private with Co E 118th IL Inf; promoted to Corporal; disabled; and discharged on Oct 10, 1864.

Nancy E. (1836-1911), wife of George W.; daughter of John and Phoebe A. (Britt) Mitchell; John was born in Greene Co. PA in 1799; Mrs. Mitchell was a native of VA, born in 1800; she died in this county in 1880.

Catherine (1810-1901), wife of William; she was born in VA; a daughter of James and Catherine (Phelps) Anderson, natives of VA; William and Catherine moved to Fairfield Co. OH with his parents; lived there till his death in 1858. William and Catherine had 12 children – 8 boys and 4 girls; a son, Robert, born in Pickaway Co. OH on Jul 27, 1849, later became McDonough Co. Sheriff. Catherine Thomas and her children moved to this county about 1859.

John (1842-1910); enlisted in the army in Eldorado Twp. on Jul 31, 1861; mustered out on Jun 8, 1865.

THROCKMORTON: Jacob (1829-1880) farmed on section 21, New Salem Twp.; he was born in OH and moved here in 1863 from Ross Co. OH.

VAIL: James M. married Elizabeth J. Pennington in this county on Sep 21, 1843.

WALKER: Solomon (1826-1895) farmed on section 13, Scotland Twp.; he was born in VA; moved to this county in 1856 from IA.

WATERS: Gideon B. (1818-1885) (Obit, in part, from The Macomb Journal, Sep 17, 1885): "Gideon B. Waters died in the early part of this week at his home near Omaha. He had moved to Nebraska about 3 years ago. Burial will be in Pennington's Point.... He was born at Warren, Trumbull Co. OH on Apr 11, 1818. His parents had come from Conn. to Ohio where they were among the colonial settlers of that state. At age 17 years, Gideon became a teacher; in 1837, he came to Pennington's Point, IL and taught the first public school there. He then went to Peoria where he was a postmaster and was in the grocery business. On Oct 30, 1845, he married Miss Mariah M. Francis. After his marriage, they returned to Pennington's Point and remained there until 1848, when he made an overland trip to Calif. There he was in the hay and stock business, going north to Oregon to buy cattle and then driving them to the Calif. Mining districts. He was in that business for 3 years when he sold out and returned to his family at Pennington's Point and there remained until 1882, during which time his wife died, leaving him 3 sons and 5 daughters. In 1876, he married Francis A. Warner, who survives. In 1882, he bought the farm of B.W. Briggs in the Louisville district of Cass Co. Nebr., where he moved in February, 1883...." Gideon B. Waters appears on the 1840 county tax list as #416; he owned no real estate; had \$100 worth of horses, \$200 in carriages, and no other property listed; taxes were \$1.50.

George (1861-1922) (Obit, in part, from The Macomb Daily Journal, Nov 16, 1922): "The remains of George Waters, who died at Adair last week were buried in Pennington Point Cemetery. Deceased was born in Pennington Point neighborhood some 60 years ago, and grew up and lived all his life there until a few years since he moved to where he died. He never married. After the death of his father, he cared for his mother, who yet survives him...." George H.; d. Oct 21, 1922; age 61y 7m 3d; b. Mar 18, 1861 in New Salem Twp.; son of Augustus and Celestia (Butler) Waters; Augustus, b. at Trumble Co. OH; Mrs. Waters also b. in OH; Mr. Waters was a retired farmer; never married.

Augustus (1822-1901) farmed on section 7, New Salem Twp.; he was born in OH and moved here from Lake Co. OH in 1853.

WATSON: Archibald (1830-1879) born at Argyleshire, Scotland; moved to America with several brothers in 1851; settled near Camp Creek in Scotland Twp; married on Jun 6, 1861 to Agnes Barclay; they had 6 children: Mary J.; Hugh W.; James A.; Isable; Albert T.; and Mattie L.

Thomas D. (1857-1881) and Cathiren J. (1860-1861) were children of Alexander and Isabella (Galbraith) Watson; the family lived in Scotland Twp.; other children in the family were: Hugh; Dugal A.; John W.; Anna B.

Thomas and Margaret (Barclay) Watson were the parents of the infant daughter that died on Sep 24, 1875; other children of Thomas and Margaret were: Agnes J.; Ella E.; Mary B.; Annie L.; Harvey W.; and Mattie M.

Hugh Watson, who was born and died in Scotland, was the father of Alexander (1826), John (1824), Thomas (1836), Archibald (1830) and Hugh (1828).

WILCOX: John M. (1826-1895), born in Carroll Co. KY; son of Benjamin and Flora (McCormick) Wilcox; Benj. was a native of KY; he died in Carroll Co. in 1836; Flora was born in Lexington; John M. moved to this county with his widowed mother and 6 other children; John M. went to Calif. In 1849 and was there mining for 3 years; returned to this county and in 1853, bought a farm in Mound Twp.; he married Mary Z.V. Yocum on Mar 13, 1855; had children: George T.; Elvia J.; William F.; Mary A.; Robert C.; John R.; Delia; and Lee.

Mary Z.V. (1834-1882), wife of John M.; daughter of Stephen and Mary (Dorris) Yocum.

John B.; farmer; single; b. in IL; d. of typhoid fever in Scotland Twp. Oct 25, 1881 age 24y 10m 5d.

WILKINS: William G. (1838-1917); born in New Salem Twp., this county, Dec 21, 1838; raised by the William Ritter family of Fulton Co.; married in Feb 1863, to Susannah Reddy; had 3 children: Mary L., Orion R. and Uriah G.

WILLIAMS: Washington (1823-1890) born in Muskingum Co. OH; a brother of Lafayette Williams; they came to this county in 1854; bought a farm in Bethel Twp.; later bought farms in New Salem Twp.

Isadora (1856-1889), wife of L.M.; daughter of Thomas and Ann (Hall) Adcock; married Oct 25, 1876; farmed in New Salem Twp.; children included: Walter, Clarence R., and Orbra.

Malissa; born Rushville, IL; died at Pennington Point in 1879; age 27y; single.

WOODS: James Bird (1856-1913), son of Dan'l and Jemima (Hammer) Woods; born in New Salem Twp., this county; married in Dec 1878, to Louella Seaburn; had 2 children: Dovie Irene (Mrs. James Rexroat) and Guy R.

Louella (1862-1928), wife of James Bird Woods; daughter of Thomas and Annie E. (Johnston) Seaburn.

Salem (1799-1879) born in Madison Co. NY Jun 4, 1799; son of Sam'l Woods; Salem moved first to Erie Co. PA; worked as a saddle and harness maker there; then came to this county in 1828; bought a property in New Salem Twp. prior to coming here; remained here a few weeks in 1828, and returned to Erie Co. PA; returned here in 1831 with his family; married in NY on Jun 12, 1823, to Cornelia Grow, a native of NY; had 6 children: Morillo; George H.; Daniel D.; Almeda L. (Mrs. Randolph Hall); Edward; and Jonas Platt. Salem died Sep 28, 1879 at Pennington Point age 80y 3m 24d; farmer; in IL since 1833. Salem appears as #420 on the 1840 county tax list; he owned 160 acres, the NE¼ of section 30, New Salem Twp.; value of the land was \$7 per acre; he also had \$200 worth of horses, \$83 cattle, \$10 clocks & watches, \$40 wagons, and \$1,120 in other property; total taxes were \$8.04.

Daniel D. (1827-1902), son of Salem and Cornelia (Grow) Woods; born in PA; moved here with parents in 1831; mined for gold in Calif. for 2-3 years in the early 1850's; returned here and on Mar 2, 1854, married Jemima H. Hammer; bought at New Salem Twp. a farm; had 5 children: Licetna A. (Mrs. Whitney S. Leighty); James B.; Clara G. (Mrs. Austin Pontious); Laura C. (Mrs. W.O. Thomas); Edgar H.

Jemima H. (1832-1894), wife of Daniel D.; daughter of James E.D. and Nancy (Pennington) Hammer.

WOOLLEY: Lewis B. married 2nd to Nancy Greenup on Sep 2, 1846. Lewis B. (1807-1866) appears on the 1840 county tax list as #410; he owned 80 acres in the SW¼ of section 24, Scotland Twp.; value of the land was \$4 an acre; he also had \$125 worth of horses, \$20 cattle, \$10 clocks and watches, \$50 wagons, and \$125 worth of other property; total taxes were \$3.25.

WORTMAN: Joseph B. (1833-1880); enlisted at Scotland Twp. on Aug 4, 1862; promoted to Corporal; wounded in action; discharged on Apr 2, 1863.

WRIGLEY: Hugh L. (1866-1869), son of Thomas H. and Virginia (Jones) Wrigley; Thos. was a son of John & Rebecca (Homes) Wrigley, natives of KY; married Virginia Jones, of Scotland Twp. in 1861; she died on Feb 20, 1882; other children of Thomas and Virginia were: James H.; Grant; Rosetta; Nora; Thomas L.; Wilber; and Myrtle. The family lived in Bethel Twp.

YOCUM: Stephen Powell (1800-1874); born in Montgomery Co. KY Feb 17, 1800; son of George and Rebecca (Powell) Yocum, natives of VA; Stephen was one of 11 children; he came to Marion Co. IL and on Sep 29, 1829 was married to Mary Dorris; moved to this county in 1833; lived near Camp Creek; Mr. Yocum attained the rank of Major with the State Militia during the Black Hawk Wars of 1831-1832; he and Mary had 11 children – 2 boys and 9 girls. Stephen's children were: Rebecca J. (Jones/Baer); Amanda M. (Mrs. Jesse Tatman/Mrs. Wm. Rowark); Eliza H. (Mrs. Wm. Toland); Telitha C. (Mrs. George T. Harlan); Mary V. (Mrs. John Wilcox); Hester C. (Mrs. Wm. Harlan); George F.; Elzira R. (Mrs. John Q. Burleigh); Clara (Mrs. James Stephens); and Milton H.

Stephen appears on the 1840 county tax list as #412; he owned no real estate; had \$260 worth of horses, \$60 wagons, and \$320 worth of other property; total taxes were \$3.73.

Mary (1809-1879), wife of Stephen; daughter of John Dorris, who moved from Smith Co. TN to Marion Co. IL in 1827.

George R. (1838-1862), son of Stephen and Mary Yocum; killed at the Battle of Stone River; his body was never recovered from that battlefield, however, a large stone was erected for him on the family burial plot at this cemetery.

Notes, Corrections, Additions, and Changes

DAILEY CEMETERY

Location: Eldorado Township, NW¼, section 6; two miles south of Pennington Point.
40° 21' 38.2" N: 90° 33' 28.3"W

Remarks: This family graveyard is situated on privately owned land and is about one-fourth mile from a public road. It is located about one-quarter mile directly east of the N550 Road, E1800 Street intersection in the middle of an agricultural field and not visible from the road when corn is planted. It is completely fenced, however, is grown over with brush and weeds.

DAILEY:

Elizabeth, dau of T. & S.; d. Sep 17, 1858; age 13y 3m 2d.
Thomas.; d. Jan 1, 1854; age 71y.
Sarah, wife of Thos.; d. Nov 21, 1862; age 72y 7m 8d.
Elvira G. dau of J.W. & M.; d. Dec9, 1856; age 5y 9m 3d.

GREENUP:

Catharine; d. Jun 27, 1854; age 79y 3m 15d.
George B.; d. Sep 5, 1844; age 29y 2m 20d.

PENDELL:

Mary Ann, wife of W.L.; d. Feb 21, 1867; age 34y 9m 21d.
Margaret, dau of W.L. & M.A.; d. Nov 21, 1863; age 1y 2m 19d.
Infant son of W.L.& M.A.; (no dates).

Genealogical Notes – Dailey Cemetery

DAILEY: Thomas (1783-1854) born in VA (WV); married Sep 22, 1814, to Sarah McIntosh, also of VA (WV); had 8 children; moved to Sangamon Co. IL in 1835; and to this county about 1836, and settled on section 6, Eldorado Twp. Thomas is listed in the 1840 county tax list as #428; he owned 160 acres, the NE¼ of section 6, Eldorado Twp.; also had \$150 worth of horses, \$100 cattle, \$10 clocks & watches, \$75 wagons, and \$259 in other property; total taxes were \$4.57.

Elvira G. (1851-1856) was a dau of John W. & Martha (Orr) Dailey who were md. in this county on Feb 26, 1846.

GREENUP: George B. md. Rebecca M. Dailey in this county on May 22, 1839. George B. appears on the 1840 county tax list as #426; he owned no real estate; personal property consisted of \$100 worth of horses, \$80 cattle; \$40 wagons; and \$125 worth of other property; taxes for that year were \$1.73.

NOTE: Other Greenup's appearing on that 1840 tax list were John (#413) and Thomas W. (#429).

Notes, Corrections, Additions, and Changes

MILES CEMETERY

Location: Eldorado Township; located on the Stanford O'Hern farm, in the NE¼, section 23.
(Information on this cemetery was furnished by Mrs. Elizabeth Grimm of Macomb, IL, copied May 14, 1976.

40° 18' 51.9" N: 90° 28' 27.3"W

Remarks: This cemetery is unkept and cattle have been pastured in it.

BOWLEN: John; d. Jun 16, 1886; age 58y 7m 14d.

MILES:

Martin; b. Dec 21, 1800; d. Mar ----, 1882.

Betsey, wife of M.; d. Feb 6, 1879; age 75y 29d.

Sarah A.; b. Nov 20, 1824; d. Apr 24, 1898.

Genealogical Notes – Miles Cemetery

BOWLEN: John (surname also spelled BOLIN): a "John S. Bowlin" appears in the list of men who served during the Civil War from this county. He enlisted at Macomb on Aug 9, 1862; discharged Feb 18, 1864; wounded. He had served as a private with Co C 84th IL Inf.

MILES: Martin was a son of Isaac & Rosanna (Hollenbeck) Miles; he was born near Charleston, SC; md. Betsey Smith on Mar 21, 1822; Martin moved to OH with his parents in the early 1800's; his father died in Lawrence Co. OH on Nov 15, 1812, at age 33 Martin and his family (including his mother) moved to IL in 1828 and lived several years in Sangamon Co.; they moved to this county about 1836; settled in Eldorado Twp.; Martin and Betsey had 10 children; 5 sons and 5 daughters; including in these children were: Augustus G. (killed during the Civil War at Chickamauga at age 22); Sarah; Rosanna (Mrs. S. D. McFadden); Betsey (Mrs. Elisha Keach); Charles; and Martin; 4 other children died prior to 1885. Martin Miles' paternal grandfather was Charles Miles, a native of SC; Charles and his wife had 15 children – 1 son and 14 daughters; the elder Miles served years in the army during the Revolutionary War; he died in 1811, at the age of 105; Charles wife died in 1816.

Betsey, wife of Martin, was a daughter of Augustus Smith of Tennessee Co. OH. Martin appears on the 1840 county tax list as #565; he owned no real estate at that time; personal property consisted of \$100 worth of horses; \$100 cattle; \$50 carriages; and \$50 in other property; total taxes were \$1.50.

A daughter of Martin Miles, Elizabeth, md. Elisha Keach in this county in 1862. Martin served in the military from this county during the Mormon War of 1846.

Fulton Co. 1879 History lists a Martin Miles born in McDonough Co. in 1837 and operated a meat market in Vermont in 1879. Perhaps this is a son of Martin that is buried in this cemetery.

RUSSELL: Rosa; (NOTE: Local history accounts indicate that Mrs. Russell died in 1844 at age 72 years). Mother of Martin Miles; maiden name was Hollenbeck; she was from a family of 18 children – 15 girls and 3 boys.

Notes, Corrections, Additions, and Changes