

**RURAL  
CEMETERIES  
OF  
McDONOUGH COUNTY, ILLINOIS**

**VOLUME II  
BETHEL-INDUSTRY**

**BY DUANE LESTER  
GOOD HOPE, ILLINOIS**

**PRINTED BY  
SCHUYLER – BROWN  
HISTORICAL AND GENEALOGICAL SOCIETY  
AND  
THE SCHUYLER JAIL MUSEUM**

“A monument is erected  
not because a person died,  
but because a person lived.”

## Volume II

### Table of Contents

Preface	i – ii
Maps and plats	iii – iv....ix-xiv
McDonough County, Illinois	iii
Areas Covered in Volumes I - XVII	iv
Section 32: Industry Township, T4N R2W, 1871	ix
Section 14: Bethel Township, T4N R3W, 1871	x
Section 22: Bethel Township, T4N R3W, 1871	xi
Section 28: Bethel Township, T4N R3W, 1871	xii
Section 33: Bethel Township, T4N R3W, 1871	xiii
Section 35: Bethel Township, T4N R3W, 1871	xiv
Clayton Cemetery	1
Doddsville Cemetery	2 - 14
Pioneer Cemetery	15 - 18
Pennington Cemetery	19 - 21
Pruitt Cemetery	22
Stoneking Cemetery	23 - 28
Stoneking Graves	29
Vawter Cemetery	30 - 31
Willey Cemetery	32 - 33

## Preface

Within the boundaries of McDonough County, Illinois are more than a hundred cemeteries and gravesites ranging in size from a single burial site to the expansive Oakwood Cemetery at Macomb. Within these cemeteries are the remains of an estimated 40,000 individuals who have died since the first settler arrived here over 150 years ago. Graves of countless others are scattered over the countryside of McDonough County; but, exact sites of many of these resting places are no longer known for various reasons. During the early days of this county, there were obviously no central burial grounds; thus, a pioneer family having the misfortune of losing one of its members placed the deceased in a grave on a family homestead and erected a makeshift marker. A number of these family burial grounds later became public cemeteries, however, many of the grave sites soon became "lost". Crude wooden markers or hand engraved stone soon succumbed to the elements and were never replaced; scores of families moved further west after staying in this area only a short time and the gravesites of their loved ones shortly became insignificant mounds of earth; a number of families passing through this vicinity suffered individual losses. A prime example of the latter is contained in a history of Bethel Township. In 1830, four children of an emigrant family died while en route through McDonough County. They were buried near their places of death which occurred about two miles southwest of Fandon. All traces of those graves have long been gone. During the summer of 1834, a widow lady died at her home in northern Tennessee Township. Her coffin of dressed walnut lumber was built by a local cabinet maker and she was buried in the timber near her home. Within a few years, no evidence remained to indicate the presence of her final resting place. A family who created an excellent farm from the prairies a few miles north of Macomb, maintained a fenced family burial site for several years. This cemetery contained the graves of about 12 former family members. During the early 1900's, the farm changed ownership. Shortly thereafter, the new owner removed all the stones, took down the fence and this graveyard became part of a cornfield. These are only three of the countless incidents involving the total disappearance of burial sites. At this time, it is impossible to determine the locations of hundreds of individual's graves in this county.

Vandalism is responsible for the destruction of many grave stones. Countless markers have been partially or totally destroyed. Inscriptions have been obliterated by gunshot blasts, stones have been broken into dozens of pieces, and some markers have been entirely removed from their original locations.

While weather-wear and vandalism accounts for most of the destruction of individual tombstones, neglect is directly responsible for the eventual deterioration of graveyards. Several local cemeteries have had no protective fencing for a number of years and the grounds have become grazing land for livestock. Groundhogs and other burrowing animals have undermined large portions of various cemeteries. Some areas are nearly invisible because of massive growth of weeds and brush. Stones have fallen, broken, and become completely covered with soil and debris.

The overall condition of our county cemeteries is a pathetic case. While some grounds are well maintained, or at least partially kept-up by various families, many have been totally forgotten. This situation is appalling and should never have come about. Apparently, lack of time, expense, and most of all regard has brought about the present-day poor conditions of many of our rural cemeteries.

Genealogical notes accompanying the various cemetery listings were prepared from a wide variety of sources including: Local area history books and atlases; newspaper files; county, state, and federal archives; family histories. These notes were collected at random from readily available sources and little, or no attempts were made to search for material for more complete genealogies. These notes are presented only for the purposes of identification and/or clarification.

Every attempt has been made to present complete and accurate information. Readers will find errors and omissions. Others will not agree with portions of my findings; however, no information contained herein is based solely on assumption or guesswork. It must be remembered that this information has been prepared for use only as a tool for further research and that nothing must be taken as final and absolute.

The larger cemeteries contained in these volumes are accompanied by grave location charts. These charts in no way are intended to represent any professionally prepared plat or survey that may exist. Their preparation and presentation are solely for general location purposes.

When copying inscriptions from grave markers, it is sometimes impossible to read some portions of the engraving. Names, dates, ages, etc. that were found to be unclear or totally missing are indicated by the use of question marks or dashes, i.e., SPICER, James T., infant son of ?J.B. & S.J.?.; d. \_\_\_\_; age \_\_\_\_\_. The letters or numbers enclosed in parenthesis following the inscription, indicated general location as indicated on the accompanying chart.

Abbreviations used are as follows:

b. born	m. months
Cav. Cavalry	md. married
Co. County/Company	sec. section
d. died/days	twp. township
dau. daughter	y. years
Inf. Infantry	

Time and space prohibits proper recognition for all those individuals who gave assistance in preparing and publishing these volumes. Deep and sincere appreciation is extended to all concerned, especially to the following: My parents, Mr. and Mrs. Lloyd Lester, and my wife, Rose; and to Mrs. Lavina Walton and other members of the Schuyler County Historical and Genealogical Society for printing and binding the finished product. Thank you.

Duane Lester

### ADDENDUM

Mr. Lester's Magnum Opus is nothing short of monumental. It is not easy to gain access to many of these historic family burial sites. By the time of Mr. Lester's survey (1970's) numerous plots were long left abandoned, overgrown with trees and weeds and monuments under attack by weather, livestock, vandals, and property owners who did not care about the burial sites of McDonough County's brave pioneers. Thankfully, we now (2012) have laws to protect our county's historical legacy and these final resting gardens.

I am in awe of Mr. Lester for his transcriptions of hard-to-read tombstones and his laborious typing of his 18 Volumes of the Rural Cemeteries of McDonough County. He did not have access to a computer. In addition to transcribing information from tombstones, he had to painstakingly access county records (e.g. 1840 county tax list), federal census records, and local newspapers requiring a great deal of time and effort. As a genealogist in 2012, I have access to the internet with fast access to US Census records, Family Search (records kept by the Church of Jesus Christ of Latter-Day Saints) and numerous other legal documents, books, and family journals. Mr. Lester used an old-fashioned key-strike, ribbon tape typewriter where mistakes were hard to correct and appear as overstrikes. There are very few attesting to his skill as a typist. What an US Census record will not contain are the names and dates of infants who died between census surveys. Mr. Lester's tombstone records give names and dates of children, whose lives were brief, but would otherwise be lost to history without his efforts. Frequently, he provides names of brothers and sisters, fathers and mothers that allows for completion of family group sheets.

Another work of love for those who dared to settle the prairie lands of western Illinois and raise their families is being performed by Dr. A. Gil Belles. He has been able to install signs for each of these rural cemeteries and provide GPS (Global Positioning System) information making it easier for anyone wishing to visit a rural cemetery to help them actually find it. Gil also works closely with Boy Scouts and other civic groups to help cleanup, clear brush and dead trees, locate buried tombstones, and restore stones. My revision of Mr. Lester's document will provide information on all cemetery restoration projects.

Any changes made to Mr. Lester's original work was done in blue color font. His maps were scanned and copied into the text and remain like his original work and are not subject to editing. His text was transcribed using MS Word, enabling me to control font size and color. Retyping text also leaves room for typo errors. Mr. Lester's rare typo errors are corrected but not displayed in blue. This MS Word document allows on-the-fly editing of any "Notes, Corrections, Additions, and Changes" found at the end of every cemetery. This was Mr. Lester's intent to produce a working document and improve accuracy about the information on those buried. I have retyped state abbreviations as they are now used (e.g. IL, instead of Ill.). On 1840 county tax lists I omitted cents (e.g. \$140, instead of \$140.00). The current MS Word font uses less space, thus, placing more text per line. This shrinks his documents and reduces pages. This, then, changes page numbering in each Table of Contents. Cemetery locations are also found on the internet. See: **McDonough County Illinois Cemeteries** <http://graveyards.com/graveyards/IL/McDonough>



McDonough County, Illinois

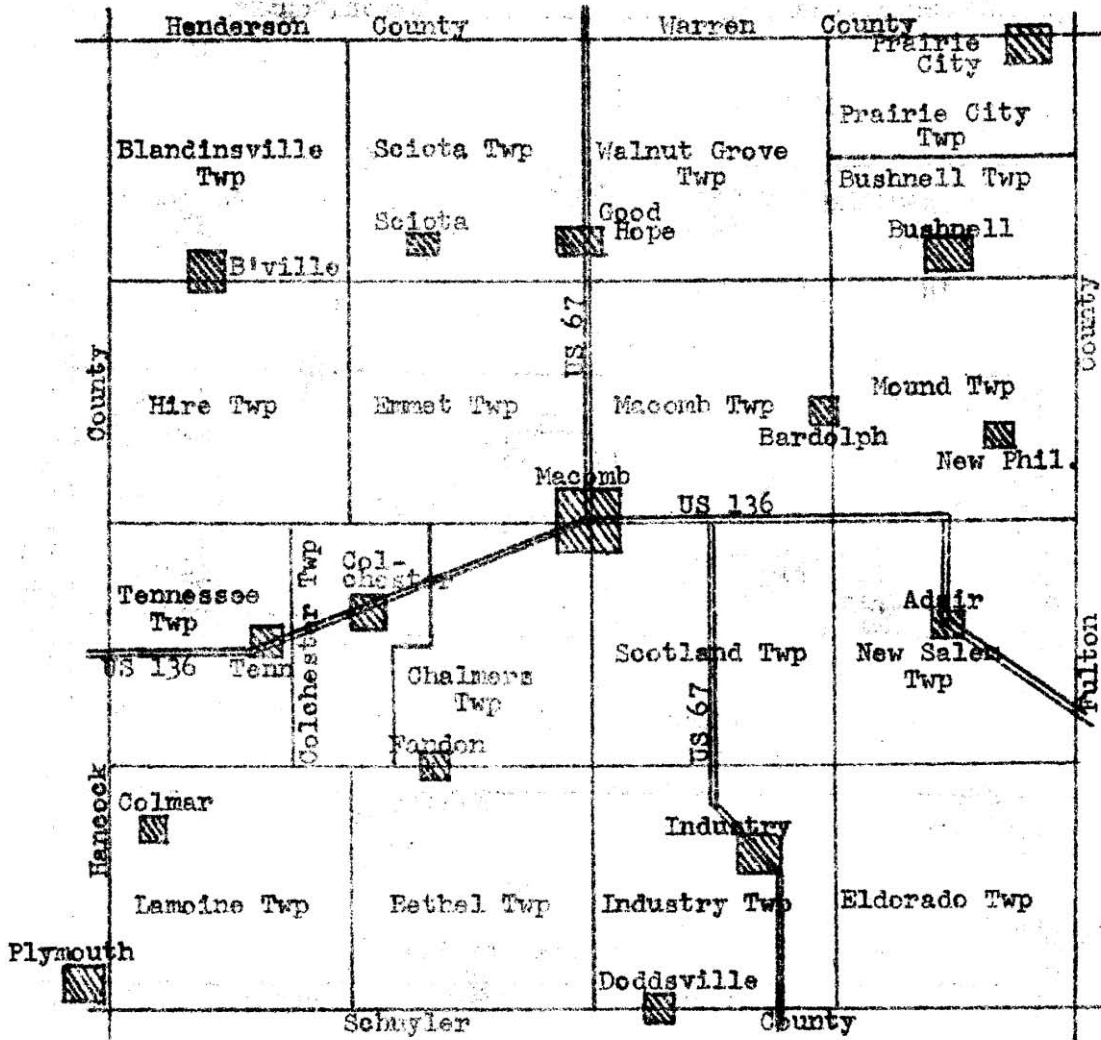

Areas covered by volumes I - XVII  
 "Cemeteries of McDonough County, Illinois"

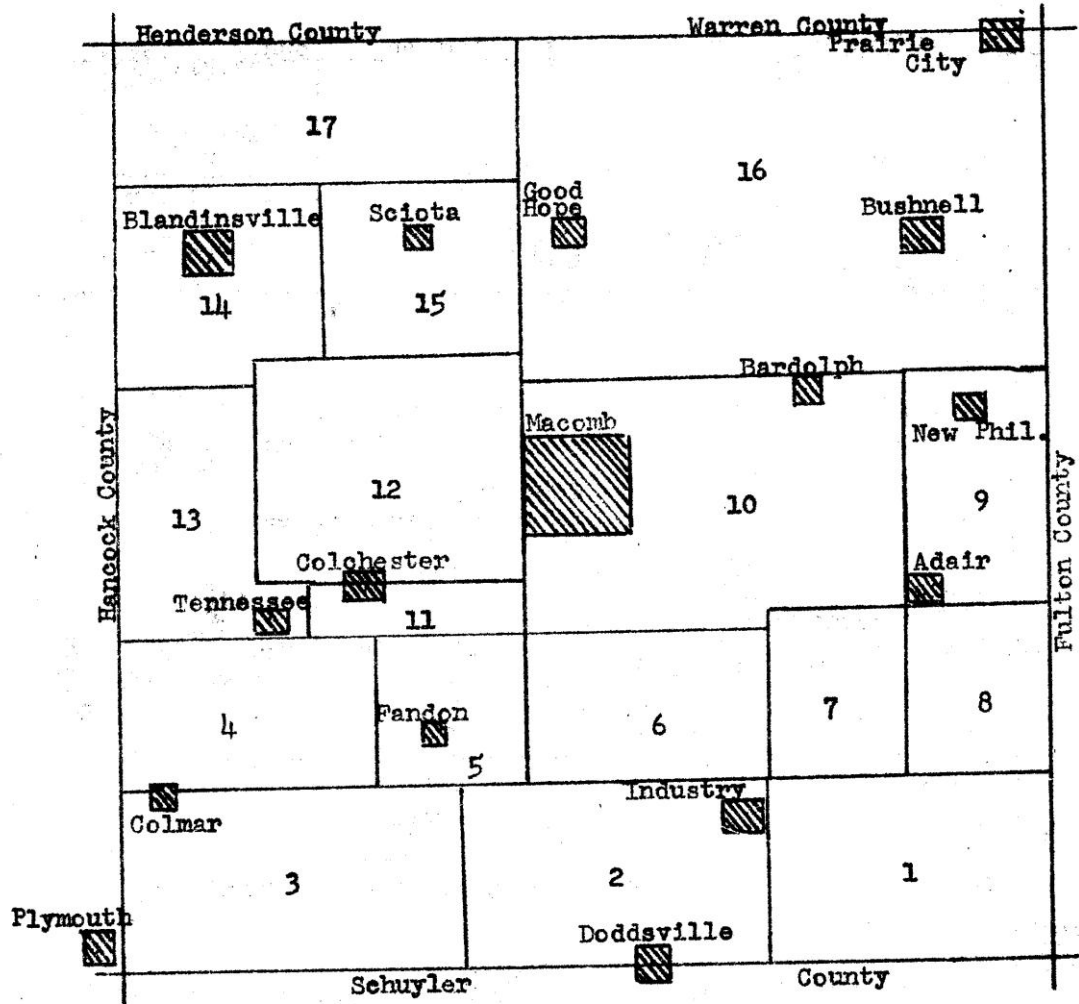

Section 32  
Industry Township, T4N R2W; 1871

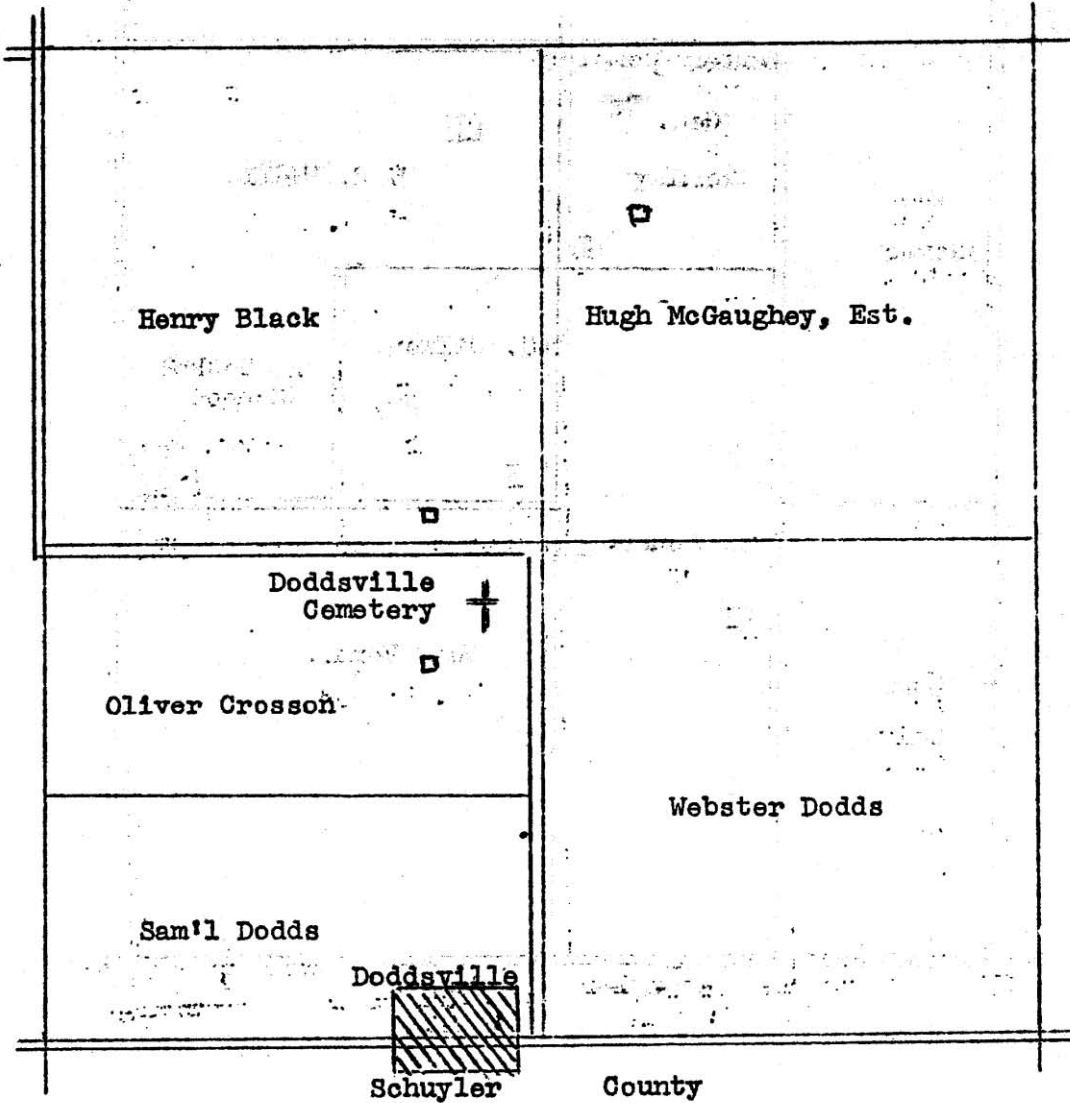



Section 14  
Bethel Township, T4N R3W; 1871

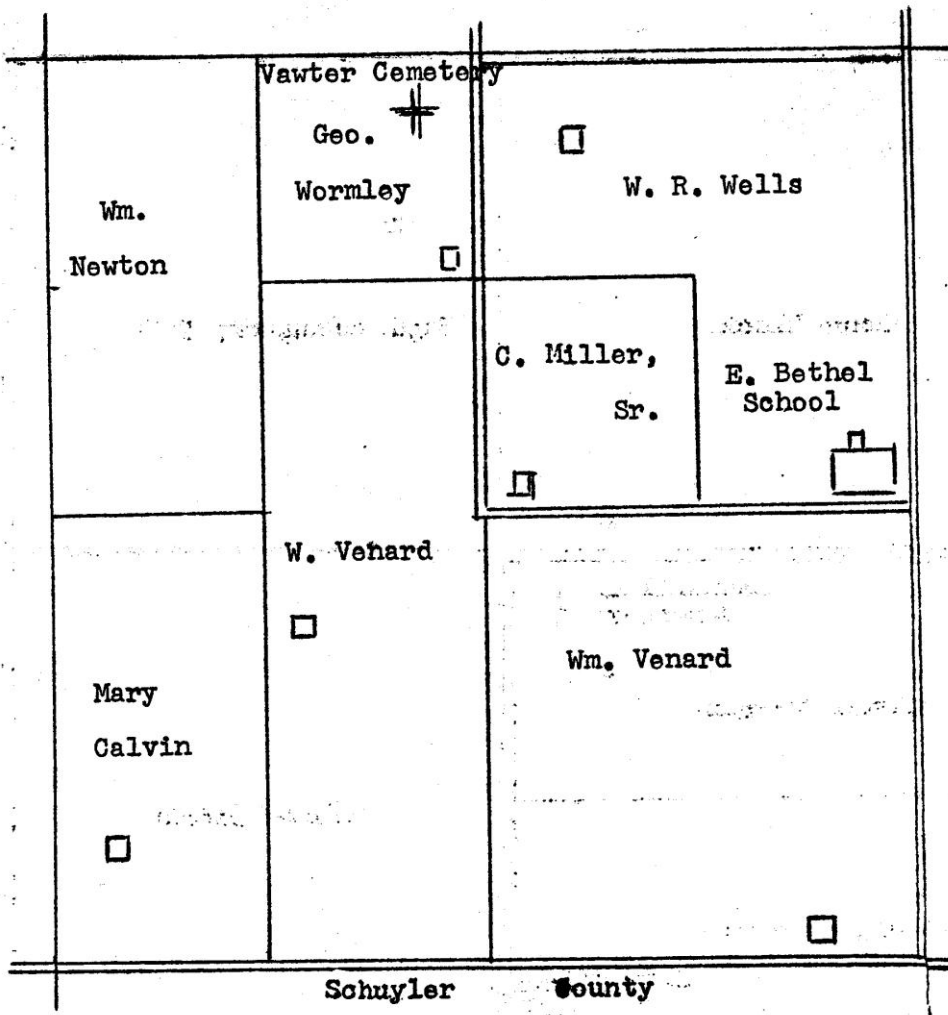

Section 22

Bethel Township, 14N R3W; 1871

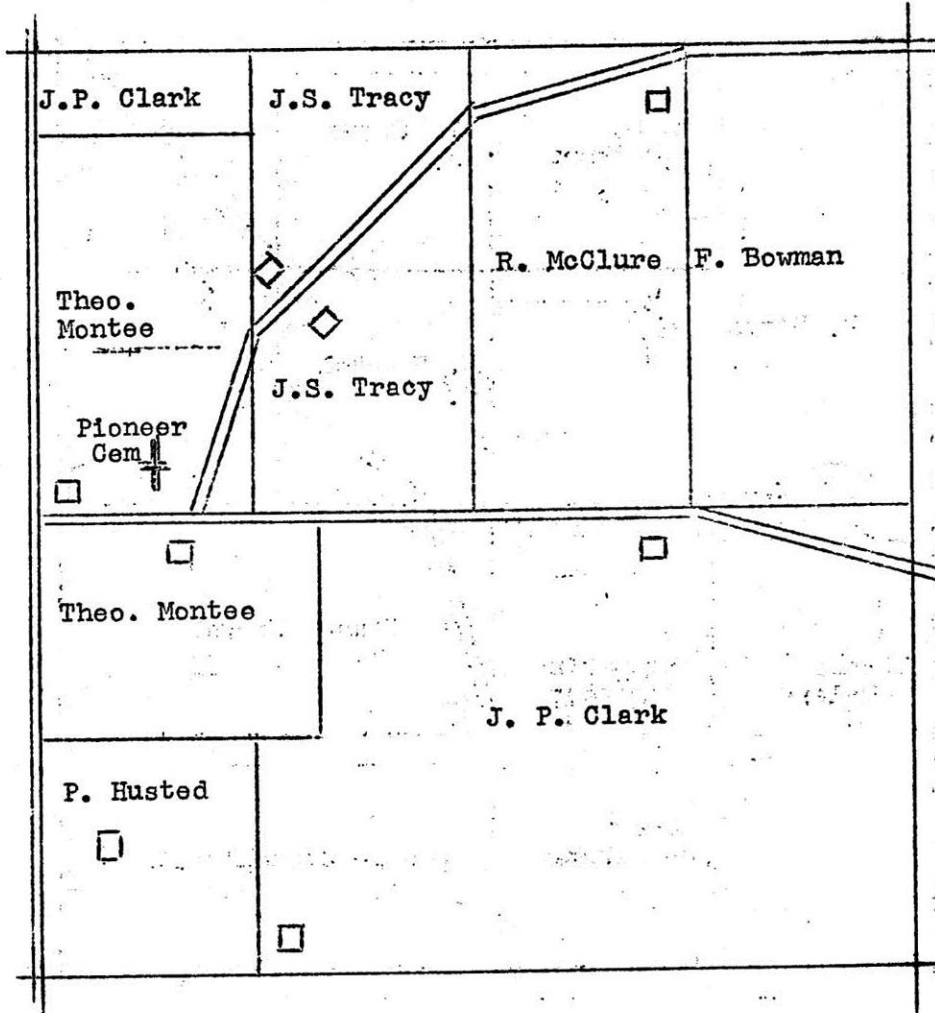

Section 28

Bethel Township, T4N R3W; 1871

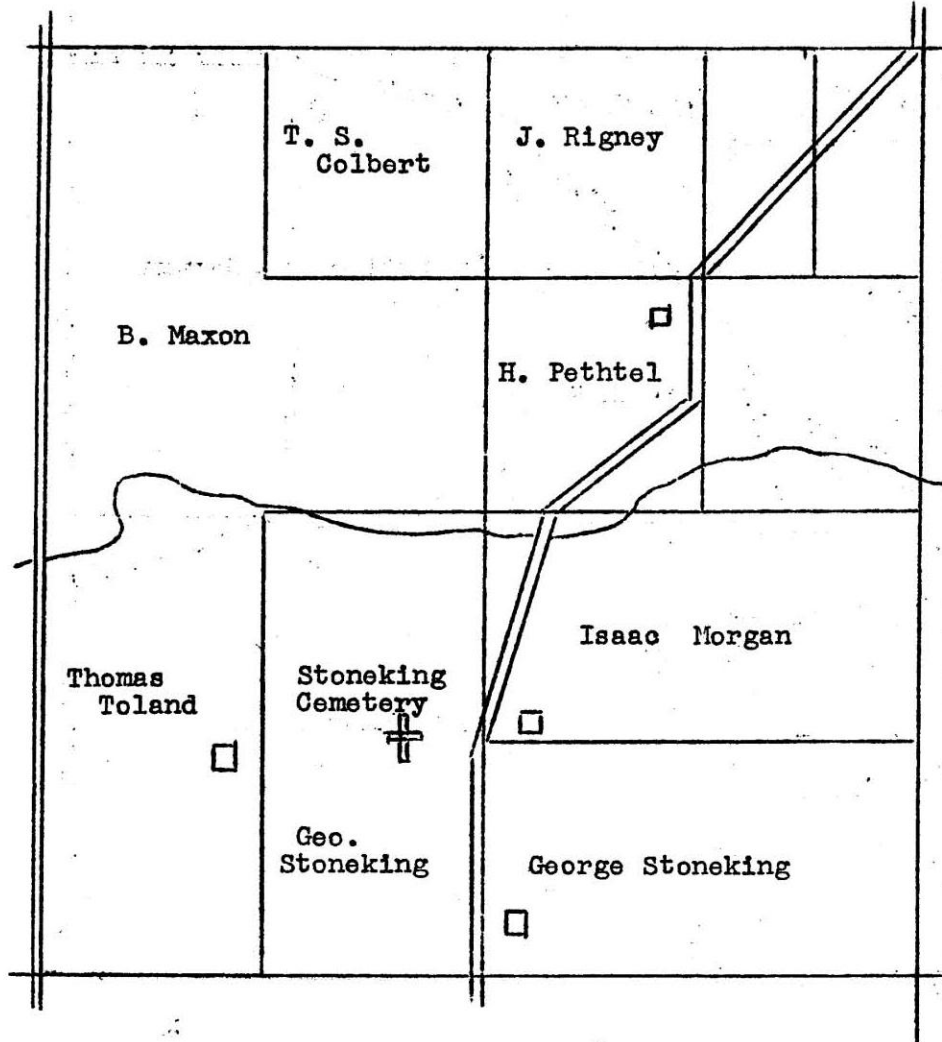

Section 33

Bethel Township, T1N R3W; 1871

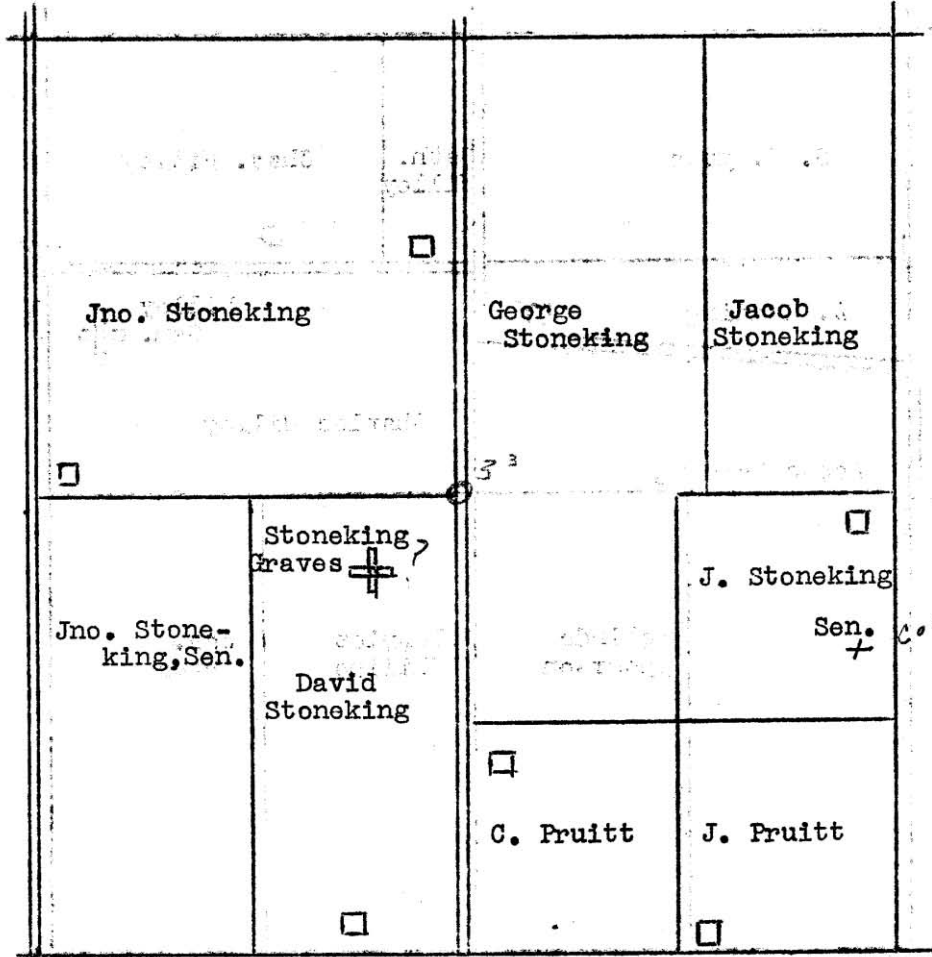

Schuyler County

Section 35

Bethel Township, T4N R3W; 1871

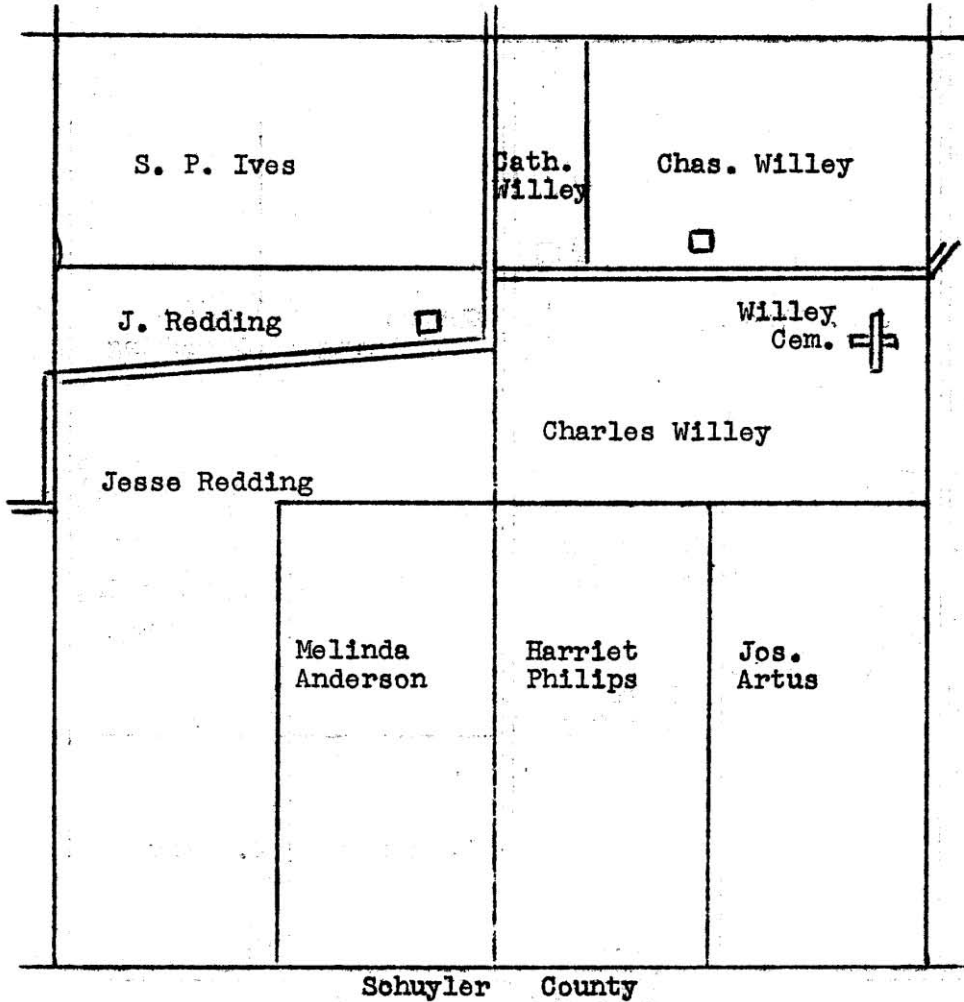

## CLAYTON CEMETERY

Location: Industry Township, NW¼, section 28; 2 miles southwest of Industry.

40° 17' 58" N: 90° 38' 3.5"W

Remarks: This family burial plot is situated on privately owned property and is about one-fourth mile from a public road. The grounds are not fenced, however, the current landowner is now making efforts to clear the brush and weeds within the small area. Most stones remain standing and all are in relatively good condition.

### CLAYTON:

Margaret, wife of W.; d. Sep 17, 1847; age 41 y 11d.

William, son of W. & M.; d. Jul 25, 1847; age 19y 2m; Pvt., McConnel's Co., 1<sup>st</sup> IL Inf.; Mexican War

Zebulon, son of W. & M.; d. Feb 28, 1847 age 16y 1m 14d.

David F., son of S. & J.R.; d. Nov 6, 1864; age 3y 1m 1d.

Alva R., son of S. & J.R.; d. Oct 4, 1877; age 8y 11m 24d.

### Genealogical Notes – Clayton Cemetery

**CLAYTON:** Margaret (1806-1847), wife of William; Wm. was b. in NJ about 1790; in 1860, he was living in Industry township in the Wm. Peak household.

David & Alva were sons of Samuel & Jane R. Clayton; Sam'l was b. in PA in 1828; son of Wm. & Margaret; in 1871, Sam'l was living on an 80A farm in the W ½ of section 28, Industry Twp.; the Clayton home was located near the site of the Clayton Graveyard. Sam'l & Jane had the following children, in addition to David & Alva: Wm. (b. 1855); Francis (b. 1856); & Grove (b. 1858).

### Notes, Corrections, Additions, & Changes

## DODDSVILLE CEMETERY

Location: Industry Township, SW¼ section 32; one-half mile north of Doddsville, at junction of E1350 St and Township Road 284.  $40^{\circ} 17' 8.3''$  N:  $90^{\circ} 39' 01''$  W

Remarks: The grounds are well fenced and regularly maintained. Several of the older stones, especially in the west portion of this cemetery, have been broken and/or overturned.

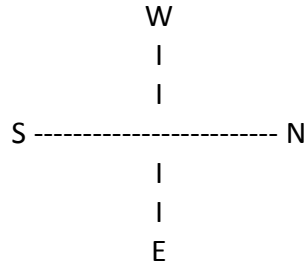

Section SW	Section NW
Section SC	Section NC
Section SE	Section NE

Gate



E 1350 Street



ALLISON:

Mary A. (See BLACK)

ARCHER:

Frank; 1860-1925. (SE)

Martha; 1859 – 1938. (SE)

BAIR:

George; Aug 11, 1816 – Apr 28, 1890. (SW)

Joseph R.; Dec 30, 1838 – Feb 27, 1862. (SW)

Margaret, wife of Geo.; Oct 1, 1818 – (no date). (SW)

Mary, wife of David & Mary; d. Sep 22, 1878; age 70y 6m. (SC)

Jeremiah, son of David & Mary; d. Jul 25, 1867; age 22y 2m 6d; Co C 151<sup>st</sup> IL Inf. (SC)

BARRY:

Lillie M.; 1889 – 1953. (SE)

BARTON:

Richard, son E. & M.; d. Sep 10, 1863; age ---. (SW)

Julia E., dau of E.&M.; d. Sep 15, 1863; age 3y 6m. (SW)

BEAVER:

Eliza J., dau of –M. & L.J.; d. Jan 5, 1867; age 18y 10m 10d. (SW)

BELL:

Jane (See GUNNING).

BLACK:

Carolyn June, dau of M.E. & D.B.; d. Feb 16, 1837. (SE)

Joseph C.; 1881 – 1957. (SC)

Randolph; 1885 – 1938. (SC)

Robert Irvin; Feb 11, 1909 – Jan 23, 1929. (SC)

Henry; d. Oct 7, 1885; age 66y 5m 4d. (NE)

Mary A. Allison, wife of Henry; Jan 15, 1822 – Jan 13, 1903. (NE)

Robert R.; d. Oct 5, 1870; age 20y 8m 5d. (NE)

Ina Myrtle, dau of M.L & S.E.; d. Jun 29, 1893; age 11y 10m 1d. (SC)

BOWLS:

William; d. Sep 1, 1861; age 19y 1m 10d. (SW)

BRENT:

Esta M., dau of G.L. & M.J.; Jan 11, 1882 – Jul 29, 1887. (SE)

BRIGGS:

Isaac E.; 1876 – 1956. (SE)

Marie A.; 1876 – 1956. (SE)

BRUNTON:

Emaline, dau of J. & S.; d. Oct 7, 1854; age 1m 4d. (SW)

BURNHAM:

Henrietta, dau of Walter & T.; d. Feb 9, 1921. (SW)

John A.; 1859 – 1950. (SE)

Ella, wife of John; 1861 – 1939. (SE)

Infant son of J.A. & E.A.; Jul 15, 1901. (SE)

Paul G.; Jan 18, 1869 – Mar 12, 1907. (SC)

Elizabeth, wife of Paul; Feb 24, 1869 – Jan 8, 1929. (SC)

Anna Ruth, dau of F.B. & C.; 1901 – 1903. (SC)

Caroline Cordell, wife of F.B.; 1865 – 1952. (SC)

Frank Blair, son of E. & C.; 1860 – 1944. (SC)

Evelyn Rowena, dau of I. & Z.; 1922 -1923. (SC)

Hannah (See SELLERS).



CARNES:

Catherine, dau of J.B. & M.A.; d. Jan 22, 1876, age 13y 10m 2d. (NE)  
Martha, wife of J.B.; 1836 - ?1861?. (NE)  
John B.; (no dates); Co C 119<sup>th</sup> IL Inf. (NE)

CHANDLER:

Seth, son of J. & M.; d. Sep 11, 1864; age 22y 9m 2d; Co I 62<sup>nd</sup> IL Inf. (SW)

CLUGSTEN:

John W., son of B. & I.; d. Aug 15, 1852; age 2y 3m 19d. (SW)  
William; d. Nov 11, 1877; age 73y 7m 3d. (NE)  
Sarah; d. Apr 14, 1868; age 62y 11m 15d. (SW)  
David A.; 1861 – 1945. (SE)  
Elizabeth; 1868 – 19--. (SE)  
Hazel Blanche; 1892 – 1894. (SE)  
Carl C.; 1894 – 1914. (SE)

COLLEASURE:

John; d. Dec 25, 1875; in the 76<sup>th</sup> year of his age. (SE)  
Margaret, wife of John; d. Mar 24, 1885; in the 83<sup>rd</sup> year of her age. (SE)  
James S.; d. Feb 25, 1876; age 28y 9m 17d. (SE)

COOPER:

Willie, son of R. & M.; d. Aug 12, 1876; age 8y 11m 8d. (NW)  
Thirreacy J., dau of M. & J.; d. Feb 11, 1856; age 7d. (NW)

CORDELL:

Caroline (See BURNHAM).

COWAN:

William; 1831 – 1913. (NW)  
Rebecca, wife of Wm.; 1837 – 1933. (NW)  
Anna E.; 1875 – 1879. (NW)  
Sarah E.; 1867 – 1879. (NW)

CROSSAN:

Fannie, wife of C.C.; d. Dec 17, 1871; age 30y 4m 13d. (SE)  
May, dau of C.C. & F.; d. Jul 26, 1888; age 21y 20d. (SE)  
Katie, dau of C.C. & Fannie; (no dates). (SW)  
William, son of C.C. & Fannie; (no dates). (SW)  
Samuel, son of C.C. & Fannie; (no dates). (SW)

CURTIS:

Homer; 1873 – 1909. (SW)  
Jesse A.; 1883 – 1942. (SC)  
Jessie F.; 1884 – 1956. (SC)  
Dorothy Louise, dau of J.A. & J.F.; b. & d. Sep 7, 1914. (SC)

DEWITT:

Pearley H., dau of J.M. & J.; d. Dec 8, 1878; age 4y 3m 23d. (SC)  
James M.; (no dates); Sgt Co A 10<sup>th</sup> MO Inf. (SC)

DODDS:

Webster; d. Jun 5, 1881; age 45y 3m 17d; Co G 16<sup>th</sup> IL Inf. (SE)  
Harriet A., dau of S. H.L.; d. Sep 19, 1869; 18y 11m 3d. (SE)  
Olivia, dau of S. & H.L.; d. Sep 4, 1850; age 19y 4m 4d. (SE)  
Elizabeth, dau of S. & H.L.; d. Nov 15, 1849; age 4y 6m 25d. (SE)  
Samuel; d. Aug 8, 1874; age 70y 11m 29d.

DONNALLY:

Reece, son of J.W. & A.; d. Aug 31, 18--; age ---. (NE)

FAWCETT:

Ora, son of C.M. & B.J.; d. Jul 29, 1886; age 5y 3d. (NE)

FISH:

Aleck J.; 1891 – 1967. (SC)

Lora R.; 1879 – 1967. (SC)

FREAM:

Aaron; d. Mar 7, 1868; age 58y 8m 2d. (NW)

John; d. Sep 30, 1857; age 25y 7m 11d. (NW)

Mary, wife of Aaron; d. Jul 20, 1861; age 58y 3m 17d. (NW)

David, son of A. & M.; d. Sep 5, 1864; age 25y 3m 12d; Co I 62<sup>nd</sup> IL Inf. (NW)

Charlotte R., dau of A. & M.; d. Mar 7, 1864; age 20y 2m 22d. (NW)

GAMBLE:

Thomas H.; 1834 – 1910. (SW)

Jane Anna, wife of T.H.; 1839 – 1933. (SW)

GANTZ:

Oscar C.; 1869 – 1937. (SC)

Nellie C.; 1874 – 1958. (SC)

GARRISON:

Ivy, dau of A.B.; d. Jul 27, 1881; age 9m 9d. (NW)

GIFT:

Samuel G., son of -----; d. -----; age ----. (NW)

GRIFFITH:

Clara Z. Legg, wife of I.N.; Mar 17, 1872 – Oct 22, 1901. (SE)

GRIM:

Ross D.; Jun 19, 1891 - d. at age 1y 8m 14d. (NE)

GUNNING:

William; Dec 5, 1821 – Mar 2, 1869. (NE)

Lydia, wife of Wm.; Oct 4, 1821 – Jul 27, 1894. (NE)

Margaret A.; Jun 22, 1848 – Jul 20, 1905. (NE)

James; 1845 – 1927. (NE)

William C.; 1842 – 1921. (NE)

Jane Bell; 1854 – 1920. (NE)

HAMILTON:

James A.; 1922. (SC)

Albert D.; 1889 – 1950. (SE)

Edythe Marie; 1894 – 1933. (SE)

HORSLEY:

Nellie Miner; 1883 – 1961. (SE)

HUNTER:

Jessie Crack, dau of D.F.W. & M.; d. Dec 5, 1866; age 1y 2m. (SC)

JOHNSON:

Mabel, dau of G.H. & E.; Oct 9, 1902 – Oct 3, 1916. (SW)

George H.; Apr 4, 1861 – Apr 26, 1939. (SW)

Elizabeth A.; Apr 3, 1864 – JUN 14, 1931. (SW)

KEVAN:

Elmer A., son of A. & S.L.; d. Aug 5, 1862; age 1y 19d. (NW)

LAMBORN:

Charles M.; Oct 25, 1832 – Mar 9, 1894. (NE)

Emma S., wife of Chas.; Jan 23, 1835 – Feb 9, 1910. (NE)

LAMASTER:

William; Nov 22, 1867 – d. at age 36y 3m 12 d. (NE)

LEGG:

Mary A., beloved dau of D. & A.M. Runkle; d. Mar 25, 1886; age 40y 3m 28d. (NE)

Mary F.; Oct 17, 1880 – Nov 6, 1881. (NE)

Infant son of M.A. & J.M.; d. Sep 28, 1878. (NE)

James M.; (no dates); Corpl, Co I 62<sup>nd</sup> IL Inf. (NE)

Frank; May 24, 1874 – Feb 18, 1912. (NE)

Edwin; 1875 – 1876. (NE)

Addie, dau of J. & L.; 1871 – 1930 (NE)

John F.; 1836 – 1915. (NE)

Letha M.; 1848 – 1924. (NE)

Infant son of Mary A.; 1878. (NE)

Mary Florence; d. Mar 6, 1881; age 7m 17d; dau of Mary A. (NE)

Julia F. dau of T. & M.; Dec 19, 1858; age 22y 11m. (NW)

Thomas L., son of T. & M.; d. Nov 26, 1861; age 8y 8m 12d. (NW)

Clyde J.; 1881 – 1948. (SC)

Jessie G.; 1885 – 1954. (SC)

Charles Wilson; Feb 3, 1908 – Nov 19, 1956; age 48; Tec 5 9817<sup>th</sup> Tech Svc Unit, WWII. (SC)

Charles I.; Aug 24, 1868 – Jan 27, 1900. (SE)

Clara Z. (See GRIFFITH).

Grace (See WORLEY).

Lucretia J. (See MC GAUGHEY).

E. E. (See RUNKLE)

LICKEY:

Leita, dau of Leo & Ruth; Jul 4 – Aug 4, 1916. (SE)

LOWE:

Willa Jean; 1931 – 1972. (SW)

LUCAS:

Nancy; d. Jul 31, 1863; age 74y 2m 6d. (SW)

MARSHALL:

Rev. John; d. Aug 24, 1858; age 44y 7m. (SW)

MC CULLOCH:

Mary J., dau of H. & N.M.; d. Jun 2, 1860; age 1y 4m –d. (SW)

Charles, son of H. & N.M.; d. Sep 10, 1866; age ---. (SW)

Nancy J., dau of H. & N.M.; d. Sep 4, 1866; age 15d. (SW)

Nancy, wife of Hugh; d. Aug 23, 1866; age 36y 3m 26d. (SW)

Hugh; d. Dec 12, 1882; age 54y 6m 2d; Co D IL Inf. (SW)

MC GAUGHEY (MC GAUGHY):

Lucretia J. Legg, wife of J.W.; 1843 – 1908. (NE)

John W.; (no dates). (NE)

A. Leota; 1877 – 1944. (NE)

Betty Lou, dau of J.B. & E.L.; 1939 -1939. (NE)

J. Bernard; 1910 -1959. (NE)

Evelyn L.; 1915 – 1965. (NE)

William P.; 1870 – 1941. (NE)

William; d. Nov 1, 1869; age 16y 11m 5d. (NE)

James W., son of Wm. & Margaret; d. Jun 16, 1857; age 9y 6m 15d. (NW)

Margaret J., dau of W. & M.; d. Aug 20, 1860; age 1y 8m 11d. (NW)

Agness, wife of J.; d. May 29, 1853; age 63y 11m 16d. (NW)

MC GAUGHEY (MC GAUGHY):

Mary L., dau of H.F. & J.; d. Aug 27, 1852; age ---. (NW)  
Jane, wife of Hugh F.; d. Mar 26, 1863; age 42y 4m 27d. (NW)  
-----; d.-----, 1863; age -----. (Large overturned stone). (NW)

MC GRATH:

James; Jul 17, 1813 – Jan 4, 1892. (NE)  
Barbara, wife of James; Jan 11, 1814 – Mar 1, 1885. (NE)  
Thomas J.; (no dates); Sgt Co G IL Inf. (NE)  
Mary A.; Aug 30, 1861 – May 1, 1863. (SW)  
Emily E.; May 5, 1863 – Jul 18, 1864. (SW)  
(Latter 2 were children of J.H. & E.)  
Sarah R., dau of J.H. & Eliza; d. Mar 29, 1881; age 15y 10m ---d. (SW)  
John H.; Jul 21, 1834 – Dec 24, 1904; 2Lt Co G 73<sup>rd</sup> IL Inf. (SW)  
Eliza, wife of J.H.; Jun 8, 1840 – (no date). (SW)

MC LAIN:

Joseph; d. Feb 26, 1893; age 69y 7m 26d; Capt Co I 62<sup>nd</sup> IL Inf. (SC)  
Mary; d. Jul 5, 1894; age 60y 10m 9d. (SC)  
James; d. Jun 7, 1866; age 76y 4m 7d. (SC)  
Ann; d. Mar 25, 1883; age 81y 8m 21d. (SC)

MERIWETHER:

George; 1833 – 1912; Co B 119<sup>th</sup> IL Inf. (SC)  
Mary E., wife of Geo.; 1840 – 1907. (SC)

MESSMORE:

Samuel W.; d. Sep 14, 1886; age 71y 8m 1d. (SC)  
Rebecca, wife of Sam'l; d. Mar 11, 1900; age 76y 6m 10d. (SC)  
Joseph M.; 1851 – 1943. (SC)

MINER:

George W.; d. Jan 20, 1894; age 30y 8m 10d. (SC)  
Noah; Aug 24, 1824 – Sep 30, 1906. (SC)  
Christena, wife of Noah; Sep 29, 1830 – Jan 26, 1915. (SC)  
S.T.; Oct 25, 1858 – Sep 22, 1921. (SC)  
W.J.; d. Jul 11, 1892; age 40y 6m 4d. (SC)  
Leslie R., son of J.A. & N.E.; d. Feb 28, 1895; age 4y 11m 5d. (SC)  
Benj. F.; Sep 18, 1864 – Mar 19, 1899. (SC)  
Infant dau of B.F. & C.A.; d. Aug 16, 1895; age 14d. (SC)  
Infant son of B.F. & C.A.; d. Feb 11, 1897; age 13d. (SC)  
Nellie (See HORSLEY).

MUMA:

Willis, son of David & Mary; d. May 20, 1865; age 9y 7m 13d. (NW)  
George, son of D. & M.; d. Feb 1862. (NW)  
Charlie, son of D. & M.; d. Apr 14, 1867; age 8m 28d. (NW)

NORRIS:

Charles L.; 1877 – 1935. (SW)  
(NOTE: Three other decorated graves nearby - no markers).

O'DELL:

Isaac W., son of J.F. & A.J.; d. Dec 24, 1850; age 6m. (SW)  
John F. and Amanda J. (See SELLERS).

PASCHKE:

William; Jan 22, 1869 – Nov 3, 1944. (SE)

PATTERSON:

James W., son of J.R. & M.; d. Jan 1, 1873; age 2y 10m 6d. (SE)

PERSHING:

Hazel E.; Jun 12, 1892 – Jun 9, 1960. (SW)

Jacob P.; Feb 4, 1858 – Jan 19, 1942. (SW)

Charles T.; 1820 – 1918; Co I 62<sup>nd</sup> IL Inf. (SW)

Mary A.; 1833 – 1912. (SW)

PLANK:

Marion; 1885 – 1963. (SC)

Mary; 1885 – 1938. (SC)

POLLOCK:

Joseph W.; 1862 – 1913. (SC)

Emma B., wife of Joseph; 1862 – 1925. (SC)

Mary Adda, dau of Wm. & S.M.; d. Aug 16, 186-; age 6y 6m 12d. (SW)

Anna M.; Oct 7, 1851 – Oct 5, 1899. (NC)

Florence J.; Jul 8, 1853 – Nov 30, 1874. (NC)

Mary A.; Feb 4, 1855 – Aug 4, 1861. (NC)

Frank L.; Aug 30, 1869 – Apr 22, 1871. (NC)

(Latter 4 were children of Wm. & S.M.)

PRENTISS:

Francina, dau of Dr. M.M. & H.; d. Apr 3, 1861; age 7y 1m 23d. (NW)

Mary Jessie, dau of Dr. M. & H.; d. Mar 29, 1861; age 5y 1m 24d. (NW)

RAPER:

Alice G., wife of A.F.; d. Sep 23, 1873; age 50y 2m 10d. (SC)

REDDING:

Harvey R., son of S.P & A.L.; d. Dec 9, 1873; age ---. (NE)

REED:

Sarah M; Jun 16, 1850 – Apr 13, 1883; age 32y 9m 27d. (NE)

Joseph; Dec 9, 1817 – May 8, 1898. (SW)

Rebecca; Dec 4, 1836 – Jan 17, 1915. (SW)

George B.; 1858 – 1946. (SW)

Selena; 1857 – 1928. (SW)

Infant dau of G.B. & S.E.; d. Jul 31, 1895; age 5d. (SW)

Minnie Maud, dau of Joseph & Rebecca; Jul 3, 1869 – Aug 13, 1886. (NW)

Martha C., dau of J. & R.; Feb 23, 1856 – Aug 9, 1858. (NW)

Sarah G., dau of J. & R.; Dec 2, 1860 – Dec 24, 1861. (NW).

RILEY:

George W.; 1841 – 1910; Co D 119<sup>th</sup> IL Inf. (NE)

Elizabeth A.; 1857 – 1889. (NE)

Stella D.; 1876 – 1893. (NE)

RINGS:

Ray, son of E.S. & M.A.; Jun 24, 1892 – Oct 25, 1893. (NC)

ROYER:

Jerry, Jan 8, 1939 – Jan 10, 1939. (SE)

E. Bernetta; 1920 – 1966. (SE)

RUNKLE:

James I. Oct 6, 1841 – Nov 17, 1928. (NC)  
Caroline M.; Dec 25, 1845 – Feb 24, 1919. (NC)  
Darius; Feb 10, 1813 – Mar 13, 1896. (NC)  
Anna Maria, wife of D.; Nov 1, 1822 – Jan 11, 1889. (NC)  
Clara J., wife of F.C.; Oct 13, 1856 - Jan 11, 1889. (NC)  
Mary, wife of Wm.; d. Mar 28, 1869; age 83y. (NC)  
William; d. Jul 30, 1867; Lt Kiser's Co Ohio Mil., War of 1812. (NC)  
William; Sep 1, 1843 – Feb 11, 1893. (NC)  
Stephen A.; Mar 29, 1852 – Jul 31, 1894. (NE)  
Lizzie, dau of D. & A.M.; d. Jun 21, 1861; age 2y 4m 7d. (SW)  
Laura J., dau of D. & A.M.; d. Oct 1, 1856; age 2y 4m 4d. (SW)  
Roy L.; 1875 – 1941. (SW)  
Viola M.; 1875 – (no date). (SW)  
Eula B.; 1888 – 1932. (SW)  
Charles W.; 1849 – 1922. (SC)  
E.E. Legg, wife of Chas.; 1848 – 1930. (SC)  
George N.; 1864 – 1928. (SC)  
Elizabeth; 1877 – 1915. (SC)  
Hugh Van; In Memory of Hugh Van Runkle; paratrooper, 17<sup>th</sup> Airborne Div.; Jun 26, 1914 – Feb 9, 1945; at rest  
in U.S. Military Cemetery, Henri Chapelle, Belgium. (SC)  
Mary A. (See LEGG).

SAUARD:

George E., son of J.W. & N.C.; d. Sep 3, 1861; age 9m 1d. (NW)

SCOTT:

Mary L.; d. May 19, 1888; age 87y 5m. (NE)

SEITOUS:

Alice M., dau of J. & S.; d. Nov 11, 1876; age 28y 6m 2d. (NE)

SELLERS:

Andrew; d. Aug 16, 1878; age 48y 6m 21d; removed to Macomb. (SW)  
(NOTE: Inscribed on this stone: "In Memory of John F. O'Dell and his wife Amanda J."  
Hannah Burnham, wife of H.D.; 1870 – 1919. (SW)

SHIRK:

John B., son of A. & C.; d. Feb 7, 1869; age 10m 20d. (NE)

SMILEY:

Mary, wife of H.B.; d. Aug 28, 1878; age 56y 7m 21d. (NE)  
H.B.; Mar 1, 1811 – Feb 21, 1897. (NE)

?SNOWDEN?:

Aunt Susie; 1835 – 1932. (SE)

SOWARD:

William; d. Apr 18, 1856; age 56y 2m 19d. (SW)

STAGE:

Lettice, a wife of Luke; d. Dec 9, 1888; age 72y 4m 10d. (NE)

STANLEY:

Lawrence; 1901 – 1902. (SC)  
Howard; 1875 – 1901. (SC)  
Joseph; Apr 7, 1833 – Aug 13, 1902. (SC)

STOTT:

Charles W., son of J. & C.; d. Dec 14, 1878; age 4y 9m 22d. (NW)

SWINHART:

Sarah., wife of A.; d. Jan 12, 1892; age 74y 1m 25d. (NE)

SWITT:

John H.; d. Dec 1, 1877; age 24y 11m 22d. (NE)

THOMAS:

Hannah; d. Jul 16, 1854; age 66y 5m 20d. (SW)

THOMPSON:

Elizabeth; Sep 5, 1845 – Dec 15, 1891. (NE)

WALKER:

Charles W.; d. May 8, 1883; age 70y 14d. (NC)

WHEELER:

John H.; May 29, 1841 – Jun 8, 1914; Co A 78<sup>th</sup> IL Inf. (SC)

Eliza A., wife of John; Jan 27, 1846 – Apr 2, 1905. (SC)

WILLEY:

Bertha M.; 1895 – 1964. (SE)

WORLEY:

Grace Legg, wife of Chas. T.; 1884 – 1912. (SC)

WORMAN:

Moses; d. Sep 4, 1857; age 56y. (SW)

### Genealogical Notes – Doddsville Cemetery

**ARCHER:** Frank (1860-1925), a son of John M. & Mary E. (Parshall) Archer; 4<sup>th</sup> of a family of 6 children; he was a brother to Rachel (Mrs. M.L. Harris); Florence Belle (Mrs. John F. Booth); Mary E. (Mrs. George Smith); John W.; and Elizabeth G. (Mrs. Elmer E. Pollock). John, the father of Frank, was born in Warren Co. OH, a son of John & Rachel (Hillman) Archer, natives of NJ; Mary E., mother of Frank, was born in Wood Co. OH, a daughter of James G. & Margaret (Staley) Parshall, natives of PA.

**BAIR:** George (1816-1890) served as a deacon with the Doddsville Presbyterian Church.

Jeremiah (1845-1867) served from Schuyler Co. during the Civil War; dates of service as a private were 1865-66.

**BARTON:** Richard & Julia were children of Mr. & Mrs. Elijah Barton; Elijah enlisted in the army at Littleton, IL in 1862 and served with Co I 62<sup>nd</sup> IL Inf. He died of disease at Paducah, KY on Jun 1, 1863.

**BLACK:** Henry (1819- 1885) was born in PA; moved to this county in 1840, from PA; he farmed on section 32, Industry Twp.; Mr. Black served as an elder with the Doddsville Pres. Church; he was also President of the Industry Mutual Ins. Co.

Mary (1822-1903), wife of Henry; born in Washington Co. PA; moved to this county with her parents in 1836.

**BRUNTON:** Emaline (1854-1854) was a daughter of J. & Sarah; Sarah was born in OH in 1835; Emaline was a sister to Edward (b. 1853 in IL), Wesley (b. 1857 in MO), and William (b. 1859 in MO). This family lived in Industry Twp.

**BURNHAM:** John (1859-1950), Paul (1869-1907) and Frank B. (1860-1944) were sons of Edgar and Caroline (Armstrong) Burnham; another son (Chas. Edgar) is buried at Vance Cemetery; Edgar & Caroline were the parents of 14 children and had lived in Schuyler Co. IL prior to moving to this county about 1872.

**BURNHAM (Cont'd):**

Paul (1869-1907) (Obit, in part, from The Macomb Daily By-Stander, Mar 13, 1907): "Paul G. Burnham died Tuesday at 6 p.m., at the St. Francis Hospital of septic poisoning. He had been sick for the past two months. He was 38 years, 1 month, and 22 days old..... The remains were taken to his home, one mile west of Doddsville..... Paul Graff Burnham was born in Doddsville Jan 18, 1869. He was a son of Mr. and Mrs. Edgar Burnham. In 1883, he was married to Lizzie Sellers. Three children were born to this union, all of whom survive. They are Walter, Howard, and May. He is survived by his wife, mother, and six brothers: John A., Frank E., Ami, and Fred of Doddsville, Ed of Industry, and Albert of Bethel Twp.; four sisters, Mrs. Lizzie Clugsten of Littleton, Minnie of Honolulu, Hannah Sellers of Littleton, and Katie Meriwether of Blandinsville. He also leaves an aunt, Miss Prescilla Armstrong, also in Honolulu....."

**CARNES:** John B. enlisted in the army at Schuyler Co. IL in 1862; he was disabled and discharged on Jun 25, 1864; according to IL VA records, Mr. Carnes d. Jan 16, 1929.

**CHANDLER:** Seth (1842-1864) died at Doddsville, IL while a member of the 62<sup>nd</sup> IL Inf.

**CLUGSTEN:** Elizabeth was a daughter of Edgar and Caroline (Armstrong) Burnham. She was a resident of Littleton, IL.

**COLLEASURE:** John (1799-1875) moved to this area in 1857, from PA; he later served as an elder of the Doddsville Presbyterian Church; a daughter, Margaret, was born in Westmoreland Co. PA; she md. Benj. D. Gristy and later lived in Schuyler Co. IL>

James (1847-1876) was elected as an elder of Doddsville Pres. Church, however, died prior to ordination.

**COOPER:** Willie (1867-1876) was killed when a log rolled over him. The family lived about a mile west of Doddsville.

**COWAN:** William (1831-1913) was a Doddsville carpenter.

**CROSSAN (CROSSEN):** Oliver C. was a school director at Black School, Distr. #9, Industry Twp.; Mr. Crossen owned an 80A farm in the same section as the Doddsville Cemetery; his home was located just south of the cemetery grounds.

**DODDS:** Samuel (1803-1874) laid out the village of Doddsville in 1836; on the 1840 county tax list, Mr. Dodds is shown as the owner of 400 acres of ground in sections 27, 31, &32 of Industry Twp. His residence, at that time, was in Schuyler Co. Mr. Dodds later moved to Macomb, where he died in 1874.

Webster (1836-1881) lived in Doddsville; he move here from Dayton, OH about 1840; his wife was the former Emily A. Ainsworth, born in Sangamon Co. IL in 1847.

**DONNALLY:** Reece (d. 18--) was a son of Dr. J.W. Donnally who was a Doddsville physician during the 1870's.

**FREAM:** David (1839-1864) died of disease in military service. Pvt. Fream had served 3 years and had reenlisted for 3 additional years; he served from Schuyler Co. IL.

**GUNNING:** William (1821-1896) was born in PA; Lydia, his wife, was born in OH; the following children were born in OH: Margaret Ann (1848), James R. (1845), William C. (1842), Amanda J. (1852). John R. (1857) & Nancy H. (1860) were born in IL.



**HAMILTON:** Albert D. (1889-1950); according to IL VA records, served with the U.S. Navy during WWI.

**LEGG:** Thomas (1805-1871), a native of KY; he moved to Schuyler Co. IL in 1832. His wife, Mary (Greenwood) Legg, was also born in KY. This family lived on section 7, Littleton Twp., Schuyler Co.

James M., a son of Thos. & Mary Legg; enlisted in the army at Littleton, IL and served with the 10<sup>th</sup> MO Inf. And 62<sup>nd</sup> IL Inf.; he md. Mary A. Runkle on Oct 3, 1867, and had 8 children: Chas. I., Lewis L., Clara Y., Nellie C., Anna M., Gracie L., Mary F., and a son that died in infancy.

Addie (1871-1930); according to IL VA records, served as a war nurse during WWI, and died Aug 30, 1930.

**MARSHALL:** John (1814-1858) was serving as minister of the Doddsville Presbyterian Church at the time of his death.

**MC CULLOCH (MC CULLOUGH):** Hugh (1828-1882) enlisted in the army in Schuyler Co. IL and served with Co D 124<sup>th</sup> IL Inf.; he was mustered out on Nov 24, 1865.

**MC GAUGHEY (MC GAUGY):** Hugh (husband of Jane), born in PA. He owned an 160A farm a half mile north of Doddsville.

Jane (1820-1863) was born in PA; md. in PA; the following children were born to Hugh & Jane in PA: Jane (1843); Walker (1845); and Frances (1848). The following children were born in IL: Mary L.; Joseph (1852); and Jane (1856). Living in the McGaughey household in 1860, in addition to the above named persons, were: Ann Walker, age 72, a native of PA; and A.B. Stewart, age 30, also b. in PA.

**MC GRATH:** James (1813-1892), born in PA, was a Doddsville blacksmith; his wife Barbara, was a native of MD; all of their children were born in PA; they included: John H. (1834); Thomas (1837); Lloyd (1840); William (1842); Joseph (1843); Brattan (1846); Ellen (1848); Sarah (1850); and Jane (1853).

**MC LAIN:** James (1790-1866) was born in Dayton, OH and moved to this area in the 1830's.

Mary Ann (1801-1883), wife of James; born in Monmouth Co. NJ; maiden name was Dey.

Joseph (1823-1893), son of James & Ann (Stewart) McLain; born in Montgomery Co. OH; moved to Schuyler Co. IL in 1846, and lived on section 2, Littleton Twp. He had a brother named William Stewart McLain.

Mary (1833-1894), wife of Joseph; maiden name, Dodds; born in Montgomery Co. OH; moved to Schuyler Co. IL in 1843.

**MERIWETHER:** George (1833-1912) was born Sep 1, 1833 in Floyd Co. IN, a son of James P. & Nancy (Ebersole) Meriwether; James was b. in KY; Nancy, in OH; paternal grandparents were John & Emma (Bell) Meriwether, natives of VA & KY, resp.; George was a cooper, by trade, and moved to Schuyler Co. IL in 1856. He md. Nov 26, 1857, to Mary E. Huff, a native of Schuyler Co.; they had the following children: Sarah C. (Mrs. Wm. Craig); Emma B. (Mrs. Joseph Pollock); J.P.; W.J.; Mary Edna (Mrs. Wm. McGaughey); E.L.; and Fannie. Mr. Meriwether served 3 years during the Civil War and was mustered out on Aug 26, 1865; after the war he bought a farm in Industry Twp.

**MESSMORE:** Rebecca (1823-1900) (Death notice, in part, from the Bardolph News, Mar 14, 1900): "Mrs. Rebecca Messmore died at the home of her son, A.A. Messmore, of Macomb.....of Bright's disease, at the age of 77 years.. interment beside her husband who died about 13 years ago."

**MINER:** Noah (1824-1906), born in VA; wife, Christena, born in OH; they had 6 children born in VA; John A. (1850); William J. (1852); Mary Ann (1854); Henry (1856); Sarah E. (1857); and Samuel T. (1858). The family lived in Bethel Twp., this county.

**MUMA:** David, father of Willis, George, and Charlie, served with Co D 124<sup>th</sup> IL Inf. As a private; he enlisted at Colchester, IL on Aug 22, 1862; muster out Aug 15, 1865.

**PATTERSON:** Mr. & Mrs. James R. Patterson lived on their 160A farm two miles north of Doddsville. Mr. Patterson later operated a barber shop and restaurant on Main St. in Industry during the 1870's and 1880's.

**PERSHING:** Charles T. (1829-1918) enlisted in the army at Littleton, IL; he was disabled and discharged as a Sgt on May 21, 1863.

**POLLOCK:** Joseph (1862-1913) was a son of William & Sarah M. (Walker) Pollock; Wm. was a native of IN; Sarah, from PA; Wm. & Sarah had 11 children. (Obit, in part, from The Macomb Daily Journal, Mar 13, 1913): "Joseph Walker Pollock died at his home near Doddsville March 13, 1913. Mr. Pollock was 50 years and 3 months old at the time of his death..... He was born Nov 25<sup>th</sup>, 1862, near Doddsville. He lived at his place all his life. He was married Feb 14, 1883, to Miss Emma Belle Meriweather, who is living at the present time. To this union were born Roland of Doddsville; Mrs. Mildred Sellers of Littleton; and Wm. Frederick of Littleton. Mr. Pollock also has two brothers, Robert of Scotland Township, and Dr. A.D. Pollock of Good Hope. He has two sisters, Mrs. Cynthia Messmore of Macomb, and Mrs. Clara Buck of Mt. Pleasant, IA. Mr. Pollock had been sick for the last two years with tuberculosis....."

William, father of Joseph, was born in Dearborn Co. IN and moved to this area in 1849. Sarah, wife of Wm., was born in Adams Co. PA and moved to Schuyler Co. IL in 1840. The family lived on section 5, Littleton, Twp.

**PRENTISS:** M.M. was a physician in Rushville, IL in the 1870's and 1880's.

**RAPER:** Allice (1823-1873), wife of Augustus F. Mr. Raper was a grandson of Wm. Manlove of Schuyler Co. and was named in Mr. Manlove's will, dated Aug 16, 1833.

**RILEY:** George W. (1841-1910). IL VA records indicate his date of death as Oct 6, 1910.

**RUNKLE:** Darius (1813-1896), son of William & Mary (Ponce) Runkle; born in Champaign Co. OH; md. Anna M. Walker, a daughter of Andrew Walker; moved to this area in the 1830's. Darius appears on the 1840 county tax list as the owner of 80 acres in the NW¼ of section 27, Industry Twp.; his residence, at that time, was a short ways south of here in section 4, Littleton Twp. Schuyler Co. Darius and his wife's children were all born in IL. They included: James (1841), William (1843), Mary (1846), Joseph (1848), Charles (1849), Stephen (1852), Laura J. (1854), Clara (1856), and Lizzie (1859).

Anna Maria (1822-1928), wife of Darius; a daughter of Andrew Walker; she was born in PA.

Stephen A. (1852-1894), son of Darius & Anna (Walker) Runkle; b. at Doddsville, IL; attended local schools & Gem City Business College at Quincy, IL; md. Feb 7, 1883, to Emma D. McLain; had 2 children: Lulu B. (1885) and Rex (1887). Mrs. Runkle was a daughter of William s. & Mary J. (Sellers) McLain; after the death of Stephen in 1894, Mrs. Runkle moved to Macomb.

James I. (1841-1928), son of Darius; md. Caroline M. Legg; lived in section 4, Littleton Twp., Schuyler Co. IL. VA records indicate that James served as a 1<sup>st</sup> Sgt with Co A 10<sup>th</sup> MO Inf. during the Civil War.

**RUNKLE (Cont'd):** Charles W. (1849-1922), son of Darius; md. Emma E. Legg; lived on section 4, Littleton Twp. Schuyler Co.

**SELLERS:** Hannah (1870-1919), wife of H.D.; a daughter of Edgar & Caroline (Armstrong) Burnham.

**SMILEY:** H.B. (1811-1897) lived on his 160 acre farm a mile north of Doddsville. He served as a school director for the Runkle School, Distr. #3, located in section 28, Industry Twp.

**STOTT:** The James Stott family lived on their 80 acre farm 2 miles west of Doddsville.

**THOMPSON:** Elizabeth (1845-1891), wife of R.B. (Obit, in part, from The Macomb Daily Journal, Dec 31, 1891). "Mrs. R.B. Thompson died at the residence of her brother-in-law, J.W. McGaughey, Scotland Twp., Dec 17, 1891....born in Industry Twp., Sep 5, 1845....maiden name was Smiley. In Dec 1872, married R.B. Thompson, who with 2 sons, ages 14 and 16 survive. Mrs. Thompson became ill over a year ago with a disease known as Myelitis, something of the character of paralysis...."

**WALKER:** Charles (1813-1883) was born in Adams Co. PA and moved to Schuyler Co. IL in 1840 with his parents; son of Andrew & Ann (Wilson) Walker, both natives of Adams Co. PA. Andrew died in 1843; Ann in 1870; both were buried at Camp Creek Cemetery. Charles Walker was among the original 17 members of the Doddsville Presbyterian Church, established in 1843.

**WHEELER:** John H. (1841-1914) enlisted in the army in Schuyler Co. IL; mustered out on Jun 7, 1865; after the war, Mr. Wheeler was a wagon maker in Doddsville.

#### Notes, Corrections, Additions, and Changes

**ADD: WORLEY:** Grace (1884-1912) (Obit, in part, from The Macomb Daily Journal, Apr 15, 1912): "Grace Legg Worley, youngest child of James M. and Mary (Runkle) Legg, was born May 19, 1884, and died at the Macomb Lying-in hospital Saturday morning, April 13. Her age was 27 years 10 months, and 24 days. When less than two years old her mother died, and she was taken into the home of Mr. and Mrs. Charles Runkle, where she was reared as a child of their own. She resided in Doddsville until she removed with the family to Macomb, and resided on S. Randolph street. She attended the seminary in Jacksonville, IL in the year 1891. In 1902, she enrolled in Knox College, Galesburg, from which college she graduated in June, 1907....Deceased was united in marriage Nov 29, 1907, to Charles T. Worley of Macomb, since which time they have resided at 725 S. Lafayette street. Besides her husband she is survived by Mr. and Mrs. C. W. Runkle, who will cherish her memory as an own daughter; her father, James Legg; her brothers and sisters, L.L. Legg of Salt Lake City, UT; Nellie C. Gantz, Doddsville; Anna M. Bond, Buffalo, KA; and her cousin, Miss Lora Runkle, the only daughter of Mr. and Mrs. C.W. Runkle....".

**ADD: GANTZ:** Nellie C. (1874-1958); wife of Oscar; daughter of James M. and Mary (Runkle) Legg.

## PIONEER CEMETERY

Location: Bethel Township, NW¼, section 22; nine miles south and three miles west of Macomb.  
40° 19' 8.9" N: 90° 43' 58"W

Remarks: This old cemetery was established in the 1830's and is currently located on privately owned property and is about one-fourth mile from any public road. It has also been known as Montee Cemetery or Brundage Cemetery. The area is completely fenced and contains about an acre of ground. Present condition is poor due to a heavy growth of weeds and brush. Some family plots indicate recent care. A number of stones were located under several inches of leaves and sod.

The entrance way on the east side is separated by two concrete posts. The north post contains a small bronze plaque that reads as follows: "Erected in honor of the pioneers who cleared away the forests and destroyed the abiding places of the wild beasts so that civilization might occupy the land."

### BRUNDAGE:

Lucy Ann, wife of J.; d. Nov 20, 1861; age 42y 1m 6d.  
S.E. (No headstone located; initials "SEB" located on a footstone).  
Mary, wife of Solomon; d. Nov 13, 1839; age 39y 7d.  
George, son of S. & M.; d. Oct 21, 1838; age 1y 11d.  
George R., son of S. & G.; d. Oct 9, 1851; age 1m 17d.  
Nancy, dau of J. & L.; d. Jan 23, 1857; age 1m 7d.

### BUZZARD:

Sarah A.; 1829 – 18--.

### CALVIN:

Samuel; Feb 13, 1800 – Apr 23, 1866.

### DOWNEY:

Sarah A., wife of John and dau of G.F. & S.A. Raymond; d. Sep 17, 1883; age 29y 5m 4d.

### FRISBIE:

James E., son of W. & M.; d. Jan 2, 1873; age 5m 5d.

### FUGATE:

I.Q.; Apr 4, 1820 – Sep 20, 1895.  
Elizabeth, wife of I.; Dec 21, 1825 – Mar 29, 1906.  
Ella S., dau of I.Q. & E.E.; Oct 2, 1863 – Aug 26, 1885.

### GIBSON:

Mary A., wife of J.W.; d. Jul 29, 1866; age 37y 6m 20d.

### HITE:

Jesse F., son of J.S. & R.; d. Jul 20, 1870; age 1y 8m 10d.

### HUSTED:

Talmon; (no dates); Co A 78<sup>th</sup> IL Inf.  
Amos; d. Mar 14, 1866; age 34y 4m 19d.

MC CLURE:

Greenup; d. Feb 19, 1856; age 65y 9m.

MC COMSEY:

Robert F.; d. Jul --, ----; age 66y 25d.

MONTEE:

Rosetta, dau of T. C. & N.; d. Sep 12, 1851; age 21 d.

Joseph M., son of T.C. & Nancy; d. Sep 26, 1861; age 2y 9m 20d.

NORRIS:

Sarah; (no dates)

OSBORN:

Francis, son of E. & L.; d. Aug 15, 1872; age ----.

RAYMOND:

G.F.; (no dates); age 72y 1m 27d.

Sarah Ann, wife of G.F.; (no dates); age 71y 8m 25d.

G. James; 1860 – 1914.

Infant son of G.J. & wife; (no dates nor age).

Sarah A. (See DOWNEY).

RIGG:

Sarah Jane, wife of Russell; d. Jun 24, 1870; age 50y 5m 22d.

THOMPSON:

William; d. Jan 27, 1873; age 50y.

Lorren, wife of Wm.; d. Mar 16, 1893; age 69y.

Joann, dau of Wm. & L.; d. Jul 17, 1869; age 16y 4m 5d.

Charles, son of Wm. & L.; d. Feb 6, 1859; age 21d.

Thomas; d. Mar 14, 1871; age 20y.

Sarah; d. Nov 12, 1878; age 17y.

(Thos. & Sarah were children of Wm. & L.)

VENARD:

Sarah Jane, wife of Wm.; d. May 18, 1883; age 68y 3m 8d.

William; d. Jun 5, 1881; age 65y 4m 8d.

Sarah J., dau of Wm. & S.F.; d. Jul 7, 1857; age 11y 5m 3d.

WHITSON:

Hannah, wife of B.F.; d. Mar 11, 1851; age 28y.

Infant of B.F. & D.; d. -----; age 5m 14d.

WILSON:

Eli; 1824 -1867.

Edward B.; 1852 – 1854.

Elizabeth J.; 1853 – 1865.

John, Sr.; d. Jun 14, 1843; age 61y 10m.

## Genealogical Notes – Pioneer Cemetery

**BRUNDAGE:** Solomon appears on the 1840 county tax list as #600; he owned \$295 worth of horses, \$50 cattle, \$40 wagons, had \$50 cash loaned out, and owned \$208 worth of other property; no real estate; taxes were \$3.22.

**CALVIN:** Samuel (1800-1866) appears on the 1840 county tax list as #594; he owned \$120 worth of horses, \$42 cattle, and \$129 in other property; no real estate; taxes were \$1.46. Mr. Calvin served from this county during the 1840's "Mormon War." He was a county commissioner during the 1840's.

**DOWNEY:** Sarah A. (1854-1883), wife of John; daughter of G.F. & Sarah (McMurtry) Raymond; she was the eldest of 5 children; born in the State of NY in 1854; moved with parents to IL in 1858 and to this county in 1869.

**FUGATE:** Isaac Q. (1820-1895), born in VA; a son of Martin & Nancy Fugate, natives of VA; moved to this county prior to 1840; served during the "Mormon War"; md. in this county; his wife, Elizabeth, born in 1826 in IL; they had the following children, all born in IL; George (1851); Nancy C. (1852); Mary (1853); Martha (1856); Ella (1863).

**GIBSON:** Mary A. (1829-1866), wife of John W.; she was born in OH; no children were listed on the 1860 federal census report; however, living in that Gibson household were Jane Wilson, age 74, born in KY and Malissa Cheney, age 48, born in OH.

**HUSTED:** Talmon (appears on the 1860 federal census for Bethel Twp.); he was born in Ohio about 1825; his wife was Martha, born in TN about 1835. He enlisted in the army in Bethel Twp. on Aug 11, 1862; served as a private with Co A 78<sup>th</sup> IL Inf.; later was with the Veteran's Reserve Corps.

**MC CLURE:** Greenup (1790-1856) moved to this county from KY; he was md. to Mary Mc Comsey; they had a daughter, Lorren, who md. Wm. Thompson; another daughter, Sarah, md. Wm. Venard. Mr. McClure appears as #598 on the 1840 county tax list: he owned \$70 worth of horses, \$18 cattle, \$10 clocks & watches, \$92 in other property; no real estate; taxes were \$.95.

**MC COMSEY:** Robert F. was born in KY about 1796; died about 1862; wife was Elizabeth, b. in 1800 in KY; they lived in Bethel Twp. Mr. McComsey served from this county during the "Mormon War." He appears as #704 on the 1840 county tax list; he owned \$40 worth of personal property; no livestock; no real estate; taxes were \$.20.

**RAYMOND:** G.F. was born in Orange Co. NY Aug 11, 1834; a son of Uriah & Margaret (Decker) Raymond; he md. Sarah A. McMurtry, Feb 19, 1853; she was a native of NY; they had 5 children: Sarah A., Margaret A., John U., Gabriel J., and Mary C. The Raymond family moved to IL in 1858 and lived several years in Schuyler Co., moving to this county about 1869; they lived on section 21, Bethel Twp. Daughter, Sarah, md. John Downey; she died at age 29 years in 1883.

**RIGG:** Sarah Jane, wife of Russell; maiden name was Venard; md. in this county in 1845, to Russell Rigg; Mr. Rigg was a native of Greenup Co. KY. They had 9 children: Mary E., James L., John T., Sam'l B., William D., Andrew N., Anna, and two that died at early ages. After, Sarah's death in 1870, Russell md. Eliza Jane Lucas on Feb 2, 1871; they had a son, George M.

**THOMPSON:** William (1823-1873) was b. in KY; moved to this county prior to 1840; he served during the "Mormon War" in the 1840's. He md. Lorren McClure in this county.

Lorren (1824-1893), wife of Wm.; daughter of Greenup & Mary (McComsey) McClure; b. at Shelbyville, KY; moved to this county with parents in 1830's; md. Wm. Thompson and lived on section 10, Bethel Twp.; had 10 children: Mary E., John T., Charles, George, Sam'l G., Rozella, Sarah J., Franklin L., Alice, and William.

**VENARD:** William (1816-1881), born in KY; moved to Morgan Co. IL in 1830; to this county in 1831-32; md. Sarah Jane McClure on Mar 29, 1836, that being the first wedding in Bethel Twp.; they lived on section 14, Bethel Twp.; Mr. Venard appears on the 1840 county tax list as # 593: owned \$70 worth of horses, \$130 cattle, \$10 clocks & watches, \$50 wagons, and \$82 in other property; no real estate; taxes were \$1.71. William & Sarah Venard had the following children, all born in IL: John F. (1840); George G. (1841); Sarah J. (1846); James W. (1848); ?W.? (1851); Robert (1854); Webster (1856); and Josephine (1858). Mr. Venard served from this county during the "Mormon War".

Sarah Jane (1815-1883), wife of William; she was a daughter of Greenup & Mary (MComsey) McClure and was born in KY.

**WILSON:** John (1781-1843), born Aug12, 1781, in Greenbrier Co. VA; he moved to OH in 1804, and was md. at Madison Co. OH on Dec 20, 1809, to Jane McComsey, a native of Harrodsburg, Mercer Co. KY; she was born there on Oct 7, 1787. John & Jane had 7 children: Melissa, Margaret, Sam'l, John, Eli, Jane, & Mary Ann. The family moved to Champaign Co. OH in 1816; and to this county in 1835; they lived in Bethel Twp; Jane died on Feb 11, 1861. John appears on the 1840 county tax list as # 597; he owned \$155 worth of horses, \$56 cattle, \$10 worth of clocks & watches, \$50 wagons, and \$175 in other property; no real estate; taxes were \$2.23. There were 2 John Wilsons in this county in 1840, both living in the south half of the county; this Mr. Wilson was identified on the 1840 tax list as living on Grindstone Creek.

Eli (1824-1867), born in OH; son of John & Jane (McComsey) Wilson; wife, Sophia, was born in 1830, in IN; their children included: Edward B., Elizabeth Jane, Browning, Mary, Ann, and Melissa. All the children were born in IL.

#### Notes, Corrections, Additions, and Changes

## PENNINGTON CEMETERY

Location: Industry Township, NE¼, section 17; about one and a half miles west of Industry.  
40° 17' 48" N: 90° 43' 47" W

Remarks: This cemetery is located on privately owned property and is situated about one fourth mile from any public road. The grounds are loosely fenced and livestock have caused considerable damage to stones. The area is covered with weeds and brush; most stones are broken and/or overturned. The name of this cemetery is not be confused with the Pennington Point Cemetery, located in New Salem township.

### AVERY:

Mahala Tuggle, wife of Edgar; Nov 6, 1851 – May 20, 1880.

### BAYMILLER:

John; d. Jan 18, 1876; age 83y 4m 18d.

Mary, wife of John; d. Jun 12, 1874; age 73y 6m 12d.

Infant son of J.S. & K.; (no dates); age 7d.

Mary J.; d. Jan 1, 1887; age 11y 7m.

Vanderbilt, son of J.S. & K.; d. Sep 10, 1873; age 6m 4d.

### CORD:

Harry, son of H. & N.J.; d. Aug 1, 1887; age 1y 7m 20d.

### KEE:

Martha J. (See TUGGLE).

### MC KINNEY:

John; Dec 8, 1820 – Sep 28, 1889; age 68y 9m 20d.

Jane; Nov 15, 1822 – Sep 5, 1892; age 69y 9m 20d.

### PENNINGTON:

Lemmie, son of J.W. & M.C.; d. Feb 22, 1872; age 1y 1m 28d.

James W.; d. Mar 22, 1874; age 38y 26d.

Thomas J.; b. Monroe Co. KY, Mar 15, 1810; d. Sep 27, 1875; age 65y 6m 12d. "Emigrated to this county in 1829"

Mary J., wife of T.J.; d. Oct 1, 1901; age 83y 3m 3d.

Alonzo; 1857 – 1937.

Morris, son of T.J. & M.J.; d. Sep 12, 1869; age 9y 5m 1d.

### RYAN:

M.E.; d. ----- (Small, hand-engraved field stone).

### SMITH:

Peter F.; d. May 28, 1897; age 56y 4m. Co F 119<sup>th</sup> IL Inf.

Anna, wife of P.F.; b. May 22 1850; d. Mar 1, 1919.

### TUGGLE:

Nancy J., wife of A.; d. Jul 21, 1871; age 20y 6m 29d.

Lovina J., dau of A. & N.J.; d. Jul 29, 1871; age 2m 15d.

Martha J. Kee, wife of John; Jul 8, 1821 – Dec 28, 1877.

John; Mar 16, 1816 – Jan 22, 1899.

Mahala (See AVERY).



## Genealogical Notes – Pennington Cemetery

**AVERY:** Mahala (1851-1880), wife of Edgar; daughter of John & Martha (Kee) Tuggle.

**BAYMILLER:** John (1792-1876), born in PA; lived in York Co. PA. Wife, Mary (1801-1874), also native of PA; her maiden name was Smith. John & Mary's children included: Jacob S., Elizabeth (b. in OH in 1842); and another daughter who md. Thos. Maxwell in OH and later lived in Industry Twp. this county.

Jacob S., father of the infant son, Mary J., and Vanderbilt, was a son of John & Mary (Smith) Baymiller; Jacob was b. in York Co. PA and md. there to Ann Tuttle, a native of OH; they had 1 daughter, Arabell; Ann (Tuttle) Baymiller died 2 years after marriage; Jacob then md. Kate Rogers, a native of IL; they had 7 children: Mary J., Edgar L., Harry S., Alonzo J., Nellie, Vanderbilt, and a son that died in infancy. Jacob was a carpenter in Industry.

**MC INTIRE:** Daniel owned a 160 acre farm, the NE¼ of section 19, Industry Twp.

**MC KINNEY:** John (1820-1889) was born in PA and moved to this county from York Co PA in 1854; he operated a boot and shoe business in Industry; Mr. McKinney served as a village trustee in Industry for several years.

**PENNINGTON:** Thomas J., a native of KY, moved to this county in 1829; he lived for a time in Schuyler Co. IL and near Pennington Point in New Salem Twp., this county. He was first md. to Polly H. Vanters, a native of KY; they had several children including James W. (b. 1836). Polly died in 1840; she and several of her children are buried in the Standard Cemetery in Industry Twp. Thomas and Mrs. Mary J. (Smithers) Rogers were md. in April 1841; 2 of their children (Ulissus and an infant) are buried at Standard Cemetery. The 1830 federal census indicates that Thos. J. and family were living in Schuyler Co. IL and that he and his wife had 2 daughters under age 5. In 1840, Mr. Pennington was residing in this county; he appears on the 1840 county tax list as # 453; he owned \$230 worth of horses, \$100 cattle, \$20 clocks & watches, \$40 wagons, \$337 in other property; no real estate; his total taxes were \$3.64. Other children of Thomas J. and his second wife, Mary, included: Thos. (1842); S.M.C. (1844); Nancy (1847); Jemima (1849); Stephen (1852); Elvira (1858); and Morris Isaac (1860).

**SMITH:** Peter F. (1841-1897), son of John & Elizabeth (Lenton) Smith; Peter was born in KY; moved with parents to this county in 1850; enlisted in Co F 119<sup>th</sup> IL Inf. in 1862; mustered out on Aug 26, 1865; md. Aug 1, 1868 to Dica A. Osborn.

A son of Peter & Dica Smith, Alonzo, died in 1918, and was buried in this cemetery; however, no stone for this individual was located. Alonzo's obit, in part, is from The Macomb Daily Journal, Jul 27, 1918): "Alonzo Curtis Smith died this morning..... at the home of his mother in Industry Township. Although he had been ill with tuberculosis for five or six years, his death was rather sudden and unexpected as he fell dead in the yard. His age was 40 years, 7 months, and 10 days .... Interment in the Pennington Cemetery near Industry ..... son of Peter F. and Dicia (Osborn) Smith, born in Industry December 17, 1878, and was never married. Besides his aged mother, he is survived by three brothers, Charles M. and Henry, at home; Arthur of Vermont; and one sister, Mrs. Myrtle Dunivent of Industry. Two sisters are deceased.....".

**TUGGLE:** John (1816-1899), born in VA; son of John & Elizabeth (Genny) Tuggle; moved to Morgan Co. IL in 1836, and to this county about 1858; md. in 1838, to Martha Jane Kee; had 13 children: Crawford; Maria Elizabeth (Mrs. C.M. Snow); Julia Ann (Mrs. G. W. Patterson); Thomas J.; Andrew; Ellen (Mrs. Paris Wheeler); Sarah J. (Mrs. Sam'l Allison); Fannie (Mrs. John Gibson); Charles B.; James C.; John M.; and Mahala (Mrs. E. Avery).

**TUGGLE (Cont'd):**

Martha J. (1822-1877), wife of John; daughter of Peter Kee, a native of SC. Martha was born in TN. She & John Tuggle were md. in 1836; lived in Morgan Co. IL; all their 13 children were born in this state.

Nancy J. (1851-1871), wife of Andrew. Mr. Tuggle was born in IL in 1848, and was a son of John & Martha (Kee) Tuggle. Andrew moved to the State of Kansas after the death of his wife.

## PRUITT CEMETERY

Location: Bethel Township, SW¼, section 27; one-half mile east of Stoneking Cemetery.  
40° 19' 48" N: 90° 38' 33" W

Remarks: Other than its general location and it's locally known name, no information can be presented at this time on this family cemetery. The site of this graveyard is on privately owned property and the present land owners have continued to refuse access to the grounds. A number of Pruitt's lived in this vicinity and in neighboring Schuyler County during the early pioneer days of this area.

### Notes, Corrections, Additions, and Changes

## STONEKING CEMETERY

Location: Bethel Township, near the center of the S½ of section 28; five miles south of Fandon.  
40° 17' 56" N: 90° 44' 41" W

Remarks: The grounds are completely fenced and are in excellent condition. Most of the stones are standing upright and the overall area displays dedicated and regular care. [There is a gate in the middle of Section E.](#)

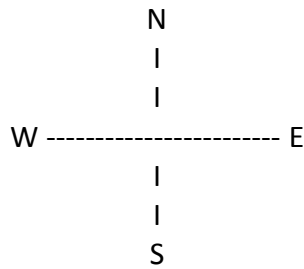
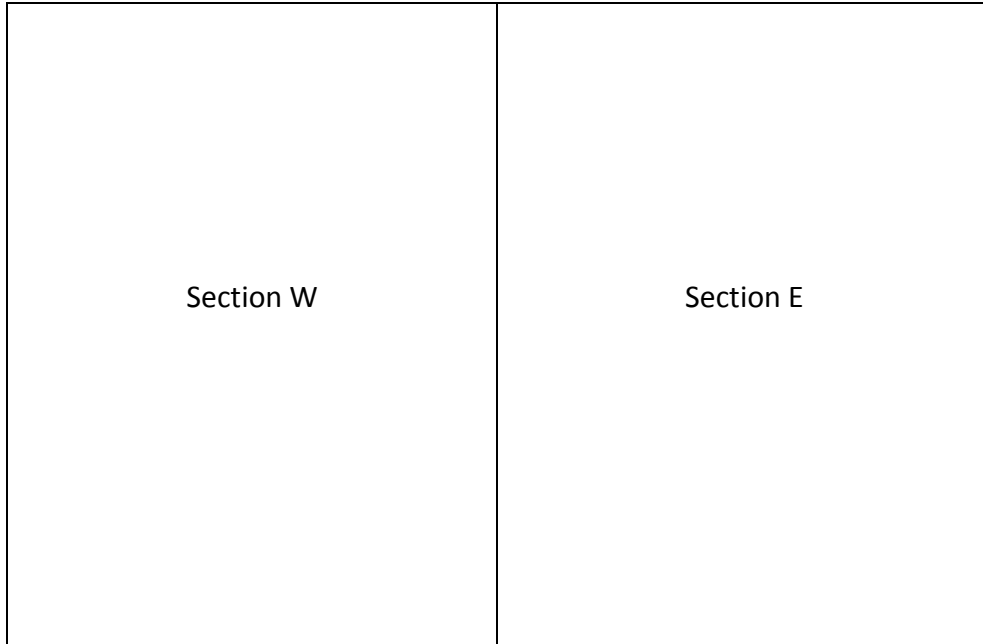

BABB:

Samuel; (no dates); Pvt., Co C 7<sup>th</sup> Regt MO Cav. (E)  
Margaret; 1860 – 1916. (E)  
-----; d. -----; age 77y 2m. (E)

CAREY:

George, Jr.; Jun 23, 1920 – Mar 21, 1943; IL Pvt WWII. (E)  
George W.; Oct 15, 1890 – Mar 21, 1941. (E)  
Herbert; 1897 – 1915. (W)  
Johnnie; 1890 – 1890. (W)

CARPENTER:

Eva; Aug 27, 1905 – May 15, 1909. (E)  
Geneva M.; Jul 19, 1916 – Oct 15, 1916. (E)

CARY:

John J.; d. ----; age ----. (W)  
Lilley M.; d. Jan 12, 1881; age 5m 3d. (W)  
Mary L.; d. ----, 1879; age ----. (W)  
(Above 3 were children of G.W. & E.J.)  
George W.; d. Dec 31, 1882; age 23y 10m –d. (W)  
Nelson; 1855 – 1900. (W)  
Francis; 1862 – 1930. (W)  
Glen Richard, son of L. & R.; Jul 26 – Sep 30, 1929. (W)  
Fred A.; 1883 – 1931. (E)  
Paul Roger; 1936 – 1936. (E)  
Clara M. (See Stoneking)

FRAKES:

Wesley Lee; d. Aug 6, 1974; age 70y 6m 11d. (W)  
Phebe B.; 1873 – 1960. (W)  
Hosea; 1877 – 1905. (E)  
Warnie; 1900 – 1962. (E)  
Adabell; 1927 – 1928. (E)

GINSBERG:

Barbara A. "Ginsy"; May 9, 1925 – Jul 9, 1961. Photo attached to upper part of stone; inscribed: "Irish Eyes  
Are Smiling." (E)

HARRY:

Riley; Dec 12, 1859 – Jul 30, 1917. (E)  
Isabelle; Mar 4, 1864 – Jun 6, 1940. (E)  
Reva Belle; 1926 – 1928. (E)  
Riley Keith; 1912 – 1935. (E)  
Brice; 1882 – 1935. (E)

KELLY:

Edward Oscar; Jul 20, 1874 – Nov 2, 1907. (W)

KING:

Dorothy M.; 1915 – 1974. (W)  
Ellis M.; 1910 – 1974 | (W)

LITTLE:

Son of E. & M.; (no dates). (W)

MC CULLUM:

J.E. "Whitey"; 1903 – 1971. (E)

MILLER:

Isaac; d. Jul 30, 1872; age 53y 11m 27d. (W)

PESTEL:

Joseph; (no dates); Co F 47<sup>th</sup> IL Inf. (E)

PETHTEL:

Joseph L., son of S. & S.; d. Apr 12, 1868; age 1y 7m 28d. (E)

Infant dau of S. & S.; (no dates). (E)

Solomon; d. Nov 18, 1872; age 42y 7m 7d. (E)

PORTER:

Melvin R.; 1938 – 1938. (W)

Gladys I.; 1902 – 1971. (W)

Jesse M.; 1898 – 1975. (W)

Jesse, Jr.; 1928 – 1928. (W)

Merle Dee; 1931 – 1931. (W)

Martha Jane; 1936 – 1936. (W)

Robert E.; 1929 – 1939. (W)

REED:

George W.; 1877 – 1925. (W)

Vern W.; 1905 – 1921. (W)

SCUDDER:

Florence L.; 1899 – 1966. (E)

Glen Burdett; 1922 – 1925. (E)

Geraldine June; 1926 – 1927. (E)

STEELE:

Johnie; (no dates); age 12y. (E)

Lewis; Sep 26 – Nov 22 (no year). (E)

STEVENS:

Phillip Dudley; 1941 – 1941. (W)

STONEKING:

Jesse; 1880 – 1961. (W)

Kenneth; 1922 – 1923. (W)

Dean E.; 1913. (W)

Carl A.; 1911. (W)

Douglas; 1906. (W)

Doris D.; 1925 – 1926. (W)

Jessie M.; 1904 – 1905. (W)

Eddie; 1874 – 1875. (W)

Evey; 1874 – 1875. (W)

Alice; 1879 – 1881. (W)

Rachel E.; 1861 -1935. (W)

Andrew; 1854 – 1937. (W)

James; 1844 – 1908. (W)

Mariara Davis; 1851 – 1891. (W)

Marion S.; d. Dec 20, 1899; age 27y 8m 14d. (W)

Glen; 1919 – 1919. (W)

Otto; 1897 – 1905. (W)

Norman; 1869 – 1932. (W)

Jane; 1876 – 1940. (W)

Maxine; 1914. (W)

Charles A.; 1875 – 1920. (W)

Rhoda B., wife of Charles; 1880 – 1960. (W)

Mildred; 1918 – 1926. (W)

STONEKING (Cont'd):

Dau of Owen & Inez; (no dates). (W)  
Dollie; 1889 – 1907. (W)  
Jackie; 1888 – 1908. (W)  
Fred A.; 1885 – 1914. (W)  
Mattie I.; 1871 – 1942. (W)  
Thomas S.; 1865 – 1934. (W)  
Leola; 1903. (W)  
Ellen; 1860 – 1929. (W)  
Leroy C. "Bud"; Sep 4, 1914 – Oct 12, 1963. (W)  
Norma Jean; Aug 21, 1937 – Apr 17, 1939. (W)  
Earnest C.; Mar 27, 1884 – Mar 29, 1945. (W)  
Etta F.; Dec 25, 1888 – Oct 25, 1959. (W)  
Darlene P.; Dec 12, 1913 – Jan 23, 1932. (W)  
Wayne G.; May 13, 1911 – Jan 18, 1912. (W)  
Sidney M., son of J.C. & Clara; 1915. (W)  
Clara M. Cary; 1888 – 1925. (W)  
Wilmer E., son of S.T. & E.; 1921 – 1923. (W)  
Girtrude Zimkoske; 1884 – 1910. (W)  
Mahala, wife of Isaac; Mar 12, 1856 – Feb 21, 1912. (E)  
Hugh; 1853 – 1928. (E)  
Amanda; 1870 – 1901. (E)  
George; Dec 29, 1831 – Jul 19, 1888. (E)  
Levina, wife of Geo.; Jun 15, 1831 – Apr 28, 1902. (E)  
Mary B.; Mar 14, 1864 – Dec 20, 1880. (E)  
Infant son of G. & L.; d. Oct 16, 1872. (E)  
Hiram; Oct 16, 1874 – Mar 16, 1921. (E)  
Edseld; 1923 – 1924. (E)  
Addie; 1871 – 1919. (E)

SWAYZE:

E. H.; (no dates); Co H 33<sup>rd</sup> IL Inf. (W)

VAN WINKLE:

Winnie M.; Mar 8, 1882 – Jul 10, 1907. (W)  
Dewey M.; Dec 8, 1898 – Apr 3, 1919. (W)  
Gladys M.; Jun 3, 1907 – Dec 27, 1931. (E)  
Jesse M.; Apr 2, 1903 – Jul 6, 1938. (E)

VOGLER:

Frank; 1874 – 1918. (W)

WEAVER:

Mary C.; Feb 16, 1851 – Dec 30, 1936. (W)

WILLEY:

Morris; 1859 – 1928. (W)  
Lucy S.; 1861 – 1896. (W)  
Kitty; 1894 – 1909. (W)  
Two infants; (no dates). (W)

WINGO:

Hazel Ara; 1921 – 1970. (E)

ZIMKOSKE:

Girtrude (See Stoneking).

## Genealogical Notes – Stoneking Cemetery

**CARY:** Francis Priscilla (1862-1930), wife of Nelson; daughter of George & Levina (Pyles) Stoneking; Francis was b. Sep 4, 1862, in Bethel Twp.; d. Nov 16, 1930.

Fred A. (1883-1931), born in this county; a son of Nelson & Francis (Stoneking) Cary; md. to Eva Davis; d. in this county on Nov 9, 1931 at age 49y 5m 19d. Mr. Cary was a farmer in Industry Twp.

**FRAKES:** Hosea (1877-1905); b. in IL; d. at St. Francis Hospital in Macomb on Mar 16, 1905, at age 27y 6m.

**HARRY:** William Riley (1859-1917), b. in Bethel Twp. on Dec 12, 1859; son of Jesse & Elizabeth (Morgan) Harry; Elizabeth was a native of PA; Riley d. in this county.

Riley Keith (1912-1935), b. at Bardolph, IL, May 27, 1912; a son of Brice & Gertrude (Coakley) Harry; d. in this county on Jun 8, 1935.

Brice (1882-1935), b. in Bethel Twp.; md. to Gertrude Coaley, a native of Table Grove, IL.

**PESTEL:** Joseph enlisted in Schuyler Co. IL in Aug 1861; served till Jan 1866.

**PETHTEL:** Solomon (1830-1872), b. in VA; wife, Sarah, b. in VA about 1835; 2 children b. in VA in the 1850's: Newton J. (1855) and George M. (1856). Mr. Pethtel owned an 80 acre farm in the SW¼ of section 27, Bethel Twp. in 1871.

**STONEKING:** Rachel Evaline (1861-1935), wife of Andrew; daughter of Nicholas & Clorenda (Shaw) Cumberledge; b. in IL on Mar 9, 1861; d. in this county, May 15, 1935.

Andrew (1854-1937); b. in Bethel Twp.; son of George & Lavina (Pyle) Stoneking; date of birth was Nov 11, 1854; d. in this county, Jan 28, 1937.

Charles Anderson (1875-1920), b. in this county on Nov 13, 1875; a son of James & Maria (David) Stoneking; d. of tuberculosis in this county on Jan 13, 1920; wife, Rhoda B., d. in 1960.

James (1844-1920) b. in PA; moved to this county; md. Maria David; lived in Bethel Twp. Mrs. Stoneking was a native of this state.

George (1831-1888) b. in Greene Co. PA; moved to this county & md. here in March 1851 to Levina Pyle(s); they had 12 children; David; Uriah (md. Mary C Carey in 1871; had 8 children; became a preacher); Andrew; George, Jr. (Geo. Burned to death a age 4); Solomon; Lucinda; Francis Priscilla; Mary Bell; Thomas S. Eliza Agnes; Amanda Jane; and Hiram. Mr. Stoneking owned several hundred acres of land in south-central Bethel Twp. in the 1870's. Levina (Pyle) Stoneking was born in Green Co. PA.

Hiram (1874-1921), youngest son of Geo. & Levina; (Obit, it part, from The Macomb Daily Journal, Mar 16, 1921): "Hiram Stoneking died at his home in Bethel township at 11:22 this morning, aged 46 years and 5 months .... Deceased had been ailing with rheumatism for some time ..... Friday he commenced to be afflicted with drowsiness & became steadily worse. Physicians were summoned and two of them pronounced the case sleeping sickness, while another diagnosed the case as a blood clot on the brain, probably coming from his rheumatic trouble .... Deceased was one of the best known men in the south part of the county and especially in Bethel Township where he was born and lived all of his life ..... elected assessor of Bethel township ..... survived by his wife, three sons and two daughters."



**STONEKING (Cont'd)**

Addie (1871-1919); b. Apr 9, 1871 in IL; d. in this county on May 9, 1919.

**VAN WINKLE:** Dewey M. (1898-1919) b. in IL, son of Thos. & Minnie (Stoneking) Van Winkle; parents both natives of this state; Dewey d. of tuberculosis on Apr 3, 1919.

**VOGLER:** Frank (1874-1918); b. in MO on May 27, 1873; a son of Fred V. & Mary C. (Moon) Vogler; Fred was born in Germany; Mary in England; they moved to this country before 1870; Frank was as coal miner by trade; he died in Bethel Twp. on Mar 25, 1918; at the time of his death, Mr. Vogler was md.

**WEAVER:** Mary Catherine (1851-1936) b. in Bethel Twp., a daughter of Wesley Carey; mother's maiden name was Frakes; Mary was a widow of Jessie Weaver; she died in this county.

**WILLEY:** Morris (1859-1928); b. Nov 14, 1859; a son of Chas. & Sarah (Frakes) Willey; parents were natives of PA; Morris was md to Louise Willey; he died in this county Feb 1, 1928.

**Notes, Corrections, Additions, and Changes**

## STONEKING GRAVES

Original Location: Bethel Township, SE¼, section 33; six miles south-southeast of Fandon.

Land purchased by strip coal mine company and in 1993, 12 graves were moved to the southwest corner of Stoneking Cemetery; 40° 17' 56" N: 90° 44' 42" W

Remarks: Located west of the north-south road about a half mile north of the McDonough- Schuyler county line. Only two stones remain here at this time; however, eight field-stones were found which indicates at least ten persons have been buried at this site. The general area is wooded; the graveyard is not fenced.

### STONEKING:

Charlotte, dau of J.G. & Ann; d. Jul 12, 1855; age 1y 7m 21d.

Comadore P., son of J.G. & A.; d. Apr 16, 1854; age 6y 3m.

### Notes, Corrections, Additions, and Changes

## VAWTER CEMETERY

Location: Bethel Township, NW¼, section 14; seven and a half miles south of Macomb.  
40° 20' 04" N: 90° 42' 25" W

Remarks: This cemetery, located about three-fourths of a mile west of the former site of the of the East Bethel church, is on privately owned property and is about a quarter mile from a public road. The grounds are adequately fenced, however, a small entrance on the southeast corner is open and, as a result, livestock have been permitted to roam through the area. The cemetery, about an acre in size, is badly overgrown and misplaced from their original sites. Several unreadable field-stones were located and a number of partial stones were found. As indicated below during this survey, taken in early 1975; at this time, it is impossible to determine how many persons have been buried here.

### CALVIN:

John Clay, son of W. H. & M.; d. Aug 14, 1871; age 1y 3m 2d.  
----, son of W.H. & M.; d. May 21, 186-; age ----.  
----, dau of W.H. & M.; d. Jun 24, 1868; age 12y 1m 2d.

### CLARK:

Charlie Clide, son of D.B. & N.J.; d. ----; age ----.

### GROVES:

Harriet, wife of Jame; d. Oct 18, 1864; age 54y 8m 9d.

### HOOVER:

Sebastian; d. Sep 20, 1839; in his 50<sup>th</sup> year; a soldier in the War of 1812; serving in VA Regt.  
Elizabeth, wife of S.; d. Nov 7, 1851; age 51y 3m 8d.  
Mary F., wife of S.R.; d. Oct 12, 1860; age 23y 7m -d.

### JOHNSON:

James; Feb 7, 1832 – Sep 4, 1881.  
Fannie, wife of James; Jun 7, 1834 – Mar 4, 1918.

### LOCKARD:

Infant dau of H. & M.; d. Jun 10, 1897.

### MILLER:

Henry, son of C. & S.; d. Jun 21, 1857; age 19y 11m 28d.  
Charles; d. Feb 20, 1870; age 71y 10m 16d.

### RUSH:

Sarah, wife of A.H.; d. Sep 26, 1878; age 50y 4m 29d.  
A.H.; d. Jul 30, 1868; age 44y 5m.

### TUNIS:

Rachel, wife of J.; d. Mar 9, 1877; age 72y.  
Merva, infant dau of J. & S.; (no dates)  
Jacob; d. Nov 19, 1863; age 66y.  
Jacob W., son of J. & R.; d. Sep 8, 1858; age 25y.

### VAWTER:

Earley H.; Jun 24, 1810 – Apr 9, 1835.

### WELLES:

Samuel, son of W.R. & S.; d. Dec 18, 1858; age 16y 12d.  
William R.; d. Jun 25, 1884; age 63y 8m 5d.  
Sarah, wife of Wm.; d. Nov 25, 1894; age 74y 1m 16d.  
Mary J., dau of ----; d. ----; age ----.

## **Genealogical Notes – Vawter Cemetery**

**HOOVER:** Elizabeth (1800-1851) wife of Sebastian. Appears on the 1840 county tax list as \$ 631; she owned \$80 worth of horses, \$30 in cattle, and \$44 in other property; no real estate; taxes were \$.77.

**JOHNSON:** James (1832-1881), b. in OH; md. in 1855, to Fannie Van Hyning; had 8 children; moved to this county about 1857. James' mother, Nancy Johnson, died the same day as James, also in Bethel Twp. She was 72 years old at the time of her death.

Fannie (1834-1918), wife of James. (Obit, in part, from The Macomb Daily Journal, Mar 8, 1918): "Fannie Van Hyning, daughter of Henry and Clarissa Van Hyning, was born Jun 7, 1834, in Branch Co. MI, and passed away March 4, at 3 p.m. at the home of her son, George, near Doddsville, where she had made her home since October. Death was due to old age and heart trouble ..... She was united in marriage Aug 16, 1855, to James A. Johnson, who preceded her to the other world Sep 4, 1881. To this union eight children were born, one girl and seven boys, four of whom also preceded her, namely, Alonzo P., Charlie, Frank, and an infant. Those living ..... are Serilda Taylor of Macomb; George and Lewis, Bethel township; and Mathew of Aledo. Also a number of grandchildren and four great-grandchildren survive ..... The body was laid to rest beside her husband in the Vawter Cemetery ....."

**MILLER:** Charles (1798-1870), born in CT; moved to Summit Co. OH; md. Sarah Bryant in OH; a daughter, Ellen, was b. in OH in 1826; two sons were also born in that state; Marion in 1834; Henry in 1837. Mrs. Miller was a native of NY, b. about 1798.

**RUSH:** Absolom H. (1824-1868) was b. in PA; md. Sarah Berry; moved to IN; then to this county about 1851; the family lived on section 2, Bethel Twp. In 1860, Mr. and Mrs. Rush had the following children residing in their household: Mary J. (age 11, b. VA); John S. (age 8, b. IN); Samuel (age 6, b. IL); Margaret (age 4, b. IL); and Josiah (age 2, b. IL). Mrs. Rush was a native of PA.

**TUNIS:** Jacob (1797-1863),, born in PA; federal census for 1860 indicates Mr. Tunis was born in 1802; he and wife, Rachael, had the following children living in the household in 1860: Henry (age 24); George W. (13); and Mary (16); all born in OH. Another son, Isaac, was born in OH about 1830; he married prior to 1860. The Tunis families came to IL and lived in Bethel Twp.

**WELLS:** William R. (1820-1884); b. in MD; he and wife, Sarah, had the following children living in their household in 1860: Christopher (age 19, b. OH); Mary Ann (16, b. OH); Eliza (13, b. OH); Benjamin (11, b. OH); James W. (10, b. O); Sarah R (8, b. OH); Aaron (4, b. IL); and Adaline (1, b. IL).

### **Notes, Corrections, Additions, and Changes**

## WILLEY CEMETERY

Location: Bethel Township, NE¼, section 35; ten miles south on county road 16; west one mile; south ¼ mile. 40° 17' 19" N: 90° 42' 00"W

Remarks: This cemetery is well maintained and is in excellent condition. It is completely fenced and the majority of the stones are standing upright and are intact. During this registration, made in April of 1975, five or six small metal markers, similar to those furnished by funeral homes, were located in this cemetery; these had no names or dates remaining within their holders.

### CAREY:

C. J.; (no dates)

### CURTIS:

Margaret, wife of John; d. Jan 8, 1860; age 20y 10m 26d.

### FRAKES:

Catharine, wife of G.R.; (no dates); age 41y.

George R.; d. Jul 24, 1869; age 71y 6m 5d.

Alvin; d. May 20, 1918; IL Pvt. 352<sup>nd</sup> Inf., 88<sup>th</sup> Div.

George Edward; d. May 15, 1922.

### L-----:

J.T.; (no dates) (Large field-stone with the initials "JTL").

### OWENS:

Melissa J.; 1880 – 1968.

Robert E.; 1864 – 1926.

Freddie; Apr ---, 1898 – Apr --, 1898.

Mary E.; May ---, 1909 – Aug ---, 1919.

Peter; (no dates); Co E 2<sup>nd</sup> IL Cav.

Ella M.; Jul 31, 1884 – Feb 28, 1904.

Dale, son of Ella; Feb 22 – Mar 1, 1904.

### SHAW:

John; (no dates)

### WILLEY:

Steven; (no dates); Co K 155<sup>th</sup> IL Inf.

A.; d. Apr 22, 1856; age 79y.

Rachael, wife of Absalom; d. May 8, 1856; age 78y.

Isaac, son of C. & S.; d. Oct --, 1846; age 2y 11m 29d.

John; d. May 30, 1865; age ---. 56y 10m 24d.

Mary, wife of John; d. Aug 26, 1841; age 30y.

Harrison, son of G. & C.; d. Jan 26, 1860; in his 19<sup>th</sup> year.

George; d. Apr 21, 1880; age 65y.

Catharine, wife of Geo.; d. Dec 27, 1885; age 67y.

Andy; (no dates)

W.M.; d. Jun 12, 1877; age 60y.

Sarah, dau of W. & M.; d. Sep 9, 1858; age 3y 9d.

Isaac; d. Feb 7, 1866; age 36y 8m 22d.

Mary, dau of I. & C.; d. Dec 30, 1852; age 1y 9m 23d.

## Genealogical Notes – Willey Cemetery

**FRAKES:** George (1798-1869) appears on the 1840 county tax list as # 603; he owned \$20 in cattle, and \$15 in other property; total taxes were \$.18

**WILLEY:** Steven (CW Vet) (Obit, in part, from The Macomb Daily Journal, Dec 24, 1924): “Steve Willey, well known resident of Macomb, died of heart trouble at 4 o’clock this morning at the Ira Wheeler home, 1120 E. Wheeler street, age 81 years ..... Deceased was born in 1838, in Bethel township, and resided in Colchester before coming here. He served in the Civil War in the 155<sup>th</sup> Regiment, Co K, Illinois, and fought to the end of that great conflict. Deceased is survived by three sons, Al, Arthur, and Earl, and one daughter, Mrs. Ollie Cheeseman, all of Macomb. He also had the following brothers and sisters: A. Boyd, Morris David, Len, and Node, and Mrs. Miranda Frakes of Galesburg.”

Absalom (1777-1856), born in PA; md. Rachel Lemby, also a native of PA; moved to Schuyler Co. IL and lived in Littleton Twp.; moved to this county a year later, in 1834.

Isaac (1843-1846), son of Charles & Sarah (Frakes) Willey. Chas., a son of Absalom & Rachel (Lemby) Willey, moved to this county with his parents in 1834; lived on section 35, Bethel Twp. Chas. was born in Muskingum Co. OH. He and Sarah were md. in this county in 1841; they had 13 children: Liddie, Isaac, David, Andy, Steven, Boyd, Leonard, Noah, Morris, Caroline, Mahala, Amanda, and Laurinda. Charles appears as # 619 on the 1840 county tax list; he owned \$110 worth of horses, \$50 cattle, \$95 in other property; no real estate; taxes were \$1.28.

John (d. 1864) was a son of Absalom & Rachel (Lemby) Willey; he was born in PA about 1806; md. first to Mary, who died in 1841; then md. to Nancy, a native of TN about 1842; John & Nancy had the following children: Jane (1843); Nancy (1845); John (1850); Thomas (1853); and William (1856). John, Sr. appears on the 1840 county tax list as # 609; he owned \$140 worth of horses, \$110 in cattle, \$10 clocks & watches, and \$103 in other property; no real estate; taxes were \$1.82.

George (1815-1880), son of Absalom & Rachel (Lemby) Willey; moved to this county with parents in 1834; born in PA; son, Harrison, b. in 1841; other children included: Rachael (b. 1849) and Lucinda (b. 1858). George appears on the 1840 county tax list as # 616; he owned \$115 worth of horses, \$35 cattle, \$10 clocks & watches, \$25 wagons, and \$105 in other property; no real estate; total taxes were \$1.45.

W.M. (d. 1877); William M. (1817-1877) was another son of Absalom & Rachel Willey; Wm. appears on the 1840 county tax list as \$ 620; he owned \$60 worth of horses; \$80 cattle, and \$70 in other property; taxes were \$105. William was born in PA; his wife Mary, was born in 1821, in OH; they had the following children living in the household in 1860, in Bethel Twp.: Absalom (b. 1838); Lewis (1844); Catherine (1847); Lydia (1850); and George (1858).

Isaac (1829-1866), born in OH; wife, Catherine, also a native of OH; children included: Mary (1851); Henry (1852); Ellen (1855); John (1857); and Hardin (1859).

### **Notes, Corrections, Additions and Changes**

DAR Lineage was recently proven for Mrs. Opal M. Wilcoxon to George Lemley of Greene County, PA, a soldier of the Revolutionary War, by Lavina Walton. Rachel Lemley Willey (1781 – 1859) was a daughter of George Lemley (1742 – 1813) and his second wife Catherine Yoho. John Willey married Mary Shaw as his first wife.