

**RURAL  
CEMETERIES  
OF  
McDONOUGH COUNTY, ILLINOIS**

**VOLUME IV  
LAMOINE - TENNESSEE**

**BY DUANE LESTER  
GOOD HOPE, ILLINOIS**

**PRINTED BY  
SCHUYLER – BROWN  
HISTORICAL AND GENEALOGICAL SOCIETY  
AND  
THE SCHUYLER JAIL MUSEUM**

“A monument is erected  
not because a person died,  
but because a person lived.”

## Volume IV

### Table of Contents

Preface	i – ii
Maps and plats	iii – iv....ix-xiv
McDonough County, Illinois	iii
Areas Covered in Volumes I - XVII	iv
Area north and east of Colmar, including portions of Lamoine and Tennessee Townships	v
Section 30: Tennessee Township, T5N R4W, 1871	vi
Section 35: Tennessee Township, T5N R4W, 1871	vii
Section 4: Lamoine Township, T4N R4W, 1871	viii
Section 11: Lamoine Township, T4N R4W, 1871	ix
Hill's Grove Cemetery	1 - 13
Hutchinson Cemetery	14 - 24
King Cemetery	25 - 31
Rice Cemetery [White Flock]	32 - 35

## Preface

Within the boundaries of McDonough County, Illinois are more than a hundred cemeteries and gravesites ranging in size from a single burial site to the expansive Oakwood Cemetery at Macomb. Within these cemeteries are the remains of an estimated 40,000 individuals who have died since the first settler arrived here over 150 years ago. Graves of countless others are scattered over the countryside of McDonough County; but, exact sites of many of these resting places are no longer known for various reasons. During the early days of this county, there were obviously no central burial grounds; thus, a pioneer family having the misfortune of losing one of its members placed the deceased in a grave on a family homestead and erected a makeshift marker. A number of these family burial grounds later became public cemeteries, however, many of the grave sites soon became "lost". Crude wooden markers or hand engraved stone soon succumbed to the elements and were never replaced; scores of families moved further west after staying in this area only a short time and the gravesites of their loved ones shortly became insignificant mounds of earth; a number of families passing through this vicinity suffered individual losses. A prime example of the latter is contained in a history of Bethel Township. In 1830, four children of an emigrant family died while en route through McDonough County. They were buried near their places of death which occurred about two miles southwest of Fandon. All traces of those graves have long been gone. During the summer of 1834, a widow lady died at her home in northern Tennessee Township. Her coffin of dressed walnut lumber was built by a local cabinet maker and she was buried in the timber near her home. Within a few years, no evidence remained to indicate the presence of her final resting place. A family who created an excellent farm from the prairies a few miles north of Macomb, maintained a fenced family burial site for several years. This cemetery contained the graves of about 12 former family members. During the early 1900's, the farm changed ownership. Shortly thereafter, the new owner removed all the stones, took down the fence and this graveyard became part of a cornfield. These are only three of the countless incidents involving the total disappearance of burial sites. At this time, it is impossible to determine the locations of hundreds of individual's graves in this county.

Vandalism is responsible for the destruction of many grave stones. Countless markers have been partially or totally destroyed. Inscriptions have been obliterated by gunshot blasts, stones have been broken into dozens of pieces, and some markers have been entirely removed from their original locations.

While weather-wear and vandalism accounts for most of the destruction of individual tombstones, neglect is directly responsible for the eventual deterioration of graveyards. Several local cemeteries have had no protective fencing for a number of years and the grounds have become grazing land for livestock. Groundhogs and other burrowing animals have undermined large portions of various cemeteries. Some areas are nearly invisible because of massive growth of weeds and brush. Stones have fallen, broken, and become completely covered with soil and debris.

The overall condition of our county cemeteries is a pathetic case. While some grounds are well maintained, or at least partially kept-up by various families, many have been totally forgotten. This situation is appalling and should never have come about. Apparently, lack of time, expense, and most of all regard has brought about the present-day poor conditions of many of our rural cemeteries.

Genealogical notes accompanying the various cemetery listings were prepared from a wide variety of sources including: Local area history books and atlases; newspaper files; county, state, and federal archives; family histories. These notes were collected at random from readily available sources and little, or no attempts were made to search for material for more complete genealogies. These notes are presented only for the purposes of identification and/or clarification.

Every attempt has been made to present complete and accurate information. Readers will find errors and omissions. Others will not agree with portions of my findings; however, no information contained herein is based solely on assumption or guesswork. It must be remembered that this information has been prepared for use only as a tool for further research and that nothing must be taken as final and absolute.

The larger cemeteries contained in these volumes are accompanied by grave location charts. These charts in no way are intended to represent any professionally prepared plat or survey that may exist. Their preparation and presentation are solely for general location purposes.

When copying inscriptions from grave markers, it is sometimes impossible to read some portions of the engraving. Names, dates, ages, etc. that were found to be unclear or totally missing are indicated by the use of question marks or dashes, i.e., SPICER, James T., infant son of ?J.B. & S.J.?.; d. \_\_\_\_; age \_\_\_\_\_. The letters or numbers enclosed in parenthesis following the inscription, indicated general location as indicated on the accompanying chart.

Abbreviations used are as follows:

b. born	m. months
Cav. Cavalry	md. married
Co. County/Company	sec. section
d. died/days	twp. township
dau. daughter	y. years
Inf. Infantry	

Time and space prohibits proper recognition for all those individuals who gave assistance in preparing and publishing these volumes. Deep and sincere appreciation is extended to all concerned, especially to the following: My parents, Mr. and Mrs. Lloyd Lester, and my wife, Rose; and to Mrs. Lavina Walton and other members of the Schuyler County Historical and Genealogical Society for printing and binding the finished product. Thank you.

Duane Lester

### ADDENDUM

Mr. Lester's Magnum Opus is nothing short of monumental. It is not easy to gain access to many of these historic family burial sites. By the time of Mr. Lester's survey (1970's) numerous plots were long left abandoned, overgrown with trees and weeds and monuments under attack by weather, livestock, vandals, and property owners who did not care about the burial sites of McDonough County's brave pioneers. Thankfully, we now (2012) have laws to protect our county's historical legacy and these final resting gardens.

I am in awe of Mr. Lester for his transcriptions of hard-to-read tombstones and his laborious typing of his 18 Volumes of the Rural Cemeteries of McDonough County. He did not have access to a computer. In addition to transcribing information from tombstones, he had to painstakingly access county records (e.g. 1840 county tax list), federal census records, and local newspapers requiring a great deal of time and effort. As a genealogist in 2012, I have access to the internet with fast access to US Census records, Family Search (records kept by the Church of Jesus Christ of Latter-Day Saints) and numerous other legal documents, books, and family journals. Mr. Lester used an old-fashioned key-strike, ribbon tape typewriter where mistakes were hard to correct and appear as overstrikes. There are very few attesting to his skill as a typist. What an US Census record will not contain are the names and dates of infants who died between census surveys. Mr. Lester's tombstone records give names and dates of children, whose lives were brief, but would otherwise be lost to history without his efforts. Frequently, he provides names of brothers and sisters, fathers and mothers that allows for completion of family group sheets.

Another work of love for those who dared to settle the prairie lands of western Illinois and raise their families is being performed by Dr. A. Gil Belles. He has been able to install signs for each of these rural cemeteries and provide GPS (Global Positioning System) information making it easier for anyone wishing to visit a rural cemetery to help them actually find it. Gil also works closely with Boy Scouts and other civic groups to help cleanup, clear brush and dead trees, locate buried tombstones, and restore stones. My revision of Mr. Lester's document will provide information on all cemetery restoration projects.

Any changes made to Mr. Lester's original work was done in blue color font. His maps were scanned and copied into the text and remain like his original work and are not subject to editing. His text was transcribed using MS Word, enabling me to control font size and color. Retyping text also leaves room for typo errors. Mr. Lester's rare typo errors are corrected but not displayed in blue. This MS Word document allows on-the-fly editing of any "Notes, Corrections, Additions, and Changes" found at the end of every cemetery. This was Mr. Lester's intent to produce a working document and improve accuracy about the information on those buried. I have retyped state abbreviations as they are now used (e.g. IL, instead of Ill.). On 1840 county tax lists I omitted cents (e.g. \$140, instead of \$140.00). The current MS Word font uses less space, thus, placing more text per line. This shrinks his documents and reduces pages. This, then, changes page numbering in each Table of Contents.

Cemetery locations are also found on the internet. See: **McDonough County Illinois Cemeteries**  
<http://graveyards.com/graveyards/IL/McDonough>



McDonough County, Illinois

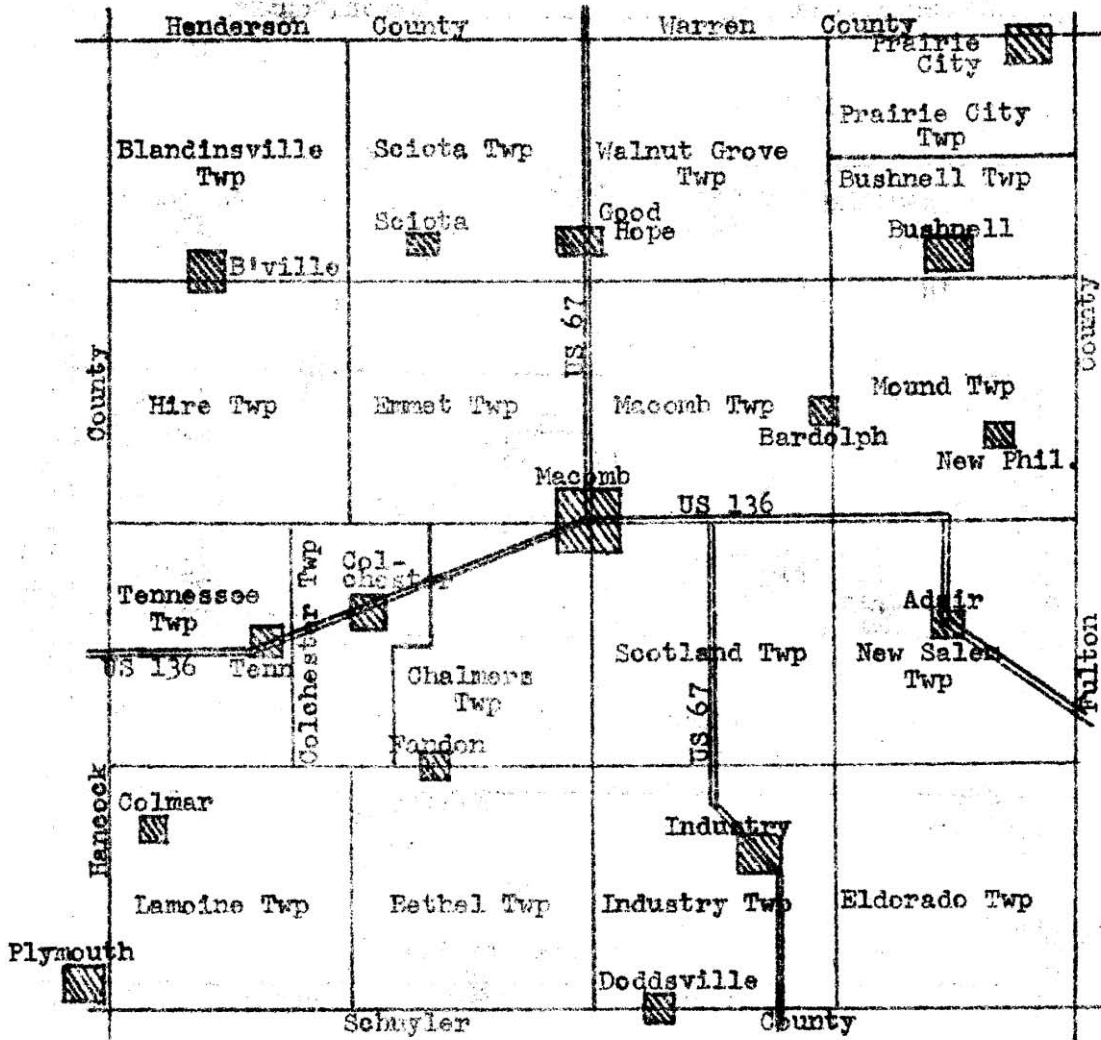

Areas covered by volumes I - XVII  
 "Cemeteries of McDonough County, Illinois"

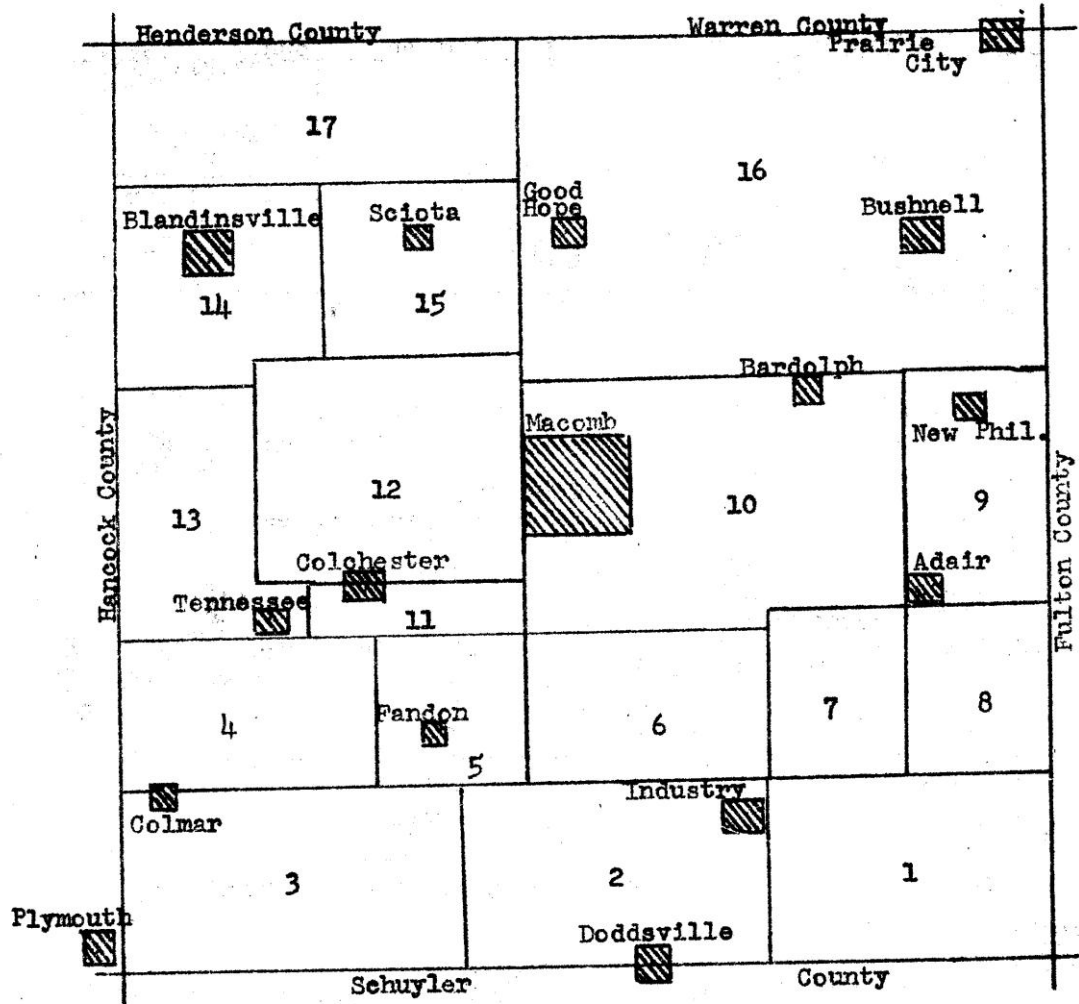

Area north and east of Colmar, including portions of  
Lamoine and Tennessee Townships: 1975.

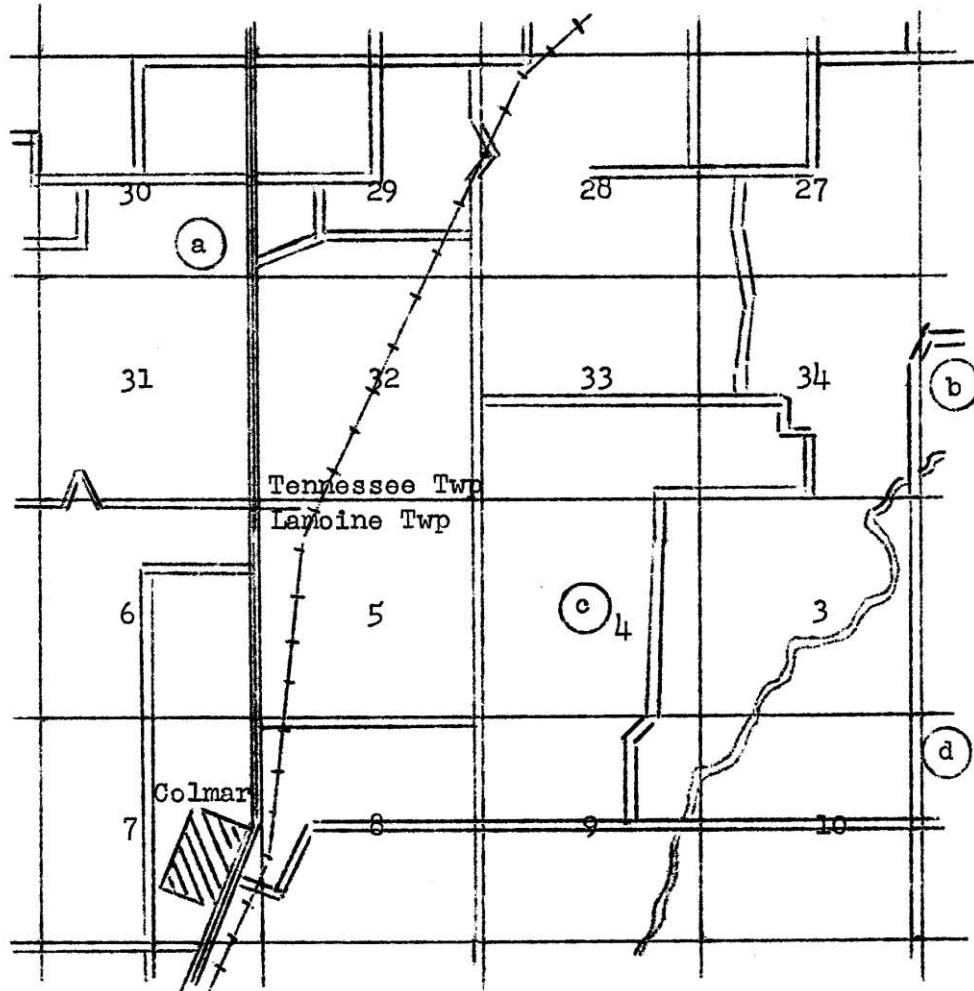

- a. Hills Grove Cemetery
- b. Hutchinson Cemetery
- c. King Cemetery
- d. Rice Cemetery



Section 30  
Tennessee Township, T5N R4W; 1871

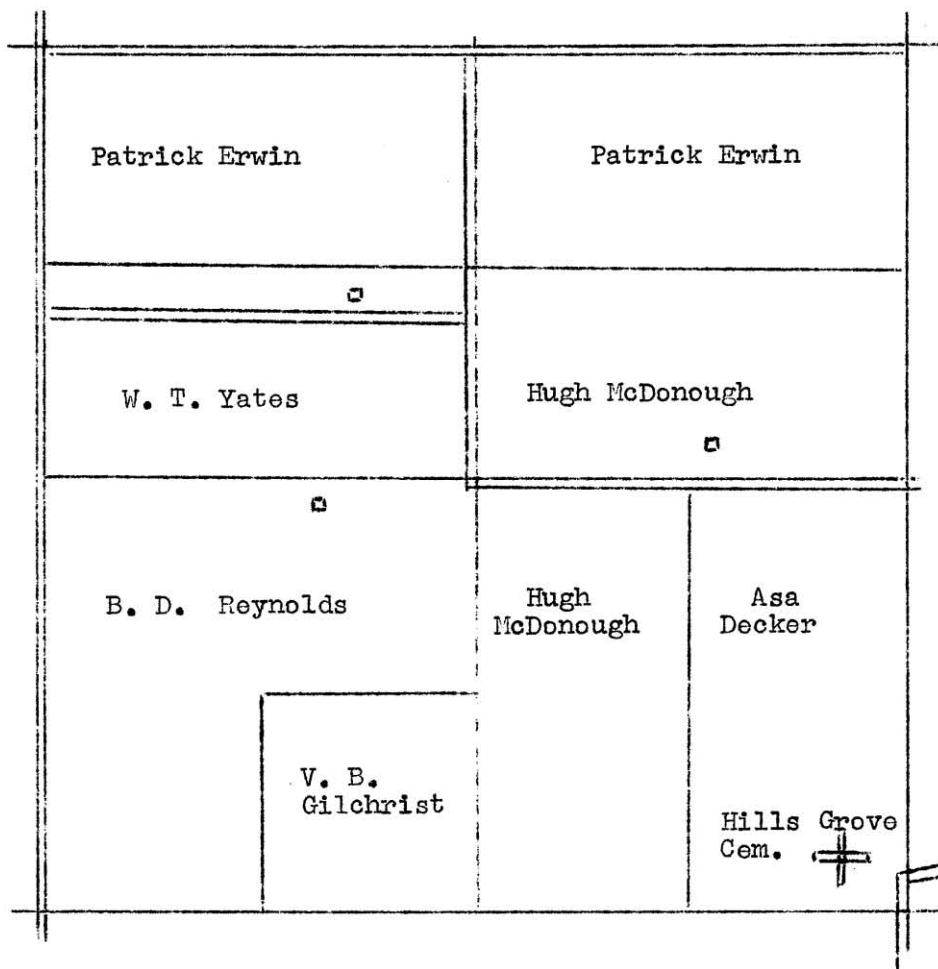

Section 35

Tennessee Township, T5N R4W; 1871

B. Boyd	J. F. Bradford	<div style="text-align: center;">□</div> F. M. Clayton	
J. Jarvis			
W. A. Hutchinson	J. F. Bradford	J. J. Lower	M. Canote
<div style="text-align: center;">□</div> N. Parks	Hutchinson <div style="text-align: center;">+ Cem.</div> R. Sanford	<div style="text-align: center;">□</div> W. A. H. Hutchinson	J. D. Green <span style="float: right;">□</span>
Edward Jarvis			

Section 4  
Lamoine Township, T4N R4W; 1871

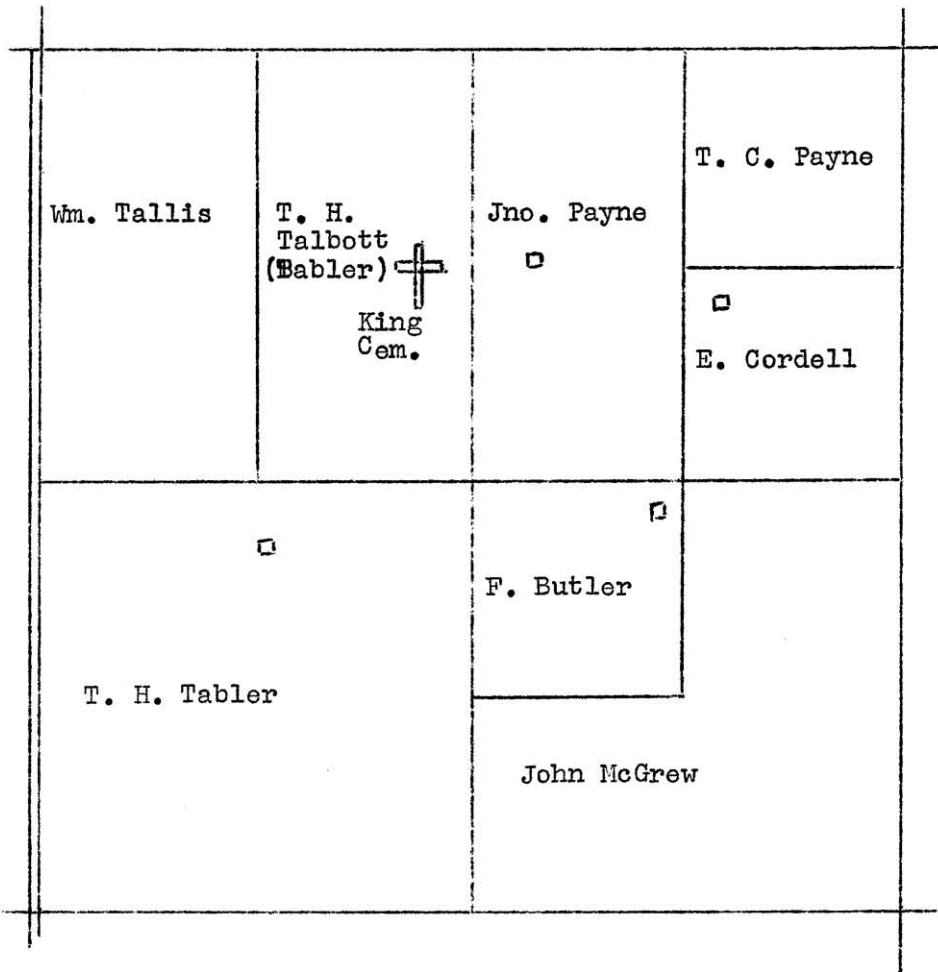

2  
2  
1  
1

Section 11

Lamoine Township, T4N R4W; 1871

5  
6  
7  
5  
1  
15

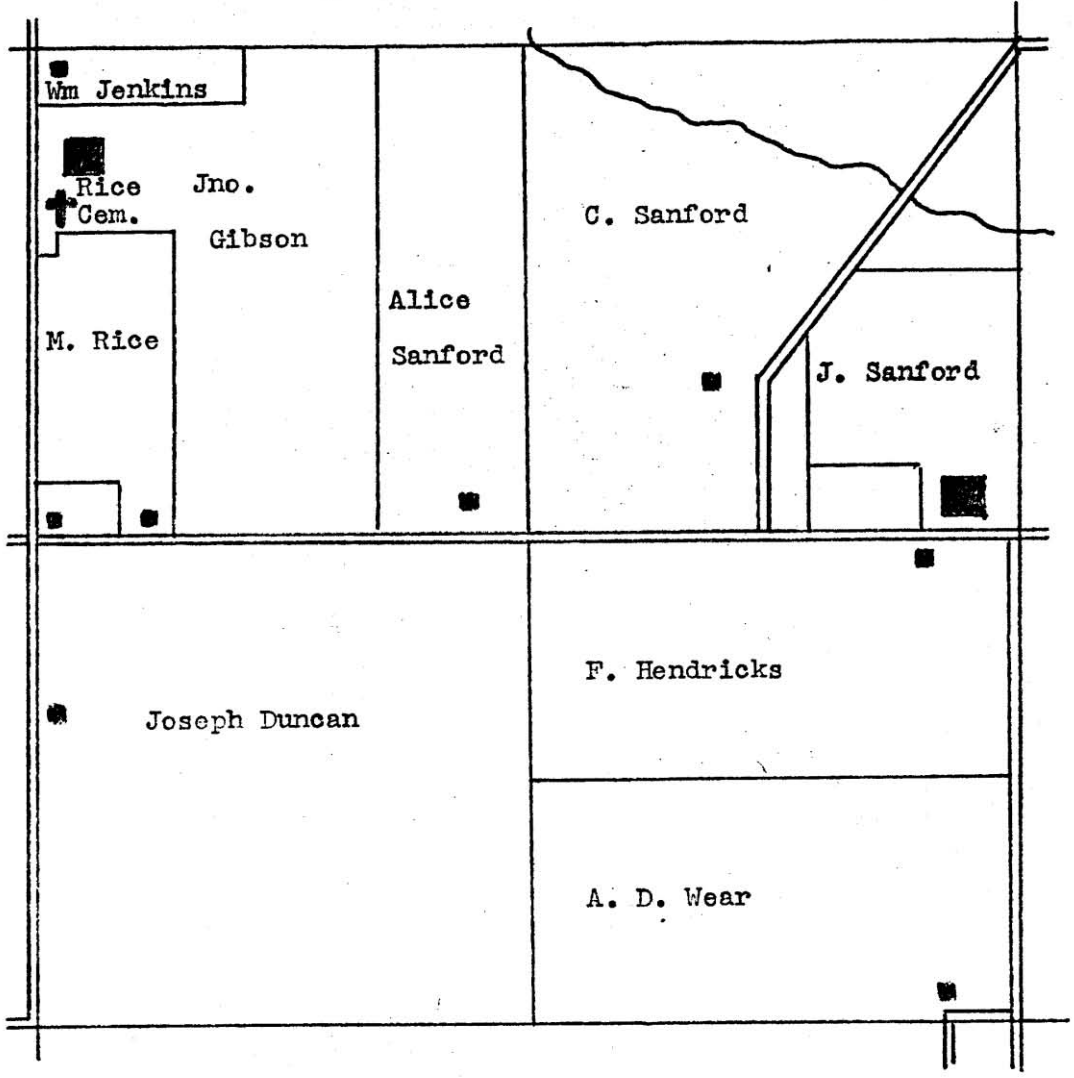

## HILL'S GROVE CEMETERY

Location: Tennessee Township, SE¼, section 30; 3 miles west, one and one-half miles south of Tennessee. South on IL Hwy 61, west side of road, and about .7 miles south of road 750N;  
40° 23' 10.6" N: 90° 53' 25.5" W

Remarks: This cemetery is located a short way west of IL Hwy 61; privately-owned property must be crossed to reach the grounds. The area is completely fenced and the grounds are well cared for. Most stones remain standing and are in relatively good condition. The town of Hill's Grove was laid out in the 1830's by Isaac Holton. A post office was established here in 1839, and during the next several years a number of businesses were operated in this village which was located a short way east of the present location of the cemetery.

Section NW	Section NE
Section WC	Section EC
Section SW	Section SE

ADAMS:

Elmer E.; 1867 – 11913. (NW)

ALLTON:

Andrew M.; 1848 – 1921. (WC)

Eliza J.; 1853 – 1940. (WC)

Delford D.; 1880 – 1921. (WC)

ANDERSON:

James H.; 1859 – 1931. (NW)

Fannie E.; 1862 – 1948. (NW)

BACON:

Honor, wife of L.C.; d. Feb 13, 1864; age 38y 11m 18d. (EC)

Fannie, dau of L.C. & H.; d. Feb 15, 1864; age 13d. (EC)

George W., son of L.C. & H.; Aug 28, 1848 – Nov 13, 1967.

Larkin C.; May 2, 1818 – Oct 24, 1877. (EC)

Frona P.; Mar 9, 1851 – Sep 22, 1880. (EC)

BADGER:

Elizabeth R.; 1864 – 1937. (WC)

William S.; 1862 – 1936. (WC)

Mrs. Fannie; d. Nov 9, 1964; age 89y 6m 12d. (WC)

BARTLETT:

Etta; 1965 – 1952. (SE)

Clarence L.; 1862 – 1943. (SE)

BROADHEAD:

Joshua Dee; 1874 – 1948. (SW)

James T.; 1883 – 1942. (SW)

Emma B.; 1887 – 1931. (SW)

Henry; 1872 – 1948. (NW)

Grace S., wife of H.; 1875 – 1909. (NW)

BURFORD:

Wyatt L.; Aug 3, 1814 – Aug 3, 1892. (NW)

Priscilla M., wife of W.; Oct 27, 1818 – Jan 2, 1902. (NW)

BURTON:

Winifred; 1893 – 1918. (NW)

CARTER:

Russell; 1898 – 1970. (SW)

Alta; 1903 – 1958. (SW)

Russell A.; Feb 8, 1926 – May 5, 1926. (SW)

CONANT:

Isabel H., wife of J.C.;; d. Mar 19, 1841; age ----. (NE)

William H.; d. Feb 27, 1857; age ----. (NE)

Henry G., son of J.C. & A.C.; d. Jun 15, 1854; age 5m. (NE)

COOK:

Linda Lee; 1932. (SW)

Caroline Buford; 1848 – 1924. (NW)

CUBA:

Agnes; 1889 – 1969. (SE)

Bert; 1879 – 1944. (SE)

DECKER:

Asa; Jan 3, 1810 – Apr 17, 1876. (EC) 1810 or 1819?  
Sarah; Feb 7, 1826 – Dec 19, 1868. (EC)  
Honor; Sep 1, 1863 – Sep 27, 1914. (EC)  
Retta; Dec 3, 1857 – Dec 5, 1949. (EC)  
George A.; Jan 18, 1846 – Sep 5, 1919. (SW)  
Hollie C.; Jan 2, 1946 – Apr 15, 1932. (SW)

DEWITT:

Hester Ann Brown, wife of A.T.; Apr 16, 1828 – Dec 11, 1893. (NE)  
Annas T.; d. Oct 5, 1872; age 22y 6m 7d. (NE)  
Henry L., adopted son of A.T. & E.A.; dec 10, 1867; age 9m 12d. (NE)  
Infant son of L.A. & M.A.; d. Nov 10, 1883. (NE)  
Clide, son of L.A. & M.A.; Nov 11 – 27, 1882. (NE)

DINWIDDLE:

William; d. Feb 26, 1860; age----y. (NE)

DORETHY:

Harry E.; 1873 – 1959. (SW)  
Sarah J.; 1874 – 1916. (SW)

DOUGLAS:

Emily, dau of -- & E.; d. Dec 21, 18---; age 7y 1m 22d. (EC)

EATON:

James; Apr 25, 1823 – Apr 13, 1890. (NE)  
Elizabeth C.; Feb 11, 1830 – Mar 26, 1922. (NE)  
H.K., son of J. & E.; May 10, 1859 – Aug 22, 1875. (NE)

FLYNN:

Michael G.; d. Dec 28, 1898; age 83y 9m 27d. (SW)  
Ann M.; wife of Michael; d. Jul 29, 1874; age ----. (SW)  
Lizzie, dau of M. & A.; d. Sep 29, 1867; age 5y 24d. (SW)

FOLEY:

G. Harold; 1904 – 1960. (SE)  
Cornelia G.; 1876 – 1966. (SE)  
George W.; 1875 – 1945. (SE)

FOLTZ:

Amos; May 25, 1926. (WC)  
Maude G.; 1869 – 1926. (WC)

FOUSEL:

Jacob; d. Sep 21, 1873; age 57y 11m 25d. (WC)  
Catherine; d. May 25, 1877; age 49y 1m 14d. (WC)  
Addie; 1858 – 1939. (WC)

FULKERSON:

Mary L., dau of C.W. & L.; Aug 29, 1855 – Mar 6, 1882; age 26y 6m 6d. (NE)  
Charles W.; Oct 14, 1822 – Sep 23, 1885; age 62y 11m 8d. (NE)

GILCHRIST:

Charles C.; d. Jun 30, 1882; b. in Walpole NH, May 27, 1802. (NE)  
Minerva H., wife of C.; d. May 30, 1875; age 69y 7m 12d. (NE)  
Erastus H., son of C. & M.; d. Oct 24, 1851; age 12y. (NE) age 12y or 12?  
Charles V., son of C.A. & E.L.; d. Sep 21, 1863; age ?1?y 8m 20d. (NE)  
Van B.; 1836 – 1914. (NE)  
Sarah A. Robinson, wife of V.B.; 1839 – 1909. (NE)  
Ivan Erastus, son of V. & S.; 1867 – Jun 13, 1880; age 12y 11m 6d. (NE)

GILCHRIST: (Cont'd)

William Leonard, son of V. & S.; 1875 – Jan 2, 1876; age 11m 11d. (NE)  
Carolyn Vernice, dau of Chas. V. & Sarah S.; d. Mar 26, 1905; age 1m 9d. (NW)  
Infant son of Chas. V. & Sarah S.; d. May 18, 1898. (NW)  
Charles V.; 1869 – 1920. (NW)  
Sarah, wife of Chas.; 1869 – 1934. (NW)

GLASGOW:

Amos R.; d. Dec 23, 1883; age 29y 6m 14d. (WC)

GOODRIDGE:

Elva I., dau of J.T. & A.M.; Feb 28, 1890 – Jul 4, 1891. (WC)

GREEN:

Mary C., wife of Wm.M.; Dec 15, 1845 – Nov 11, 1880; age 35y 11m 19d. (NE)  
Lilly Bell, dau of Wm. & Mary; Aug 26, 1866 – Dec 22, 1878; age 12y 3m 22d. (NE)  
George W.; d. Feb 16, 1891; age 48y 10 19d; Co A 118<sup>th</sup> IL Inf. (NW)  
Mary A.; d. Jan 30, 1891; age 72y 1m 5d. (NW)

GUY:

Merle Bryan; 1896 – Jan 9, 1936; Seaman US Navy. (SW)

HAGGARD:

Charles W.; Aug 11, 1858 – Feb 11, 1864. (NE)  
Eglatine, wife of A.J.; Oct 30, 1831 – Dec 16, 1862. (NE)

HARDING:

Dean F.L.; 1838 – 1865. (SW)

HEIKES:

William; 1866 – 1949. (SE)  
Florence; 1872 – 1960. (SE)

HOLT:

Olive Ann Broadhead; 1870 – 1938. (SW)

HOLTON:

Phoebe Arnold, wife of Isaac; b. in Westminster, VT, Jan 29, 1798; d. Feb 1, 1887. (NE)  
Isaac; b. in Westminster, VT, Mar 13, 1790; d. Jun 26, 1850. (NE)  
Anna P., dau of Isaac & Phoebe; d. Sep 30, 1848; age 9y 9m.  
Joel A.; d. Apr 25, 1860; age 18y 10m 10d. (NE)  
Elizabeth Roe, wife of Seth A.; d. Jan 4, 1860; age 33y 2m.

JACKSON:

Mary W.; 1876 – 1926. (SE)  
Wyman A.; 1872 – 1913. (SE)

KNOEDLER:

John W.; 1877 – 1963. (SW)  
Millie L.; 1879 – 1935. (SW)

KNOTT:

Susannah, wife of S.A.; d. Sep 9, 1854; age 51y 1m 6d. (EC)  
Mary A., dau of S.A. & S.; d. Feb 8, 1853; 21y 7m 18d.  
Lucy M., dau of S.A. & S.; d. Sep 21, 1853; age 18y 6m 28d.  
Helen M., dau of S. & S.; d. Sep 7, 1854; age 16y 9m 2d.

MAVIS:

Theodore, Jr.; Feb 8 – 9, 1935. (SE)

MC DONOUGH:

Charles; 1863 – 1938. (SE)  
Sarah J., wife of Chas.; 1863 – 1927. (SE)  
George H.; 1861 – 1923. (SE)



MC DONOUGH (Cont'd):

John Leo; Mar 11, 1850 – Feb 17, 1907. (NE)  
Hugh; Oct 14, 1823 – Feb 23, 1870. (NE)  
Mary Moore, wife of H.; Nov 20, 1825 – Oct 20, 1910. (NE)  
James Adolphus; Nov 20, 1855 – Jun 8, 1902. (NE)  
Sarah J. Morrow, wife of J.A.; Jul 18, 1859 – Jul 4, 1928. (NE)  
Infant dau of J.A. & S.J.; d. Aug 20, 1882. (NE)  
Infant dau of J.A. & S.J.; d. Mary 1, 1889. (NE)  
Infant son of J.A. & S.J.; d. Apr 27, 1890. (NE)

MC GEE:

Samuel E.; 1867 – 1922. (SW)  
Mary H.; 1867 – 1952. (SW)

MC KONE:

Kathryn Broadhead; 1868 – 1947. (SW)  
Hazel May; 1891 – 1961. (SW)

MORROW:

Samuel A., son of J.L. & I.D.; 1879 – 1881. (SW)  
Samuel J.; 1889 – Aug 28, 1964; age 74y 7m. (SW)  
Ben T.; 1866 – 1937. (SW)  
Suzanne; 1868 – 1945. (SW)

NELSON:

John M.; 1889 – 1953. (WC)  
Albert T.; 1896 – 1946. (WC)

NICHOLS:

Charles Elmer; 1872 – 1944. (SW)  
Leanora Dorethy; 1871 – 1938. (SW)  
William H.; 1846 – 1906; Mus'n Co E 36<sup>th</sup> IL Inf. (NW)  
Rachel A.; 1849 – 1912. (NW)

OWEN:

Elizabeth H.; d. Aug 20, 1865; age 70y 6m 19d. (EC)  
Asel; Dec 8, 1792 – Nov 21, 1869. (EC)  
B.E., infant son of A.K. & N.A.; d. Jul 20, 1876; age 1y 10d. (EC)  
Elizabeth J., wife of A.G.; Sep 29, 1826 – May 1, 1881. (EC)  
Clarence M., son of A.G. & E.; d. Oct 15, 1851; age 5m 20d.  
Infant of A.G. & E.J.; d. Jun ---, 1856. (EC)  
Elmore, son of A.G. & E.J.; d. Sep 13, 1868; age 1m 2d. (EC)  
Asal, son of A.G. & E.J.; d. Oct 25, 1877; age 6y 11m 16d.  
Mary Ann, dau of A.G. & E.J.; d. Oct 16, 1857; age 11m 22d.  
Ambers G.; Sep 26, 1821 – May 23, 1895. (EC)  
Mary L., dau of R. & M.A.; d. Oct 10, 1881; age 2y 7m 1d.  
Roswell, son of R. & M.A.; d. Aug 30, 1884; age 4y 6m 17d.  
Infant dau of R. & M.A.; d. Jun 22, 1869. (EC)  
Infant dau of R. & M.A.; d. Feb 8, 1876. (EC)  
Earnest, son of R. & M.A.; d. Nov 18, 1875; age 1y 1m 8d.  
Maurice H., son of R. & M.A.; d. Nov 17, 1875; age 3y 8m 8d.  
Wallace F., son of R. & M.A.; d. Sep 30, 1877; age 4y 6m 8d.  
Roswell; d. Sep 7m 1879; age 29y 7m 7d. (EC)

PHELPS:

Samuel David; b. & d. Nov 15, 1864. (SW)

REYNOLDS:

S.F.; Jul 24, 1833 – Aug 28, 1908. (NW)  
B.D.; d. May 5, 1886; age 72y 4m 10d. (NW)

RILEY:

Frank; 1870 – 1950. (SW)  
Ellen; 1869 – 1943. (SW)

RINEHART:

Elva H.; 1863 – 1946. (SE)  
Bruce B.; 1875 – 1943. (SE)  
Iva M.; 1887 – 1966. (SE)  
Lyman H.; 1876 – 1941. (SE)  
John; Sep 13, 1841 – Sep 24, 1924; Co G 143 rd Regt PA Vol Inf. (NW)  
Maria, wife of John; Sep 24, 1846 – Apr 25, 1910. (NW)

ROBERTS:

Garnet; infant; 1908. (NW)

ROSS:

Louisa Bacon; Mar 12, 1861 – Dec 30, 1896. (EC)

RUDELL:

George H.; Dec 26, 1821 – Jan 4, 1904; Pvt Stapp's IL MTD Vol Mex War. (WC)  
Mary, wife of Geo.; Sep 23, 1828 – Aug 21, 1902. (WC)  
Robert M.; 1856 – 1931. (WC)  
Sarah J.; 1857 – 1941. (WC)

SALISBURY:

-----, father; 1816 – 1895. (NE)  
-----, mother; 1820 – 1884. (NE)  
Homer; 1860 – 1872. (NE)  
Joseph; 1854 – 19--. (NE)  
A.T.; (no dates); Co A 64<sup>th</sup> IL Inf. (NE)

SCHLEGEL:

Milton; 1856 – 1936. (WC)  
Catherine I.; 1867 – 1932. (WC)  
Frances E., infant son of M. & C.I.; b. & d. Aug 13, 1896.  
Lilie B., infant dau of M. & C.I.; d. Jul 22, 1891; age 1y 7m 4d. (WC)  
Clarence, son of M. & C.I.; d. Sep 5, 1896; age 11y 5m 18d. (WC)

SEYMORE:

Alice A.; 1863 – 1939. (SW)

SHIFLEY:

A. Lincoln; 1862 – 1929. (SE)  
Lillie; 1867 – 1945. (SE)  
Beulah E., dau of A.L. & L.; d. Jan 30, 1893; age 3m 14d.  
Gordon L.; d. Dec 16, 1931. (SE)  
Caroline A.; d. Nov 16, 1895; age 60y 9m 11d. (NW)  
Max; 1855 – 1925. (NW)  
J.C.; Jul 19, 1856 – Mar 31, 1936. (NW)

SHORE:

Isiedeen; 1878 – 1953. (SE)  
Clayton L.; 1878 – 1947. (SE)

SIDWELL:

Nina D., wife of T.E.; d. Jan 2, 1908; age -----. (NE)  
Emma; (no dates). (NE)

SIEPEL:

Infant son of W.E. & O.B.; May 12 – 13, 1917. (NW)  
Olive B.; 1879 – 1928. (NW)  
Willard; 1877 – 1956. (NW)

STEWART:

Malcom; Jan 4, 1834 – Jul 28, 1887. (EC)  
Harvey, son of M. & E.; Oct 20, 1872 – Dec 4, 1872. (EC)  
Eddie M., son of M. & E.; Feb 23, 1870 – Sep 3, 1878. (EC)

TERRELL:

Roswell; May 23, 1798 – Apr 13, 1872; Pvt Oviatt's Co 2<sup>nd</sup> OH Mil War of 1812. (NE)

THOMPSON:

Della A., dau of B.F. & M.S.; d. Jan 23, 1879; age 4y 23d. (SE)  
Myrta V., dau B.F. & M.S.; d. Jun 25, 1868; age 15m. (SE)  
Louie, dau of B.F. & M.S.; Jul 27, 18--; age ?1?y 6d.  
-----, child of B.F. & M.S.; d. Sep 30, 1865; age -----. (SE)  
B.F.; b. Payson, IL, Nov 7, 1834; d. Tennessee, IL, Jan 22, 1888. (SE)  
Mary S. Walker, wife of B.F.; b. Hill's Grove, IL, Jan 12, 1838; d. Ft Madison, IA, Nov 10, 1927. (SE)

TOLIVER:

Gerald; d. Jan 21, 1975; age 21y. (SW)

TWITCHELL:

William H.; 1861 – 1948. (SW)  
M. Katherine; 1859 – 1942. (SW)

WADDILL:

W.M.; 1866 – 1952. (SW)  
Ella R.; 1863 – 1951. (SW)  
John W.; 1863 – 1941. (SW)  
James M.; 1861 – 1939. (SW)  
Ida E.; 1864 – 1934. (SW)  
Orval; 1885 – 1961. (SW)

WALKER:

Mathew H.; 1842 – 1916. (EC)  
Frances Thompson, wife of M.H.; 1844 – 1932. (EC)  
Willie; d. Oct 31, 1866; age 10d. (EC)  
Louisa; d. Jan 7, 1869; age 5m. (EC)  
Marcus H.; 1833 – 1944. (EC)  
Mabel; 1881 – 1886. (EC)  
Frederick T.; 1875 – 1894. (EC)  
(Latter 5 were children of M.H. & F.)  
James V.; Apr 30, 1840 – Apr 26, 1907. (NE)  
Nettie, dau of A.J. & E.; d. Sep 8, 1872; age 14y 3d. (NE)  
Elizabeth C.; d. Feb 21, 1864; age 49y 1d. (NE)  
Andrew J.; d. Feb 25, 1864; age 60y 10m 16d. (NE)

WEBB:

Mabel A.; 1888 – 1954. (SE)  
Charles J.; 1891 – 1954. (SE)  
Clarence Armour; 1916 – 1921. (SE)  
Thomas I.; 1851 – 1933. (EC)  
Mary D.; 1852 – 1939. (EC)

WIBBY:

Eliza J., dau of C.F.; d. Aug 2, 1886; age 6y 10m 1d. (NW)

**WILLIAMS:**

Noel V.; 1908 – 1912. (EC)  
Fred M.; 1869 – 1952. (EC)  
Rosa L.; 1875 – 1949. (EC)  
Rev. D.R.; d. Jul 8, 1852; age 47y 10m 2d. (NE)  
Abby M., wife of D.R.; d. Jun 7, 1843; age 37y 5m. (NE)

**WINDOW:**

Cassie; 1886 – 1924. (SE)  
Winnifred Rebecca; Feb 4, 1879 – Aug 6, 1880. (SE)  
Infant son of W.H. & L.R.; d. Dec 21, 1887. (SE)  
Ben, son of W.H. & L.F.; 1884 – 1956. (SE)  
W. H.; Aug 15, 1841 – May 30, 1893. (SE)  
Louise; 1849 – 1939. (SE)

**WOODS:**

Rita Sue; b. & d. Sep 15, 1959. (SW)

**UNKNOWN:**

-----  
Samuel A., son of M.L. & I.D.; d. Jan 16, 18---; age 2y 21d. (EC) (Stone broken).

**Genealogical Notes – Hills Grove Cemetery**

**ALLTON:** Delford D. (1880-1903). Born at Hill's Grove; never married; died on Feb 17, 1903 at Tennessee, IL, age 22y 5m 17d.

**BACON:** Honor (1825-1864), wife of Larkin; maiden name was Durbin; born at Louisville, KY.

Larkin Crouch (1818-1877); son of Joseph B. & Agnes (Crouch) Bacon; parents natives of TN; Larkin's b. in Washington Co. TN; moved to MO; then to this county in 1834; settled in section 22; Tennessee Twp.; md. Dec 26, 1841, to Honor Durbin; she died in 1864; their children included Joseph Barnes Bacon, who later became a Macomb physician; after Honor's death, Mr. Bacon md. on Oct 20, 1864, to Mrs. Louisa (Latimer) Meek of Abingdon, IL.

Frona P. (1851-1880) (Death notice, in part, from The Macomb Eagle, Sep 25, 1880): "Died in Macomb on Sep ; 22<sup>nd</sup>, Frona Bacon, daughter of L.C. & H. Bacon ..... The funeral was from the residence of D.G. Tunncliff ....."

**BARTLETT:** Clarence (1862-1943); moved to this county in 1863 later farmed & raised sheep on section 7, Lamoine Twp.

**BROADHEAD:** Joshua Dee, James T., and John Henry were sons of James T. and Susan A. (Vaughn) Broadhead, who were md. in this county in 1862. Other members of the Broadhead family are buried at the King Cemetery in Lamoine township.

**BURFORD:** Wyatt L. (1814-1892), b. Amherst Co. VA; son of Wm. Burford; the family moved to Anderson Co. KY about 1816; lived a few miles from Lawrenceburg; Wyatt moved to IL in 1832 and lived in this area about 3 years; return to KY and md. Priscilla M. Driskell on Mar 9, 1837; returned to IL & moved to Hancock Co. near St. Mary for about 20 years; moved to Tennessee, IL in 1857 & worked as a carpenter for about 2 years; then resumed farming on section 17, Tennessee Twp.; Wyatt & Priscilla had 10 children: Dennis; Louisa; Mary Jane (Mrs. Henry Canote); William; Caroline; Susan (Mrs. Sam'l White); Lucy (Mrs. John McClure); John; and 2 that died in infancy.

Priscilla (1818-1902), wife of Wyatt; daughter of Dennis & Mary (Griffin) Driskell; b. in KY; d. in Tennessee, IL

**DECKER:** Asa (1819-1876), b. in NY; moved to this county in 1840, from Geneseo Co. NY; farmed on section 32, Tennessee Twp.

**EATON:** James (1823-1890) engaged in coal mining beginning in about 1876, north of Tennessee; also involved in the mercantile business in Tennessee; he and his partner, James Marvis, opened a general store in Tennessee in 1858.

Elizabeth C. (1830-1922), wife of James; daughter of John & Elizabeth (Beckelheimer) Lower.

**FOLEY:** George William (1875-1945); b. in this county; md. Cornelia Gilchrist; farmed on section 29, Tennessee Twp.

Cornelia, wife of Geo. W.; daughter of Van B. & Sarah A. (Robinson) Gilchrist.

**FULKERSON:** Charles (1822- 1885), b. in Washington Co. TN; son of James & Elizabeth Hannah (Waddill) Fulkerson; moved to IL with parents in 1831; md. Jan 1, 1846 to Lavina Owen, dau of Asal & Elizabeth (Cowan) Owen; Chas. & Lavina had 5 children: Asal; James; Elizabeth H.; Mary L.; and Chas. His parents are buried at the King Cemetery.

Mary L. (Death notice, in part, from The Macomb Journal, Mar 9, 1882): "Miss Mary Fulkerson, daughter of C.W Fulkerson of Hill's Grove, died Tuesday, March 9<sup>th</sup>, aged 29 years. She was a school teacher and is survived by her parents, brothers and a sister ....."

**GILCHRIST:** Charles (1802-1882) (Death notice, in part, from The Macomb Journal, July 6, 1882): "Charlie O. Gilchrist, one of the pioneers of McDonough Co., died at Fountain Green on June 30<sup>th</sup>, aged 80 years. Until lately he had been a resident of Hills Grove ...." Born in Walpole, NH; son of Sam'l & Betsey (Allen) Gilchrist; Betsy was a neice of Co. Ethan Allen; Charles lived at home & in the Cambridge, MA area until age 21, when he moved to Westminster, VT; then moved to this county in 1837; he md. Dec 31, 1829 to Minerva H. Holton; they had 5 children; Helen (Mrs. L.F. Ferris); Charles A.; Van B.; Erastus H.; and Edward M. Mr. Gilchrist appears as #855 on the 1840 McDonough Co. tax list. He owned 40A in the NW¼ of section 32, Tennessee Twp.; also \$140 worth of horses, \$60 cattle, \$10 clocks & watches, \$50 wagons, and \$40 in other property; total taxes were \$2.30.

Minerva, wife of Charles, was a daughter of Joel, Holton; she was b. in Windham Co. VT

Erastus H. (1839-1851), son of Chas. & Minerva; was killed in this county by a horse.

Charles V. (d. 1863), a son of Charles A. & Lucy E. (Walker) Gilchrist; Chas. & Lucy died in this county & were buried at the Pearce Cemetery, Walnut Grove Twp.

**GILCHRIST (Cont'd):**

Van B. (1836-1914), son of Chas. & Minerva; b. Apr 11, 1836, at Westminster, VT; moved to this county with parents; moved to CA and lived there from 1853 to 1861; returned to this county & bought a farm; md. Dec 4, 1862, to Sarah A. Robinson; had the following children: Ivan Erastus; Wm. Leonard; Elva (Mrs. B.B. Rinehart); Grace (Mrs. Judd Breeden); Charles V.; & Cornelia (Mrs. Wm. Foley).

Sarah A. (1839-1909), wife of Van B.; daughter of Henson & Sarah Ann (Reed) Robinson; b. in Green Co. OH.

**GLASGOW:** Amos R. (Death notice, in part, from The Macomb Journal, Dec 29, 1883): "Amos Glasgow died Dec 23<sup>rd</sup>. He is survived by a wife and little daughter ....."

**HOLTON:** Isaac (1790-1850), b. in VT; graduated from the Univ of VT in 1814; read law with a brother, John, in Springfield, MA; taught school in VT & ME; moved to this county in 1835; traded a church pew in Bango, ME for 160 acres of ground in this county – the SW¼ of section 29, Tennessee Twp.; arrived here and laid out the town of Hill's Grove; opened the first school in the area; md. Jun 6, 1827, to Phebe Arnold; they had the following children: Seth Arnold; Rebecca (Mrs. Joseph Mason); Dr. John Ambrose (an Arkansas dentist); Rev. Chas. Augustus (lived in Peoria Co); Julia Esther (Mrs. Hiram G. Ferris); Anna Phebe; Joel Alexander. Mr. Holton appears as #857 on the 1840 McDonough Co. tax list; he owned 320 acres in section 29, Tennessee Twp; residence was in the SW¼ of that section; he also owned \$40 worth of horses, \$34 cattle, \$10 clocks & watches, \$25 wagons, & \$72 in other property; total taxes were \$6.56.

Phoebe (1798-1887), wife of Isaac; daughter of Seth & Esther (Ramsey) Arnold; after the death of her husband in 1850, Mrs. Holton moved to Carthage & lived several years with her daughter and family, Mr. & Mrs. Hiram Ferris.

Elizabeth (1826-1860), first wife of Seth Arnold Holton; after her death, Seth md. Margaret (Farley) Shedd and they later moved to Washington, D.C. where he was employed with the Treasury Dept.

**KNOTT:** Susannah (1803-1854), wife of Sam'l. Mr. Knott appears as #854 on the 1840 county tax list; he owned \$100 worth of horses, \$57 cattle, \$30 wagons, and \$45 in other property; taxes were \$1.16.

**MC DONOUGH:** Hugh (1823-1870), b. in Owen Co. KY; son of Hugh, Sr.; moved to this county in 1831; lived in Tennessee Twp.; Hugh, Sr. died here on Aug 25, 1849; Hugh, Sr. had 5 children: Cornelius; Hugh, Jr.; Lee; John; and Edward. Hugh, Jr. md. Mary Moore on Apr 25, 1849; they had 6 children: Lee; Adolphus; George H.; Charles; and 2 others who died at early ages.

Mary (1825-1910), wife of Hugh, Jr.; daughter of John & Maria (Beard) Moore; b. in Yorkshire, England; moved to America with parents in 1831; lived in Toronto, Canada for several years; moved to IL in 1840 & lived in Hancock Co.

John Lee (1850-1907), son of Hugh, Jr.; b. in Hancock Co.; md. Carrie Saunders; graduated from business school; later ran a stock ranch in NE.

James Adolphus (1855-1902), son of Hugh, Jr.; b. in this county; md. Sarah Morrow; farmed in Tennessee Twp.; died at Colchester.

**NICHOLS:** William H. (1846-1906); born in PA; carpenter by trade; died in Hancock Co. IL Feb 8, 1906.

Charles E. (1872-1944); b. in Hancock Co. IL; moved to Tennessee Twp about 1882; bridge contractor.

**OWEN:** Asel (1792-1865), b. in KY; later lived in IN; also in OH for a short time; moved to St. Louis, MO about 1839; then to this county in 1840; lived near Hill's Grove.

Elizabeth H. (1795-1865), wife of Asel Owen; b. in VA; maiden name was Grafton.

Ambers G. (1821-1895), son of Asel & Elizabeth; b. in Champaign Co. OH; moved with parents to IN; then to MO; then to this county in 1840; md. here Dec 1848, to Elizabeth Terrill; they had 10 children including: Clarence M.; Elmore; Asel; Mary Ann; Ambrose E.; Lawrence S.; Nellie L.; Frank; Roswell; and a child that died in infancy. Ambers and a brother, Asel, operated a general store in Tennessee, IL for several years; Asel later moved to Lake Geneva, WI and established a newspaper there about 1882. [Spelling of Asel or Asal?](#)

Elizabeth J. (1826-1881), wife of Ambers G.; daughter of Roswell & Mary Ann (Sidwell) Terrill. (Death notice, in part, from The Macomb Journal, May 12, 1881): "Mrs. E.J. Owen, wife of A.G. Owen in Hillsgrove, died on May 1<sup>st</sup>. She was a daughter of Roswell Tyrrel; b. in Fulton Co. IL on Sep 29, 1826; came to Hillsgrove with her father in 1832; married Mr. Owen in 1848. A son preceded her in death; survived by husband, sons and a daughter."

**REYNOLDS:** B.D. (1813-1886). b. in Washington Co. OH on Dec 25, 1813; son of Thos. & Elizabeth (Wilson) Reynolds; Thos. died there in 1850; Elizabeth died there in 1884; B.D. lived at home till age 14; then went to sea; spent a number of years traveling the world; later he was a pilot of river boats on the Mississippi, Missouri, & Ohio rivers for about 20 years; retired from that life in 1848; came to this county about 1848; md. here in Sep 1848 to Amelia O. Thompson, a native of KY; they had a daughter, Louisa (Mrs. W.H. Window); Mrs. Reynolds died Jul 2, 1864; B.D. md. 2<sup>nd</sup> to Sophronia Freeman ([or Freeland?](#)) on Sep 20, 1865.

S.F. (1833-1908), 2<sup>nd</sup> wife of B.D. Reynolds; Sophronia was a daughter of Francis & Julia Freeland; they settled in this county in 1834 & lived in Blandinsville & Hire townships; the Freelands later moved to Shelby Co. MO; Mrs. Freeland died there in Apr 1873.

**RINEHART:** Elva Helen (1863-1946), wife of B.B.; dau of Van B. & Sarah A. (Robinson) Gilchrist; the Rinehart's lived in Hancock Co. IL for several years.

**ROSS:** Louisa (1861-1896) (Death notice, in part, from The Macomb Eagle, Dec 31, 1896): "Mrs. Lou B. Ross, after a long illness of consumption, died at the home of her sister Mrs. D.B. Tunncliff, on E. Washington St., shortly before noon Wednesday. She was about 35 years of age. She leaves two children, a son & a daughter...."

**RUDELL:** George H. (1821-1904). George Harrison Ruddell, b. in Bourbon Co. KY; son of Wm. & Armonas (Phelen) Ruddell; moved with parents to Sangamon Co. IL in 1829; to this county in 1835; first lived in Hire Twp; Armonas died there in 1838; Wm. Ruddell then moved in 1840 to Van Buren Co. IA; he died there in 1871; George moved to section 17, Tennessee Twp in 1864; md. Nov 1, 1849, to Mary Dorothy; they had the following children: William T.; George H. Jr.; Robert Marion; Emily (Mrs. Geo. Towers); Mary; Andrew Jackson; Elizabeth; and John Wesley. George, Sr. served for a year during the Mexican War.

Mary (1828-1902), wife of George; daughter of Thomas & Elizabeth (Sissell) Dorothy; b. in Washington Co. KY; moved with parents to Blandinsville Twp. this county in 1834; Thos. later moved to Hancock Co. where he died in 1855; Mrs. Dorothy died in this county in 1876.

Robert M. (1856-1931), son of Geo. & Mary; born in this Co.; md. Sarah J. Wixon on Mar 19, 1885; lived in Tennessee Twp.

**SALISBURY:** -----, mother (1820-1884) (Death notice, in part, from The Macomb Journal, Sep 25, 1884): "Mrs. Sarah Salisbury, a former resident of Tennessee (IL), died at her residence in Galesburg, Knox Co. on Sep 10<sup>th</sup>. She is survived by her husband, several children, all of whom are grown, brothers and sisters. Burial was on the 11<sup>th</sup> at Hills Grove in this county."

Ambrose T. (A.T.); was a Tennessee (IL) merchant during the 1880's; IL VA records indicate Mr. Salisbury died in 1895.

**SHIFLEY:** Max (1855-1935), son of George and Caroline (Helock) Shifley (also spelled Schifley); parents were born in Germany; Max was born in PA on Dec 21, 1854; never married; died on Apr 29, 1925 in this county.

**TERRELL:** Roswell (1798-1872) (NOTE: Surname also spelled variously as Terrill/Tyrrell) Son of Abijah & Naomi; b. near Hartford, CT; enlisted in the army at age 16 years toward the end of the War of 1812; served thru 1814; parents had moved to OH about 1812; Roswell returned to Trumbull Co. OH; there till 1819; then he came to IL and lived in Madison Co. about 4 years; then to Fulton Co. and md. there Feb 22, 1823, to Mary Ann Sidwell; they had a daughter Elizabeth (b. 1826; md. A.G. Owen); Mrs. Terrell died in Fulton Co. in May 1828; Roswell moved to Tennessee township in 1830; he md. second, to Hannah Ann Brooks, on Jul 8, 1831; they had a daughter; Roswell in 1849 went to CA and remained there about 3 years. Mrs. Terrell (formerly Hannah Brooks) died in 1852. Mr. Terrell appears on the 1840 county tax list as #860; he owned 160A in the SE¼ of section 29, Tennessee Twp.; No personal property is shown on this list, indicating that, at the time this list was prepared, Mr. Terrell's residence was not in this county.

**THOMPSON:** B.F.; Benjamin Franklin Thompson was a son of Josiah & Louey (Tibbets) Thompson; Josiah was b. in OH; Mrs. Thompson in ME; the family moved to Adams Co. IL from OH in 1830; Benj. And Mary Walker were married on Apr 2, 1862, and lived in Adams Co. IL for a few years after marriage; they moved to Tennessee, IL in 1856, B.F. went to CA and stayed a few months; his physical description appears on page 494, Clarke's History of McDonough County; five feet eight inches in height, light wavy hair, bearded, blue eyes, and a well developed head. (Obit, in part, from The Macomb Journal, Jan 26, 1888): "B.F. Thompson of Tennessee died last Sunday .... He was born in Fall Creek Twp. Adams Co. IL on Nov 7, 1835, and was aged 53 years. He attended college for one year at Quincy College and for awhile at Abingdon, and then he was a schoolteacher for 9 years. In 1862, he married Miss Mary S. Walker of Hills Grove, and they had 5 children, 2 of whom survive along with the wife ...."

Mary S. (1838-1927), wife of B.F.; daughter of Andrew J. and Elizabeth C. Walker.

**TWITCHELL:** William (1861-1948); farmed on section 29, Bethel Twp.

**WADDILL:** William Michael (1866-1952), John Wesley (1863-1941), and James Milton (1861-1939) were sons of Charles W. and Nancy (Lawyer) Waddill. The parents were married in this county in May, 1860; lived in Tennessee Twp.; the father, Chas., was a son of John & Elizabeth (Roiston) Waddill; the mother, Nancy, was a daughter of Michael & Sarah (Parker) Lawyer. Both Chas. & Nancy died in this county & were buried at King Cemetery with various members of the Waddill families.

Ida E. (1864-1934), wife of James Milton Waddill; daughter of John M. Mourning; Ida Ellen Mourning was raised by her uncle & aunt, Lewis B. & Lucinda (Keithley) Mourning in Tennessee Twp.

**WALKER:** Andrew J. (1803-1864) and Elizabeth C. (1815-1864); early settlers of Tennessee Twp.; both died of diphtheria during the same week of February, 1864. Mr. Walker appears as #850 on the 1840 county tax list; he owned \$80 worth of horses; \$44 cattle; \$20 clocks & watches; \$40 wagons; and \$60 in other property; taxes were \$1.22.



**WINDOW:** Louise (1849-1939), wife of W.H.; b. in Hancock Co. IL; daughter of B.D. & Amolia C. (Thompson) Ruddell. [\[First name of Louise's mother Amolia difficult to read\]](#)

**Notes, Corrections, Additions, and Changes**

## HUTCHINSON CEMETERY

Location: Tennessee Township, SW¼, section 35; two and one half miles south Tennessee. [Cemetery at bend in road 400E at 650N: 40° 22' 32" N: 90° 49' 43"W](#)

Remarks: This cemetery, established as a family graveyard in the 1830's, is entirely fenced and is regularly maintained. For the most part, the stones are in good condition, however, a number of the older monuments were found to be broken and/or badly weather worn.

---

Road N 650

---

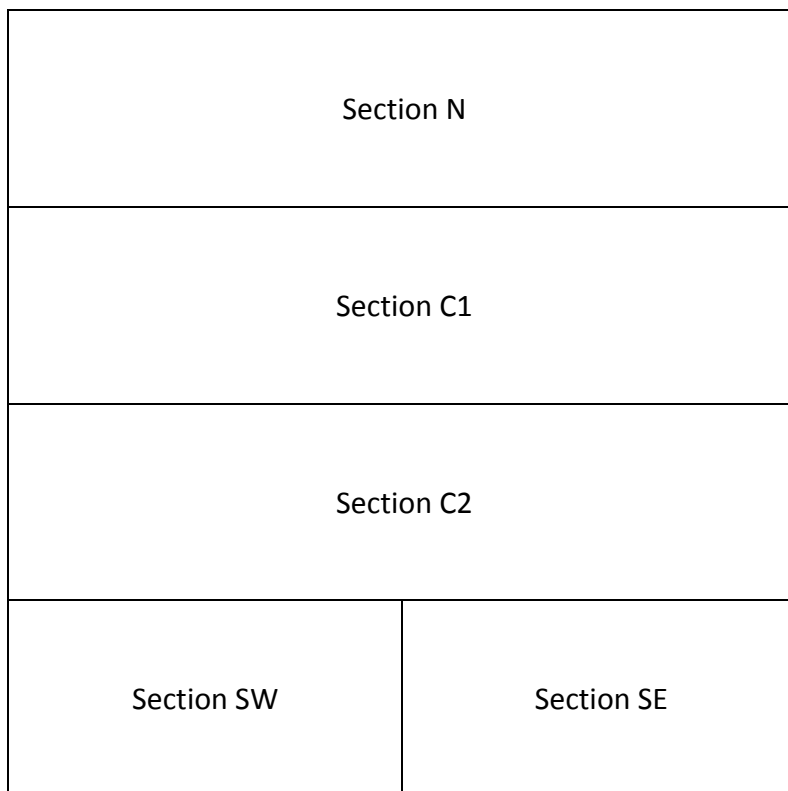

AIKEN:

John; 1835 – 1912. (SW)  
Martha S., wife of John; 1834 – 1917. (SW)

ALLISON:

Caleb R.; 1887 – 1967. (C1)  
Mamie R.; 1890 – 1931. (C1)  
Charles F.; USNR WWII; May 27, 1921 – Apr 10, 1951. (C1)  
May; 1868 – 1959. (C1)  
Charles; 1865 – 1957. (C1)  
Wiilber; 1895 – 1903. (C1)  
Emma; Oct 2, 1902. (C1)

ARRISON:

Joseph E., son of S.R. & H.L.; d. Jul 30, 1863; age 1y 6m 11d. (SE)  
S.R.; d. Nov 2, 1863; age 31y 6m 7d. (SE)  
John, son of S.R. & H.L.; d. Jul 10, 1863; age 5y 2d. (SE)

BARBER:

Robert; b. in Lexington, KY, May 22, 1822; and d. Nov 17, 1901. (SW)  
Mary Stevens, wife of Robt.; b. in IN, Jul 28, 1829; d. Dec 23, 1901. (SW)

BEVAN:

Phamy; b. May 6, 1795; d. ----- (SE)

BLOOM:

William Lloyd; 1900 – 1963. (N)

BLOYD:

William, son of E. & G.; d. Oct 7, 1860; age 19y 2m 7d. (SE)  
Roselie A., dau of W.W. & E.; d. Sep 13, 1857; age 6m 3d. (SE)

BOYLE:

William T. & Sarah A.; (no dates). (C2)

BREEDEN:

Richard G.; 1860 – 1897. (SE)  
Grace Gilchrist, wife of Richard; 1865 – 1951. (SE)  
Ralph B., son of R. & G.; 1891 – 1958. (SE)  
Helen, dau of R. & G.; 1893 – 1970. (SE)  
Rev. William; Feb 7, 1815 – Dec 7, 1896. (SW)  
Damaris E., wife of Wm.; Dec 11, 1825 – Jul 15, 1897. (SW)  
Nancy A. Driskell, wife of Wm.; Apr 3, 1819 – Sep 24, 1851.

BUGG:

Sarah Isabel, wife of S.A.; Sep 2, 1852 – Jul 29, 1889. (C2)  
Sharod A.; (no dates); Co I 124<sup>th</sup> IL Inf. (C2)

BUSKE:

Viola M. St. John; Jan 29, 1927 – Dec 1, 1971. (N)

CAREY:

Jackie Lee; Jun 15, 1942. (C1)

CARSON:

Sarah E.; 1860 – 1934. (C2)  
George W.; 1855 – 1934. (C2)  
Gracy E., dau of G.W. & L.; (no dates). (C2)  
Lee; d. Feb 20, 1880; age 49y 11m 18d. (C2)  
Joseph Delta; Oct 3, 1867 – Jul 2, 1956. (C2)  
Elsina, wife of J.D.; Aug 6, 1868 – Sep 11, 1911. (C2)

CLARK:

Sarah; 1871 – 1949. (C1)  
Evelyn; 1920 – 1931. (C1)  
Thomas; 1869 – 1936. (C1)  
Dale; 1893 – 1959. (C1)  
Keith; 1914 – 1972. (C1)  
Charles E.; 1882 – 1957. (SW)  
Thomas M.; 1838 – 1903; Co C 148<sup>th</sup> IL Inf. (SW)  
Sarah A., wife of T.M.; 1856 – 1920. (SW)

CLAYTON:

Ira C., son of J.F. & S.E.; Jun 12, 1891 – Feb 4, 1908. (SW)  
Sarah Ellen (Carson); d. May 15, 1959; age 98 10m 24d. (SW)  
Lucy Ann (Lawyer); 1857 – 1939. (SW)  
Martin C.; 1889 – 1910. (SW)  
Howard J.; 1897 – 1913. (SW)  
James M.; 1856 – 1917. (SW)  
Alonzo N.; 1860 – 1911. (SW)  
Sarah. E. (Lawyer), wife of Alonzo; 1860 – 1933. (SW)  
Lawrence B.; Apr 5, 1887 – Jul 17, 1904. (SW)  
Martin Earl, son of Alonzo & Elizabeth; d. Aug 29, 1896; age 11y 1m 29d. (SW)

COPELAN:

Clarence; 1888 – 1931. (C1)  
Walter; 1882 – 1972. (C1)  
Rosa; 1894 – 1946. (C1)  
John Jasper; Oct 12, 1853 – Mar 23, 1939. (C2)  
Carrie E., wife of J.J.; Oct 9, 1853 – Aug 17, 1921. (C2)  
Della L., dau of J. & C.; Dec 3, 1886 – Nov 4, 1906. (C2)  
Vern J.; 1924 – 1925. (C2)  
Lyle; Jul 28, 1929. (C2)

COZIAR:

William B., son of W. & E.; d. Sep 9, 1959; age 10m 11d. (SE)  
George; 1824 – 1857. (SE)  
John, Mary E., William A., & Susanna; (no dates). (SE)

CRAMBLET:

Faustine; 1909 – 1973. (C2)

CRAWFORD:

Edna Hills; (no dates); C1)

DAUGHERTY:

William; Feb 16, 1838 – Dec 1, 1901; Co K 89<sup>th</sup> OH Inf. (C2)  
Margaret, wife of Wm.; Aug 27, 1848 – (no date). (C2)

DEMOSS:

Arminda; Jul 28, 1834 – Jan 13, 1914. (SW)

DIAMOND:

Hugh C.; 1837 – 1906. (C1)  
Malvina Irving; 1844 – 1909. (C1)

DOUGLASS:

Edward H.; 1868 – 1913. (SE)  
Edna B. Lawyer, wife of E.H.; 1876 – (no date). (SE)  
Lewis; Feb 14, 1843 – Feb 16, 1894. (SE)  
John S.; 1814 – 1887. (SE)  
Caroline; wife of John; 1822 – 1907. (SE)

FILBERT:

Mac; 1886 – 1957. (C2)  
V. Oscar; Aug 7, 1879 – Jul 22, 1945. (C2)  
Florence E. Clayton, wife of V.O.; Aug 26, 1882 – Feb 24, 1916. (C2)  
Verner E.; 1871 – 1959. (C2)  
\_\_\_\_\_ “Mother”; 1851 – 1913. (C2)  
\_\_\_\_\_ “Father”; 1843 – 1905. (C2)

GALLAGHER:

Steven Elmer; 1882 – 1955. (C1)  
David Nelson; 1837 – 1905. (C1)  
Mary Prenett; 1856 – 1905. (C1) [middle name could be Pronott]  
Joseph N.; 1880 – 1956. (C1)  
Cora E., wife of J.N.; 1885 – 1927. (C1)  
Garret N., son of J. & C.; 1910 – 1912. (C1)

GROGG:

N.F.; 1876 - 1923. (C2)  
Hattie E.; 1876 – 1960. (C2)

HANKINS:

Augustus; Feb 13, 1824 – Jan 31, 1898. (SW)  
Rebecca Moore, wife of A.; Feb 23, 1842 – Nov 12, 1910. (SW)

HEIKES:

Sophia P.; 1840 – 1906. (C2)  
Edward G.; 1833 – 1901. (C2)

HILLS:

John Z.; 1875 – 1942. (C1)  
Ralph E.; 1921 – 1933. (C1)  
William H.; 1882 – 1966. (C1)

HODGES:

Willard; 1886 – 1972. (N)

HOUCK:

William B.; 1849 – 1918. (C2)  
Margaret Ruth, dau of W.M. & M.; Mar 1, 1893 – Mar 11, 1895. (C2)  
Margaret H.; 1850 – 1928. (C2)  
William Bush; 1890 – 1944. (C2)  
L. Grace; 1878 – 1964. (C2)  
Katharine; 1875 – 19--. (C2)

HUDDLESTON:

Harvie S.; Aug 22, 1871 – Apr 28, 1900. (SW)  
Sarah A.; Mar 4, 1860 – Jul 22, 1904. (SW)  
William R., son of R.F. & H.A.; d. Apr 8, 1891; age 25y 26d. (SW)  
Richard F.; Mar 15, 1828 – Jun 3, 1901. (SW)  
Harriet A., wife of R.F.; Dec 12, 1830 – Oct 14, 1916. (SW)

HUGHBANKS:

George; 1851 – 1933. (SE)  
Martha; 1849 – 1927. (SE)  
Bruce Elmer; 1891 – 1918; died in service of his country.  
Ora G.; 1890. (SE)  
Ella, dau of M. & G.W.; d. May 1, 187-; age 1y 11m 22d. (SE)  
Elender, wife of John; May 11, 1811 – Nov 27, 1882. (SE)  
Ivan W.; 1883 – 1954. (SW)  
-----; Jun 1, 1909 – Feb 2, 1916. (SW)

HUTCHINSON:

May, dau of A.M. & M.E.; d. Jan 1, 1874; age 1y 2m 21d. (C2)  
William; Aug 25, 1817 – Nov 18, 1896. (SE)  
William A.; (no dates); Co A IL Inf. (SE)  
Rebecca L. Hallett; May 3, 1826 – Aug 21, 1890. (SE)  
Emma E., dau of W. & M.M.; Jun 23, 1844 – Apr 11, 1863. (SE)

JACKSON:

Almira, wife of Wm.; Nov 20, 1801 – Nov 18, 1893; age 91 11m 28d. (C2)

JARVIS:

Howard; 1890 – 1969. (C1)  
Gail T.; 1900 – 1918. (SE)  
Bessie B.; 1893 – 1901. (SE)  
Frances; 1860 – 1945. (SE)  
Abigh; 1855 – 1946. (SE)  
James; 1843 – 1926; Co C 16<sup>th</sup> IL Inf. (SE)  
Ada; 1861 – 1937. (SE)  
John; d. Jan 8, 1846; age ----- (SE)  
Michael; d. Oct 30, 1848; age 36y 1m 1d. (SE)  
Max Duane; Dec 30, 1934. (SE)  
James L.; Dec 29 – 30, 1910. (SE)  
Permelia; 1810 – 1907. (SW)  
James; d. Jan 28, 1888; age 75y 5m 27d. (SW)  
Andrew W.; d. Jan 3, 1891; age 22y 5m 6d. (SW)  
Edward; 1825 – 1904. (SW)  
Elizabeth, wife of E.; 1833 – 1878. (SW)  
Walter, son of E. & E.; 1871 – 1873. (SW)  
Ephraim; Oct 14, 1827 – May 10, 1899. (SW)

JENKINS:

James; Feb 12, 1829 – Feb 16, 1908. (C2)  
Elizabeth E. Horrell; Nov 5, 1828 – Jan 30, 1910. (C2)  
James H.; 1866 – 1937. (C2)  
Ida L.; 1866 – 1940. (C2)  
Nancy E.; 1861 – 1952. (C2)  
William; Feb 5, 1826 – Jul 17, 1902. (C2)  
Frances T.; Oct 17, 1831 – Jan 23, 1906. (c2)  
Harry James, son of L.F. & Sophia; Apr 29, 1893 – Jul 11, 1896. (C2)  
E. Mary, dau of G.H. & A.E.; Oct 25, 1902 – Dec 17, 1902.  
Nancy J.; Nov 14, 1832 – Sep 14, 1901. (C2)  
David; Mar 29, 1801 – Apr 22, 1886. (C2)

JOHNSON:

Corydon; 1832 – 1891. (C1)  
Jane E.; 1836 – 1926. (C1)  
Calvin E.; 1860 – 1925. (C1)

KEPPLE:

Hellen, wife of Charley W.; Mar 13, 1872 – Apr 11, 1900. (SE)

LAWYER:

Fred B.; Feb 14, 1900 – May 7, 1966; Cpl Medical Dep WWI. (N)  
Ralph; d. Jan 7, 1975; age 78y 1m 14d. (N)  
Thomas B.; Jul 17, 1844 – Sep 5, 1914. (C2)  
Nancy E. Wear, wife of Thos.; Sep 20, 1847 – Feb 8, 1903. (C2)

LAWYER (cont'd):

Rex B.; d. Feb 24, 1893; age 1y 2m 14d. (C2)  
William S.; Jan 12, 1868 – Mar 12, 1962. (C2)  
Ella M. Windsor, wife of Wm.; Nov 7, 1871 – Mar 16, 1908.  
Infant dau of W.B. & M.E.; Jul 9, 1891. (C2)  
Hubert A.; 1897 – 1965. (C2)  
John C.; 1884 – 1969. (C2)  
Bess D.; wife of John; 1888 – 1963. (C2)  
Frankie, son of Amos & Carrie; d. Aug 6, 1888; age 1y 10m 12d. (C2)  
John; Sep 17, 1827 – May 19, 1913. (C2)  
Rebecca J. Jackson, wife of John; Mar 15, 1834 – Dec 5, 1925. (C2)  
Carrie F.; 1862 – 1948. (C2)  
Amos M.; 1861 – 1915. (C2)

LEWIS:

Lucy E.; d. Dec 18, 1895; age 37y 1m 9d. (C2)  
Daniel; 1842 – 1920. (C2)  
Martha E., wife of D.; d. Nov 8, 1894; age 49y 6m 1d. (C2)  
Albert W.; 1886 – 1953. (C2)

LOGAN:

Frank; 1910 – 1970. (N)  
Freda; 1908 – 1969. (N)  
Minerva; 1868 – 1919. (SW)  
John; 1859 – 1944. (SW)  
Gerald E., son of J. & M.; 1907 – 1907. (SW)  
Catherine, dau of J. & M.; 1905 – 1969. (SW)  
Ava Lillian, dau of Catherine; 1925 – 1929. (SW)  
Genan Lynn; Jan 15, 1950 – Mar 15, 1967. (SW)  
Glenda Ann; Jan 15, 1950 – Feb 13, 1950. (SW)  
Edna LaVerne; Jul 17, 1917 – Jan 16, 1926. (SW)  
Gregory Kent; Jan 22, 1947 – Jul 26, 1949. (SW)  
Cecil M.; Nov 12, 1918 – Apr 20, 1967; 1<sup>st</sup> Lt Co K 414<sup>th</sup> Inf 104<sup>th</sup> Div WWII. (SW)  
Edna May; 1893 – 1956. (SW)  
Lee Mark; 1891 – 1972. (SW)

LOWDERMAN:

John; 1831 -1903. (SE)  
Juliett, wife of John; 1838 – 1915. (SE)  
Charlotte Ann Perkins, wife of John; Mar 4, 1821 – Jul 28, 1878. (SE)  
Gertrude, infant dau of J. & J.; Feb 26, 1882 – Mar 6, 1882.  
Charles H.; 1857 – 1928. (SE)  
Mary, wife of Chas.; 1861 – 1910. (SE)  
Claudie, son of C. & M.; 1894 – 1896. (SE)  
John A.; d. Mar 29, 1892; age 27y 10d. (SE)

LYON:

Minnie M.; Jan 25, 1869 – Apr 24, 1995. (SE)  
A.C.; Mar 11m 1864 – Jan 7, 1891. (SE)  
Eva; Apr 29, 1873 – Feb 13, 1891. (SE)

MAJOR:

Benjamin; 1863 – 1927. (C2)  
Sarah A.; 1868 – 1923. (C2)

MANLOVE:

Beulah Fern, dau of J.E. & A.M.; Apr 28-29, 1901. (C1)

MARSHALL:

Ella; 1884 – 1921. (C2)

MARTIN:

Myrtle; d. 1867; age 83y 7m 4d. (SE)

MATTLOCKS:

Lewis J.; Jun 23, 1838 – Mar 20, 1906. (SE)

Emma; Jan 2, 1854 – May 25, 1897. (SE)

MC DANIEL:

Bessie C., dau of G.H. & E.; d. Aug 16, 1882; age 1y 11m 8d. (SE)

MC DONOUGH:

Nora Hankins; 1875 – 1949. (SW)

MILLER:

John; 1858 – 1948. (C1)

Charles A.; 1882 – 1970. (C2)

Asa; 1877 – 1967. (C2)

Anna H.; 1874 – 1925. (C2)

Donald; 1905. (C2)

William; 1830 – 1908. (C2)

Hester J.; 1843 – 1933. (C2)

Fannie; 1867 – 1904. (C2)

Laura; 1872 – 1897. (C2)

Effie; 1874 – 1959. (C2)

Charlie; 1861 – 1948. (SW)

Almira; 1865 – 1933. (SW)

Infant dau of C. & M.; b. & d. Nov 16, 1890. (SW)

MOURNING:

Cora; 1869 – 1961. (C2)

Eugene; 1869 – 1952. (C2)

Flossie; 1908 – 1910. (C2)

Babies; (no names nor dates). (C2)

NEWLAND:

Abraham; 1836 – 1919; Capt Co D 124<sup>th</sup> IL Inf. (C2)

Annie Mussen, wife of A.; 1843 – 1915. (C2)

Ethel A., dau of A. & A.; 1885 – 1889. (C2)

Abram, son of A. & A.; 1877 – 1904. (C2)

Grace E.; 1874 – 1951. (C2)

George A.; 1873 – 1906. (C2)

Etta, wife of Rev. T.E.; d. Apr 19, 1895; age 25y 3m 20d. (SW)

PERKINS:

Henry B.; Nov 28, 1798 – Jan 11, 1866. (SE)

PITTMAN:

Henry C.; (no dates); Co D 124<sup>th</sup> IL Inf. (SW)

POST:

Henry N.; 1851 – 1926. (SE)

Amanda Breeden, wife of Henry; 1854 – 1922. (SE)

ROBERTS:

Clara; (no dates). (SE)



**SMITH:**

Louiiis A.; d. Jul 5, 1897; age 30y 11m 20d. (C2)  
John T.; Jan 10, 1826 – Oct 13, 1903. (C2)  
Nancy J., wife of John; Oct 4, 1837 – Jul 22, 1901. (C2)

**STEPHENSON:**

J.V.; Feb 22, 1838 – Jun 9, 1901. (C1)

**ST JOHN:**

John L.; Mar 17, 1920 – Jun 1, 1965; Cpl 3505<sup>th</sup> Base Unit AAF WWII. (N)

**TWADDLE:**

George O.; Apr 17, 1874 – Nov 16, 1894. (C2)  
Seine C.; Dec 10, 1867 – Jul 19, 1898. (C2)

**VAN FLEET:**

Myrtle E.; 1890 – 1931. (C!)  
George H.; 1890 – 1941; Pvt 25<sup>th</sup> Bn US Guards. (C1)  
G.H. "Jackie", son of G. & M.; 1929 – 1936. (C1)

**WADDILL:**

Mary A., wife of C.W.; d. Aug 14, 1892; age 40y 10m 19d. (SE)  
Charles W.; d. -----; age 51y 6m 21d. (SE)

**WATTS:**

Bertha; 1888 – 1889. (C2)  
Emma I.; 1862 – 1941. (C2)  
Robert N.; 1861 – 1937. (C2)  
Lawrence; d. Jul 25, 1937; Pvt Coast Arty Corps. (C2)  
Ellsworth N.; Jan 25, 1891 – Oct 12, 1950; Pvt 339<sup>th</sup> MG Bn 88<sup>th</sup> Div WWI. (C2)

**WEAR:**

Sarah A., wife of M.D.; Dec 20, 1853 – Mar 24, 1912. (C2)

**WINTERS:**

Infant son of J.A. & A.; d. -----; age -----. (C2)

### **Genealogical Notes – Hutchinson Cemetery**

**AIKEN:** J. W. was a physician in the village of Tennessee; he was b. in OH & moved here in 1865.

**BARBER:** Robert (1822-1901), son of John D. & Mary (Davis) Barber; b. in KY; moved to this county with parents in 1830; lived in Chalmers Twp.; other members of the Barber family included Robert's parents, are buried in the Barber Cemetery in this county.

**BUGG:** Shared A.; enlisted in Emmet Twp., Aug 12, 1862; wounded while in service; muster out Aug 15, 1865.

**CLARK:** Thomas (1838-1903); b. in OH; moved to IL in 1863 from Adair Co. MO; lived on section 1, Lamoine Twp.

**CLAYTON:** Lawrence B. (1887-1904); b. in IL; employed as a telegrapher. (Death notice, in part, from The Macomb Semi-Weekly, Jul 22, 1904): "Lawrence Clayton, son of Mr. & Mrs. Lou Clayton of Colmar, who in company with several other boys went to Crooked Creek, bathing Sunday afternoon and was drowned..."

**COPELAN:** Della L. (1886-1906); b. Fulton Co. IL; died in Tennessee Twp. this county

**DOUGLASS (DOUGLAS):** John S. (1814-1887); b. Frederick Co. MD; b. Jun 3, 1814; son of Sam'l & Rebecca (Young) Douglas; Sam'l killed by a falling log in OH in 1829; Rebecca d. at age 92 in 1878; the Douglas family moved to OH in 1826, Belmont Co.; moved to this area in 1854 & lived in Vermont, IL for a short while; then John moved to this county & opened a mercantile business in Tennessee; moved to a farm on section 34, Tennessee Twp. in 1872; md. in OH on Jan 20, 1842, to Caroline Bevan, daughter of Lewis Bevan; John & Caroline had 9 children: Lewis; Stacy B.; Martha A. (Mrs. Michael Doran); Ellen (Mrs. G.H. McDaniel); William R.; Elmer E.; Minnie L.; and Eddie O.

Caroline (1822-1907), wife of John; b. in OH; daughter of Mr. & Mrs. Lewis Bevan; died at Tennessee, IL Sep 16, 1907, age 84y 10m 16d.

Lewis (1843-1894), son of John & Caroline; enlisted at Tennessee on Nov 23, 1861; reenlisted as a veteran; mustered out on Jul 11, 1865; served as a private with Co A 64<sup>th</sup> IL Inf; md. Josie Bales and lived a few years in Des Moines, IA.

**FILBERT:** -----"Father" (1843-1905). This was Osker Filbert who died on May 16, 1905 at age 62y 10m 5d. He was born in PA and farmed in this county.

Florence E. (1882-1916) (Obit, in part, from The Macomb Daily Journal, Feb 29, 1916): "Mrs. Oscar Filbert died at her late residence south of Tennessee, February 25, cause of death being complications with which she had suffered about four months. Her age was 33 years, 5 months, 29 days..... Florence E. Clayton was born near Colchester, Aug 26, 1882, and was a daughter of Franklin & Ella Clayton .... Married to Oscar Filbert on Feb 8, 1905. To this union were born the following children: Geneva; Lester; Virgil; Clayton; Meredith; and Nellie. Besides her husband and children and father and mother, she leaves two sisters, Mrs. A.G. Copeland, Miss Mary, and a brother, Sherman, all of Colchester....."

**GALLAHER:** David Nelson (1837-1905) was b. in Wheeling, VA (WV); moved to this county & farmed here; d. at Colchester on Feb 15, 1905, at age 67y 6m 9d.

Mary (1856-1905) died at Colchester on Nov 5, 1905; maiden (or former) name was Mary Ann Milstread; b. at Palmyra, MO; d. at age 48y 10m 15d.

**HOUCK:** William B. (1849-1918); according to VA records, he was a Civil War veteran, having served with a PA Inf. unit

**HUDDLESTON:** Sarah A. (1860-1904) was born in Hancock Co., IL and died in Lamoine Twp., this county, of spinal meningitis; court records indicate she was never married.

**HUTCHINSON:** William (1817-1896); b. in Windsor Co. VT; a son of Ebenezer & Mary Hutchinson; md. in VT Jan 23, 1843, to Miss Hallett; moved to this county, 1860; lived on section 35, Colchester Twp.

William A. enlisted at Tennessee, IL on Dec 4, 1861; served as a private with Co A 57<sup>th</sup> IL Inf till discharged of a disability on Sep 17, 1862.

**JARVIS:** James (1812-1888); b. Madison Co. KY Aug 1, 1812; son of Wm. & Mary (Hale) Jarvis; James moved with the family to Edgar Co. IL in 1829; William died there in 1843 at age 63; Mary also died there in 1844, aged 56; James moved to this county in 1839; settled in Hire Twp; there till 1845; moved to section 34 Tennessee Twp; md. in Edgar Co. IL to Permelia Driscoll; James & Permelia had 9 children: John M.; Henry M.; James E.; Samuel M.; Joseph M.; Nancy A.; Isaac S.; William H.; Garrett J.D. Sons, William, John, Garret, & Henry served during the Civil War. Garret was killed in 1865. James also served with Co C 16<sup>th</sup> IL Inf during that war, as a guard. James Jarvis obit, in part, from The Macomb Journal, Feb 2, 1888: " James Jarvis died at his late home in Tennessee last Saturday aged 75 years 6 months 27 days. He was born in Madison Co. KY in 1812. ....married Permelia Driscoll on Apr 25, 1832 in Edgar Co. IL; they had 9 children, 5 of whom are dead. The survivors are John M. of near Cowley, KA; Henry M., recently of Tennessee, but now a banker in Kansas; James K. of Winfield, KA; and Samuel M. of Kansas City, MO who went to Kansas 8 years ago. Two of his sons died in the Civil War and Mr. Jarvis himself was a veteran .....He is also survived by his widow."

Permelia (1810-1907), wife of James; daughter of Joseph M. & Nancy Ann (Riley) Driscoll; b. Mercer Co. KY; Joseph, a native of KY; Nancy from NC; Joseph & Nancy were md. in Mercer Co. KY and lived there 10 years; Joseph was a boatman, and died in New Orleans in 1839; Nancy Ann (Riley) Driscoll died in this county in 1850.

Ephraim (1827-1899); b. Madison Co. KY Oct 14, 1827; son of Wm. & Mary (Hale) Jarvis, and a brother to James; moved to this county in 1836 with other members of the family; md. May 1, 1851, to Catherine Lawyer, a daughter of Wm. & Catherine (Emerick) Lawyer; she was a native of Fayette Co. OH & moved to this county in 1836; her parents later moved to Appanoose Co. IA. Mrs. Lawyer died there in 1874, at age 74 years; buried at Seymour, IA. Mr. Lawyer died Apr 8, 1883 at Orient, IA.

Michael (1812-1848) was a twin brother of James.

Edward (1825-1904), b. Knox Co. IN Jul 11, 1825; son of John & Martha (Bloyd) Jarvis; moved to this county about 1841; md. here Sep 5, 1849, to Elizabeth Royce; they had the following children: Martha Jane; Minerva; John F.; William A.; Levi Jackson, Ida A.; Walter; and Edward Taylor. After Elizabeth's death in 1878, Edward md. Charlotte Jane Dudley on Apr 3, 1879; they had 3 children: Octavia; Uriah; & Jonathan O. Edward's second wife was a daughter of Chas. & Rebecca A. (Patty) Nichols; she had been md. to John Dudley and had lived in Schuyler Co. IL; Mr. Dudley drowned there in 1865.

Elizabeth (1833-1879), first wife of Edward; daughter of Frank Royce, native of TN.

John (d. 1846); native of VA; moved to this county about 1840. He appears on the 1840 county tax list as #712; he owned \$30 worth of horses, \$85 cattle, \$10 clocks & watches, \$86 in other property; taxes were \$1.16.

**JENKINS:** David (1801-1886) appears on the 1840 county tax list as #716; he owned \$60 worth of horses, \$25 cattle, \$10 clocks & watches, \$36 in other property; total taxes were \$.66. His death notice appears in The Macomb Journal, Apr 29, 1886: "David Jenkins, an old resident of McDonough County, died at his home in Lamoine township recently. He settled in this county in 1832 and was aged over 80 years he died."

**LAWYER:** John (1827-1913); b. Fayette Co. OH; son of Michael & Sarah (Parker) Lawyer; moved with parents to this county in 1837; md. Rebecca J. Jackson on Nov 10, 1850; had 4 children: William B.; Sarah A.; Amos M.; and Sind.

Rebecca (1834-1925), wife of John; daughter of Wm. & Almira (Hills) Jackson; moved here with parents in 1843 & lived in Lamoine Twp.; Wm. died in 1842; widow & children then moved to this county; Almira later lived with John & Rebecca Lawyer

**LOGAN:** John (1859-1944); b. Henderson Co. IL; moved to this county in 1900; farmed on section 35, Tennessee Twp.

**LOWDERMAN:** John (1831-1903) (Death notice, in part, from The Bardolph News, Aug 5, 1903): "John Louderman, a prominent resident of Tennessee, committed suicide on last Wednesday afternoon by hanging himself to a rafter in his barn ..... he was 72 years of age and had been a resident of Illinois for 44 years, living most of the time in Tennessee. He carried insurance in the A.O.U.W. order." Mr. Lowderman was born in OH and moved to this county in 1855; he lived on section 27, Tennessee Twp.

**MATTLOCKS:** Lewis James (1838-1906); according to IL VA records, was a Civil War veteran.

Emma (1854-1897); born in IA; died in this county during child birth.

**MC DANIEL:** Bessie C. (1880-1882), a daughter of G.H. & Ellen (Douglas) McDaniel; this family lived in Bethel Twp.

**MILLER:** William (1830-1908); born at Summit Co OH Aug 28, 1830; son of Chas. & Sallie (Bryan) Miller; Chas. was b. in CT; Sallie, a native of Ireland; Wm. was the 7<sup>th</sup> of a family of 10 children: the Miller family moved to Bethel Twp., this county, about 1854; Wm. md. Hester Jane McClure on Jun 27, 1858; they had 10 children: James H.; Charles; Annie (Mrs. F.K. Williams); Robert' Mary F. (Mrs. Martin Laughlin); George W.; Laura F.; Wealthy; Asa; and Francis Edwin. Mr. William Miller died on Apr 5, 1908, of Brights disease.

**NEWLAND:** Abraham (1836-1919); b. Evenwood, County Durham, England; son of Abraham & Sarah (Porter) Newland, both natives of England; the family moved to America in 1853; moved to Colchester in the mid-1850's; Abraham, Jr. was connected with the Colchester coal mines a number of years; he enlisted in 1862, & served as a Captain during the Civil War; received a gunshot wound in the face at Champion Hills & was reported dead; later returned to duty and served till Aug 15, 1865; returned to Colchester & opened a general store in Colchester; ran that till the late 1800's; also was involved with various area coal mines, tile works, and potteries in the Colchester vicinity; in 1859, he married Mary Jane Musson in Colchester; she died Jun 15, 1871, leaving 2 children – Sarah Florence & Thomas E.; Abraham md. again on Jun 18, 1872 to Annie Musson; they had 7 children: Mary O.; George A.; Abraham R.; Gilbert; Haven; Henry Woolsley; & Ethel A.

**PITTMAN:** Henry C.; Illinois VA records indicate his date of death as Aug 30, 1921.

**POST:** Henry N. (1851-1926); moved to this county in 1855; farmed on section 27, Tennessee Twp.

**TWADDLE:** Seine C. (1867-1898) (Obit, in part, from The Macomb By-Stander; Jul 20, 1898): "Marsicino Twaddle died at his late home on E. Jackson St. in Macomb Tuesday evening about 5 o'clock, death being caused by blood poisoning, the result of the breaking of an internal abscess with which deceased had been afflicted since his recent spell of malarial fever ..... Deceased was born at Centralia, Washington County, Dec 10, 1868. While still a small boy he came with his father's family to a farm south of Colchester, where he lived till 1891. Sep 7<sup>th</sup> of that year he was united in marriage with Miss Eva Bugg of Sciota, and moved to Macomb ..... he worked at his trade of carpentering ..... survived by his wife and two children, a boy and a girl, his father, five brothers and four sisters."

### **Notes, Corrections, Additions, and Changes**

## KING CEMETERY

Location: Lamoine Township, SW¼, section 4; about three miles northeast of Colmar. Cemetery ½ mile south of N650 Rd, ½ mile east E200 St; 40° 21' 49" N: 90° 51' 34" W

Remarks: This old cemetery was established in the mid-1830's as a family graveyard and was later used as a burial place by the general public. The grounds are situated on privately owned farm ground. The area is completely fenced, however, the overall condition is not good due to overgrowth of weeds and brush. Most stones are standing upright; many are badly weather-worn; a few were located under several inches of sod and dead leaves. This graveyard is also known as the Tabler Cemetery.

### BADGER:

Edmund; d. Oct 26, 1846; age 68y.  
Daniel; Jan 13, 1832 – Dec 13, 1881.  
David C.; Dec 25, 1822 – Feb 1, 1897.  
Sarah Ann, wife of David; Dec 11, 1839 – Jan 13, 1903.  
Howard C.; Sep 24, 1877 – Dec 29, 1903.  
Edmund H.; Feb 22, 1868 – Jul 31, 1894.

### BAYLES:

Ellen, dau of S.E. & P.; d. Feb 26, 18?64?; age 6y 9m 2d.  
Sarah E. Porter, wife of David P.; d. Jan 26, 1?2?; age 64y 3m 28d.

### BRENT:

James M.; Oct 21, 1821 – Aug 13, 1880.  
Marget, wife of J.M.; May 13, 1820 – Sep 18, 1879.

### BRICKELL:

Elen R., dau of H.C. & J.E.; d. Oct 16, 1853; age 9m 1d.  
Henry C.; d. Sep 16, 1878; age 53y 5m 1d.  
Jane E., wife of H.C.; d. Jan 4, 1854; age 24y 4m 4d.

### BROADHEAD:

Lenora A., wife of Sam'l; 1867 – 1897.  
Richard, son of T. & S.; d. Jan 1, 1871; age 31y 2m 23d.  
Infant of J.T. & S.A.; Feb 19-20, 1879.  
Musette, dau of J.T. & S.A.; Aug 23, 1876 – Oct 19, 1881.  
James T.; 1838 – 1919.  
Susan A., wife of James; 1842 – 1929.

### BUSHNELL:

Homer; 1845 – 1915; Co I 11<sup>th</sup> IL Cav.  
Martha J., wife of Homer; 1853 – 1914.

### COOK:

Susan, wife of William; Jan 28, 1832 – Dec 21, 1896; age 64y 10m 23d.  
William; Dec 21, 1828 – Oct 10, 1908.

### DOYLE:

Mary C. (See GOODRIDGE).

### DRAIN:

Elizabeth, wife John; d. Jun 13, 1899; age 74y 11m 19d.

DULL:

William M.; Feb 27, 1843 – Sep 6, 1902.  
Margaret, wife of Wm.; Nov 8, 1843 – Feb 23, 1913.  
Elizabeth R., wife of D.B.; d. Feb 5, 1872; age 20y 3m.  
William; Oct 22, 1812 – Oct 21, 1876.

EAKLE:

Gertrude Owen; d. Sep 1, 1904; (no age shown).  
Harvey; 1854 – 1937; buried in Friendship Cemetery.

FULKERSON:

Martha W., dau of J. & E.; d. Jun 10, 1872; age 30y.  
James; d. Jul 1, 1866; age 69y.  
Elizabeth Waddill, wife of James; 1799 – (no date).  
Thomas; (no dates).  
Mary (See LORD).

GOODRIDGE:

Mary C. Doyle, wife of E.F.; 1885 – 1920.  
Francis; 1917.  
Mary Lee; 1909 – 1912.

HANKINS:

Seth; 1892 – 1894.

HOLDEN:

Phebe, wife of J.; d. Oct 15, 1844; age 50y 6m 27d.  
Jonathan; d. Oct 23, 1845; age 49y 5m 16d.

JENKINS:

Willie, son of T. & M.; d. Jun 6, 1872; age 1y 5m 27d.  
Jennie, dau of T. & M.; d. Dec 20, 1874; age 6y 8m 25d.  
Jimmie, son of T. & M.; d. Nov 18, 1875; age 4m 2d.  
Clara Ellen, dau of T. & N.E.; d. Sep 3, 1860; age 5m 22d.  
Nancy E., wife of Thomas; d. ----, 1866; age ?22? y.  
Joseph, son of D. & L.; d. Jul 6, 1865; age 29y 7m 2d; a member of Co G 72<sup>nd</sup> IL Inf.  
Sarah M., dau of D. & N.; d. Feb 21, 1842; age 10y 8m 7d.  
Abraham, son of D. & L.; d. Feb 9, 1842; age 6m 1d.

KING:

James; d. Nov 25, 1845; age 18y 4m.  
Jonathan H., son of T. & M.; d. Jul 28, 1842; age 4y 11m 28d.

LAWYER:

Martha (See MORROW).  
Margaret (See WADDILL).  
Nancy (See WADDILL).

LORD:

Mary Fulkerson, wife of Isaac; 1839 – 1912.  
Isaac; (no dates); buried in Mexico.

MC LAREN:

Mary, wife of R.H.; d. Mar 1, 1877; age 20y 1m.

MORRIS:

Robert; Nov 3, 1803 – Jan 25, 1891.  
Elizabeth, wife of R.; Feb 14, 1815 – Aug 19, 1895.

**MORROW:**

Samuel A., son of M. & S.; d. Feb 18, 1864; age 1m 22d.  
Samuel; d. Apr 12, 1891; age 64y 7d.  
Martha Lawyer, wife of Sam'l; d. Jun 2, 1910; age 79y 4m 18d.  
Ambrose; d. Feb 18, 1861; age 4m 22d.  
Lucy J.; d. Nov 4, 1854; age 7m 4d.  
Samuel; d. Aug 25, 1865; age 7m 9d.  
Ida; d. Jul 26, 1873; age 2y 3m 21d.  
Mary E.; d. Aug 15, 1870; age 1y 7m 22d.

**MOURNING:**

Carrie A.; Jun 16, 1876 – Mar 11, 1901.  
Essie E.; Dec 12, 1883 – Dec 12, 1900.  
William H.; 1849 – 1924.  
Mary A. Porter, wife of Wm.; 1848 – 1907.

**NELSON:**

Susanah, wife of Thomas B.; d. Nov 14, 1851; age 61y.

**OWEN:**

Rev. William; d. Oct 28, 1906.  
Margaret K., wife of Wm.; d. Mar 26, 1908.  
James F.; 1868 – 1954.  
Ada N.; 1857 – 1943.  
W.S.; 1853 – 1932.  
Ambers M.; 1870 – 1949.  
Anna E.; 1855 – 1938.  
Carrie; (no dates).  
Gertrude (See EAKLE).

**PARKER:**

Julia O., dau of J. & O.; d. Oct 4, 1848; age 3y 4d.

**PORTER:**

Allen; d. May 28, 1855; age 45y.  
Susan, wife of Allen; d. Feb 22, 1875; age 64y.  
Sarah E. (See BAYLES).  
Mary A. (See MOURNING).

**ROBINSON:**

Thomas; 1848 – 1912.  
Rebecca C., wife of Thos.; 1851 – 1997.

**SMITH:**

Infant son of I. & R.; d. Oct 11, 1856.  
Mary G., dau of I. & R.; d. Sep 13, 1856; age 1y 21d.

**TABLER:**

Louisa L., wife of T.H.; Jul 8, 1810 – Apr 10, 1876.  
Thomas H., son of T.H. & L.J.; d. Mar 11, 1874; age 22y 10 4d.  
Sarah S.; 1846 – 1917.  
James D. (no dates); Co I 88<sup>th</sup> IL Inf.

**WADDILL:**

James; d. Sep 5, 1836; in his 23<sup>rd</sup> year.  
Thomas; d. Nov 30, 1857; age 49y 8m 20d.  
Mary, dau of J.T. & R.C.; d. Dec 17, 1876; age 4m 11d.  
Lucinda; d. Jan 29, 1864; age 44y.  
Maggie; 1875 – 1876.

WADDILL (Cont'd):

M.E. Dull; 1839 – 1898.  
Wesley H., son of M.L. & J.A.; Nov 19, 1880 – Dec 8, 1881.  
John W., son of J. & E.; d. Jan 22, 1856; age 19y 8m 7d.  
John; d. Jan 9, 1877; age 76y 2m 8d.  
Elizabeth; d. Sep 12, 1844; age 46y.  
Charles W.; Jan 26, 1830 – Jan 29, 1917.  
Nancy Lawyer, wife of Chas.; Aug 28, 1838 – May 23, 1900.  
Benjamin; May 9, 1834 – Jul 10, 1918.  
Margaret Lawyer, wife of Benj.; b. Jul 16, 1840; d. at age 62y 6m 22d.  
Rachel; d. Nov 6, 1871; age 69y 8m 12d.  
Eva Q., dau of G.R. & A.; d. Jan 29, 1875; age 4m.  
Hannah E.; 1854 – 1907.  
Sarah; Jan ---, 1802 – Sep 17, 1876.  
C.W.; d. Apr 9, 1857; age 43y 9m.  
Thomas W.; Aug 27, 1855 – May 10, 1909.  
Louie, wife of T.W.; d. Apr 18, 1891; age 33y 7m 1d.  
Thomas D.; d. Mar 17, 1891; age 2y 4m 21d.  
Lucile; Jan 25, 1891 – Nov 30, 1892.  
M.L.; b. in McDonough Co. IL, Mar 20, 1852; d. Feb 10, 1890.  
Wesley H.; Nov 19, 1835 – Aug 31, 1910.  
Elizabeth (See FULKERSON).

WATTS:

Joseph, Jan 30, 1835 – Aug 31, 1910.  
Barbara Ann, wife of Joseph; Jul 24, 1840 – Apr 4, 1909.

WHELCHER:

Lucritia, wife of B.; d. Jun 16, 1870; age 46y 1m 16d.  
Joanna, dau of B. & L.; d. Feb 10, 1868; age 12y 10d.  
Hellen M.; d. Sep 2, 1872; age 9y 3m 17d.  
George; d. Jan 2, 1865; age 2y 3m 23d.  
(Hellen & Geo.; children of F. & R. Whelcher)

### Genealogical Notes – King Cemetery

**BADGER:** Edmund W. (1788-1846) appears on the 1840 county tax list as #874; he owned \$110 worth of horses, \$55 cattle, \$20 wagons, and \$62 in other property; taxes were \$1.24. Illinois VA records indicate Mr. Badger was a veteran of the War of 1812.

Daniel (1832-1881); Illinois VA records indicate Dan'l to be a veteran of the Civil War. (Death notice, in part, from The Macomb Journal, Dec 22, 1881): "D. Badger, Sr. was buried in the "King's" graveyard, 4 miles from Tennessee. He was 50 years old and his brother died about 3 years ago."

Sarah Ann (1839-1903) (Death notice, in part, from The Macomb Times, Jan 22, 1903): "Mrs. Ann Badger of near Tennessee, being a quiet, patient sufferer for about thirteen years, died at her home ..... funeral at the old home, where she resided with her daughter, Mrs. Dadie Dorothy ..... laid to rest in the King Cemetery."

**BAYLES:** Sarah E. (1837-1902), wife of David P.; her husband was a son of David & Jane (Victor) Bayles; he died while in the army in August, 1863, at Memphis, TN.



**BRENT:** James M. (1821-1880); b. in IN; moved here in 1865 from Knox Co. IL; farmed in section 13, Lamoine

**BRICKELL:** Henry C. (1825-1878); Illinois VA records indicate that Mr. Brickell was a Civil War veteran. He appears on the 1850 federal census in Bainbridge Twp. Schuyler Co. IL; he was a blacksmith; b. in IA; wife, Jane, b. in NY. No children were indicated on this listing; however, noted as living in the Brickell household were; Nancy K. Dale, age 4, b. in MO; and Rachael Murray, age 18, b. in IL.

**BROADHEAD:** James T. (1838 – 1919); b. in Morgan Co IL Aug 28, 1838; son of Wm. & Sarah (Grimsley) Broadhead; Wm. b. in England; Sarah in KY; Wm. d. in Morgan Co in 1844; Sarah then md. John Waddill and moved to this county in 1846; James T. md. Susan A. Vaughn in 1862; they had 10 children: Richard; Sarah J.; Lucy E.; Sam'l; Louie K.; Olive M.; John H.; J.D.; James T.; and Musette.

Susan A. (1842-1929), wife of James T.; daughter of Henry & Jiet (Jones) Vaughn, natives of Culpepper Co VA.

**BUSHNELL:** Homer (1845-1915); enlisted at Blandinsville, IL on Mar 25, 1864; served as a private; mustered out Sep 30, 1865.

**COOK:** Susan (1832-1896), wife of Wm.; daughter of John & Elizabeth (Roisten) Waddill; Susan b. in TN; moved to this county with parents in 1833.

**DULL:** William Malathen (1843-1902); b. in Augusta Co VA; d. in Tennessee, IL of a cerebral hemmorrhage.

William (1815-1876); b. VA; moved here in 1865 from MO; operated a hotel in Tennessee; a daughter, Mary, md. Dan'l B. Waddill.

**EAKLE:** Gertrude Owen (d. 1904); b. IL; d. in Tennessee Twp. at age 40 years.

**FULKERSON:** James (1797-1866); b. in TN, son of John & Elizabeth (King) Fulkerson; parents natives of VA; both died in TN; James moved to IL in 1831; after a year in Jacksonville, moved to this county; settled in Tennessee Twp.; md. in Washington Co TN to Elizabeth H. Waddill; had 7 children: Elizabeth K. (Mrs. Isaac Webb); Charles W.; Margaret K. (Mrs. Wm. Owen); Thomas; Mary A. (Mrs. Isaac Lord); Martha W.; and 2 children that died in infancy. Elizabeth, wife of James, died in Feb 1880. Mr. Fulkerson appears on the 1840 county tax list as #858; he owned 120 acres in section 16, Tennessee Twp.; residence was in the NW¼; also owned \$150 worth of horses, \$54 cattle, \$10 clocks & watches, \$40 wagons, & \$125 in other property; total taxes were \$3.70.

**HOLDEN:** Jonathan (1796-1845); b. in VT; lived in Hamilton Co OH & Park Co IN before moving to this county. Lived a short while during the 1850's in Warren Co IL. A daughter, Martha M., md. Richard Tilton King, in this county. Mr. Holden appears on the 1840 county tax list as #868; he owned \$260 worth of horses, \$100 cattle, \$10 clocks & watches, \$50 wagons, & \$138 in other property; taxes were \$2.70.

Phebe, wife of Jonathan; b. in NJ; maiden name, Rogers.

**JENKINS:** Joseph (1836-1865) enlisted with his brother, Thos., at Colmar on Aug 12, 1862; was a prisoner of war; brother Thos. mustered out with others of the regiment Jul 15, 1865.

Sarah M. (1831-1842); dau of David & Nancy E. Jenkins; David moved to this county in 1832; Nancy died that year; David later remarried & lived in Kansas several years; returned to this county & died here in 1886; buried at Hutchinson Cemetery.

**LORD:** Mary (1839-1912), wife of Isaac; daughter of James & Elizabeth (Waddill) Fulkerson; b. in this county; md. Mr. Lord; moved to Texas; later returned to this county. (Her obit, in part, from The Macomb Daily Journal, Jan 31, 1912): "Mrs. Mary A. Lord was born in Hills Grove neighborhood, Tennessee Township, McDonough Co, IL, Aug 5, 1839, and d. at her home near Tennessee, IL of pneumonia, Jan 26, 1912. Her parents, James & Elizabeth Fulkerson, were early settlers in Hills Grove ..... She spent a number of years in loving and devoted care of an invalid sister and of her parents in their declining years ..... On Dec 25, 1880, married to Mr. Isaac Lord, a railroad machinist. They made their home in Texas for a number of years. Then he accepted an attractive offer of a position on a railroad in Central America but died a few months after going there. Her parents & her brothers & sisters had preceded her. She is the last to go."

**MORROW:** Martha (1831-1917), wife of Sam'l; daughter of Michael & Sarah (Parker) Lawyer.

Samuel (1827-1891), b. in MO; moved here in 1845, from Morgan Co IL; farmed on section 31, Tennessee Twp.

**MOURNING:** Essie E. (1883-1900) (Death notice, in part, from The Macomb Times, Dec 20, 1900); "Died, at the residence of Wm. Mourning, his daughter, of consumption ....."

**OWEN:** Margaret K. (d. 1908), wife of Rev. Wm.; daughter of James & Elizabeth (Waddill) Fulkerson; b. in this county.

**SMITH:** Mary (1855-1856) & the infant son (d. 1856) were children of Isaac & Rebecca (Lawyer) Smith; Rececca, a dau of Michael & Sarah (Parker) Lawyer; Isaac & Rebecca later moved to Brooks Co. KA.

**TABLER:** James D.; b. in Hancock Co. IL; son of Thos. & Louisa (Owen) Tabler; Thos. b. in VA; Louisa, in OH; James D. md. Sarah Waddill; a son, Harry M., b. in Tennessee Twp. in 1868, later was a school teacher & lawyer in Macomb. Illinois VA records indicate Mr. Tabler's date of death as May 2, 1926.

Sarah S. (1846-1917), wife of James D.; daughter of Chas. Wesley & Mary E. (Lawyer) Waddill; b. in this county.

**WADDILL:** John (1800-1877), b. in Jonesboro, Washington Co. TN; Oct 3, 1800; son of Chas. & Margaret (King) Waddill, natives of TN; the family moved to this county in 1833; lived in Tennessee & Lamoine Twps.; John md. in Washington Co. TN to Elizabeth Roisten; had 7 children: Sarah (Mrs. Thos. Sammons); Margaret (Mrs. Marvin Cook); Rachel (Mrs. Thos. Griffiths); Charles W.; Susan (Mrs. Wm. Cook); Benjamin; & John Wesley. John Waddill appears on the 1840 county tax list as #864; he owned \$80 worth of horses, \$55 cattle, \$10 clocks & watches, \$40 wagons, & \$88 in other property; taxes were \$1.37.

C.W. (1813-1857); Charles Wesley Waddill was b. in Washington Co. TN Jul 16, 1813; son of Chas. & Margaret (King) Waddill; C.W. md. Dec 2, 1845, to Mary E. Lawyer; had 4 children: Sarah S. (Mrs. James D. Tabler); Charles R.; Michael L.; & Thos. Wesley. Mr. Waddill attained the title of Colonel Waddill as a commander of a rifleman's group from Hills Grove, a State Militia unit; Col. Waddill's wife, Mary E., was a sister to Nancy & Margaret, wives of Chas. & Benj. Waddill. Mr. Waddill appears on the 1840 county tax list as #859; he owned 40 acres in the NE¼ of section 16, Tennessee Twp.; also owned \$90 worth of horses, \$120 cattle, \$10 clocks & watches, \$40 wagons, and \$73 in other property; taxes were \$2.27.

Charles W. (1830-1917), son of John & Elizabeth (Roisten) Waddill; b. near Jonesboro, TN; moved to this co. with parents; lived in section 32, Tennessee Twp.; md. in May, 1860, to Nancy Lawyer; had 3 children: James Milton, John Wesley, and Wm. Michael. Illinois VA records indicated Mr. Waddill was a veteran of the Mexican War.

Nancy (1838-1900), wife of Chas. W.; daughter of Michael & Sarah (Parker) Lawyer.

**WADDILL (Cont'd):** Benjamin (1834-1918), a son of John & Elizabeth Waddill; b. in this county; md. in Oct. 1861, to Margaret Lawyer, sister to Nancy Waddill; had 4 children: Caroline; Mary Ann; Emma Jane; & Sarah Ellen. (His obit, in part, from The Macomb Daily Journal, Jul 11, 1918): "Benjamin Waddill died yesterday, Jul 10, at 6:30 p.m., at the home of his daughter, Mrs. Emma Flinn, at Colchester, of general debility, aged 84 years 2 months and 1 day. He was born in this state May 9, 1834, being the son of John & Elizabeth Royston Waddill and married Margaret Lawyer, now deceased ..... following children were born: Mrs. Caroline Brickle, Plymouth; Mrs. Emma Flinn, Colmar; Mrs. Ella Filey, Colmar; and Mrs. O. Vaughn, deceased. He made his home the past eight years with his daughter, Mrs. Flinn, and had been poorly the past two years and bedfast the last six months.... Besides the children named he is survived by the following grandchildren: Frank Brickle & Mrs. Nellie Bushnell; Bonni Vaughn, a grandchild is deceased. Also a great-grandchild, Grant Brice Brickle, survives....."

M.L. (1852-1890); Michael L. was a son of Chas. W. & Mary E. (Lawyer) Waddill; he md. in Jessamine Co. KY Oct 5, 1876, to Jo Hughes, daughter of John M. & L.J. (Morrow) Hughes. Michael & Jo had 3 children: Jennie May; Wesley Hughes; and Sarah Luella.

**WATTS:** Barbara Ann (1840-1909); b. in VA; d. in Tennessee Twp.

**Notes, Corrections, Additions, and Changes**

## RICE CEMETERY Now Known As WHITE FLOCK

Location: Lamoine Township, NW¼, section 11, 3 miles east of Colmar. [40° 21'13.7" N: 90° 49' 47.6"W](#); also known as Jenkins & Lewis

Remarks: The grounds were found to be in fair condition during this survey in early 1975. Many small, unreadable field-stones present here indicate an estimated dozen or more unknown burials. Most stones are badly weather-worn and several have been overturned. Rice Cemetery has also been referred to as Jenkins Cemetery.

### BAYLES:

William T., son of D. & J.; d. Aug 6, 1845; age -----.

Jane Victor, wife of D.; d. Nov 10, 1854; age 53y.

George W., son of P. & J.; d. Jul 31, 1843; age 9m 21d.

Infant son of P. & J.; d. Nov 8, 18--; age 4d.

Joseph H.; (no dates); Co C 59<sup>th</sup> IL Inf.

### BILLINGTON:

Virginia Ussery Sanford; 1870 – 1952.

### DAMRELL:

Ed.; d. Jul 29, 1878; age 62y 6m 18d.

Edw; Native of England; d. Apr 3, 1871; age ?85?y 3m 3d.

Edmund; d. Oct 23, 1875; age 61y 3m 26d.

Agnes, wife of E.; b. Oct 9, 1813; d. at age 73y 5m 22d.

### DUNSWORTH:

Gladys J.; d. Jul 5, 1890; age 7d.

### FRESHWATER:

Sarah A.; d. Oct 22, 1902; age 70y.

### GALLAHER:

Pearl (See SANFORD).

### HATCH:

Joseph N.; d. Aug 14, 1871; age 27y 9d; son of Wm. A. & M.H.

Thomas Ira, son of Susan & David; d. Mar 26, 1890; age ?16?y 6m 11d.

Martha H., wife of Wm.A.; d. May 19, 1855; age -----.

Andrew J., son of Wm. & Martha; d. Dec 28, 1862; age 26y 8m.

Louisa H., dau of W.A. & M.H.; d. Sep 25, 1870; age 30y 4m 4d.

Sarah M., dau of W.A. & M.H.; d. -----; age -----.

### HARVEY:

Ed; 1858 – 1956.

### HOOVER:

Erminia; Jul 26, 1857 – Mar 22, 1881.

### MARVEN:

Sarah Ann, wife of E.L.; d. May 25, 1878; age 25y 4m 29d.

### MINNICK:

Louisa, wife of L.A.; Apr 6, 1847 – Aug 20, 1862.

POLITE:

Robert Oren; Mar 2, 1854 – Apr 27, 1926.  
Anna M.; Apr 17, 1868 – Dec 12, 1902.  
Baby; Mar 1, 1894 – Mar 4, 1894.

RICE:

Alice Woodward, wife of Marcus; Apr 14, 1787 – Oct 3, 1869.  
Marcus; Oct 7, 1785 – Jan 16, 1872.  
Alice (See SANFORD).

ROACH:

J.M.; d. Jan 4, 1900; age 48y 7m 7d.  
Alwilda, wife of J.M.; 1859 – 1909.  
Minnie; 1897 – 1898.  
William K.; 1881 – 1882.  
James A.; 1888 – 1891.

SANFORD:

J.B., son of W.A. & M.; d. Oct 27, 1892; age 3y 10m 25d.  
Maggie A., wife of W.; d. Jun 30, 1873; age 23y 2m 6d.  
Infant of W. & M.A.; d. Jun --, 187?3?.  
Harmon L.; Feb 8, 1884 – Jul 26, 1885.  
Joseph N., son of C. & N.J.; d. Sep 7, 1849; age 1y 3d.  
Mary J., dau of C. & N.J.; d. Aug 2, 1856; age 1y 4m 16d.  
Joel; Nov 21, 1800 – Apr 5, 1888.  
Alice Rice, wife of Joel L.; Oct 6, 1826 – Feb 28, 1911.  
Howard A.; Aug 14, 1889 – May 10, 1914.  
Mary; 1858 – 1938.  
George; 1857 – 1932.  
Nancy J.; Oct 29, 1823 - -----.  
Chancellor; Oct 11, 1827 – Apr 20, 1900.  
Altha A.; 1887 – 1894.  
Adella Irene; 1892 – 1896.  
John Ray; 1895 – 1896.  
William; 1850 – 1933.  
Malinda; 1854 – 1934.  
George Manson; 1876 – 1955.  
Pearl Gallaher; 1884 – 1964.  
Aaron Floyd; Mar 30, 1892 – Jan 7, 1858; PFC Co A 342 Machine Gun Bn WWI.  
Virginia (See BILLINGTON).

STOOKEY:

Dau of B. & H.; d. Jan 6, 1873; age 28y 10m 15d.  
Benamine W., son of B. & H.; d. Jun 28, 1860; age 6m 2d.  
Infant of J.R. & H.J.; d. Apr 24, 1868.  
Helen J.; 1848 – 1939.  
Jacob R.; 1846 – 1926.  
Hannah; Jan 31, 1825 – Feb 19, 1894.  
Benjamin; Mar 29, 1817 – Aug 9, 1901.

TURNER:

Charles C.; (no dates); Co G 85<sup>th</sup> IL Inf.; 82y 6d.  
Louisa V., dau of Chas.; d. Jan 15, 1890; age -----.

UNDERHILL:

Infant of G.W. & L.J.; (no dates).

VICTOR:

Jane (See BAYLES).

WOODWARD:

Alice (See RICE).

**Genealogical Notes --- Rice Cemetery [White Flock]**

**BAYLES:** Jane (1801-1854), wife of David; maiden name was Victor; lived in OH before coming to this county; died at the home of a daughter in 1854. David, husband of Jane, was born in VA; served a number of years in military service & drowned near Troublesome Creek in this county; David & Jane had 16 children including: William T. (d. 1845); Philip V. (d. in Hancock Co.); Minerva E.; Jesse E. (Civil War vet, Co B 3<sup>rd</sup> IA Cav., later lived at Memphis, MO); Joseph H. (see below); David P. (d. in service in 1863); Isaiah O. (CW vet, Co B 118<sup>th</sup> IL Inf., later lived at Jericho, MO); Marion C. (CW vet, d. at Baton Rouge, LA); Silas R. (CW vet, 118<sup>th</sup> IL Inf., later lived in MO); James R. (CW vet, killed at Yazoo Bayou in 1863); two others, a son & daughter, drowned while enroute to Springfield, OH. David, husband of Jane, appears on the 1840 McDonough county tax list as #718; he owned \$160 worth of horses; \$36 cattle; \$5 clocks & watches; \$50 carriages; \$150 wagons; and \$200 in other property; taxes were \$3.01.

Joseph H., son of David & Jane; b. in Champaign Co. OH Feb 2, 1829; moved with parents to this county about 1839; md. in Hancock Co. IL to Julia Parker in 1858; they lived in Lamoine Twp., this county; Julia d. in Oct 1862; Joseph then md. Josephine Smith, 1868; had a daughter, Dora B. Joseph H. served from this county during the Mexican War and at the outbreak of the Civil War, he enlisted as a private and served throughout the war with Co B 16<sup>th</sup> IL Inf, 9<sup>th</sup> MO Inf, and 59<sup>th</sup> IL Inf. He was taken prisoner and was at Libby Prison, Belle Isle, & at Andersonville Prisons; he was nearly blinded during a fire at Andersonville; escaped prison in Dec 1864; wounded a number of times; returned to this county after the war and later travelled extensively in attempts to regain his health & eyesight; he later lived on a Lamoine Twp. farm on section 2. Joseph's second wife, Josephine Smith, was a native of this county, a daughter of Sam'l B. & Sarah Smith.

George W. & the unnamed infant were sons of Philip & Jenimia (Downs) Bales. Mr. & Mrs. Bales were md. in this county on Oct 1, 1840. They later lived in Hancock Co. where Philip died.

**DAMRELL:** Edmund was born in England and moved to this county in 1857, from Peoria, IL; lived in section 3, Lamoine Twp.

**POLITE:** Anna M. (1868-1902) was born in Scott Co. IL; she had suffered from rheumatic fever since age 9 years; died of heart disease in Lamoine Twp.

**RICE:** Marcus (1785-1872) appears on the 1840 county tax list as #721; he owned 320 acres in sections 11 & 15, Lamoine Twp.; residence was in the NW of section 11; he also owned \$100 worth of horses; \$60 cattle, \$15 wagons, and \$54 in other property; total taxes were \$4.55.

**ROACH:** Alwilda (1859-1909), wife of J.M.; born in this state; died on Jul 25, 1909 at Phelps Hospital in Macomb.

**SANFORD:** Joel (1800-1888); born in MA; painter by trade; moved here from Clay Co. MO in 1844; lived on section 11, Lamoine Twp.; he and Alice Rice were married in this county on Dec 31, 1844.

Chancellor (1827-1900) and Nancy Jane Wear (b. 1823) were md. in this county in Nov 1847.

## **Notes, Corrections, Additions, and Changes**

Press Release

Immediate - October 12, 2010

Macomb - Dick Jackson, local historian and genealogist, with his wife Marilyn cosponsored a new sign for the White Flock Cemetery installed by the McDonough County Historical Society. This well maintained cemetery is in the northeast corner of Lamoine Township.

The first burials were in 1839, but the land was not deeded as a cemetery until 1871. There is still an occasional funeral at this beautiful site.

There are two veterans of the Civil War resting here, Charles Turner and Joseph Bayles. Seven of Bayles' 16 siblings served in the Civil War, one killed in action.

Joseph also served in the Mexican War before enlisting in the Union Army from Illinois. He was taken prisoner and incarcerated at Andersonville, where a fire nearly blinded him. He escaped in 1864, and continued to serve even though being wounded several more times.

The White Flock Church was built near the cemetery in about 1866. A fragment of an undated newspaper article attributes the name to Hannah Wilson Stookey, who, with her husband Benjamin, organized the church. "Mrs. Stookey suggested that since all in the community were white with no other color or nationality, and since the people seemed to flock together very well, they should call the church White Flock and . . . establish a Congregational Christian Church."

There are almost 100 pioneer citizens of McDonough County resting in this hilltop cemetery.

The cemetery sign project is supported by the McDonough County Genealogical Society, the McDonough County Highway Department, Niemann's County Market and Pepsi, Richard and Marilyn Jackson, and the McDonough County Historical Society.