

**RURAL  
CEMETERIES  
OF  
McDONOUGH COUNTY, ILLINOIS**

**VOLUME XII  
HIRE - EMMET**

**BY DUANE LESTER  
GOOD HOPE, ILLINOIS**

**PRINTED BY  
SCHUYLER – BROWN  
HISTORICAL AND GENEALOGICAL SOCIETY  
AND  
THE SCHUYLER JAIL MUSEUM**

“A monument is erected  
not because a person died,  
but because a person lived.”

## Volume XII

### Table of Contents

Preface	i – ii
Maps and plats	iii – iv....ix-xiv
McDonough County, Illinois	iii
Areas Covered in Volumes I - XVII	iv
Section 36: Hire Township, T6N R4W, 1871	v
Section 20: Emmet Township, T6N R3W, 1871	vi
Section 16: Emmet Township, T6N R3W, 1871	vii
Section 31: Emmet Township, T6N R3W, 1871	viii
Section 32: Emmet Township, T6N R3W, 1871	ix
Argyle Cemetery	1 - 17
Guy Cemetery	18 - 21
Simmons Cemetery	22 - 25
Atkinson Cemetery	26 - 28
Post-Shippey-Dew Cemetery	29

## Preface

Within the boundaries of McDonough County, Illinois are more than a hundred cemeteries and gravesites ranging in size from a single burial site to the expansive Oakwood Cemetery at Macomb. Within these cemeteries are the remains of an estimated 40,000 individuals who have died since the first settler arrived here over 150 years ago. Graves of countless others are scattered over the countryside of McDonough County; but, exact sites of many of these resting places are no longer known for various reasons. During the early days of this county, there were obviously no central burial grounds; thus, a pioneer family having the misfortune of losing one of its members placed the deceased in a grave on a family homestead and erected a makeshift marker. A number of these family burial grounds later became public cemeteries, however, many of the grave sites soon became "lost". Crude wooden markers or hand engraved stone soon succumbed to the elements and were never replaced; scores of families moved further west after staying in this area only a short time and the gravesites of their loved ones shortly became insignificant mounds of earth; a number of families passing through this vicinity suffered individual losses. A prime example of the latter is contained in a history of Bethel Township. In 1830, four children of an emigrant family died while en route through McDonough County. They were buried near their places of death which occurred about two miles southwest of Fandon. All traces of those graves have long been gone. During the summer of 1834, a widow lady died at her home in northern Tennessee Township. Her coffin of dressed walnut lumber was built by a local cabinet maker and she was buried in the timber near her home. Within a few years, no evidence remained to indicate the presence of her final resting place. A family who created an excellent farm from the prairies a few miles north of Macomb, maintained a fenced family burial site for several years. This cemetery contained the graves of about 12 former family members. During the early 1900's, the farm changed ownership. Shortly thereafter, the new owner removed all the stones, took down the fence and this graveyard became part of a cornfield. These are only three of the countless incidents involving the total disappearance of burial sites. At this time, it is impossible to determine the locations of hundreds of individual's graves in this county.

Vandalism is responsible for the destruction of many grave stones. Countless markers have been partially or totally destroyed. Inscriptions have been obliterated by gunshot blasts, stones have been broken into dozens of pieces, and some markers have been entirely removed from their original locations.

While weather-wear and vandalism accounts for most of the destruction of individual tombstones, neglect is directly responsible for the eventual deterioration of graveyards. Several local cemeteries have had no protective fencing for a number of years and the grounds have become grazing land for livestock. Groundhogs and other burrowing animals have undermined large portions of various cemeteries. Some areas are nearly invisible because of massive growth of weeds and brush. Stones have fallen, broken, and become completely covered with soil and debris.

The overall condition of our county cemeteries is a pathetic case. While some grounds are well maintained, or at least partially kept-up by various families, many have been totally forgotten. This situation is appalling and should never have come about. Apparently, lack of time, expense, and most of all regard has brought about the present-day poor conditions of many of our rural cemeteries.

Genealogical notes accompanying the various cemetery listings were prepared from a wide variety of sources including: Local area history books and atlases; newspaper files; county, state, and federal archives; family histories. These notes were collected at random from readily available sources and little, or no attempts were made to search for material for more complete genealogies. These notes are presented only for the purposes of identification and/or clarification.

Every attempt has been made to present complete and accurate information. Readers will find errors and omissions. Others will not agree with portions of my findings; however, no information contained herein is based solely on assumption or guesswork. It must be remembered that this information has been prepared for use only as a tool for further research and that nothing must be taken as final and absolute.

The larger cemeteries contained in these volumes are accompanied by grave location charts. These charts in no way are intended to represent any professionally prepared plat or survey that may exist. Their preparation and presentation are solely for general location purposes.

When copying inscriptions from grave markers, it is sometimes impossible to read some portions of the engraving. Names, dates, ages, etc. that were found to be unclear or totally missing are indicated by the use of question marks or dashes, i.e., SPICER, James T., infant son of ?J.B. & S.J.?.; d. \_\_\_\_; age \_\_\_\_\_. The letters or numbers enclosed in parenthesis following the inscription, indicated general location as indicated on the accompanying chart.

Abbreviations used are as follows:

b. born	m. months
Cav. Cavalry	md. married
Co. County/Company	sec. section
d. died/days	twp. township
dau. daughter	y. years
Inf. Infantry	

Time and space prohibits proper recognition for all those individuals who gave assistance in preparing and publishing these volumes. Deep and sincere appreciation is extended to all concerned, especially to the following: My parents, Mr. and Mrs. Lloyd Lester, and my wife, Rose; and to Mrs. Lavina Walton and other members of the Schuyler County Historical and Genealogical Society for printing and binding the finished product. Thank you.

Duane Lester

### ADDENDUM

Mr. Lester's Magnum Opus is nothing short of monumental. It is not easy to gain access to many of these historic family burial sites. By the time of Mr. Lester's survey (1970's) numerous plots were long left abandoned, overgrown with trees and weeds and monuments under attack by weather, livestock, vandals, and property owners who did not care about the burial sites of McDonough County's brave pioneers. Thankfully, we now (2012) have laws to protect our county's historical legacy and these final resting gardens.

I am in awe of Mr. Lester for his transcriptions of hard-to-read tombstones and his laborious typing of his 18 Volumes of the Rural Cemeteries of McDonough County. He did not have access to a computer. In addition to transcribing information from tombstones, he had to painstakingly access county records (e.g. 1840 county tax list), federal census records, and local newspapers requiring a great deal of time and effort. As a genealogist in 2012, I have access to the internet with fast access to US Census records, Family Search (records kept by the Church of Jesus Christ of Latter-Day Saints) and numerous other legal documents, books, and family journals. Mr. Lester used an old-fashioned key-strike, ribbon tape typewriter where mistakes were hard to correct and appear as overstrikes. There are very few attesting to his skill as a typist. What an US Census record will not contain are the names and dates of infants who died between census surveys. Mr. Lester's tombstone records give names and dates of children, whose lives were brief, but would otherwise be lost to history without his efforts. Frequently, he provides names of brothers and sisters, fathers and mothers that allows for completion of family group sheets.

Another work of love for those who dared to settle the prairie lands of western Illinois and raise their families is being performed by Dr. A. Gil Belles. He has been able to install signs for each of these rural cemeteries and provide GPS (Global Positioning System) information making it easier for anyone wishing to visit a rural cemetery to help them actually find it. Gil also works closely with Boy Scouts and other civic groups to help cleanup, clear brush and dead trees, locate buried tombstones, and restore stones. My revision of Mr. Lester's document will provide information on all cemetery restoration projects.

Any changes made to Mr. Lester's original work was done in blue color font. His maps were scanned and copied into the text and remain like his original work and are not subject to editing. His text was transcribed using MS Word, enabling me to control font size and color. Retyping text also leaves room for typo errors. Mr. Lester's rare typo errors are corrected but not displayed in blue. This MS Word document allows on-the-fly editing of any "Notes, Corrections, Additions, and Changes" found at the end of every cemetery. This was Mr. Lester's intent to produce a working document and improve accuracy about the information on those buried. I have retyped state abbreviations as they are now used (e.g. IL, instead of Ill.). On 1840 county tax lists I omitted cents (e.g. \$140, instead of \$140.00). The current MS Word font uses less space, thus, placing more text per line. This shrinks his documents and reduces pages. This, then, changes page numbering in each Table of Contents. Cemetery locations are also found on the internet. See: **McDonough County Illinois Cemeteries** <http://graveyards.com/graveyards/IL/McDonough>



McDonough County, Illinois

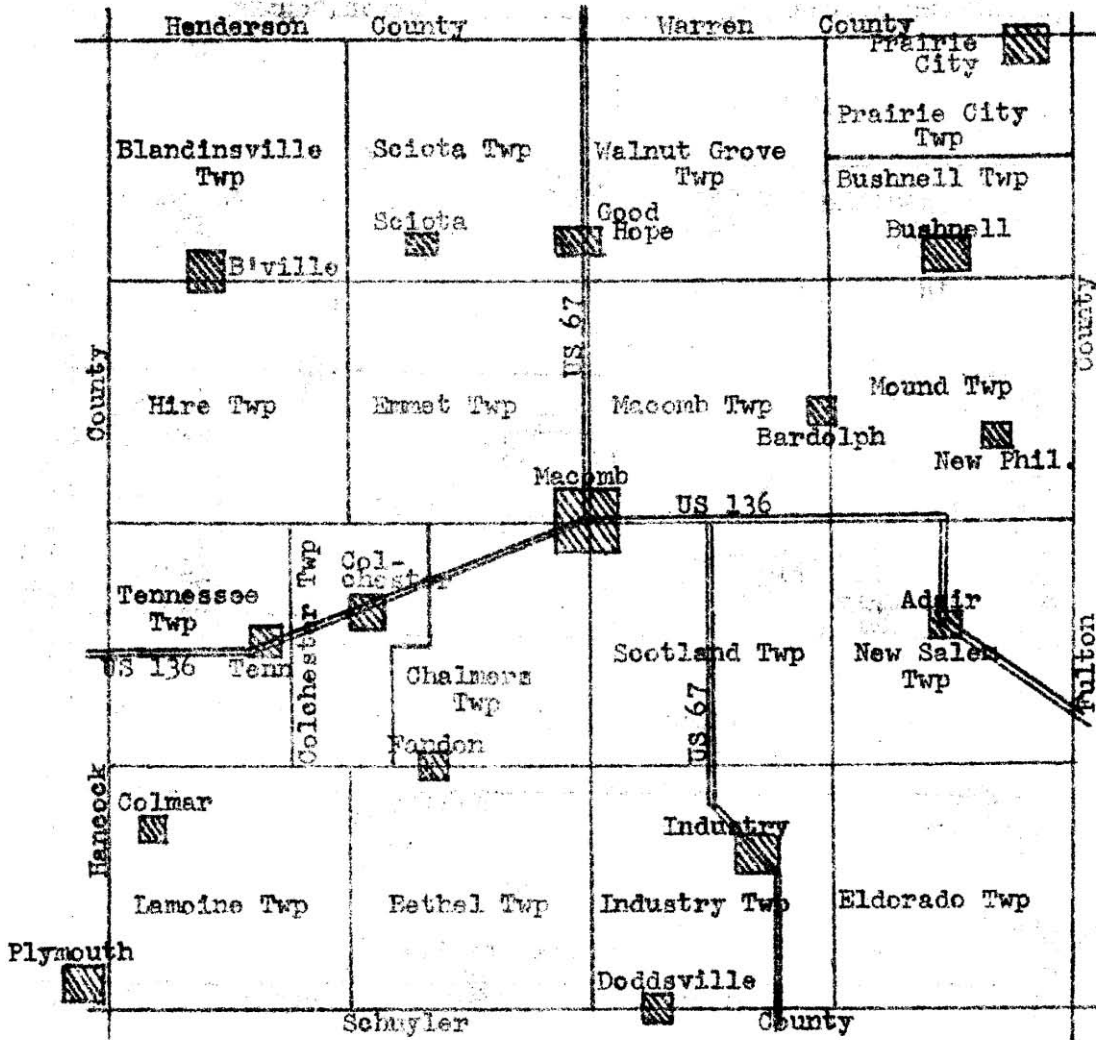

Areas covered by volumes I - XVII  
 "Cemeteries of McDonough County, Illinois"

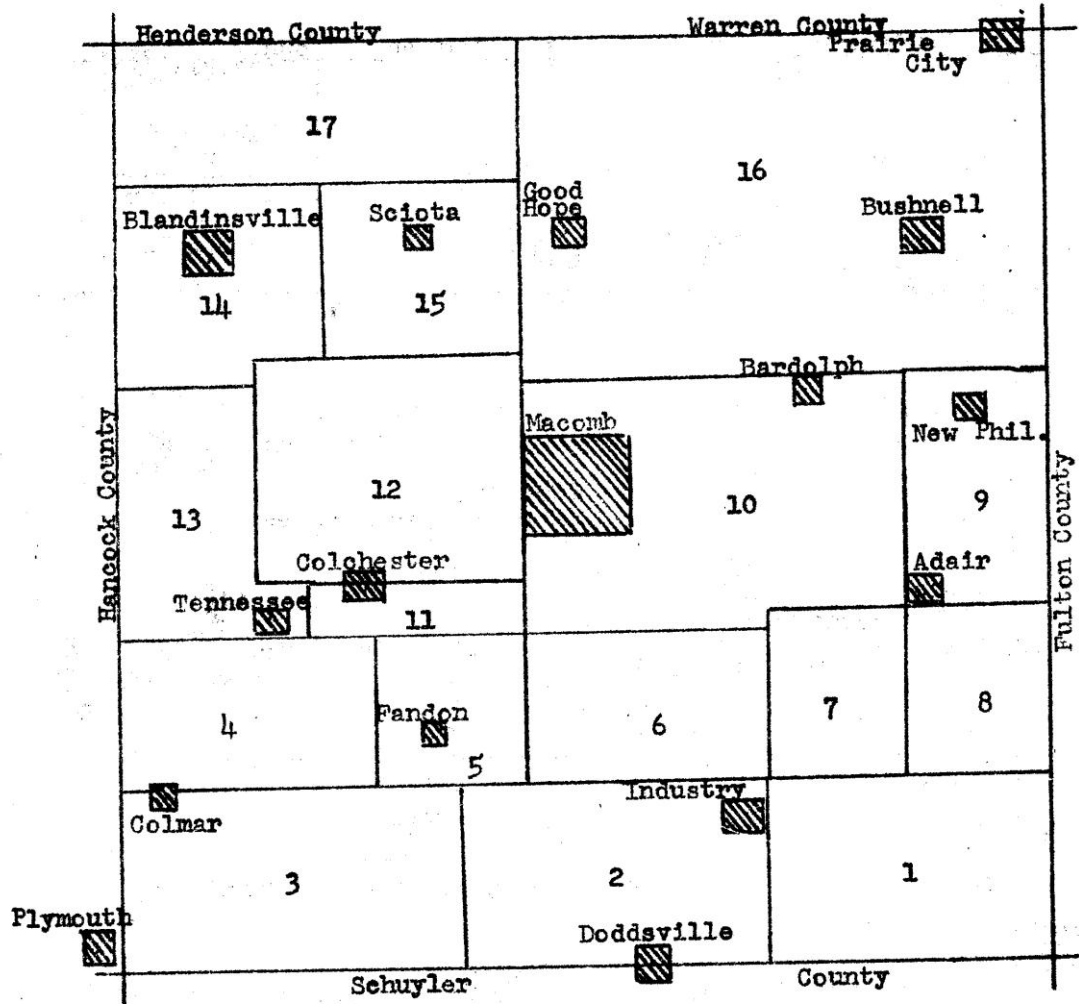

Section 36  
OS 11002  
Hire Township, T6N R4W; 1871

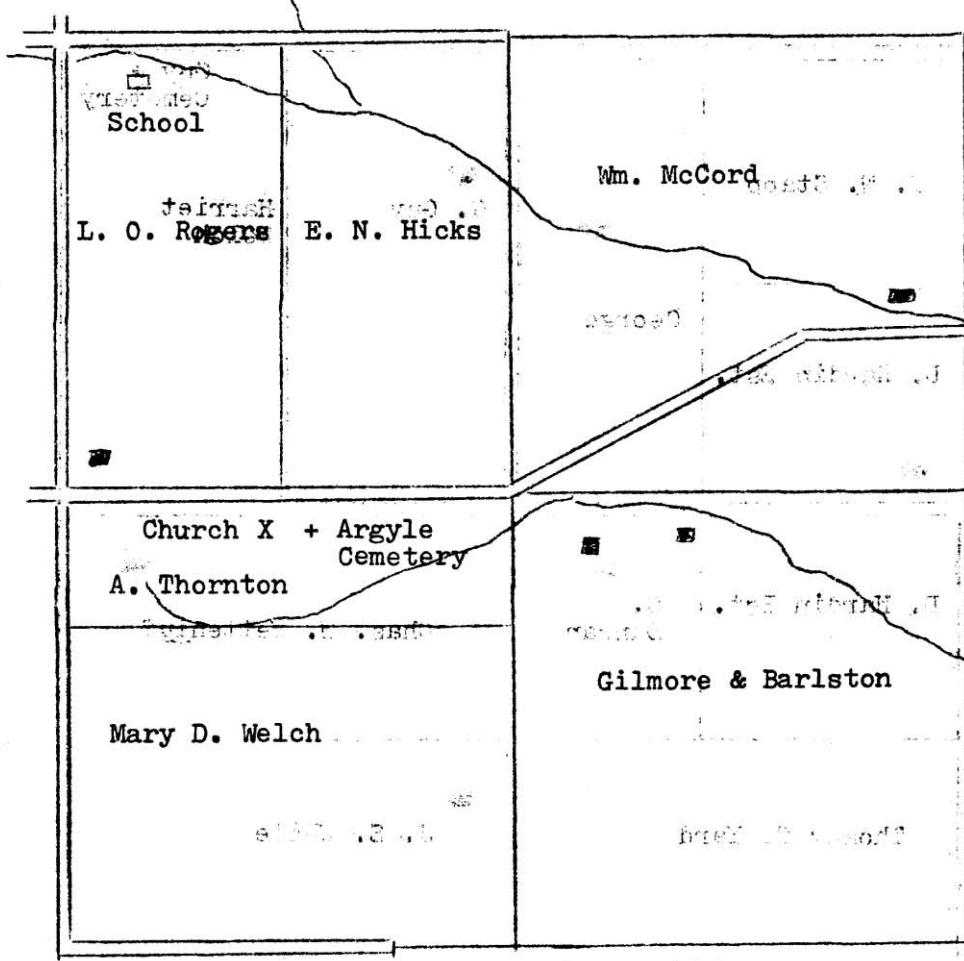



Section 20

Emmet Township, T6N R3W; 1871

J. W. Stapp		G. Guy	Guy + Cemetery Harriet Welch
D. Hardin Est.	George		
D. Hardin Est.	C. Duncan	Chas. W. Wetteniu?	
Thomas C. Yard		J. S. White	

Section 16

Emmet Township, T6N R3W; 1871

J. S. Wilson		G. Knappenberge	Jno. Dew		J. D. Simmons Simmons + Cemetery		T. H. S. Murray	
X Saw Mill			R.W.D.	J.W.	M. Champion	W. C. McD.		
G. G. Guy		T. C. Yard		J. S. Teaford				
J. Bayliss				D. J. D.				
N.L.	W.D.							
G.G. Guy		Job Yard		D. Hardin		Wm. Stickle	A. B. Stickle	



Section 32

Section 32  
Emmet Township, T6N R3W, 1871

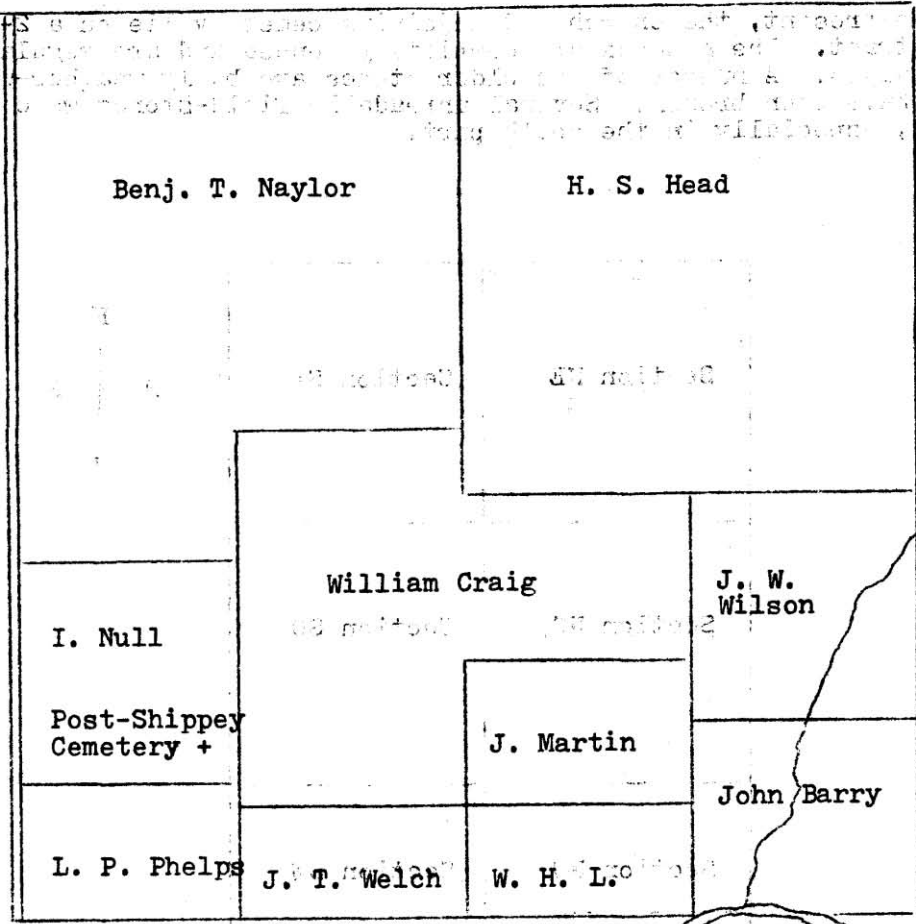

## ARGYLE CEMETERY

Location: Hire Township, SW¼, section 36; about two miles northwest of Colchester. This cemetery is about one quarter mile east on N1250 Rd off E500 St:  $40^{\circ} 27' 47.17''$  N:  $90^{\circ} 48' 23.47''$  W

Remarks: The Cumberland Presbyterian Church of Argyle was originally organized in the southwestern part of Emmet township and held first meetings in 1834. First known as Bersheba Church, the congregation met at or near the original site until 1854, when it was transferred to its present location. The church building was erected in 1854 and was used for several years by both Baptists and Cumberland Presbyterians.

At the present [1975], the church and adjoining cemetery lie on a 2-3 acre tract. The grounds are completely fenced and are regularly maintained. A number of the older stones are badly weather-worn; some have been broken. Several unreadable field-stones were located, especially in the south part.

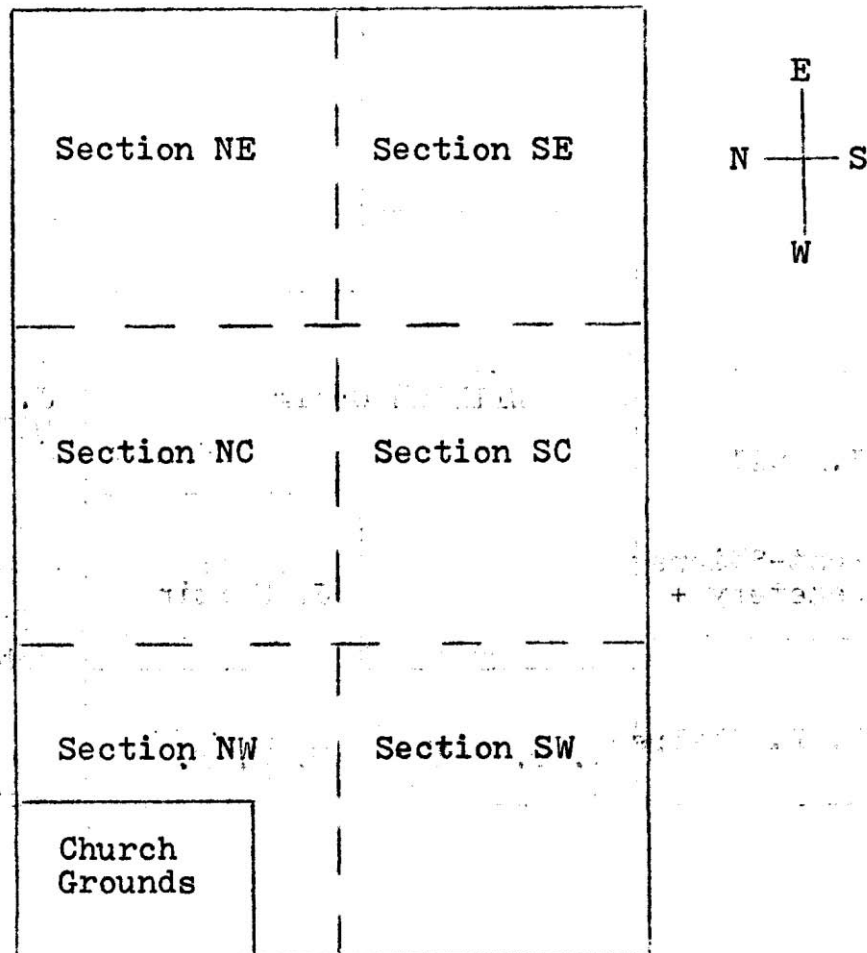

ABELL:

Jeremiah; Jun 30, 1770 – Sep 17, 18---. (SE)  
Nancy; (See CALDWELL).

ADAMS:

Cerelda, wife of Robert; d. May 1851; age 25y. (SC)

AVERILL:

Carie, dau of A.W. & M.A.; d. Apr 2, 18---; age -----. (SE)  
Clarie, dau A.W. & M.A.; d. Jan 2, 1864; age -----. (SE)  
Henry C., son of A.W. & M.A.; d. Apr 5, 1861; age 1y 6m 7d. (SE)  
Delinda J., dau of A.W. & M.A.; d. Sep 11, 1860; age 1y 3m ---d. (SE)  
Sarah E., wife of A.W.; d. Dec 22, 1851; age 21y 5m 12d. (SE)

BAUMGARDNER:

Thomas; 1869 – 1963. (NW)  
Myra; 1873 – 1930. (NW)  
Angeline; 1871 – 1945. (NW)  
Wallace; 1865 – 1945. (NW)  
Lora O.; 1880 – 1947. (NW)  
Maurine; 1919 – 1945. (NW)  
Lawrence R.; 1876 – 1955. (NW)  
William; 1837 – 1925. (NW)  
Martha E. McClure; 1844 – 1917. (NW)

BEAN:

Joseph; Sep 4, 1837 – Oct 15, 1912. (NW)  
Mary F. Welch, wife of Joseph; Sep 18, 1842 – Oct 25, 1897. (NW)  
Clyda; Nov 23, 1875 – Mar 2, 1876. (NW)  
Daniel E.; Aug 23, 1869 – Mar 19, 1876. (NW)  
Leo C., son of Vilasco; Jan 20 – 25, 1907. (NW)  
Bert; 1878 – 1948. (NW)  
Lida M.; 1884 – 1973. (NW)

BEARD:

Ivy Ella; d. Jul 19, 1863; age 3y 9m 9d. (SE)  
Ida May, infant; d. Aug 10, 1861. (SE)  
(Children of J.W. & L.C. Beard)

BELL:

Nancy R.; (See SHORT).

BENNETT:

Mary Elvesia, dau of Thomas & Phebe; d. Aug 28, 1880; age 21y 9m. (NW)  
Wales, son of T. & P.; d. Nov 18, 1869; age 17d. (NC)

BISHOP:

Herman T.; 1902 – 1964. (SW)  
Icie E. Smith; 1904 – 1937. (SW)

BOSLER:

Infant son of G. & E.; Mar 21 – 22; 1857. (SC)  
Infant son of G. & E.; b. & d. Mar 21, 1857. (SC)

BRADLEY:

Elijah; (no dates); Co G 8<sup>th</sup> TN Cav. (NW)  
Mary E., wife of J.W.; d. Sep 19, 1869; age-----. (NC)  
Lucy A., wife of James W.; Apr 4, 1842 – Jan 7, 1878. (SW)

BRIGHT:

Charlie, son of S. & M.A.; d. Aug 3, 1873; age 1y 3m. (NC)  
Johnny, son of S. & M.A.; Jul 19, 1873 – Dec 2, 1878. (NC)  
Clara, dau of S. & M.A.; Nov 25, 1877 – Sep 10, 1878. (NC)  
Rosetta, dau of S. & M.A.; Jun 17, 1879 – Oct 26, 1879. (NC)  
Freddie, son of S. & M.A.; Sep 3, 1887 – Feb 3, 1888. (NC)  
Mary A. Fentem, wife of Sam'l; Jun 21, 1852 – Sep 23, 1900. (NC)

CALDWELL:

Elijah K., son of S. & N.; Jul 21, 1821 – Sep 8, 1846. (SE)  
Nancy Abell, wife of Sam'l; d. Jul 27, 1877; age 85y 7m 7d. (SE)  
Vicessimus A.; d. Jul 26, 1850; age 33y 9m 3d. (SE)  
Minerva A., wife of Vicessimus; d. Dec 20, 1859; age ----. (SE)

CALE:

Willoughby Douglas, son of P. & M.J.; d. Jan 23, 1863; age 1y 7m 24d. (SC)

CALVERT:

Melvina N.; 1869 – 1944. (NW)

CARLILE:

Elizabeth J., dau of J.E.K. & M.; d. Feb 25, 1855; age 6y 8m 5d. (SE)  
Polly Ann, dau of J.E.K. & M.; May 6, 1846 - ----- . (SE)  
John E.K.; Dec 30, 1817 – Aug 4, 1879. (SE)  
Matilda; May 24, 1817 – Sep 16, 1900. (SE)

CARMACK:

Margaret Ann, dau of J.C. & E.C.; d. Dec 31, 1863; age----. (NE)  
James R., son of J.C. & E.C.; d. Aug 16, 1864; age----. (NE)  
Ida, dau of J.C. & E.C.; d. Oct 5, 1866; age 10m 13d. (NE)  
Elizabeth C.; Mar 12, 1840 - Feb 12, 1904. (NE)  
Jane, wife of J.B; 1831 – 1914. (NE)  
James B.; d. Jun 26, 1888; age 57y 4m 29d. (NE)  
William C.; Apr 18, 1825 – Jun 18, 1905. (NW)  
Martha Murray, wife of Wm.; Mar 4, 1833 – Mar 10, 1885. (NW)  
Harry S.; Aug 27, 1823 – Mar 21, 1906. (NW)  
Mary Jane, wife of Henry; Mar 24, 1831 – Dec 6, 1910. (NW)  
Martha Mearl, dau of E.F. & L.J.; d. Mar 2, 1891; age 1y 10m 4d. (NC)  
Ethel I., dau of E.F. & L.J.; d. Apr 1, 1898; age 8m 27d. (NC)  
Eli F.; 1852 – 1935. (NC)  
Lovina; 1860 – 1946. (NC)  
Lewis M.; 1852 – 1922. (NC)  
Mary A., wife of L.M.; 1856 – 1935. (NC)  
Mary M., dau of W.C. & M.; d. Mar 5, 1862; age 3y 5m 9d. (SE)  
John W., son of W.C. & M.; d. Feb 25, 1862; age 1y 3m 25d. (SE)  
William R., son of W.C. & M.; d. Feb 20, 1862; age 8y 1d. (SE)  
James C., son of W.C. & M.; d. Aug 21, 1859; age 3y 3d. (SE)  
Lemura A., dau of J.B. & J.; d. Oct 5, 1854; age 8m 25d. (SE)  
Cornelius; d. Jul 24, 1849; age 55y 2m 6d. (SE)  
George C., son of J.C.D. & L.E.; d. Feb 29, 1854; age 2y 8m 15d. (SE)  
J.C.D.; d. Mar 30, 1855; age 35y 3m. (SE)  
Madison L., son of W.C. & Martha; d. -----; age -----. (SE)  
William R.; 1858 – 1934. (SW)  
Sarah E.; 1867 – 1939. (SW)  
Elizabeth C.; (See GRAHAM).

CHANDLER:

Gladys B., dau of L.M. & C.A.; 1899 – 1908. (SW)  
Lewis M.; 1871 – 1952. (SW)  
Clara A.; 1873 – 1966. (SW)

COPLAN:

J. Willard; 1865 – 1944. (SW)  
Emma J., wife of J.W.; 1863 – 1925. (SW)  
Della A., dau of J.W. & E.J.; Jul 2, 1887 – Sep 9, 1890. (SW)  
Infant dau of J.W. & E.J.; May 21 – 25, 1892. (SW)

CREASEY:

James F.; 1841 – 1916. (SW)  
Susan M. Nelson, wife of J.F.; 1844 – 1886. (SW)  
Lucy A. Nelson, wife of J.F.; 1840 – 1922. (SW)  
Nancy George; Oct 24, 1817 – May 9, 1973. (NE)

CRESSEY:

G.W. (no dates); Co A 16<sup>th</sup> IL Inf. (SE)

CRESY:

Ida A., dau of G.W. & M.E.; d. Aug 26, 1872; age 1y 9m 18d. (SE)

CRUME:

Elizabeth, dau of A.H. & L.M.; d. Feb 23, 1875; age 1y 5m 13d. (NC)

CUYLER:

Martha A., wife of C.H.; d. Aug 30, 1879; age 38y 10m 3d. (NC)

DAUGHERTY:

William O., son of S. & M.C.; d. ----; age-----. (SE)

DEWEY:

Nancy H., wife of C.C.; b. Aug 13, 1825; d.-----. (SE)

DICKEY:

Irena Belle, dau of James & Laura; d. Apr 6, 1884; age 19y 1m 22d. (SW)

DIXON:

Eleathe Belle, dau of G.W. & L.S.; d. Aug 6, 1864; age----. (SC)  
George W.; Sep 24, '840 – Nov 14, 1917. (NC)  
John E., son of G.W. & L.S.; d. ----; age ----. (NC)

DOAN:

Thomas E., son of A.H. & S.L.; d. Aug 18, 1862; age 18y 5m ---d; Co D 64<sup>th</sup> IL Inf. (SC)

EBBEN:

Samantha Martin, wife of W.H.; Apr 5, 1878 – May 5, 1899. (NC)  
Maggie M. Nelson, wife of W.H.; May 15, 1874 – May 28, 1903. (NC)

EVANS:

William; d. Jun 6, 1861, in his 40<sup>th</sup> year. (SE)

FENTEM:

Lewis E.; 1872 – 1928. (SW)  
J. Taylor; 1900 – 1922. (SW)  
Ethel; 1902 – 1920. (SW)  
Otto W.; 1907 – 1909. (SW)  
J.W.; Jan 18, 1849 – Nov 11, 1912. (NC)  
Nancy B. McCord, wife of J.W.; Jul 31, 1852 – Jan 24, 1912. (NC)  
Dewey B., son of J.W. & N.B.; Nov 4, 1898 – Feb 19, 1902. (NC)  
Ida; d.----, 1876; age 1y 7m 12d. (NC)  
Mary A. (See BRIGHT).



FISH:

Mary C., dau of J.E. & F.L.; d. Mar 13, 1866; age 4y. (NE)  
Jesse E., Jr.; d. Feb 24, 1866; age 32y 3m 13d; QM Sgt 58<sup>th</sup> IN Inf. (NE)

FOLTS:

Franklin H.; ----- (NC)

FURGHTBAR:

William, son of J.G. & M.F.; d. Jul 13, 1873; age 5y 7m 22d. (NC)

GEORGE:

Nancy; (See CREASEY).

GIBBS:

Clarissa, wife of J.T.; d. ?Aug 21, 1872?. (NE)

GOAD:

Robert; d. Oct 17, 1855; age ----. (SC)

GOSSETT:

Mrs. J.F.; 1892 – 1910. (SW)

GRAHAM:

Eliza J.; d. Jan 14, 1864; age 13y 11m 2d. (SW)  
Jane; d. Mar 20, 1860; age 35y 8m 1d. (SE)  
Maria, wife of Hampton; Dec 11, 1793 – Oct 12, 1855. (SE)  
Milton J., son of B. & J.; Apr 16, 1852 – Mar 6, 1853. (SE)  
William S., son of B. & J.; Nov 6, 1851; age 1y 7m 28d. (SE)  
Elizabeth G., dau of B. & J.; d. Aug 9, 1849; age 2y 1m 15d. (SE)  
Laura J., dau of B. & ---; d. Oct 25, 1877; age 5y 7m 6d. (SE)  
Ella M., dau of B. & ---; d. Oct 31, 1877; age 3y 4m 22d. (SE)  
Austin C., son of B. & ---; d. Oct 21, 1877; age 15y 11m 26d. (SE)  
Elizabeth C. Carmack, wife of Joseph; Aug 1862 – Sep 1880. (SE)

GREENBANK:

William, Sr.; d. Nov 8, 1893; age 84y. (NE)  
Jane; d. May 13, 1880; age 64y. (NE)  
Richard, son of W. & J.; d. Aug 17, 1867; age ----. (NE)

GRILLS:

Susan L., dau of W.P. & M.L.; ----- (NC)

GROW:

Rebecca; d. Dec 18, 1902; age 76y 9m 11d. (NE)  
Andrew; d. Apr 27, 1885; age 66y 1m 24d. (NE)

HAINES:

Lucy Jane; (See PARISH).

HENDERSON:

P.K.; d. Dec 9, 1838; age ----. (SE)  
Theresa J.; ----- (SE)  
Louisa E., dau of W.G. & P.; d. Mar 22, 1848; age 14y ---m ---d. (SE)

HIBBARD:

Henry; d. Sep 3, 1869; age 37y 5m ---d. (NE)

HILL:

Thomas; Feb 28, 1810 – Sep 25, 1881. (NC)  
Malvina, wife of Thomas; b. Dec 24, 1816; md. Nov 22, 1832; d. Sep 9, 1866. (NC)

HOLDEN:

Eliza J.; Jan 6, 1859 – Feb 8, 1952. (NW)  
M.F.; 1863 – 1939. (NW)

HOOD:

John A., son of J. & M; killed in coal shaft #3, Colchester, IL May 15, 1872; age 14y 5m.

HOSKINS:

Robert; 1836 – 1908. (NE)

HUNGATE:

Rhoda; Dec 17, 1820 – Sep 9, 1897. (SE)

HUNT:

Milly, wife of John; d. Oct 25, 1855; age 29y 2m 5d. (SE)

JAGGARD:

Clemey, son of T. & E.; d. Apr 20, 1863; age 2y 9m 5d. (SC)

JAMES:

Malinda, wife of John; d. Dec 18, 1850; age 37y 11m 15d. (SE)

Martha Belle, wife of Robt.; d. May 23, 1899; age 40y 2m 4d. (NW)

William Robert; 1849 – 1920. (NW)

JOHNSON:

Emma E., dau of H. & R.J.; d. Nov 13, 1857; age 1y ---m ----d. (SE)

JUSTUS:

Fleming; 1844 – 1928. (NE)

Catherine; 1851 – 1917. (NE)

Elmer James; d. Jul 15, 1865; age 77y 2m 8d. (NE)

KEEVER:

Pearl; (See NULL).

KIPLING:

Infant son of M. & W.; d. Feb ----, 1863, age ----. (NE)

Mary E., dau of W. & M.H.; d. Sep 28, 1865; age ---. (NE)

Mary H., wife of Wm.; d. Apr 14, 1874; age 50y 6m 9d. (NE)

-----; d. ----- 3, 1865; age 48y. (NE)

KRIEG:

Infant son of T.B. & M.C.; (no dates). (NW)

LATHAM:

Nelson P.; d. Jan 22, 1878; age 67y 5m 12d. (NW)

Charles E.; 1859 – 1910. (NW)

Emma B. Norville, wife of Chas.; 1862 – 1909. (NW)

LEDGERWOOD:

Elijah; 1844 – 1927. (NW)

Clementine, wife of Elijah; 1841 – 1924. (NW)

Elisha; d. Jun 18, 1908; age 64y 2m 11d. (NE)

Catherine, wife of Elisha; d. Oct 14, 187--; age 34y. (NE) [should be 1874; age 30 in 1870 census]

Infant son of Elisha & Catherine; d. Oct 14, 187--. (NE)

John, son of J. & N.; d. Nov 10, 1865; age 20y 20d.

Nancy H., wife of John; d. Dec 1, 1884; 78y 1m 13d. (NE)

John; d. Oct 30, 1879; age 68y 10m 13d. (NE)

Elizabeth R.; 1862 – Mar 25, 1907. (SC)

LIGHTLE:

Effie M., Oct 16, 1869 – Jan 24, 1923. (NC)

David B.; Jan 30, 1847 – Feb 19, 1915. (NC)

LUSTER:

Thomas J., son of P.D. & T.H.S.; d. Dec 28, 1851; age 2y. (SE)

William E., son of P. & T.H.; Sep 14, 1852 – Feb 14, -----. (SE)

MARTIN:

Samantha; (See EBBEN).  
Cathern; 1852 – 1928. (NE)  
Henry; 1846 – 1909. (NE)  
Roy A.; 1891 – 1892. (NE)  
Arthur P.; 1872 – 1936. (NE)  
Nancy A.; 1857 – 1876. (NE)  
James R., son of J.A. & S.J.; d. May 19, 1876; age ----. (NE)  
Infant son of J. & R.G.; d. Apr 12, 1861. (SW)  
Douglas; 1860 – 1936. (SW)  
Rachel; 1818 – 1903. (SW)  
Reuben; 1826 – 1892. (SW)  
Ida O., dau of W.F. & S.A.; d. Feb 16, 1893; age 5y 3m 26d. (SW)  
Sadie A., wife of W.F.; Aug 2, 1855 – Apr 4, 1908. (SW)  
William F.; May 29, 1861 – Jan 3, 1921. (SW)

MC CLURE:

Martha E.; (See BAUMGARDNER).

MC CORD:

Nancy B.; (See FENTEM).  
A.Y.; 1825 – 1902. (SW)  
Mary A.; 1827 – 1912. (SW)  
Mariah A.; Aug 6, 1835 – Jan 5, 1904. (SW)  
-----; d. Jun 23, 1938; age 66y 21d. (SW)  
Sarah Alice; Aug 5, 1875 – Sep 12, 1954. (SW)  
Amanda, wife of G.C.; Aug 11, 1851 – Feb 21, 1882. (NE)  
Arthur, son of G.C. & H.E.; d. Jan 2, 1869; age 1m 13d. (NE)  
Sarah J.; 1844 – 1922. (NC)  
John; 1844 – 1919. (NC)  
Clida; (stone unreadable). (NC)  
Mary, dau of J.A. & S.J.; d. Jun 15, 1873; age 5y 3m 3d. (NC)  
Infant son of J.A.F. & S.F.; d. Jun 8, 1870. (NC)  
Louisa, wife of William W.; d. Oct 22, 1878; age 62y 3m 6d. (NC)  
William L.; d. Feb 25, 1863; age 16y 8m 7d. (NC)  
Thomas R., son of W.H. & L.; d. Aug 25, 1864; age 8y 10m 5d. (NC)

MC GEE:

Sarah J., wife of Henry; d. Feb 27, 1855; age 25y 11m 4d. (SE)  
Henry S.R., son of H.H. & S.; d. Oct 13, 1855; age ----. (SE)  
Henry H.; d. Oct 1, 1859; age 44y 7m 11d. (SE)  
Mary E., wife of S.B.; d. Jun 25, 1870; age 26y 8m 20d. (SE)  
Elijah; d. Mar 21, 1857; age 36y ---m ---d. (SE)  
George D.; d. Feb 20, 1871; age 28y 7m 24d. (SE)

MC MAHAN:

Edgar S. 1871 – 1947. (NW)

MC NEILL:

Glenola Welch, wife of Dayton; Nov 18, 1879 – Apr 6, 1907. (NW)

MEYER:

Mary Ann, wife of F.F.; d. Ma y22, 1873; age 42y 2m 20d. (NC)

**MILLER:**

Ida Jane, dau of S.E. & P.; d. Jan 5, 1864; age ---. (NE)  
Martha B., dau of S.E. & P.; Jun 17, 1863; age ----. (NE)  
Sarah E., wife of P.; d. Feb 12, 1867; age -----. (NE)  
John; 1837 – 1924. (SW)  
Ruth Anna; 1858 – 1924. (SW)

**MOON:**

Sharlot A., dau of S. & M.A.; d. Jun 10, 1861; age 22d. (SE)  
Olive E.; d. Sep 10, 1877; age 15y 4m 6d. (NE)  
Noble C.; d. Jan 30, 1882; age 10m 15d. (NE)  
Infant son; d. Sep 24, 1889. (NE)  
(Latter 3 were children on Sam'l & Mary A. Moon).

**MORDUE:**

George Wm., son of G. & E.; d. Nov 1, 1874; age 12y 5m 23d. (SC)  
Jane, dau of G. & E.; d. Jul 27, 1872; age 1y 5m 2d. (SC)  
Lanclot, son of G. & E.; d. Sep 8, 1865; age 1y 8d. (SC)

**MORGAN:**

Sarah, wife of S.; d.----; age----. (NE)

**MORTON:**

James W.; d. Jul 19, 1863; age 5y 11m 17d. (SC)

**MOSS:**

Mary, wife of J.; d. Sep 15, 1856; age 56y 4m 12d. (SE)  
Isaac D., son of S.H. & S.A.; d. Nov 14, 1891; age 24y 2m 14d. (SW)

**MOURNING:**

Ann, wife of William; d. Jul 15, 1884; age 80y 10m 29d. (SE)

**MULKEY:**

Myrtle L., dau of Alva & Mary; d. Aug 8, 1900; age 17y 10m 7d. (SW)  
Orville L.; Aug 4, 1891 – Jun 9, 1911. (NC)  
Clyde T., son of O.L. & A.B.; Aug 2, 1910 – Apr 8, 1911. (NC)

**MURRAY:**

Mary J.; (See SIZELOVE).  
Jessie E., dau of M.A. & E.; d. Sep 27, 1881; age 4y 11m 17d. (NC)  
B.F.; Jan 17, 1819 – Sep 8, 1899. (NC)  
Marrietta; Nov 21, 1830 – Sep 28, 1872. (NC)  
Nellie; Sep 20, 1872 – Oct 11, 1872. (NC)  
Martha F., dau of E. & E.H.; d. Dec 31, 1862; age 4y. (NE)  
Louisa Mabelle, dau of E. & E.H.; d. Jun 21, 1865; age 2y 1m 14d. (NE)  
Margaret Elizabeth, dau of E. & E.H.; d. Jun 21, 1865; age 2y 1m 14d. (NE)  
John Wesley, son of E. & E.H.; d. Mar 12, 1874; age 4d. (NE)  
Elsie Euphremia; d. Oct 26, 1878. (NE)  
Ella Eugenia; d. Oct 27, 1878. (NE)  
Elizabeth Hanna; Feb 1, 1837 – Sep 3, 1916. (NE)  
Rubin; Nov 30, 1827 – Jan 15, 1903. (NW)  
Infant son of A. & R.J.; Aug 28 – Oct 16, 1881. (NW)  
S. Leroy; Mar 15, 1926 – May 20, 1967; PFC 545<sup>th</sup> Sig Co 3<sup>rd</sup> Sig Bn. (NW)  
Leroy; 1879 – 1927. (NW)  
Martha; 1880 – 1963. (NW)  
Allen; Sep 30, 1834 – Feb 23, 1920. (NW)  
Perilla J. Parker, wife of Allen; Dec 23, 1836 – May 28, 1917. (NW)  
Estella; 1874 – 1953.

MURRAY (Cont'd):

Frank; 1876 – 1952. (NW)  
Velma V., dau of B.F. & E.J.; May 19, 1898 – Mar 4, 1905. (NW)  
Amy; 1864 – 1958. (NW)  
William D., son of J.B. & S.M.; Apr 2, 1850 – Mar 31, 1869. (SW)  
James Riley; Feb 12, 1859 – Feb 15, 1881. (SW)  
John B., Sep 20, 1813 – Jul 28, 1893. (SW)  
Susan M., wife of J.B.; Jun 6, 1817 – Feb 15, 1897. (SW)  
John Taylor; 1847 – 1920. (SW)  
Henry J., son of H. & E.; d. Apr 2, 1855; age 6m. (SE)  
John L., son of H. & E.; d. Aug 12, 1849; age 3y 1m 4d. (SE)  
William R.; son of H. & E.; d. Aug 18, 1849; age 3m 13d. (SE)  
Infant dau of H. & E.; d.----- (SE)  
Elizabeth, wife of H.; d. Apr 23, 1894; age 71y 8m 2d. (SE)  
Martha; (See CARMACK).

NAYLOR:

Charlie, son of W.B. & P.; d. Sep 1, 1867; age 1m 14d. (NC)  
Sarah M., wife of W.B.; d. Mar 25, 1864; age 25y 7m 13d. (NC)  
Louisa A., dau of W.B. & S.; d.----- (NC)

NELSON:

America A. Welchell, wife of J.A.; Jul 6, 1851 – Jan 11, 1909. (SW)  
Albert; (field-stone; unreadable). (SE)  
John W., son of B.F. & L.A.; d. Feb 18, 1863; age ----. (SE)  
George W., son of B. & L.; d. Mar 5, 1862; age ----- (SE)  
William H.; son of W.H. & G.; d. Aug 10, 1875; age 16y 8m 15d. (NE)  
William; d. Mar 14, 1887; age 67y. (SW)  
Susan M.; (See CREASEY).  
Lucy A.; (See CREASEY).  
Maggie M.; (See EBBEN).

NEWLAND:

Mary Jane, wife of Rev. A.; d. Jun 15, 1871; age 30y 4m 9d. (NE)  
George Albert, son of A. & M.J.; d. May 4, 1869. (NE)  
Mary Jane, dau of A. & M.J.; d. Jul 20, 1871. (NE)

NORVILLE:

Emma B.; (See LATHAM).

NULL:

Samuel F.; Mar 21, 1864 – Feb 6, 1906. (NW)  
Pearl Keever; Oct 13, 1870 – Jun 21, 1966. (NW)  
William H.; 1835 – 1919. (NW)  
Orpha G.; 1837 – 1922. (NW)  
Louis A.; 1874 – 1959. (NW)  
Daisy S.; 1880 – 1960. (NW)  
Hugh; Oct 15 – 19, 1908. (NW)

OAKMAN:

Ida May; d. Nov 27, 1896; age 13y 10m 12d. (SW)

PARISH:

Jacob; Oct 1, 1836 – May 19, 1927. (SE)  
Lucy Jane Haines, wife of Jacob; Oct 16, 1836 – Nov 1, 1914. (SE)  
James M., son of J. & L.J.; d. May 6, 1871; age 11y 7m 6d. (NE)

PARKER:

Perilla J.; (See LATHAM).

PEARSON:

Abram; 1820 – 1871. (SC)

Elizabeth, wife of A. of Colchester, ILL.; d. Oct 21, 1862; age 59y. (SC)

PHELPS:

Mary D., wife of J.E.; d. Feb 15, 1899; age 54y 3m 10d. (NW)

Jamin E.; Jun 6, 1844 – Feb 5, 1902. (NW)

Ralph L., son of D.E. & L.E.; Feb 18, 1898 – Sep 4, 1899. (NW)

Darius; Oct 17, 1869 – Nov 23, 1904. (NW)

PURMAN:

Francis M., son of N.N. & R.; d. Dec 24, 1857; age ----- (SE)

RAY:

?Harmon?, son of J.R. & M.E.; d. Feb 11, 1893; age 1y 11m 18d. (NW)

Sarah, wife of G.; d. Aug 22, 1851; age 28y 6m. (SC)

George W.; d. Oct 28, 1851; age 24y. (SC)

RAYMOND:

William; b. in Baltimore Co. MD, Aug 10, 1815; d. Aug 30, 1894. (NW)

Mary Jane Younger, wife of Wm.; b. in Muskingum Co. OH, Aug 22, 1816; d. Feb 11, 1898. (NW)

Thomas A.; Apr 22, 1854 – May 17, 1897. (NW)

REIDSEMA:

Evelyn; 1861 – 1947. (NE)

REMINGTON:

Josephine, inf dau of V.E. & Esther; d. Sep 3, 1846; age 2y 6m. (SE)

RICHESON:

Infant daughters of J.M. & M.E.; (single stone; no dates). (SW)

ROBERTS:

David; d. Sep 21, 1875; age 58y 11m 1d. (SC)

Ann, wife of D.; d. Apr 30, 1859; age 39y 6m 24d. (SC)

ROBERTSON:

Alexander; d. Apr 29, 1864; age 55y 5m 24d. (SC)

RODGERS:

Lillian Ione, dau of S. & M.; d. Nov 29, 1901; age 14y 5m 17d. (SW)

Martha, dau of C. & N.; d. Jan 21, 1855; age 10y 9m 30d. (SE)

William H.; Dec 3, 1837 – Mar 28, 1882. (SE)

William B.; 1859 – 1946. (NC)

Allie J.; 1869 – 1951.

RUSSELL:

John; Jun 1808 – May 1875. (NE)

Margaret, wife of John; Feb 1813 – Oct 1900. (NE)

Henry H., son of J. & M.; Nov 1846 – Sep 1906. (NE)

Nancy J., dau of J. & M.; Oct 1845 – (no date). (NE)

?SARL?

John; d. Feb 9, 1862; age 50y 1m 13d. (SE)

SCOTT:

Richard; Aug 8, 1814 – Dec 14, 1897. (SE)

Polly I. Thurman; Nov 24, 1811 – Dec 27, 1893. (SE)

Jane; d. Feb 6, 1880. (SE)

SHACKLETT:

Charles M., son of R.D. & W.A.; d. Dec 19, 1868; age 2y 20. (NC)  
Henry F.; d. May 13, 1863; age 2y 22d. (NC)  
Albert F.; (unreadable). (NC)

SHAW:

Dunkin; d. Sep 26, 1867; age 64y 6m 4d. (SE)  
Margaret, wife of Dunkin; d. Oct 3, 1867; age 71y 7m 3d. (SE)

SHIPPEY:

Edmond, son of T. & C.M.; d. May 28, 1871; age 14d. (SC)  
James M., son of T. & C.M.; d. Sep 18, 1856; age 1m 1d. (SC)  
Mary A., dau of T. & C.M.; d. Jan 4, 1854; 1y. (SC)  
George W., son of T. & C.M.; d. Feb 24, 1851; age 11m. (SC)  
Thomas; d. Apr 2, 187--; age 51y 10m 2d. (SC)

SHORT:

James L.; Nov 29, 1878 – Mar 29, 1880. (SE)  
Nancy R. Bell; Dec 9, 1845 – Apr 18, 18---. (SE)  
James; d. Nov 21, 1854; age ?12/42?y 8m. (SE)  
Elizabeth C., wife of John; d. Jan 6, 1902; age 80y 3d. (NW)

SHRYACK:

S. Lorene; 1878 – 19----. (SW)  
John F.; 1872 – 1928. (SW)

SIMS:

Rev. L. B.; d. Oct 6, 1874; age 58y 6m 5d. (SW)

SIZELOVE:

Mary J. Murray, wife of John; d. Feb 11, 1882; age 25y 10m 12d. (SE)

SMITH:

Icie E.;(See BISHOP).

SMITHWAIT:

John; Feb 3, 1839 - -----; d. at age 22y 11m 4d; Co G 16<sup>th</sup> IL Inf. (SE) [[d. 7 Jan 1862](#)]

SPENCER:

Isaac, Sr.; d. Apr 1, 1869; age 68y 10m 29d. (SC)  
Isaac; d. Feb 11, 1862; age 22y 5m 22d. (SC)  
Kisiah, wife of Isaac, Sr.; d. Aug 8, 1861; age 61y ---m 18d. (SC)

STAPP:

Rev. James W.; Mar 24, 1826 – Jan 11, 1875. (SC)  
Mahala T., wife of J.W.; Feb 10, 1834 – Jun 23, 1895. (SC)  
Ben F., son of J. & M.; May 22, 1864 – Feb 26, 1865. (SC)  
Martha A., dau of J. & M.; May 12, 1866 – Sep 25, 1868. (SC)

STONES:

Thomas W., son of Wm. & S.; d. Jul 20, 1869; age ----. (NE)

SYMPSON:

Thomas W.; 1862 – 1947. (NW)  
Manta E. 1877 – 1962. (NW)

TEAS:

Delinda J., dau of N.R. & C.B.; d. Jan 20, 1836; age ----. (SE)

TERRILL:

Thomas, son of J. & E.; d. -----; age -----. (NC)

THORNTON:

Anthony; Mar 19, 1827 – Nov 5, 1910. (SW)  
Amanda Welch, wife of A.; May 29, 1836 – Sep 16, 1923. (SW)  
Carrie Alleyne; Nov 24, 1876 – Feb 7, 1880. (SW)  
“Our Infant Children”; (no names nor dates). (SW)

THORPE:

Martha, wife of John; Jan 1, 1808 – Jan 18, 1890. (SE)  
William T.; d. Sep 5, 1860; age 21y 10m 14d. (SE)  
Charles H.; d. Jan 26, 1884; age 34y 3m 18d. (SE)  
Emma J., dau of J. W. & S.; d. Mar 12, 1859; age 8d. (SE)

THURMAN:

Polly I.; (See SCOTT).

TONES:

Margaret; d. Oct 24, 187---; age 3m 12d. (SE)  
Caroline; d. Oct 23, 1873; age 3m 11d. (SE)  
(Daughters of W.T. & M.J. Tones).

TOWLER:

William; d. Oct 31, 1855; age 43y 2m. (SC)

ULLRICH:

Charlie W.; d. Jan 2, 1900; age 28y 7m 27d. (NW)

USHER:

George; d. Mar 25, 1908; age 64y 10m 24d. (NE)  
Margaret, wife of Geo.; d. Feb 2, 1867; age 36y 4m 11d. (NE)

VAUGHN:

Susan Marie; May 17, 1968 – Oct 4, 1970. (NC)

WEBSTER:

Charles; 1870 – 1944. (NC)  
Ermine; 1875 – 1949. (NC)

WELCH:

Amanda; (See THORNTON).  
Glenola; (See MC NEILL).  
Almira H.; 1850 – 1929. (NW)  
E.A.; Mar 31, 1838 – Dec 17, 1913. (NW)  
J.A.; Sep 17, 1877 – Nov 13, 1905. (NW)  
H.A., wife of E.A.; d. Oct 26, 1883; age 41y 14d. (NW)  
Elsia A., dau of J.A. & H.A.; Aug 25, 1875 – Mar 9, 1877. (NW)  
J.R.; d. Nov 30, 1883; age 78y 3m 6d. (NW)  
Adella R., wife of J.R.; d. May 6, 1907; age 93y 6m 10d. (NW)  
W.D.; 1834 – 1913. (NW)  
Charles M.; May 31, 1896 – Sep 19, 1919. (NW)  
R.T.; 1880 – 1940. (NW)  
J.R.; 1882 – 1964. (NW)  
Mary E.; 1883 – 1971. (NE)  
Ivan G.; 1881 – 1938. (NE)  
J.T.; d. Nov 25, 1883; age 36y 11m 20d. (NE)  
Willie H., son of J.T. & J.M.; d. Jan 3, 1877; age 5y 1m 26d. (NE)  
John E., son of J.T. & J.M.; d. Jan 15, 1879; age 1y 8m 22d. (NE)  
Sarah, wife of George W.; d. ----; age ----. (NE)  
John S., son of J.R. & A.R.; d. Dec 2, 1851; age 3y 10m 15d. (SE)  
Elizabeth, wife of Ozias; d. Jun 15, 1855; age 75y 13d. (SE)



WELCH (Cont'd):

Samuel H., son of J.R. & A.R.; d. Oct 25, 1860; age ----. (SE)  
Nancy J.; Oct 28, 1839 – Feb 13, 1849. (SE)  
Laura A., dau of J.R. & A.R.; d. Feb 5, 1864; age ----. (SE)  
David L.; Feb 20, 1846 – Jun 30, 1846. (SE)  
Mary A.; Oct 28, 1848 – Aug 29, 1849. (SE)  
Sarah J.; Jul 2, 1850 – Sep 2, 1850. (SE)  
George W.; Feb 26, 1807 – Dec 17, 1868. (SE)  
Mary D., wife of Geo.; Dec 1, 1815 – Nov 14, 1887. (SE)  
Elisha C., son of G.W. & M.D.; Mar 31, 1838 – Jun 30, 1860. (SE)  
James M., son of G.W. & M.D.; Feb 12, 1842; killed at the Battle of Pittsburg Landing, TN, Apr 6, 1862;  
Co D 28<sup>th</sup> IL Inf. (SE)  
Charles T.; Nov 24, 1851 – Sep 23, 1852. (SE)  
John H.; Apr 18, 1854 – Sep 1, 1854. (SE)  
William J.; Aug 18, 1857 – Sep 27, 1857. (SE)  
Margaret, wife of W.D.; Sep 20, 1834 – Dec 6, 1867. (SE)  
Mary F.; (See BEAN).

WHELCHER:

America A.; (See NELSON).  
John; May 10, 1819 – Apr 19, 1890. (NE)  
Sarah, wife of John; Jan 15, 1825 – Apr 30, 1897. (NE)

WHITE:

Frances; Mar 30, 1808 – May 12, 1893. (SC)

WILSON: (WILLSON)

Thomas; d. Sep 29, 1873; age 73y 6m. (SC)  
Jane, wife of T.; d. 1864; age 64y. (SC)  
William, son of E. & M.; d. Aug 11, 1865; age 5m 20d. (NC)

WOOD:

Nancy C., dau of J. & M.; d. Jan 15, 18---; age ---y 4m 26d. (SE)  
Joseph; d. May 22, 1872; age 76y 7m 7d. (SE)  
Austin; Nov 4, 1852 – Oct 2, 1910. (NE)  
Mary; d. Feb 21, 1890; age 78y 9m 13d. (NE)

WOODS:

Ethie, dau of Silas & Maggie; d. Nov 3, 1883; age 8m 3d. (SC)

YARD:

Frances E., dau of T.C. & L.; d. Jun 2, 1871; age 15y 3m 18d. (NE)  
Leander P., son of T.C. & L.; d. Oct 1, 1866; age 1y 5m. (NE)  
Alva T., son T.C. & S.L.; d. Jan 23, 1872; age 3y 11m 27d. (NE)

YOUNGER:

Mary Jane; (See RAYMOND).

ZIMMERMAN:

Mary E., dau of A. & M.L.; d. Jul 18, 1863; age 1y 6m 17d. (SE)  
Amanda, dau of A. & M.L.; d.----; age ----. (SE)  
Arthur, son of John & Eliza; d. Jul 9, 1874; age----. (SE)

## Genealogical Notes – Argyle Cemetery

**ADAMS:** 1850 census #518; Robert 37; farmer, b. MO; Oerilda, 21, b. TN; James M. 12, b. MO; John R. 2, b. IL.

**AVERILL:** Sarah E.; 1<sup>st</sup> wife of A.W.; Allen W. Averill and Sarah E. Clayton were married in this county on Jan 7, 1947.

**ARVIN:** Marjorie; d. Oct 16, 1922; age 3d; dau of R.L. & C. (Short) Arvin, both natives of KY; the Arvin child died at the family home in Hire Twp.

**BEAN:** 1850 census #518; Robert R., 50, miller, b. TN; ?Sousen, 24, b. TN; Margaret, 14, b. IN; John 14, b. IN; Joseph, 13, b. IL; Mary 13, b. IL; Wm. L., 12, b. IL; COLWELL, Minerva, 27, b. TN. (See CALDWELL).

**\*CALDWELL:** 1850 census #517; Nancy, 59, b. VA; Thomas, 24, farmer, b. KY; Sarah, 20, b. KY; Hannah, 89, b. VA.

**\*BOWLS:** George W.; d. Oct 16, 1879; age 20y 7m 29d; farmer; single; b. Hire Twp.; d. in Tennessee, IL of typhoid fever.

CALDWELL: Vecessimus A. Caldwell and Minerva A. Bean were married in this county on Feb 11, 1847.

1850 ceneus CALDWELL, Ivy, 53, b. TN; Henry, 27, b. TN; Caroline, 28, b. TN; Wm. 24, b. TN; Lucretia 22, b. TN; James, 19, b. IL; John , b. IL; Andrew, 16, b. IL; Tabitha, 14, b. IL

CARMACK: Lewis Mourning; d. May 9, 1922; age 69y 5m 10d; b.. Nov 20, 1852, in this county, son of Comodore and Lucinda (White) Carmack; Comodore b. in TN; Lucinda, b. in NY; Mr. Carmack died in Blandinsville.

Infant male; d. Nov 23, 1880; age 21d; b. & d. in Hire Twp.

1850 census #520; CARMACK, Joseph C., 30, miller, b. TN; Lucinda, 26, b. NY; William W., 5, b. IL; John C., 3, b. IL; Mariah, 58, b. VA.

CREASY: Lucy; d. Nov 21, 1922; age 80y; widow; dau of Wm. Nelson.

**CRESSEY: [Spelled CREASEY, CRESSEY, CRESY]:** G. (George) W. (b. 12 Sep 1846 in Greenup Co. KY – d. 12 Aug 1900); 1900 US Census, Colchester, McDonough, IL: George **Creasy**, 53, Sep 1846, married 34y, b. KY, father b. VA, mother b. AL; Mina, wife, 53, Oct 1846, 10 children, 7 alive; b. IL, father b. NY, mother b. KY; Clarence 18, Dec 1881, IL; Grover 15, Nov 1884, IL; Charley 12, Aug 1887, IL; Arva, son, 8, Dec 1891, IL; Civil War Pension Index for George W. **Cresey**, (Pvt) Co A 16<sup>th</sup> IL Inf. 28 May 1879 filed for invalid; 4 Sep 1900 Mina Cresey filed as Widow; Married Mine (Almira) Rathburn Nov 18, 1868, McDonough Co.; son of Bird Smith Creasey (5 Jan 1814 VA – 25 Aug 1860 McDonough Co.) and Nancy George (Wilkes) Creasey (24 Oct 1817 VA – 9 May 1873 McDonough Co.)

**GRAHAM:** 1850 census #253; GRAHAM, Bedford, 27, farmer, b. KY; Jane 25, b. KY; Mary E., 5, b. KY; Wm.L., 8 mos., b. IL; Mariah, 58, b. VA.

**HUNT:** 1850 census #261; HUNT, John, 26, farmer, b. KY; Milia, 24, b. KY; Green L., 3, b. KY; Elizabeth, 1, b. IL; James, 4 mos., b. IL.

**JAMES:** 1850 census; JAMES, John, 40, farmer, b. TN; Malinda, 37, b. KY; Wm. 17, farmer, b. KY; Geo., 16, b. KY; Mary E., 12, b. KY; Elisa, 8, b. KY; Malinda A., 2, b. IL; BOYD, Jublilton, 32, farmer, b. OH.

**LEDGERWOOD:** 1850 census #251; LEDGERWOOD, John, 34, farmer, b. TN; Mary, 40, b. TN; Mary, 14, b. IL; Wm., 13, b. IL; Elija, 6, b. IL; Elisha, 6, b. IL; John, 4, b. IL; Samuel, 3, b. IL. John Ledgerwood and Nancy Durant were married in this county on Jun 24, 1842.

John Ledgerwood moved into this county and settled on section 19, Emmet Twp; he bought 80A and later moved to section 18; he had about 250A at the time of his death. He was born in TN on Dec 17, 1810 and moved to IN; later lived in Hancock Co, after in IN only about a year; then moved to this area. He married in 1834 to Peggy J. Kelso and had 3 children; 2 were living in 1885; Mary j. who married B.F. Guy, and Wm. H. who moved to KA. He was again married in 1842 to Mrs. Nancy Durant, nee McCord. They had 4 sons, Elijah & Elisha, twins; John and Samuel. John died in his early years. Samuel moved to Parsons, KA. John Ledgerwood died Oct 30, 1879; his wife died Dec 1885 and both are buried at Argyle.

Elijah Ledgerwood, son of John and Nancy, lived on the old homestead where he was born on Apr 7, 1844; he married Clemantine Hill, a native of IN and a daughter of Thomas Hill. Thomas was a native of VA and settled in Emmet Twp. in 1861 on section 19 and died there. Ledgerwood lived in Emmet Twp. a short time and moved to Hire Twp. and then in 1882, sold out and returned to Emmet Twp. Elijah and Clemantine had 3 children: John S., Melvina N., and Joseph S.

**MARTIN:** 1850 census; MARTIN, Robert, 25, farmer, b. KY; Rachael, 32, b. KY; Rhoda, 6, b. KY; Joseph A., 3, b. IL; Ruben A., 9 mos., b. IL.

**MC CLURE:** 1850 census #680; MC CLURE, James, 51, b. KY; Mary, 42, b. VA; Nancy J., 18, b. VA; Lucinda, 16, b. IL; Mary E., 14, b. IL; Minerva, 11, b. IL; William, 9, b. IL; Martha E., 7, b. IL; Angelina, 4, b. IL.

**MC CORD:** William; (NOTE: No stone located for this individual. Obit, in part, from The Macomb Journal, Jul 24, 1884): "William McCord died at the residence of his grandson, Newton Mulkey, in Hire Twp; aged 75 years. He was born in Overton Co. TN. Fifty-two years ago he came with the family of his father, John McCord, to Illinois and settled in the southern part of Emmet Twp. John McCord died there aged 95 years. Wm. was married and raised a large family of children, only 3 of whom survive him. Four or five years ago he removed from this county to Kansas where his wife died. He then went to Southern Illinois where he married his 2<sup>nd</sup> wife, she being a sister of his first wife. In less than 2 years, this lady died also. He came back to McDonough County last spring. He was buried Monday in the Argyle burial ground." (NOTE: Another Wm. McCord lived in the Blandinsville area; he was from OH and born on Sep 20, 1839.)

Sarah; d. Jun 28, 1922; age 77y 4m 25d; b. Sep 3, 1844, in this county; md. John A.F. McCord; lived and died in Hire Twp.

A.Y. (1825-1902); Alex. McCord married Mary Ann Harrison in this county on Mar 4, 1845. 1850 census #524; A.Y., 24, farmer, b. TN; Mary A., 23, b. KY; Hariett C., 5, IL; Sarahe E., 1, IL.

**MC GEE:** Elijah McGee and Amelia Ruddel were married in this county on Feb 5, 1842.

**MURRAY:** 1850 census #254; MURRAY, John B., 34, farmer, b. KY; Susan, 31, b. KY; Harriett, 10, b. KY; Lucy A., 8, b. KY; John F., 4, b. KY; Wm. D., 4 mos., b. IL.

Jesse E. (Death notice, in part, from The Macomb Journal, Oct 6, 1881): "A daughter of Miles Murray died last week."

James Riley (Death notice, in part, from The Macomb Journal, Feb 17, 1881): "Riley Murray of Hire township, died Tuesday of this week and was buried at the Argyle Cemetery. He left a widow (wife of a year) who is the daughter of Mrs. Askew of this city."

**NAYLOR:** Wm. B. married Melinda L. McCord, a daughter of Wm. McCord; William was the 2<sup>nd</sup> son of Benj. T. Naylor and was born Jul 11, 1835 in Macomb. After marriage, the couple lived with his parents a year and then moved to a farm on section 20, Emmet Twp; living there in 1885; owned 166A; Mrs. Naylor died Mar 24, 1864; had the following children: George J.; Samuel; Ida; and Louisa. William remarried Oct 11, 1866 to Priscilla James, daughter of Joseph James; 1 child, Charles, born Jul 17, 1867 and died Sep 1, 1867; Wm. B. in the army during the Civil War and was taken prisoner and was in the Libby Prison.

Benjamin Naylor (See Old Macomb Cemetery).

**NELSON:** William (Death notice, in part, from The Macomb Journal, Mar 17, 1887): "William Nelson died at his residence in Emmet township on March 14<sup>th</sup> aged about 75 years. He has lived in McDonough county for many years and leaves a widow and several children, among whom is Mrs. Henry Lansdown....."

**PARISH:** Jacob and Lucy (Haines) were natives of KY; a daughter, Arrena Iona, b. Oct 22, 1864, married W.H. Moon, and later lived in Hire township; she died in 1921.

**QUINAN:** Rachel; d. Aug 5, 1881; age 23y; married; b. in this co.; d. at Colchester.

**REMINGTON:** 1850 census #541; REMINGTON, D. (male) 23, farmer, b. OH; C.C. (female), 26, b. OH; Duett, 2, (male), b. IL; Esther, 43, b. CT; Francis, 19, farmer, b. OH; Elmore, 17, b. OH; Caroline, 11, b. IL; John, 9, IL; Lafayette, 3, b. IL; California, (male), 1, b. IL.

**SHIPPEY:** Thomas Shippey and Cynthia M. Spencer were married in this county on Jul 9, 1846. 1850 census #509; Thomas, 29, blacksmith, b. VA; Cynthia, 23, b. MO; Isaac D., 3, MO; J.W. 6 mos., b. IL.

**SPENCER:** 1850 census; SPENCER, Isaac, 50, farmer, b. NY; Easa, 50, b. KY; Lucretia, 17, b. MO; Isaac, 11, b. IL.

**TEAS:** Nicholas Teas and Charlotte B. Averill were married in this county on Mar 7, 1833.

**THORNTON:** Amanda Welch, daughter of George Washington and Mary D. Welch.

Carrie A.; d. Feb 17, 1880; age 3y 2m 23d; d. at Macomb.

**THORPE:** Charles H. (Death notice, in part, from The Macomb Journal, Feb 14, 1884): "Chas. Thorp, a farmer resident of Colchester, was murdered recently in Colorado; his remains arrived here Feb 12<sup>th</sup> for burial."

**WELCH:** J. R. (1805-1883); Jefferson R. Welch and Addella R. Caldwell were married in this county on Feb 14, 1833. 1850 census #515; Jefferson, 45, farmer, b. KY; Adelinaas, 50, b. KY; William, 16, farmer, b. IL; Samuel H., 11, b. IL; Mary F., 8, b. IL; Thomas, 5, b. IL; John, 2, b. IL.

J.R. (Death notice, in part, from The Macomb Journal, Dec 6, 1883): "Jefferson Welch, one of the oldest settlers of McDonough county, died at his home north of Colchester in Emmet township on Nov 30<sup>th</sup>. He came to this county before 1835. He married a sister of Thos. Caldwell of this city and was the father of a large family. He wife survives...."

Geo. W. (1807-1868); George W. Welch and Mary Caldwell were married in this county on Aug 7, 1835. 1850 census #516; George W., 43, farmer, b. KY; Mary, 36, b. KY; Amanda, 13, b. IL; Elija, 12, (male), b. IL; Elisha, 12, b. IL; James, 8, b. IL; George 4, b. IL.

**WELCH (Cont'd):** Mary D. (d. 1887) (Death notice, in part, from The Macomb Journal, Nov 17, 1887): "Mrs. Washington Welch died at her home near the Argyle Church 2 miles north of Colchester. She was the mother of George S. Welch of Macomb, Mrs. A. Thornton, Albert Welch of Colchester and Mrs. Emma Norris.....".

H.A. (Death notice, in part, from The Macomb Journal, Nov 1, 1883): "Mrs. Hattie Welch, wife of Elijah Welch, died at her residence in Tennessee (IL) on Oct 26<sup>th</sup>, aged 41 years. She was the daughter of George G. Guy and was born and raised in Emmet township....."

J.T. (Death notice, in part, from The Macomb Journal, Nov 29, 1883): "Taylor Welch of Emmet township was killed by lightning Sunday night near his home. He was born in Emmet township and has spent his whole life there. He was a son of James Welch who died several years ago and a cousin of Mrs. A. Thornton of this place and of Geo. S. Welch, the bookdealer. He was married some 14 years ago to Miss Murray who parents reside in KY. They had 3 children, 2 of whom have died; the surviving child is less than 3 years of age....."

**YARD:** (See ATKINSON #264; Atkinson Cemetery).

### **Notes, Corrections, Additions, and Changes**

2012: NOTE: With the CREASEY/CRESSEY/CRESEY family it was obvious this is one family with different spellings on the last name by census takers, tombstone inscribers, and other record takers. In this Cemetery, Mr. Lester had access to the 1850 census. In 2012, with the internet there is easy access to all US Census records through 1940 via Ancestry.com and Familysearch. org. Within a few minutes, I was able to sort out some family records. If one had enough time, this could be done for about every family listed in every cemetery. T.L. Green.

# GUY CEMETERY

Location: Emmet Township, NE¼, section 20; 4 miles west of U.S. Hwy 67 on Spring Lake Road.  
40° 30' 2.0" N: 90° 45' 26" W

Remarks: The grounds are completely fenced and most stones are standing upright; appears to be regularly maintained.

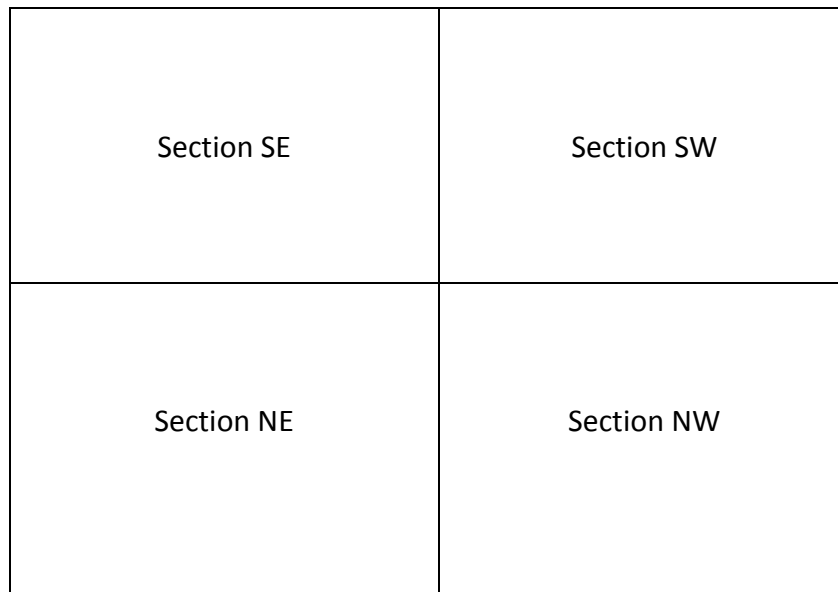
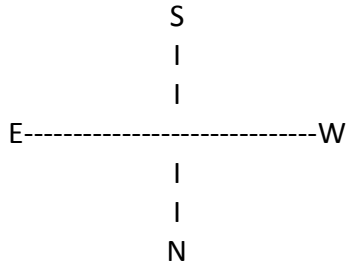

Entrance

---

Spring Lake Road

---

BAYLESS:

T. Jefferson; 1870 – 1900. (NE)  
Emma Jane; 1872 – 1937. (NE)  
Ralph, infant son of T.J. & E.J.; 1895. (NE)  
Thomas J., infant son of T.J. & E.J.; 1900 (NE)

BRIGGS:

Billy; 1931 – 1935. (SE)  
Shirley; 1947 – 1947. (SE)

BYERLY:

Jesse J.; 1886 – 1970. (NW)

CARTER:

George W., son of J.L. & E.J.; d. May 31, 1862; age 21d. (NW)  
Eliza; 1836 – 1917. (NW)

CRABB:

Carle Ray, Jr., May 25, 1914 – Oct 27, 1972. "And Hunter is Home From the Hill." (NE)

DUNCAN:

William W.; b. Feb 1, 1807; d. Nov 16, 1859. (NE)  
Matilda G.; b. A.D. 1858; d. A.D. 1860. (NE)  
Amanda C., wife of Wm.; b. Oct 22, 1816; d. Nov 30, 1888. (NE)

FUSSELMAN:

Herbert; Jan 6, 1888 – Mar 2, 1965. (NW)  
Janie; Dec 25, 1887 – May 19, 1957. (NW)

GLOYD:

Preston E.K.; 1855 – 1893. (NW)  
Mary E.; 1863 – 1935. (NW)

GUY:

Howard; Feb 1, 1885 – May 24, 1937. (SE)  
James V.; 1841 – 1916. (SE)  
William A.; 1875 – 1876. (SE)  
Elvira A.; Jun 6, 1849 – Mar 14, 1930. (SE)  
George W., son of G.G. & A.S.; b. Jan 2, 1848; d. Sep 22, 1849. (NE)  
Nathaniel M., son of G.G. & A.S.; d. Jul 8, 1863; age 24y 1m 1d. 124<sup>th</sup> IL Inf. (NE)  
George G.; Sep 2, 1808 – Nov 8, 1896. (NE)  
Angeline S., wife of George; Jul 17, 1812 – Feb 10, 1889. (NE)

HARDIN:

Davis; b. May 14, 1797; d. Dec 11, 1868. (SW)  
Eliza, wife of Davis; b. Mar 30, 1808; d. Aug 5, 1901. (SW)

HUGHES:

William W.; 1884 – 1964. (NW)

JOHNSON:

John; (no dates). (SW)  
Anna C.; (no dates). (SW)  
Eldon; (no dates). (SW)

LEWIS:

William T.; 1853 – 1928. (SW)  
Martha G.; 1849 – 1917. (SW)  
Katie, dau of W.T. & M.; d. May 15, 1890; age 5y 9m 18d. (SW)  
Chorena S.; 1891 – 1961. (NW)  
George W.; 1893 – 1958. (NW)

LEWIS (Cont'd):

Francis M.; 1897 – 1940. (NW)

Mary E., wife of S. H.; Jun 29, 1861 – Jan 12, 1900. (NW)

Samuel H.; b. Nov 1, 1855; d. Dec 31, 1897. (NW)

James, son of Samuel & Catherine; b. Apr 3, 1850; d. Oct 31, 1875; age 25y 6m 26d. (NW)

Catherine; 1833 – 1914; age 81y 18d. (NW)

Buena V.; 1888 – 1971. (NE)

MC FARLAND:

Theodore B.; 1846 – 1890. (NE)

Mary R.; 1848 – 1901. (NE)

PARKINS:

Pearle Lewis; Mar 31, 1895 – Oct 26, 1918. (SW)

ROMINGER:

Matilda A., wife of T.O.; b. Sep 9, 1849; d. Aug 22, 1886. (SW)

SIMMONS:

Bessie Ann, dau of J.M. & M.J.; d. Feb 16, 1899; age 11y 3m 1d. (SW)

John M.; 1855 – 1936. (SW)

Mary J.; 1857 – 1925. (SW)

Katherine, dau of J.M. & M.J.; 1884 – 1928. (SW)

Mary, wife of Joshua; d. Jan 21, 1897; age 86y 8m 23d. (SW)

Joshua; d. Feb 15, 1883; age 76y 2m 22d. (SW)

Zephraniah B.; b. Sep 11, 1838; d. May 15, 1913. (SW)

ST CLAIR:

James A.; Dec 15, 1868 – Apr 14, 1925. (SE)

WEBSTER:

James; d. May 18, 1858; age 54y 5m. (NW)

WHITE:

Infant sons of Jesse & Cora; (no dates). (SW)

Fidilia; Mar 21, ?1868? – Feb 20, 1888. (SW)

Charlie; b. Nov 2, 1889; d. Sep 2, 1890. (SW)

Arthur J.; 1879 – 1945. (SW)

Harvey; 1884 – 1904. (SW)

Hugh L.; Nov 24, 1871 – Apr 22, 1894. (SW)

Robert W.; b. Jul 1, 1844; d. Aug 14, 1891. (SW)

Matilda R.; 1852 – 1925. (SW)

WILSON:

Mealy, wife of Thomas; 1845 – 1894. (SW)

Mary E., dau of T.A. & M.; b. Feb 8, 1871; d. Nov 28, 1890. (SW)

WRIGHT:

Mary Ann, dau of John E. & M.E.; d. Mar 15, 1865; age 8y 28d. (SW)

John E.; d. Mar 15, 1863; "A private of Co. "F", 34<sup>th</sup> Iowa Vol Reg. (SW)

Elizabeth, dau of J.E. & M.E.; d. Nov 11, 1862; age 14m 12d. (NW)



## Genealogical Notes – Guy Cemetery

**DUNCAN:** 1850 census #252; DUNCAN, Wm., 45, farmer, b. KY; Amanda, 33, b. KY; Mary, 17, b. KY; Sarah J., 15, b. KY; Malinda, 13, b. KY; Martha, 10, b. KY; Nancy, 9, b. KY; Wm. H., 7, b. IL; H.C., (female) 7, b. IL; Samuel W., 4, b. IL; Eliza A., 1, IL.

**GUY:** 1850 census #258; GUY, George, 42 farmer, b. KY; Ann, 38, b. VA; Mahalia, 16, b. KY; Benjamin, 13, b. KY; David, 12, b. IL; Nathaniel, 10, b. IL; James, 8, b. IL; Merit, 6, (male) b. IL; Rebecca, 4, b. IL; Martha 10 mos., b. IL; BANKS, John, 14, b. KY.

**HARDIN:** 1850 census #256; HARDIN, Davis, 53, farmer, b. KY; Emily, 43, b. MD; Nancy A., 18, b. KY; SHIPPEY, Washington, 19, farmer, b. OH.

**HUGHES:** Matie E. (Obit, in part, from The Macomb Journal, Oct 23, 1976): "Mrs. Mattie E. Hughes, 86, of Macomb died today at the McDonough District Hospital....born Aug 29, 1890, in Norton Co. KA, to John and Mary Jane (Lewis) Simmons.....married Dec 1912, to William Woodford Hughes; had a son, William J....." Mrs. Hughes was a sister to Bessie and Catherine Simmons.

**ROMINGER:** Matilda A. (Death notice, in part, from The Macomb Journal, Aug 26, 1886): "Mrs. Matilda Ann Rominger died last Sunday at the home of her mother, Mrs. Polly Simmons in Emmet township. She came from her home in Texas a few weeks ago. She was aged 37 years and leaves a husband and one child...."

**SIMMONS:** 1850 census #217; SIMMONS, Joshua, 43, farmer, b. VA; Mary, 40, b. MD; Martha E., 18, b. KY; James D., 16, b. KY; Eli, 14, b. KY; Zach B., 11, b. KY; Thomas M., 9, b. KY; Wilson W., 6, b. KY; Sarah E., 4, b. IL; Joel H., 3, b. IL; Matilda A., 1 mo., b. IL; SHINN, David W., 25, school teacher, b. NY; CHAMPION, Mankin, 55, b. VA; WEBSTER, James, 47, carpenter, b. MD.

Joshua (Obit, in part, from The Macomb Journal, Feb 22, 1883): "Joshua Simmons died at his home in Emmet township on Feb 15<sup>th</sup>, age 78 years. He was born in Halifax Co. VA near the north line of N. Carolina in 1806. At the age of 9 years, he moved with his parents to Washington Co. KY where he grew to manhood. There on Dec 28, 1828, he married Miss Mary Webster. In 1834, they moved to Illinois. He was the father of 12 children, 7 sons and 5 daughters, all of whom grew to man and womanhood and 11 of whom are now surviving. One son died as a soldier in the 84<sup>th</sup> Ill., in a hospital at Bowling Green, KY in 1862. Surviving are his wife and children, 4 of whom live at a distance. Mrs. Mary McGinnis, wife of Rev. J.K. McGinnis of Hiawatha, Kansas; Mrs. Ellen Wright and Joel H. Simmons, both of Norton Center, Kansas; Mrs. Ann Rominger of Wetherford, Texas."

**WEBSTER:** James (See SIMMONS #217).

**WHITE:** Fidilia (Obit, in part, from The Macomb Journal, Feb 23, 1888): "Mrs. Fidilia White died this Monday at the residence of her son, Robert, in Emmet township, age 80 years. She had settled in Emmet township in 1835. She is also survived by sons Hugh L. White of Emmet and Prof. John S. White of Putnam Co. MO. She was the wife of Wm. M. White and died on Feb 20<sup>th</sup>. She was born Fidilia Hardin on Mar 21, 1808 in Washington, KY. She married and has lived in Emmet township ever since....."

## Notes, Corrections, Additions, and Changes

## SIMMONS CEMETERY

Location: Emmet Township: NE¼, Section 16; about ¼ mile north of the west end of Spring Lake; located on property owned by the City of Macomb, IL. 40° 30' 52.14" N: 90° 44' 37.36" W Elevation 691'

Remarks: Extensively overgrown with weeds and small trees; most stones are overturned and many are broken into several pieces. Last burial was John Joshua Simmons in 1922. Since then, cemetery has been abandoned and isolated when Spring Lake dam (Macomb City water supply) flooded county access road. Public access is by boat from Spring Lake and hike up old, overgrown road bed. Roadbed and cemetery cleared of brush and small trees in 2011 by Boy Scouts (Joe Howard Eagle Project, p4). Vehicle access may be arranged using private property by contacting McDonough County Genealogical Society, PO Box 202, Macomb, IL 61455 Ph. (309) 255-5161 Email: mcgs@macomb.com

### AXFORD:

Infant dau of J. & H. (no dates).

### CARTER:

May M., wife of J.; Mar 1, 1871 – Mar 12, 1908.

Walter O., son of J. & M.; Jul 1, 1893 – Oct 8, 1910.

Edward K., son of J. & M.; Oct 13, 1903 – Nov 18, 1904.

Gertie E., dau of J. & M.; Mar 27, 1898 – May 1, 1898.

### COLLINS:

Mary; d. Nov 18, 1861; age ?70?y.

### LANDSDOWN:

Lucy C.; Sep 17, 1850 – Jan 8, 1869

Martha J., dau of J.J. & J.; d. Feb 5, 1868; age 24y 2m 21 d *(b. 9 Dec 1843, IL)*

John T.D., son of J.J. & J.; d. Aug 10, 1866; age 28 *(b. 1838)*

John J.; d. Apr 28, 1864; age 69y 10m 18d *(b. abt 1798, Eng)*

Jane; d. \_\_\_ 3, 1865; age 56y 4m 3d *(b.1809,Osmaston, Eng)*

Joseph E.; d. Nov 29, 1855; age 54y *(b. abt 1801)*

### MC DONALD:

Obedience, wife of J.; d. Jan 1, 1868; age 78y 1m *(b. abt 1790; wife of John McDonald)*

### MC GINNIS:

Arthur, son of J.K. & M.H.; d. Jan 6, 1871; age 21d *(b. 15 Dec 1870, son of John Kepel McGinnis & Mary Ann Simmons)*

### NICHOLAS:

Violetta; d. Nov 4, 1890; age 64y 8m 7d *(b.25 Feb 1826; wife of George Nicholes, dau of John & Obedience McDonald)*

### SIMMONS:

Sarah E., wife of R.L.; Apr 14, 1845 – Oct 28, 1914

Rowan L.; Apr 24, 1836 – Mar 20, 1906 Corp. Co "D", ILL. Inf.

Leuie, son of R.L. & S.E.; d. Nov 10, 1877; age 3y 3m 20d *(b. 21 Jul 1874)*

Gladden F., son of R.L. & S.E.; d. Aug 13, 1868 age ? *(Gladden Farwell b. abt 1867)*

Infant dau of T.M. & R.; d. Apr 17, 1863 *(dau of Thomas Mankin Simmons, brother of Sarah Elizabeth Simmons)*

Ruth, wife of T.M.; Apr 4, 1865; age 24y 1m 22d *(Ruth Collins b. 10 Feb 1841)*

Pearl, dau of T.M. & N.R.; d. Apr 13, 1869; age 4m 19d *(dau of Thomas Mankin Simmons & Nancy Rosa Barnes)*

Freddie E., son of T.M. & Rosa; d. Apr 7, 1877; age 5y 5m 15d *(Frederick b. 22 Oct 1871)*

Frankie L., son of T.M. & Rosa; d. Oct 13, 1877; age 1y 10m 4d *(Frank b. 9 Dec 1875)*

John Joshua; 1866 – 1922 *(b. 6 Jun 1866 – d. 21 Mar 1922; son of James Davis Simmons & Martha McDonald)*

Martha, wife of J.D.; d. Mar 9, 1910; age 75y 11m 5d *(dau of John & Obedience McDonald b.26 Apr 1834)*

James D.; d. Dec 15, 1884; age 50y 4m 1d *(James Davis Simmons brother of Sarah E. Simmons b 12 Aug 1834)*

STRICKLEN:

Mary Jane, dau of Joseph & Jane; d. Oct 13, 1864; age 15y 4m 28d (b. 16 May 1849 Eng)  
Joseph; d. Oct 9, 1893; age 71y 1m 4d (b. 5 Sep 1822 Frome, Somerset, Eng)  
Jane, wife of Joseph; d. Apr 20, 1901; age 74y 8m 19d (dau of Richard Collins & Mary Landsdown b. 31 Jul 1826 Eng)

**Genealogical Notes – Simmons Cemetery**

**CARTER:** May M., wife of John (*isn't this James?*); maiden name was Simmons; John & May Simmons Carter were both natives of this county; a daughter, Myrtle Dell, later married George Sadler; Myrtle was born in Emmet township on Jan 25, 1891; she died in 1923 and was buried in Good Hope, IL  
Mar 1, 1898: The babe of Mr. & Mrs. James Carter of E. Jackson St, Macomb, died. Remains interred in Simmons Cemetery, north of the city. (*Was this May 1, 1898 and daughter's name Gertie E.?*)

**LANDSDOWN:** 1850 Census No# 263 – Landsdown, John 52, farmer, b. Eng; Jane, 41 b. Eng; Elizabeth 19, b. Eng; Cordelia, 16 b. IL; Mary, 14 b. IL; John L. D., 12 b. IL; James H., 9 b. IL; Martha I., 6 b. IL; Sarah C., 2 b. IL

**MC GINNIS:** Arthur, son of Rev. J.K. and Mary (Simmons) McGinnis. Mrs. McGinnis was a daughter of Joshua and Polly Simmons. Rev. and Mrs. McGinnis later moved to Hiawatha, Kansas.

**SIMMONS:** James D. (Obit. {in part} from The Macomb Journal, Dec 18, 1884): "James D. Simmons died at his residence in Emmet township on Dec 15<sup>th</sup>, aged 51 years. He was born in Washington Co., KY, on Aug 14, 1834. When he was 1 year old, he came with his parents Mr. & Mrs. Joshua Simmons, to Emmet township where the father died 2 years ago. The deceased, in 1859, married Miss Martha McDonald who survives, along with 1 son, aged 17 years ....."

John Joshua; d. Mar 21, 1922; aged 55y 9m 13d.; b. Jun 8, 1866, in Illinois; son of Mr. & Mrs. Joseph D. Simmons, natives of KY; his mother's maiden name was McDonald. John J. Simmons was married and died in Macomb.

(See Guy Cemetery--- 1850 census No 217)

**Notes, Corrections, Additions, and Changes**

**SIMMONS:** Rowan L. Simmons, Civil War Veteran

Rowan's parents were Joel Simmons (1807-1882) and Lucretia Hardin (1812-1899). Rowan's wife, Sarah Elizabeth maiden name was Simmons. Her parents were Joshua Simmons (1806 – 1883) and Mary Polly Webster (1810-1897). Joel Simmons and Joshua Simmons were brothers.



Corporal Rowan Simmons  
Company D, 28<sup>th</sup> Illinois Volunteer Infantry

## SIMMONS CEMETERY

Press Release

December 1, 2010

### SIMMONS CEMETERY CLEANUP AND SIGN

Macomb - Macomb High School senior Joe Howard learned about the cemetery restoration project of the McDonough County Historical Society early this spring. He consulted with some leaders of his Scout troop which set off a chain of events that culminated in completion of his major project to reach Eagle Scout. The Simmons family cemetery has been inactive since 1922, when Spring Lake was created. The lake project flooded the county road used to access this cemetery. The isolation and consequent abandonment and neglect took its toll in fallen trees, limbs, and aggressive weeds. Howard learned that members of the Historical Society would be enthusiastic supporters of his proposal to reclaim and restore this old family cemetery which is on property owned by the city and administered by Spring Lake Park. After several Saturdays of chain saws, weed whackers, loppers, stoop labor, and the cooperation of a few fellow Scouts and friends, the Simmons Cemetery has emerged as an expansive and restored cemetery. Most headstones are standing erect surrounded by a dense woods. The McDonough County Historical Society recognized the work of Howard by erecting its most recent sign at the edge of the newly cleared plot in the middle of a forest a half mile north of Spring Lake shore. The earliest burial was Joseph E. Landsdown in 1855, at age 54 years old. The last interment was John Joshua Simmons in 1922. An older Rowan L. Simmons was a veteran of the Civil War who died in 1906. Ten of the 31 headstones mark the graves of young children or infants. Twelve members of the Simmons family rest in this deeply wooded and secluded plot.

Howard is president of Scout Venturing Crew 5203. Dr. Shea Trost serves as Crew Advisor and Tom Green supervised this Eagle project.

The cemetery sign project is supported by Niemann's County Market and Pepsi, the McDonough County Genealogical Society, the McDonough County Highway Department, and the McDonough County Historical Society.



## ATKINSON [MC CORD] CEMETERY

Location: Emmet Township; NE¼, section 31; about ¼ mile northeast of the northeast corner of Argyle Lake State Park. [40° 28' 0.6" N: 90° 46' 54.74"W](#)

Remarks: This family graveyard has not been fenced for a number of years, and as such, the overall condition at this time is poor. Many stones are broken; most are badly weather-worn. This cemetery has also been known as the McCord Graveyard.

### ATKINSON:

Simeon; d. Sep 9, 1850; age 40y.  
Frances; d. Sep 4, 1872; age 66y 8m.  
J.W., son of S. & F.; d. Jun 29, 1851; age 15y 9m.

### BAYLESS:

Luartha, wife of Jefferson; May 22, 1827 – Jan 8, 1857.

### BOSSERMAN:

John; d. Nov 28, 1851; age 38y 3m 20d.  
Infant son of John & E.M.; d. Jul 22, 1850.

### MC CORD:

Mary, dau of ?J.W. & N.W.?; Jan ----, 1841; age 11y.  
John; b. in N. Carolina; d. Dec 23, 1863; age 83y 11m 7d. [\[b. 16 Jan 1779\]](#)  
Mary, wife of John; b. in Virginia; d. Jun 17, 1861; age 76y. [\[b. 1787\]](#)  
Elizabeth, dau of John & Mary; b. in Overton Co. Tenn; d. Sep ?30?, 1852; age 30y 6m 14d.

### RUSSELL:

Robert; d. Aug 29, 1855; age 63y 5m 23d. [\[b. Mar 7, 1792\]](#)  
Katharine, wife of Robert; Oct 15, 1797 – Mar 22, 1857.  
Frances, C., dau of R. & C.; d. Apr 23, 1853; age 25y 1m 13d.

### UNKNOWN: [\[WELSH {1850 census} McCORD {1860 census}, Jack; b. 1825, KY; d. 1870 McDonough Co. IL\]](#)

To the remains of Jack, the Black Man of John McCord; age 45y.

### WELCH:

James R.; d. Aug 8, 1848; age 38y.  
Mary E., dau of James R. & Margaret; d. Mar 27, 1859; age 16y 1m 25d.

### WILLARD:

William; d. Nov 8, 1846; age 97y. [\[b. 1749\]](#) (NOTE: Mr. Willard is one of the very few Revolutionary War veterans buried in McDonough County. He enlisted at Leesburg, VA in Jul 1778. He was born in Loudon Co. VA and was married to Jane Cooke. Their daughter, Mary, was born in VA in 1785, later married John McCord and lived in Overton Co, TN before moving to IL.)

### YARD:

Emma Louise, dau of Thomas C. & Louisa; Aug 9, 1862 – Sep 9, 1863.  
Isabell, dau of Job, Jr. & S.; d. Jun 30, 1878; age 1y 3m 11d.  
Job; d. Sep 11, 1839; age 40y.

## Genealogical Notes – Atkinson / McCord Cemetery

**ATKINSON:** Simeon Atkinson and Mrs. Francis Yard were married in this county on Jul 14, 1842. 1850 census #264; ATKINSON, Simeon, 48, farmer, b. England; Frances, 45, b. England; Mary, 15, b. England; John W., 13, b. England; Amanda, 11, b. England; Levi, 8, b. IL; Wm. H., 6, b. IL; James R., 2, b. IL; Simeon, 2 mos., b. IL; YARD, Thomas, 19, farmer, b. CT; YARD, Mary F., 17, b. IL; WARREN, George, 22, farm laborer, b.OH.

Louis, lived on section 31, NE¼, Emmet Twp.; owned 200A here and 40 A in NW¼, section 31; was of English descent and parents were natives of England; Louis was born in this country in 1842 and lived on the homestead with his parents; married Feb 11, 1866 to Maria J. Martin, dau of George Martin, who settled in this county in 1850 and later, in 1868, moved to Henry Co. MO; Atkinsons had 9 children --- 7 living in 1885; Sarah Frances; Amos S.; Wm. C.; Ira L.; Ora C.; Clara; and Thomas J.; Alta M. and Cora Jane died previous to 1885. NOTE: 1871 Atlas indicates Francis (or Frances) Atkinson as owner of the Emmet Twp. property.

**BAYLESS:** Jefferson Bayless, native of TN, born in Knox Co. TN May 27, 1827; the son of Isaac and Betsey Ann (Sumter) Bayless; they both died in TN and were buried in Knox Co.; Jefferson was raised in TN and married Luartha Ledgerwood, a native of TN; they were married in May 1851; \*she died Apr 1856 and was buried in Atkinson Cemetery on section 31, Emmet Twp. (\*Tombstone inscription says she died Jan 8, 1857.) The had one child, Isaac. Jefferson remarried in TN on Sep 28, 1858 to C.S. Lucy, a daughter of Wm. & Eveline Lucy; they had the following children --- Eva, married E. Richardson and moved to NE; Bessie A.; Jennie H.; Willie L.; Ida M.; Frederick B.; John H.; and Ray M. Jefferson settled on section 19, Emmet Twp. and bought 40A; he later owned a total of 160A in this area.

**BOSSERMAN:** 1850 census #259; BOSSERMAN, John, 33, farmer, b. VA; Elizabeth, 28, b. VA; Elizabeth, 11, b. VA; Robert, 9, b. VA; James, 6, b. IL; Frances, 1, b. IL.

**MC CORD:** 1850 census #340; MC CORD, John, 71, farmer, b. NC; Mary, 50, b. VA; Thomas, 30, farmer, b. TN; Elizabeth, 20, b. TN; Sarah, 18, b. IL; WELSH, Margaret, 30, b. TN; WELSH, Mary, 7, b. IL; WELSH, Mahala, 5, b. IL; WELSH, John, 4, b. IL; WELSH, Jack, 25, black, farmer, b. KY.

1860 census #1604; MC CORD, John, 81, farmer, NC; Mary, 75, VA; WELSH, Margaret, 35, TN; Malinda, 15, IL; John, 11, IL; MC CORD, Jack, 35, black, TN.

William W.; born in Overton Co. TN on Feb 12, 1809; lived there till the fall of 1829; moved with family to Morgan Co. IL and there 2 years; then he and his father moved to this county in 1832 and Wm. then returned to TN where he married Louisa Scantlin on Nov 1, 1832; she was a native of Jackson Co. TN; they lived there 2 years and returned to this county and lived here till the spring of 1849 and moved to Nauvoo;; there about 2 years and back to this county; in the spring of 1878 moved to KA and 1<sup>st</sup> wife died there in the fall of 1878; Wm. then returned to this State and lived in Franklin county; married there to Lucretia Mulkey; lived there a short time; 2<sup>nd</sup> wife died within a year of marriage; Wm. returned to this county in the spring of ???? and lived here till his death on Jul 20, 1884 at age of 75 years.

John A.F.; born in Emmet Twp. on section 30, Mar 14, 1844; was the 2<sup>nd</sup> son of Wm. and Louisa (Scantlin) McCord; moved to Idaho at age 20 in search of gold; returned a short time; farer here and dug coal in the winter; married on Nov 8, 1866 to Sarah J. McGee, a native of Hancock Co.; she was a daughter of Wm. McGee who died when his daughter was very young; McCord lived in Hire Twp. for 5 years on section 25; bought 40A on section 36 in 1872; owned 76A at home place and 25A of timber in 1885; had 7 children --- Robert S.; Sarah Malinda (died); Mary Lucretia (died); John A.F.; Wm. Lee (died); Nancy Bernetta; and Thomas Roach (died).

**YARD:** Job; born in Somersetshire, England; married to Frances Chorley, a native of the same place; a son, Thomas, was born in Stamford, CT on Dec 4, 1830; Thomas died in 1923 in Macomb; removed to the Macomb Mausoleum

Emma Louise, a daughter of Thomas Calvin and Louisa Yard; Thomas died in Macomb on Nov 1, 1923; aged 92y 10m 27.

**Notes, Corrections, Additions, and Changes**



## POST – SHIPPEY- DEW CEMETERY

Location: Emmet Township; SW¼, section 32. This cemetery is located off E700 St turning east on N1235 Rd and driving one quarter mile cross country to the east fence line then south about 200 yards to the crest of a hill following the ridge back west about 150 yards where the stones lie flat in a pasture and are difficult to see. 40<sup>0</sup> 27' 32.5" N: 90<sup>0</sup> 45' 56.2"W

Remarks: Little remains of this small graveyard. The site is within privately owned property and is about one quarter mile from any public road. Broken stones for the individuals listed below were found under a large hickory tree located in pasture land. One large stone, apparently hand-carved from native rock, is not totally unreadable. Another portion of a stone contained the name "Esther A."; the remainder of the marker could not be located. The following information was obtained in mid-1974:

### DEW:

Elizabeth; d. Mar 1859.  
Infant dau; d. Oct 1859.

### POST:

Margaret, wife of J.; d. Jul 22, 1840; age 48y 5m ?10?d.

### SHIPPEY:

David; d. Sep 25, 18?39?; age ?58?y ---m ---d.  
Lydia, wife of D.; d. Sep 13, 18—9; age ----.

### Notes, Corrections, Additions, and Changes

Gravestones containing the name DEW were found nearby in 2012.

PRESS RELEASE: Jun 1, 2012

Emmet Township – Kendall and Ann Runner Knowles, owners of property that includes the Post-Shippey-Dew Cemetery, recently accepted a new sign to mark the site donated by the McDonough County Historical Society. Ann's family has farmed this property for many years, and she recalls seeing the headstones when she was a young girl. But there is little historical record of the folks resting there. This cemetery is located in the southwest quarter of Section 22 in Emmet Township in McDonough County.

The headstones are all fallen and partially buried under sod and weeds. They are in two groups separated by about 20 yards, and memorialized over a 20 year period (1839-1859). David Shippey and his wife Lydia both died in September 1839. A headstone near theirs marks the grave of Margaret Post, 1840. Approximately 20 yards east are headstones for Elizabeth Dew (d. Mar 1859) and her infant daughter (d. Oct 1859). Nothing could be found about any of these early settlers.

A sophisticated "poking" between these two groups might reveal more headstones marking burials between 1839 and 1859.